

O.D.O.T. DISTRICT 2 SURVEY OFFICE (USE ONLY)

PERSONNEL \_\_\_\_\_ REFERENCE NO. 86 SHEET 4 OF 13  
 NOTES WESTFALL DATE 10-21-13 ROUTE SR 105  
 H.C. WESTFALL WEATHER PTLY CLOUDY COUNTY WOOD  
 R.C. LEU TEMP. 53°F TOWNSHIP FREEDOM  
 \_\_\_\_\_ SECTION 2  
 \_\_\_\_\_ T 5 N R 12 E

TYPE MONUMENT 5/8" IPIN  
~~ON SURFACE~~ - BELOW 4"  
~~LEFT~~ - CL PAV'T - RIGHT 34.5'  
26' TO RT EDGE PAVEMENT  
 S.L.M. 556+66.49

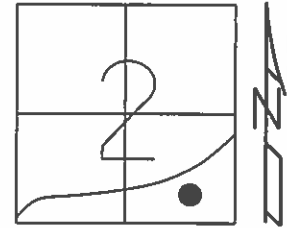

Grid: Northing: 638630.8630 Easting: 1710648.6110

RECORD 559+20.60  
 $\Delta=46^{\circ}80'60''$   
 P.I. 77

FD. 5/8" IPIN  
 GPS, REF86

GPS, REF86  
 7-22-15

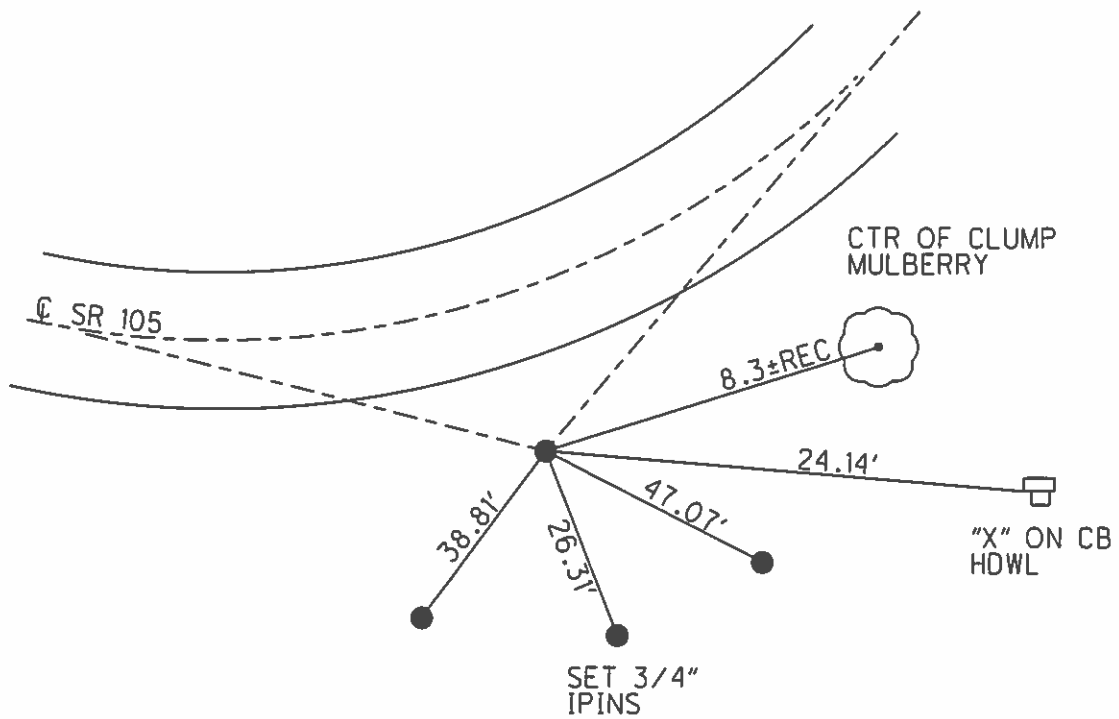

O.D.O.T. DISTRICT 2 SURVEY OFFICE

PERSONNEL

REFERENCE NO. 86

SHEET 41 OF 49

NOTES LOEHRKE

H.C. BARNHISEL

R.C. HOUSEHOLDER

HOFFMAN

DATE 11-19-94

WEATHER FAIR

TEMP. +72

ROUTE SR 105

COUNTY WOOD

TOWNSHIP FREEDOM

SECTION 2

T5 N R 12 E

TYPE MONUMENT 5/8" IRON ROD

ON SURFACE - BELOW JUST BELOW

~~LEFT~~ PAV'T. - RIGHT 34.5' RT & PYMT

260 RT TO RT EDGE PAVEMENT

S.L.M. 558+22

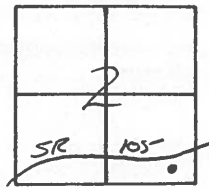

Δ = 46° 55' Lt

P.I. 77

RECORD 559+80.60

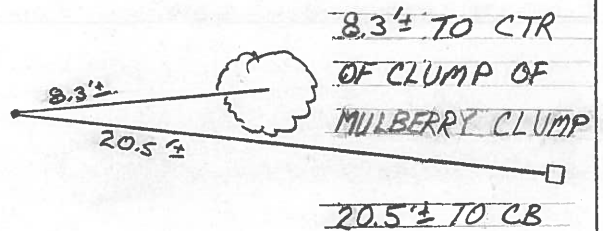
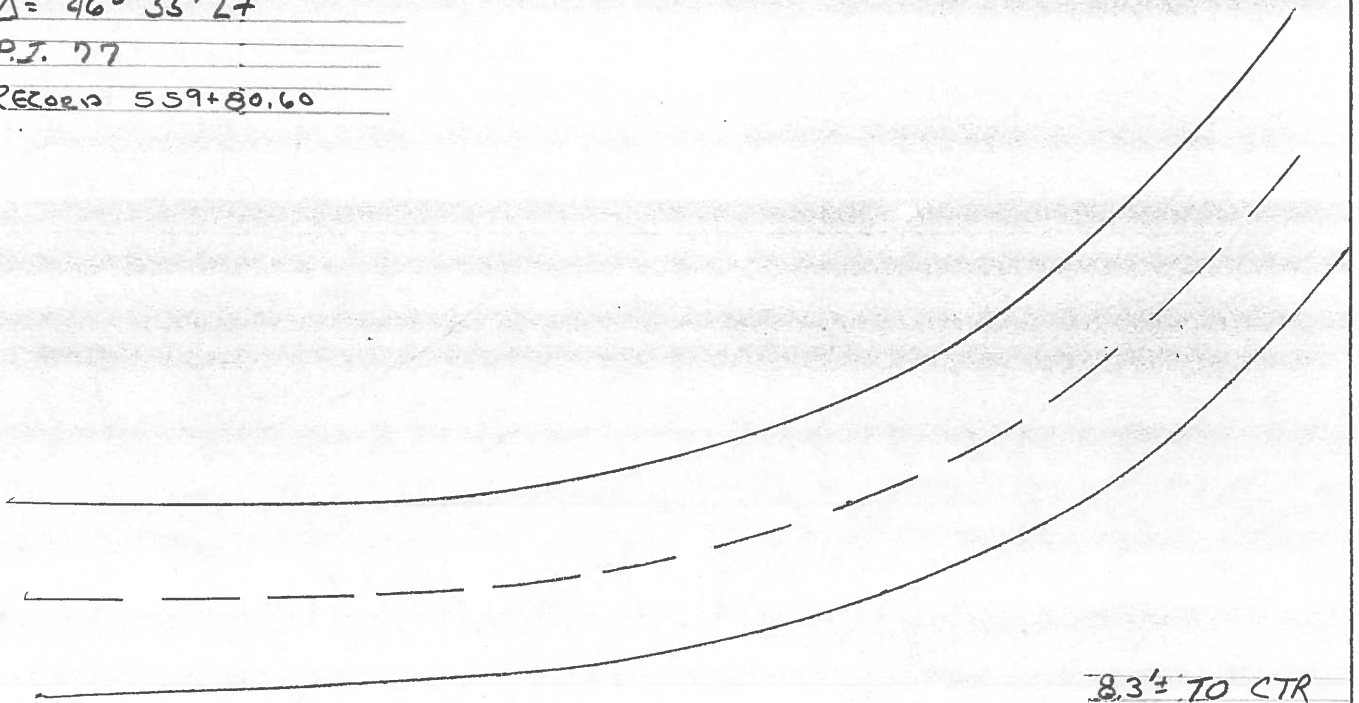

County WOOD S.R. 105

Date 8-10-84

Township FRGEdom

Weather AT CLOUDY

Section 2

Temp. +79

TSN, RIZE

Personnel	<u>BARNHISEZ</u>	<u>HC</u>
	<u>HOUSEHOLDER</u>	<u>RC</u>
	<u>LOEHRKE</u>	<u>ED</u>
	<u>Holtman</u>	<u>Y</u>

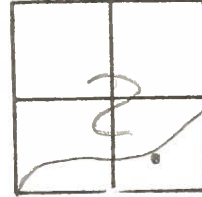

#86

RECORD  
 559+80.60  
 PI, 77  
 Δ = 46°-55'14"

Fd: IRON Rod  
 34.5' RT & PAUT  
 26.0' RT of REP  
 SLM 556+30

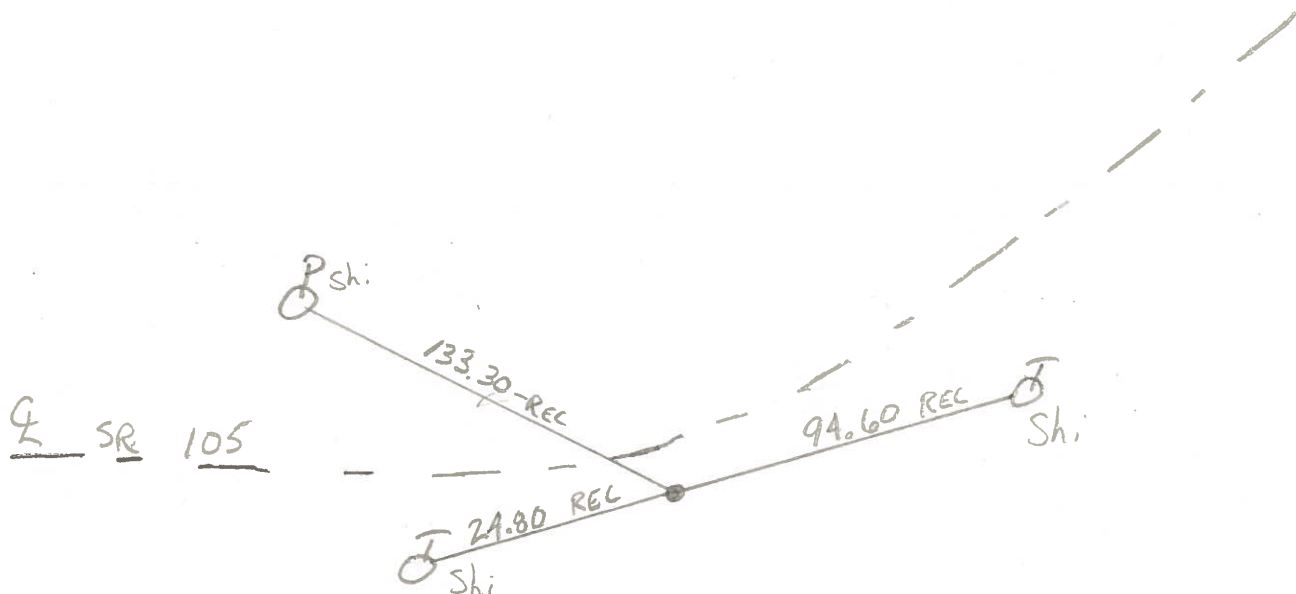

PERSONNEL	TITLE	PERSONNEL	TITLE	COUNTY	DATE	WEATHER	TEMP.
Stone				Wood	Mar 7, 74	Mild	63°
Denno				S. R. 105			
Curtis				SEC.			

DESCRIPTION References to Control Points JOB NO. \_\_\_\_\_

