

O.D.O.T. DISTRICT 2 SURVEY OFFICE (USE ONLY)

PERSONNEL	REFERENCE NO.	<u>2 A</u>	SHEET	<u>4</u>	OF	<u>24</u>
NOTES	RHOADES	DATE	<u>5-6-13</u>	ROUTE	<u>SR 199</u>	
H.C.	<u>CODER</u>	WEATHER	<u>CLOUDY</u>	COUNTY	<u>WOOD</u>	
R.C.	<u>ROUSOS</u>	TEMP.	<u>55°</u>	TOWNSHIP	<u>PERRY</u>	
				SECTION	<u>36</u>	
				T	<u>3</u>	R
					<u>N</u>	<u>12</u>
					<u>E</u>	

TYPE MONUMENT P.K./WASHER  
 ON SURFACE - ~~BELOW~~ ON  
 LEFT - ℄ PAV'T - ~~RIGHT~~ 1.9'  
10.1 TO LT EDGE PAVEMENT  
 S.L.M. 51+99.28  
 Grid: Northing: 552272.834 Easting: 1713062.930

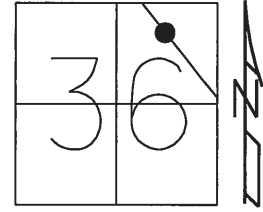

RECORD:  
 FD SM.R.R.SPIKE  
 7/14/88, CL  
 SET P.K./WASHER  
 7/30/90, CL  
 FD P.K./WASHER  
 REFA2  
 10/12/11, MC  
 SET MAG/WASHER  
 FINREFA2  
 4/28/14, TMR

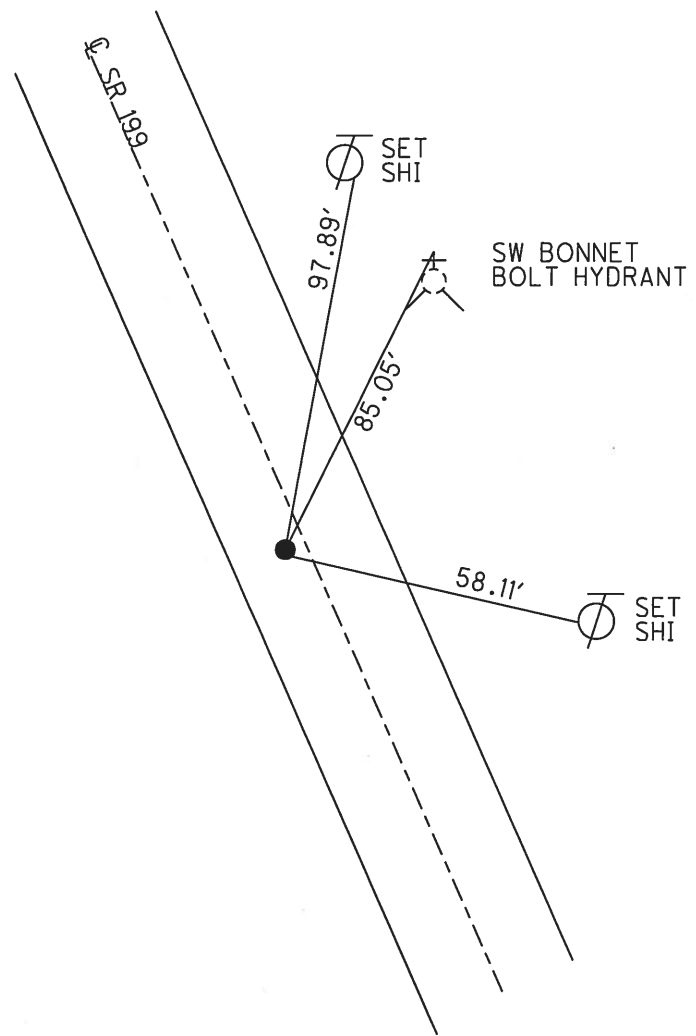

# O.D.O.T. DISTRICT 2 SURVEY OFFICE

PERSONNEL \_\_\_\_\_

REFERENCE NO. 2-A

SHEET \_\_\_\_\_ OF \_\_\_\_\_

NOTES LOHRKE

H.C. BARAHISEL

R.C. Reed

DATE 7-14-88

WEATHER Cloudy Hazy

TEMP. +85

ROUTE 199

COUNTY WOOD

TOWNSHIP PERRY

SECTION 36

T 3 N R 12 E

TYPE MONUMENT Sm R.R. Spike

ON SURFACE - BELOW \_\_\_\_\_

LEFT- & PAV'T. - RIGHT 1.9

10.1 TO Lt EDGE PAVEMENT

S.L.M. 50 too

Set P.K./WASHER  
7-30-90  
C.L.

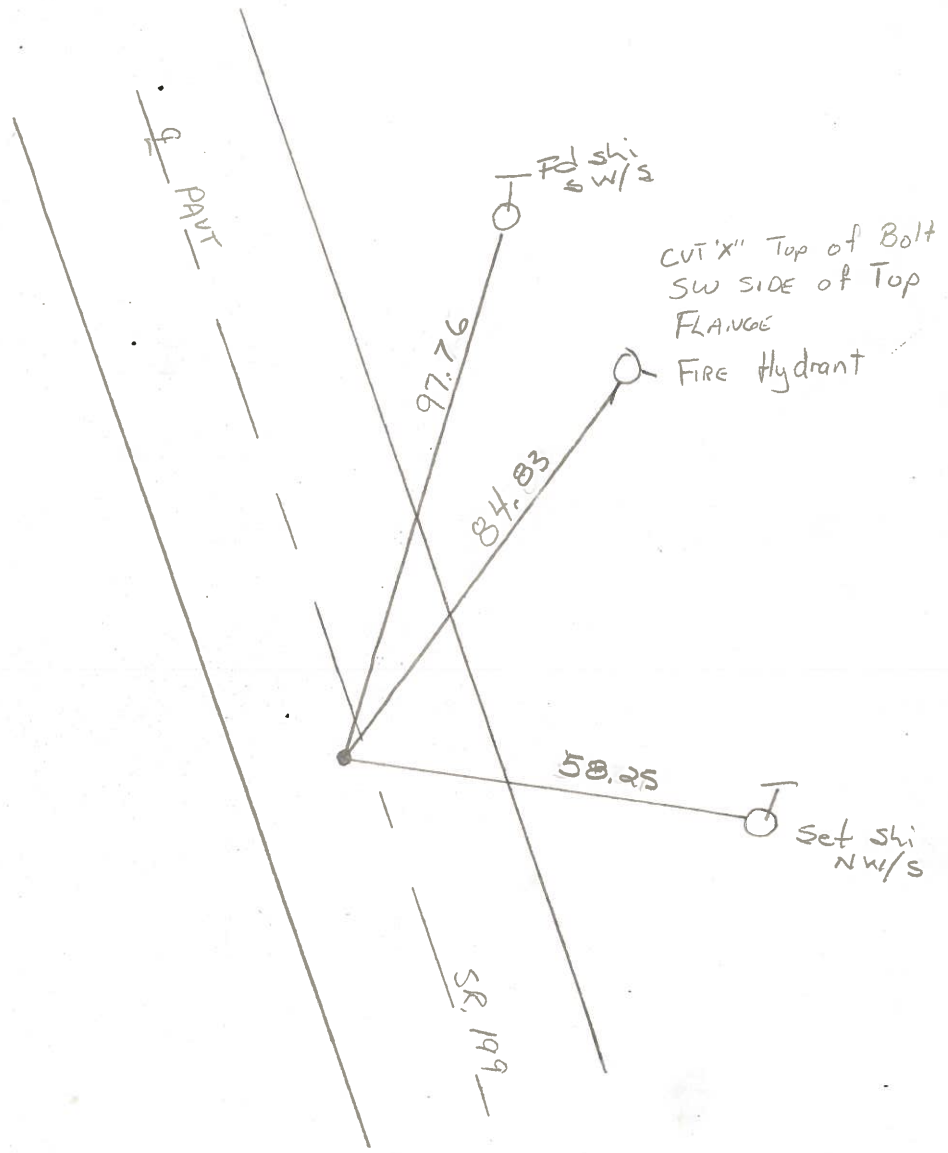
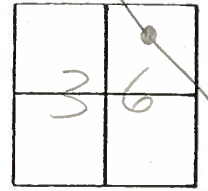

O.D.O.T. DISTRICT 2 SURVEY OFFICE

Sht. 3 of  
S.R. 199

County WOOD

Date 7-21-78

Township PERRY

Weather PT. CLEAR

Section 36

Temp. +90°

T3N, R12E

Personnel BURNSIDE

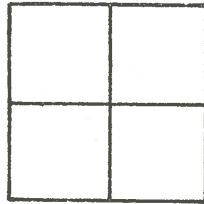

BOWERS

KNAPP

CURTIS

#2-A

P.O.T.  
STA. 50+00  
FD. R.R. SPK. 1/2" DEEP  
& 1.5' ± LT. OF CTR. PAVE

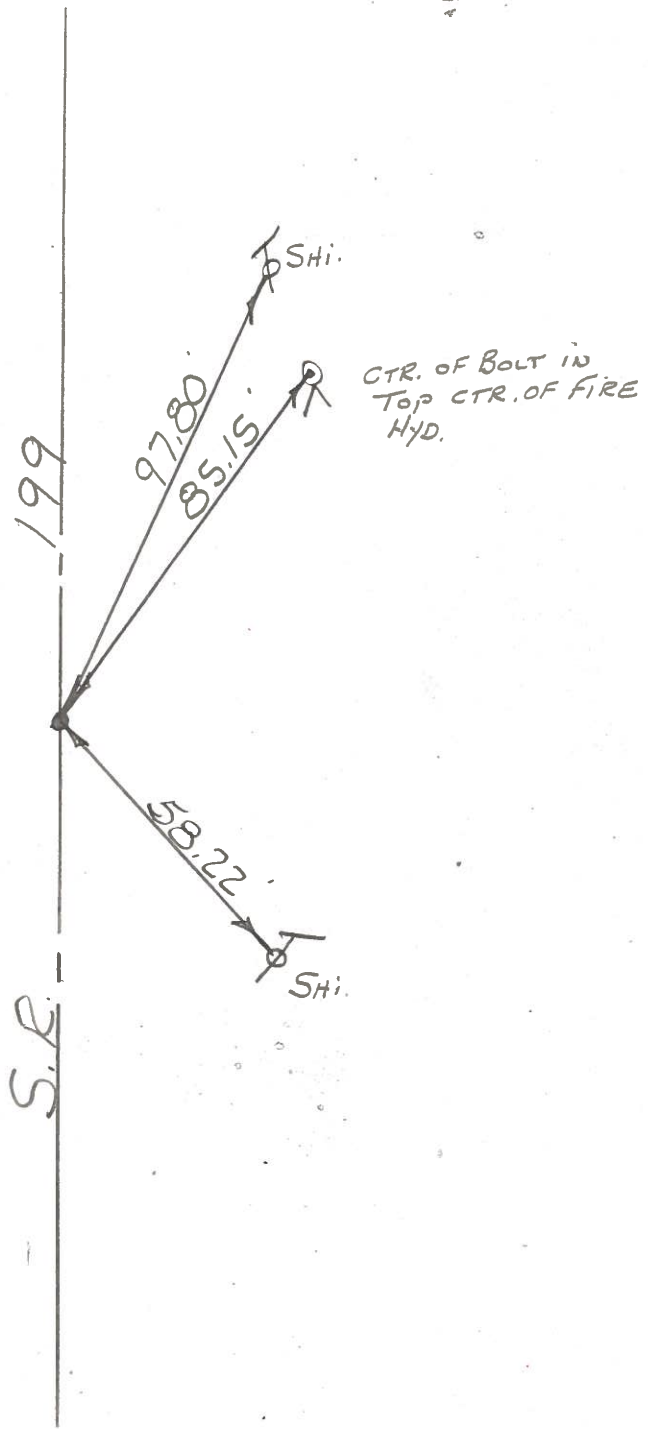

PERSONNEL	TITLE	PERSONNEL	TITLE
BURNSIDE			
SMITH			
BOWERS			

COUNTY WOOD DATE 1-10-72  
 S. R. 199 WEATHER CLEAR  
 SEC. \_\_\_\_\_ TEMP. +45°

DESCRIPTION \_\_\_\_\_ LEFT \_\_\_\_\_ CENTER LINE \_\_\_\_\_ RIGHT \_\_\_\_\_ JOB NO. \_\_\_\_\_

