

O.D.O.T. DISTRICT 2 SURVEY OFFICE (USE ONLY)

PERSONNEL _____ REFERENCE NO. 10 A SHEET 15 OF 24
 NOTES ROUSOS DATE 5-6-13 ROUTE SR 199
 H.C. HOMAN WEATHER FAIR COUNTY WOOD
 R.C. GABLE TEMP. 65° TOWNSHIP PERRY
 _____ SECTION 14
 _____ T 3 N R 12 E

TYPE MONUMENT P.K.SHANK
~~ON SURFACE~~ - BELOW 1"
 LEFT - ☉ PAV'T - ~~RIGHT~~ 1.4'
9.7 TO LT EDGE PAVEMENT
 S.L.M. 201+50.50
 Grid: Northing: 565104.810 Easting: 1705764.248

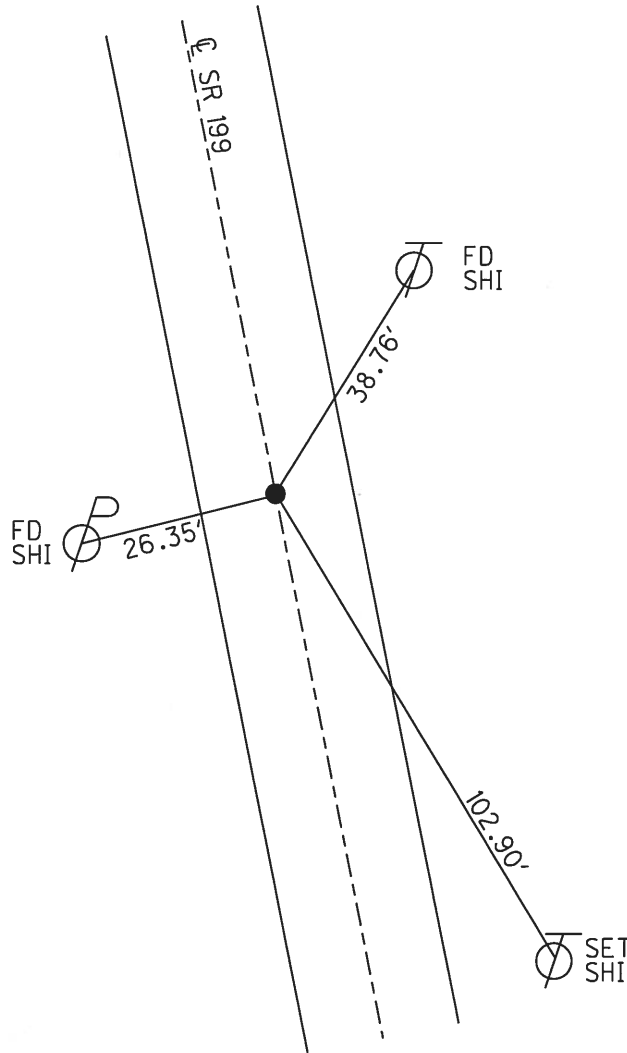
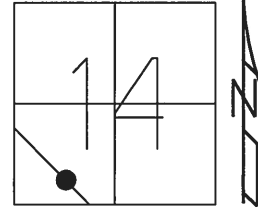

RECORD:
 FD P.K.NAIL
 7/11/88, CL
 SET P.K./WASHER
 7/30/90, CL
 FD P.K.SHANK
 REFA10
 10/13/11, MC
 D.N.SET
 TIES GONE
 4/29/14, TMR

O.D.O.T. DISTRICT 2 SURVEY OFFICE

PERSONNEL _____

REFERENCE NO. A10A

SHEET _____ OF _____

NOTES LOCHAKE

H.C. BARNHISEE

R.C. Reed

DATE 7-11-88

WEATHER pt Cloudy

TEMP. +50

ROUTE 199

COUNTY Wash

TOWNSHIP Perry

SECTION 14

T. 3 N R. 12 E

TYPE MONUMENT P.C.K. NAIL

ON SURFACE - BELOW 1" Below

LEFT - CL PAV'T. - RIGHT 1.4 RT

9.7 TO Lt EDGE PAVEMENT

S.L.M. 199+60

Set P.K. / WASHER
7-30-90
C.L.

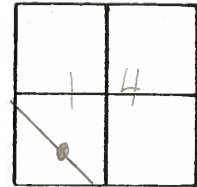

10A

