

O.D.O.T. DISTRICT 2 SURVEY OFFICE (USE ONLY)

PERSONNEL

REFERENCE NO. 52

SHEET 5 OF 78

NOTES HUSS

DATE 6/23/11

ROUTE SR 199

H.C. HUSS

WEATHER CLOUDY/RAIN

COUNTY WOOD

R.C. CANTERBURY

TEMP. 70°

TOWNSHIP FREEDOM

SECTION 20

DWG BY NIESE PID 107613

T 5 N R 12 E

TYPE MONUMENT P.K./WASHER

ON SURFACE - ~~BELOW~~ ON

OFFSET 0.2' ET : RT

- TO - EDGE PAVEMENT

STATION: 888+86.67

HORIZ.DATUM: NAD83(2011)

GEOID: NAVD88 2012A

GRID: NORTHING: 624650.899

EASTING: 1690593.554

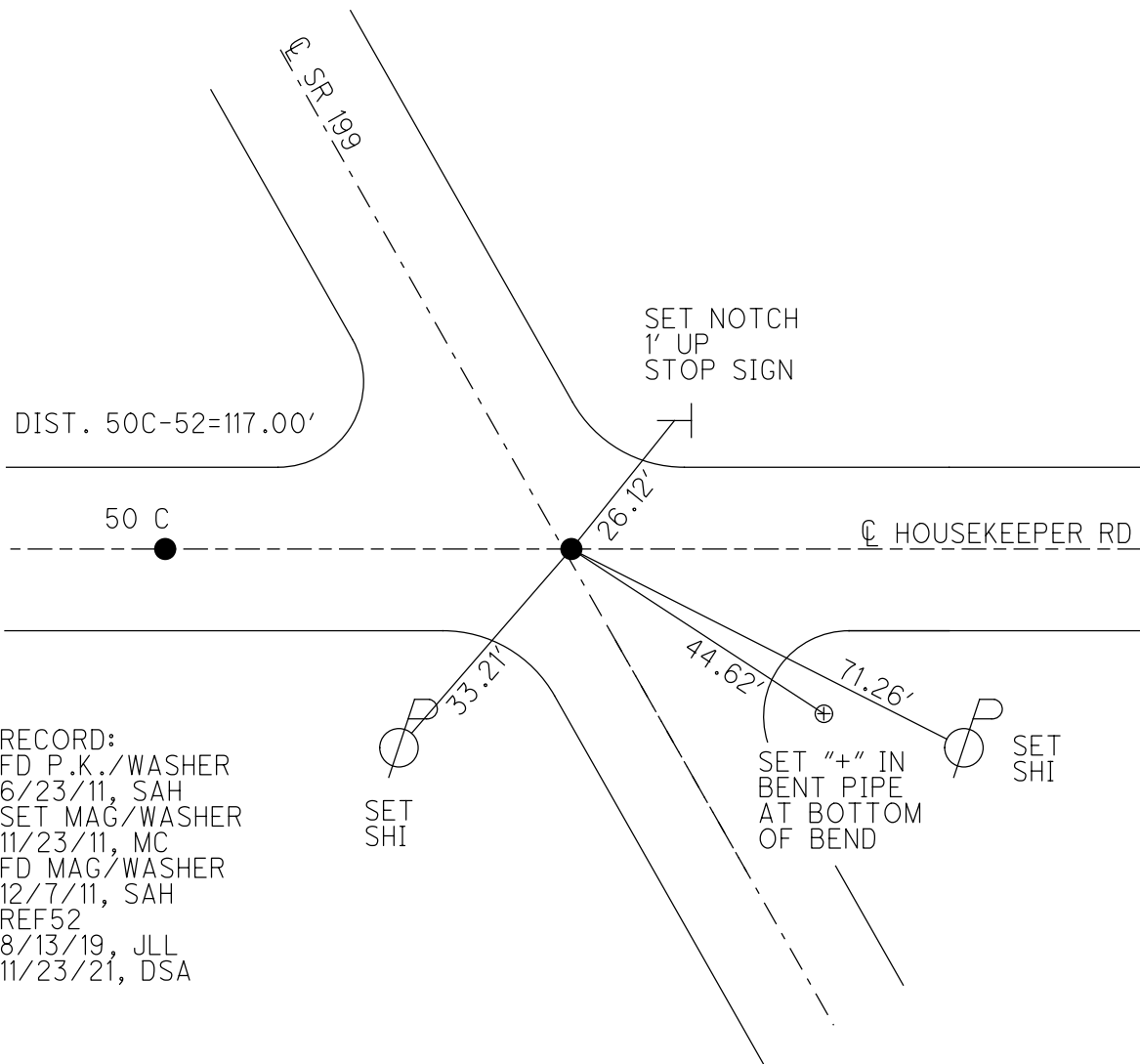
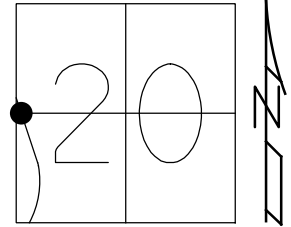

RECORD:
 FD P.K./WASHER
 6/23/11, SAH
 SET MAG/WASHER
 11/23/11, MC
 FD MAG/WASHER
 12/7/11, SAH
 REF52
 8/13/19, JLL
 11/23/21, DSA

O.D.O.T. DISTRICT 2 SURVEY OFFICE (USE ONLY)

PERSONNEL	REFERENCE NO.	52	SHEET	6	OF	72
NOTES	HUSS	DATE	6/23/11	ROUTE	SR 199	
H.C.	HUSS	WEATHER	CLOUDY/RAIN	COUNTY	WOOD	
R.C.	CANTERBURY	TEMP.	70°	TOWNSHIP	FREEDOM	
				SECTION	20	
				T	5	N
				R	12	E

TYPE MONUMENT _____ PK/WASHER _____
 ON SURFACE - ~~BELOW~~ _____ ON _____
~~LEFT~~ - ~~PAV'T~~ - RIGHT _____ 0.2' _____
 _____ TO _____ EDGE PAVEMENT _____
 S.L.M. _____ 888+86.67 _____

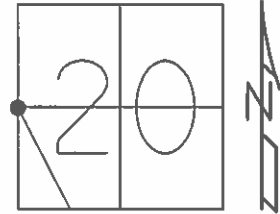

GRID: NORTHING: 624650.925 EASTING: 1690593.521

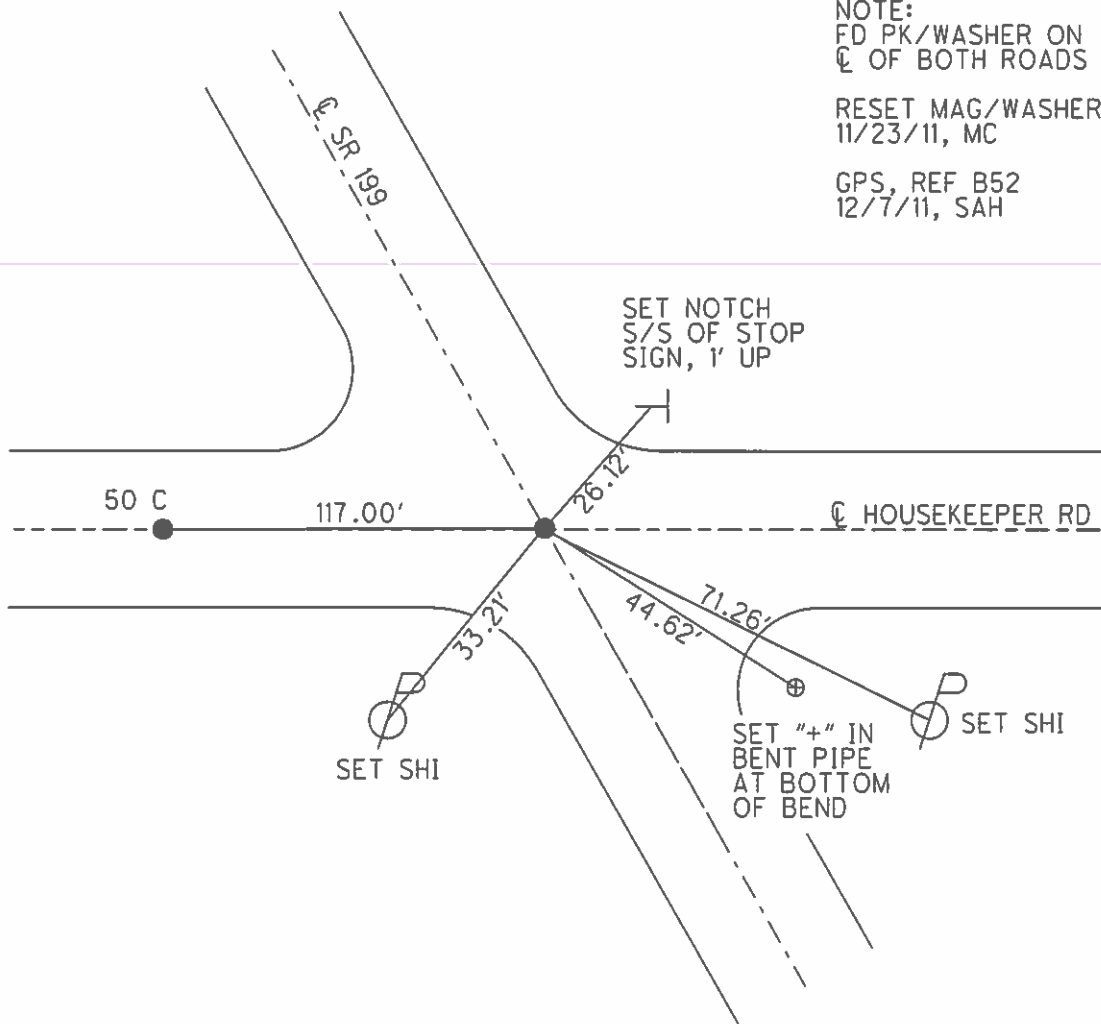

NOTE:
 FD PK/WASHER ON
 C OF BOTH ROADS
 RESET MAG/WASHER
 11/23/11, MC
 GPS, REF B52
 12/7/11, SAH