

O.D.O.T. DISTRICT 2 SURVEY OFFICE (USE ONLY)

PERSONNEL

REFERENCE NO. 55 B

SHEET 17 OF 78

NOTES NIESE DATE 8/26/21
 H.C. AUBLE WEATHER SUNNY
 R.C. NIESE TEMP. 79°

ROUTE SR 199
 COUNTY WOOD
 TOWNSHIP WEBSTER
 SECTION 18
 T 5 N R 12 E

DWG BY NIESE PID 107613

TYPE MONUMENT MAG/WASHER

ON SURFACE - ~~BELOW~~ ON

OFFSET 0.5' LT : ~~RT~~
10.1' TO LT EDGE PAVEMENT

STATION: 967+00.87

HORZ.DATUM: NAD83(2011)

GEOID: NAVD88 2012A

GRID: NORTHING: 632221.614

EASTING: 1688657.816

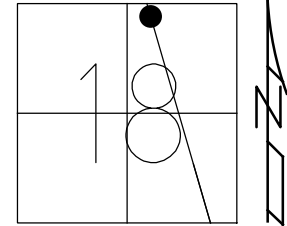

RECORD:
 SET SM.R.R.SPIKE
 9/4/87, MDB
 FD SM.R.R.SPIKE
 2/1/10
 6/23/11, SAH
 SET MAG/WASHER
 11/23/11, MC
 FD MAG/WASHER
 12/7/11, SAH
 REFB55
 8/7/19, JLL
 8/26/21, DSA
 11/23/21, DSA

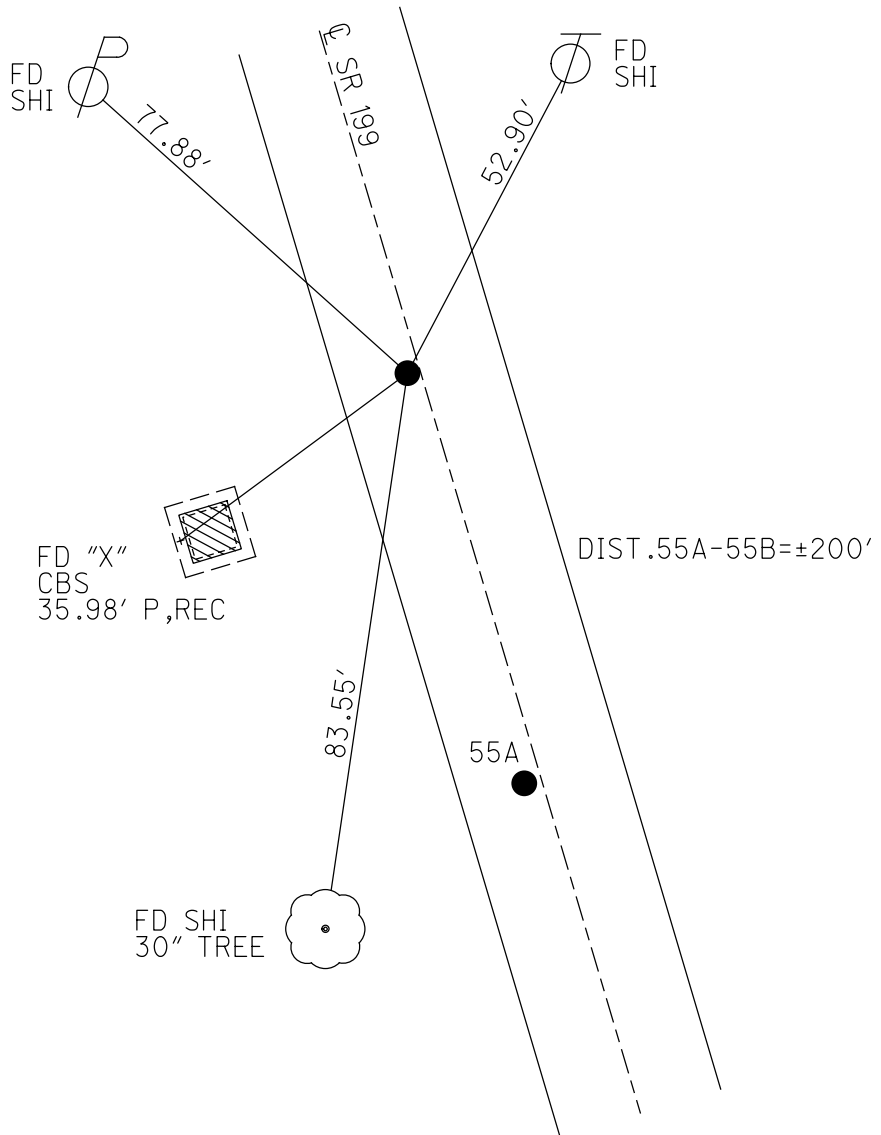

O.D.O.T. DISTRICT 2 SURVEY OFFICE (USE ONLY)

PERSONNEL _____ REFERENCE NO. 55 B SHEET 14 OF 72
 NOTES HUSS DATE 6/23/11 ROUTE SR 199
 H.C. HUSS WEATHER CLOUDY/RAIN COUNTY WOOD
 R.C. CANTERBURY TEMP. 71° TOWNSHIP WEBSTER
 _____ SECTION 18
 _____ T 5 N R 12 E

TYPE MONUMENT _____ SM RR SPIKE
 ON SURFACE - ~~BELOW~~ _____ ON
 LEFT - ~~C PAVT~~ - RIGHT _____ 0.5'
10.1' TO LT. EDGE PAVEMENT
 S.L.M. _____ 967+00.87

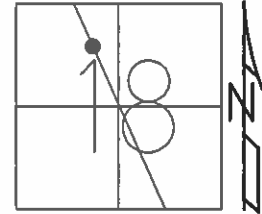

GRID: NORTHING: 632221.563 EASTING: 1688657.770

