

O.D.O.T. DISTRICT 2 SURVEY OFFICE (USE ONLY)

PERSONNEL \_\_\_\_\_ REFERENCE NO. 34 SHEET 1 OF 10  
 NOTES AUBLE DATE 9/5/19 ROUTE SR 281  
 H.C. LEU WEATHER SUNNY COUNTY WOOD  
 R.C. NASON TEMP. 60° TOWNSHIP PORTAGE  
 \_\_\_\_\_ NIESE SECTION 22  
 DWG BY NIESE PID 102824 T 4 N R 11 E

TYPE MONUMENT MAG/WASHER  
 ON SURFACE - ~~BELOW~~ ON  
 OFFSET 7.7' ~~RT~~ : RT  
3.4' TO RT EDGE PAVEMENT  
 STATION: 824+46

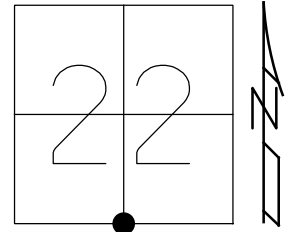

HORIZ.DATUM: NAD83(2011) GEOID: 2012A  
 GRID: NORTHING: 590426.678 EASTING: 1670787.347

RECORD:  
 STA 824+02.58  
 Δ = 0°29' LT  
 FD BRASS PLATE  
 IMBEDDED IN CONC.  
 "SEC.22 824+02.58"  
 FD SM.R.R.SPIKE  
 7/1/02, TMR  
 SET MAG NAIL  
 2/20/03, DCH  
 FD MAG NAIL  
 REF34  
 11/14/16 JLL  
 SET MAG/WASHER  
 9/5/19, JLL

BRIDGE NO.  
 WOO-281-15.61  
 ECKERT DITCH

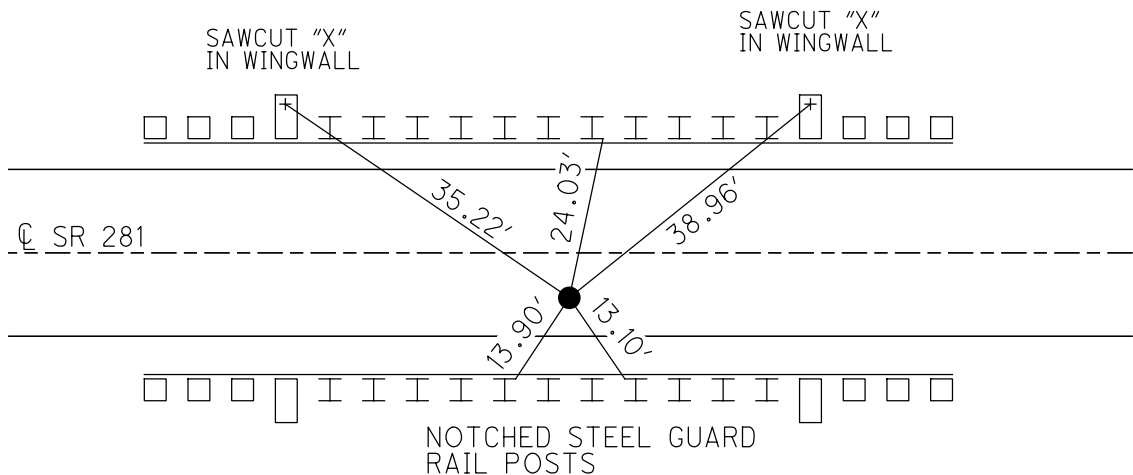

**O.D.O.T. DISTRICT 2 SURVEY OFFICE (USE ONLY)**

PERSONNEL \_\_\_\_\_ REFERENCE NO. 34 SHEET 2 OF 9  
 NOTES ROUSOS DATE 7/1/02 ROUTE SR 281  
 H.C. ROUSOS WEATHER SUNNY COUNTY WOOD  
 R.C. HOMAN TEMP. 93° TOWNSHIP PORTAGE  
 SECTION 22  
 T 4 N R 11 E

TYPE MONUMENT SM.R.R.SPIKE  
 ON SURFACE - ~~BELOW~~ ON  
~~LEFT~~ - CL PAV'T - RIGHT 7.7'  
3.4' TO RT EDGE PAVEMENT  
 S.L.M. 824+46

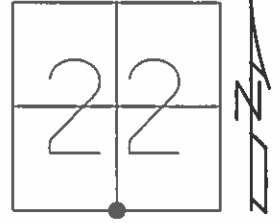

Grid: Northing: \_\_\_\_\_ Easting: \_\_\_\_\_

RECORD:  
 STA:824+02.58  
 S 1/4 POST SEC. 22  
 PORTAGE TWP.  
 $\Delta = 0^{\circ}29' \text{ LT}$   
 BRASS PLATE  
 IMBEDDED IN CONC.  
 ECKERT DITCH  
 READING, "SEC.22"  
 824+02.58"

SET MAG NAIL  
 2/20/03, DCH

BRIDGE NO.  
 WOO-281-15.61

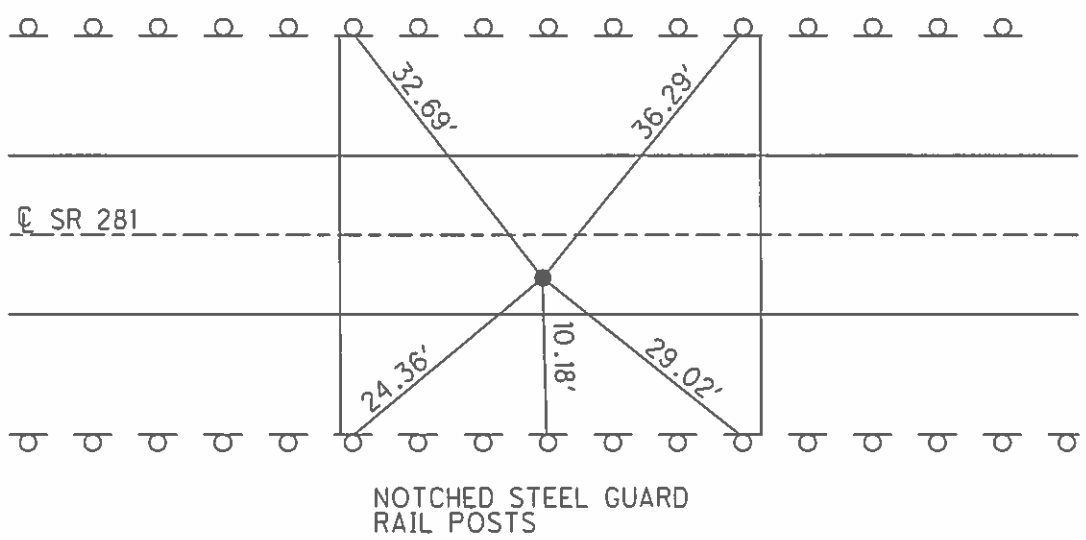

NOTCHED STEEL GUARD  
 RAIL POSTS

O.D.O.T. DISTRICT 2 SURVEY OFFICE

PERSONNEL

REFERENCE NO. 34 SHEET      OF     

NOTES BARNHISEL

H.C. HOFFMAN

R.C. Loehere

DATE 7-27-90

WEATHER SUNNY

TEMP. +82°

ROUTE 281

COUNTY WOOD

TOWNSHIP PORTAGE

SECTION 22

T 4 N R 11 E

TYPE MONUMENT BRASS PLATE

~~ON~~ SURFACE - BELOW 4"

LEFT - & PAV'T. - RIGHT 7.7

34 TO RT EDGE PAVEMENT

S.L.M. 824+46

Set Sm BE Spk  
7-27-90  
MS.

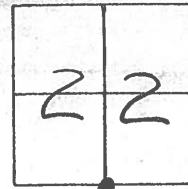

RECORD:

STA: 824+02.58

SkY Post Sec 22

PORTAGE TWP.

Δ = 0°-29' LT

BRASS PLATE Im-  
BEDDED IN CONC.

ECKET DITCH

BRIDGE No.  
WOO-281-15.61

Notched STEEL GUARD  
RAIL POST

BRASS PLATE  
READS:

Sec 22



824+02.58

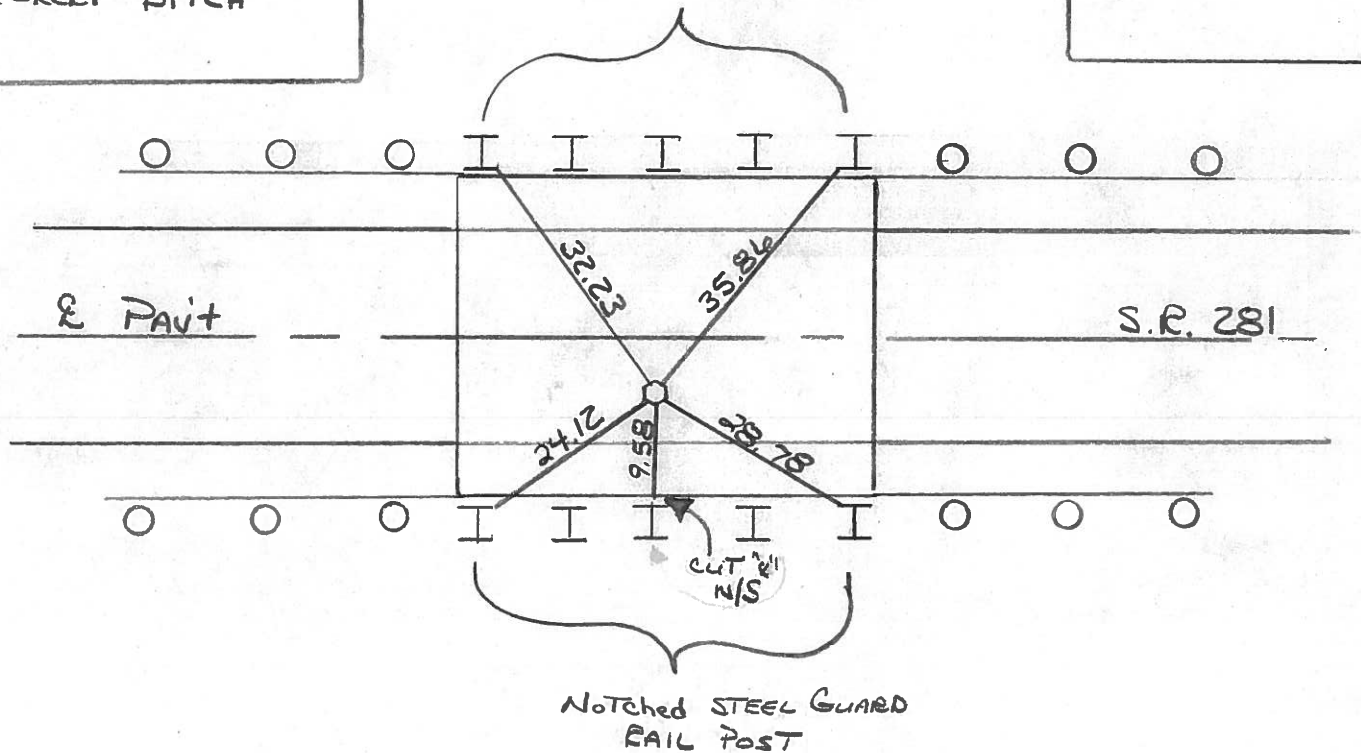

PERSONNEL TITLE PERSONNEL TITLE

COUNTY WOOD DATE OK-8-11-69

S. R. #281 WEATHER

SEC. 21 & 22 TEMP.

DESCRIPTION CONTROL TIES JOB NO.

LEFT	CENTER LINE	RIGHT
<p>STA. 824+02.58 S. 1/4 Post SEC. 22 PORTAGE Twp. <math>\Delta = 0^\circ - 29' LT.</math> BRASS PLATE IMBEDDED IN CONC. ECKERT DITCH</p> <p>#173</p>	<p>#34 OK 4-14-77 28</p>	<p>NEAR EDGE STEEL GR. RAIL POST N.E. 35.84 NEAR EDGE STEEL GR. RAIL POST S.E. 28.78 NEAR EDGE STEEL GR. RAIL POST: 24.12' NEAR EDGE STEEL GR. RAIL POST N.W. 32.23</p>
<p>STA. 157+62.8 = 797+56.40 S.E. COR. SEC. 21 PORTAGE Twp. STONE - R.R. SPK. HUFFMAN ROAD</p> <p>#172</p> <p>797+63</p>	<p>#33</p> <p>set sh Sut 46.31</p> <p>29.24</p> <p>40.50</p>	<p>"X"-S. END CONC. PIPE S.W. 25.2. <del>SHOWER IN P. POLE</del> N.E. 46.3 "X"-N. END CONC. PIPE N.W. 29.12 <del>SHOWER IN T. POLE</del> S.E. 42.8</p> <p>FD PK surface 4.0 RT &amp; 281 1157 West of Huffman</p> <p>+ 25.35</p> <p>5283 → John Blue Co. Dealer set in Li E/S N Post</p>

PERSONNEL TITLE PERSONNEL TITLE

COUNTY Wood DATE OK 12-5-57

S. R. #281 WEATHER 3-31-60

SEC. TEMP. 8-24-62

JOB NO. 11-1-62 Silvester 2-28-64

DESCRIPTION LEFT CENTER LINE RIGHT

DESCRIPTION	LEFT	CENTER LINE	RIGHT
Sta. 131+23.3		OK	S.W. cor. masonry Hdwl. N.W. 30.
3/4 post sec. 21 Portage			N.W. cor. masonry Hdwl. S.W. 29.3
Twp. set wood Hub			N.E. cor. masonry Hdwl. S.S.W. 26.13' 26.2
from old ties set R.R. spk.			S. E. cor. masonry Hdwl. N.W. 26.4
$\Delta = 0^\circ - 16' Lt.$			26.5
Meas. 5' Road		New Ties 11-1-62	"X" in 2 <sup>nd</sup> stone down from Top @ N. end of S. Culvert wall S.W. 29.27'
<b>32</b>	#171		"X" in 4 <sup>th</sup> stone down from Top @ W. end of N. Culvert wall N.W. 30.45'
Sta. 157+62.8 = 797+56.40		OK	Iron cor. post S.E. 45.2
S.E. cor. sec. 21 Portage			"X" 5' end conc. pipe S.W. 26.1
twp. Stone		set R.R. spk.	conc. man S.W. ?
Huffman Road		from Ties	Shiner in P.P. N.E. 41.6
<b>33</b>	#172		Shiner in Br. Pole N.W. 30.6
Sta. 824+02.58 meas.		OK	Near edge steel Gr. Rail Post N.E. 35.84
$\Delta = 0^\circ - 29' Lt. meas.$			Near edge steel Gr. Rail Post S.W. 28.78
5/4 post sec. 22 Portage			Near edge steel Gr. Rail Post S. 24.12
Twp. Eckerl Ditch			Near edge steel Gr. Rail Post N. 32.23
Brass Plate imbedded in Conc.		(exposed)	
$\Delta = 0^\circ - 29' Lt.$			
<b>34</b>	#173		
Sta. 850+45.43		OK	Shiner in P. Pole S.S.E. 95.78'
S.E. cor. sec. 22 Portage			"X" cut in S.E. cor. C.B. Top S.W. 49.64'
Twp. Stone with brick on top.		set R.R. spk. set.	"X" cut in North end 66" Conc. Pipe N. Plumbed 59.30'
$\Delta = 0^\circ - 47' Lt. meas.$			
Cloverdale Rd.			
<b>35</b>	#174		

Note: (2' down from top)