

O.D.O.T. DISTRICT 2 SURVEY OFFICE (USE ONLY)

PERSONNEL _____ REFERENCE NO. 51 D SHEET 39 OF 51
 NOTES NIESE DATE 6/14/23 ROUTE SR 281
 H.C. AUBLE WEATHER SUNNY COUNTY WOOD
 R.C. BEJARANO TEMP. 70° TOWNSHIP MONTGOMERY
 _____ MILLER SECTION 11
 DWG BY RHOADES PID CHIP SEAL T 4 N R 12 E

TYPE MONUMENT MAG/WASHER
 ON SURFACE - ~~BELOW~~ ON
 OFFSET ☉ PAVEMENT ON LT : RT
- TO - EDGE PAVEMENT
 STATION: 1267+57

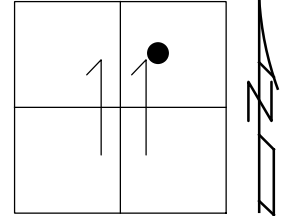

HORZ. DATUM: NAD83 2011 GEOID: NAVD88 2018
 GRID: NORTHING: 604292.420 EASTING: 1709107.850

RECORD:
 FD SM.R.R.SPIKE
 8/9/10, SAH
 D51, 11/17/10
 SET MAG/WASHER
 7/27/12, SDC
 REFD51
 7/31/12, SAH
 FD MAG/WASHER
 REF51D
 6/14/23
 10/20/23, TDN

WOOD LPD:
 N: 426882.767
 E: 220523.828

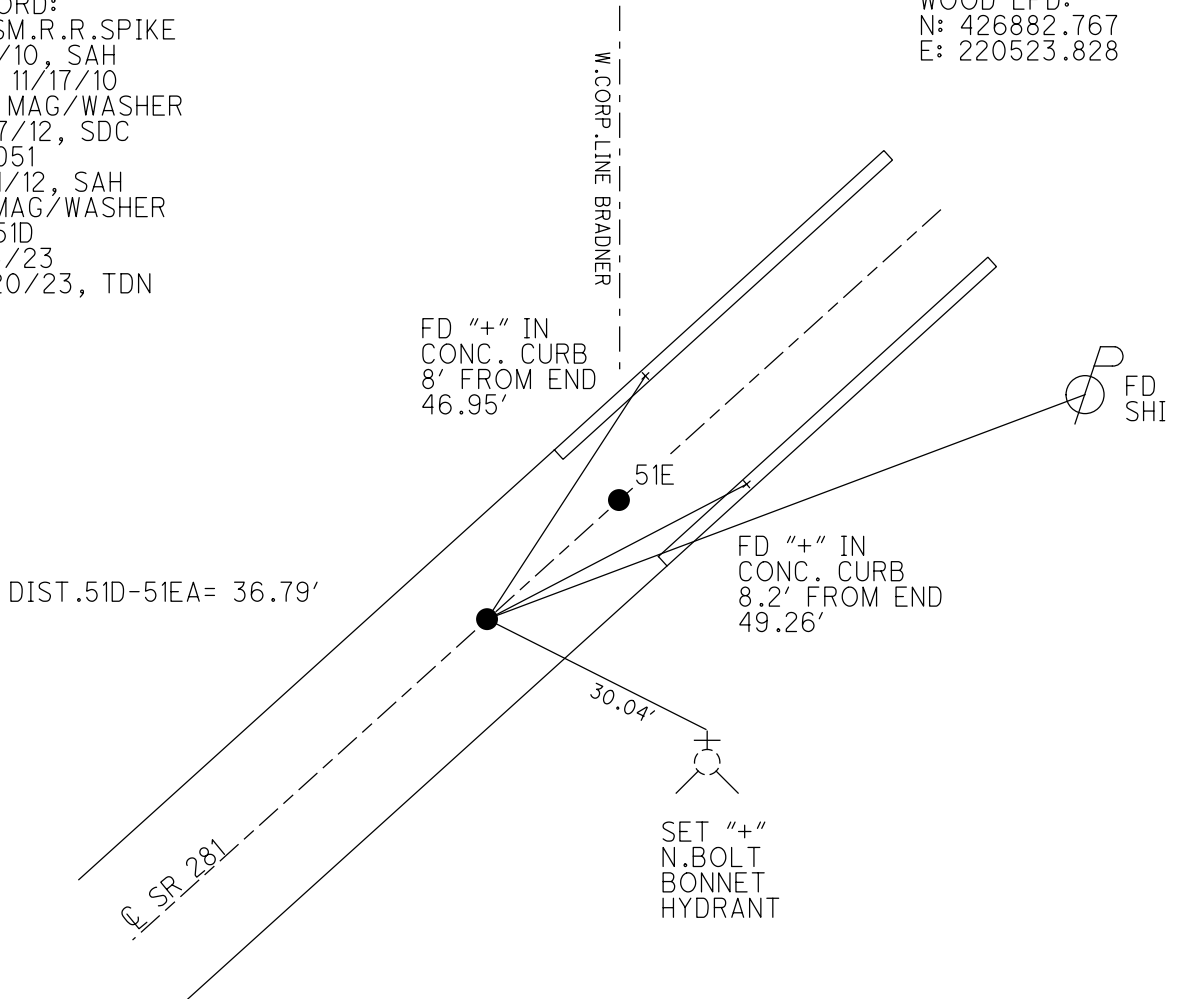

O.D.O.T. DISTRICT 2 SURVEY OFFICE (USE ONLY)

PERSONNEL _____

REFERENCE NO. 51 D

SHEET 37 OF 49

NOTES HUSS

DATE 4/2/12

ROUTE SR 281

H.C. CANTERBURY

WEATHER CLOUDY

COUNTY WOOD

R.C. HARBAUGH

TEMP. 58°

TOWNSHIP MONTGOMERY

SECTION 11

T 4 N R 12 E

TYPE MONUMENT SM.R.R.SPIKE

ON SURFACE - ~~BELOW~~ ON

LEFT - Q PAV'T - RIGHT ON

- TO - EDGE PAVEMENT

S.L.M. 1267+57

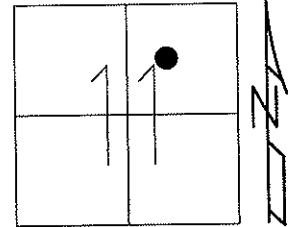

Grid: Northing: 604292.371 Easting: 1709107.811

FD SM.R.R.SPIKE
8/9/10, SAH

GPS, D51, 11/17/10

SET MAG/WASHER
7/27/12, SDC

FINAL REF D51
7/31/12, SAH

