

LIMITED ACCESS

This improvement is especially designed for through traffic and has been declared a limited access highway or freeway by action of the Director of Highways in accordance with the provisions of Section 5511.02 of the Revised Code of Ohio.

STATE OF OHIO  
DEPARTMENT OF HIGHWAYS

I-475-7(25)193

FED. RD. DIVISION	STATE	PROJECT
5	OHIO	I-475-7(25)193

1/36

W00-475-(0.05-0.67)  
LUC-475-(0.00-15.63)

MICROFILMED  
MAR 26 1979

W00-475-(0.05-0.67)  
PERRYSBURG TOWNSHIP  
WOOD COUNTY

LUC-475-(0.00-15.63)  
MONCLOVA, SPRINGFIELD & SYLVANIA TOWNSHIPS  
CITY OF MAUMEE & CITY OF TOLEDO  
LUCAS COUNTY

CONVENTIONAL SIGNS

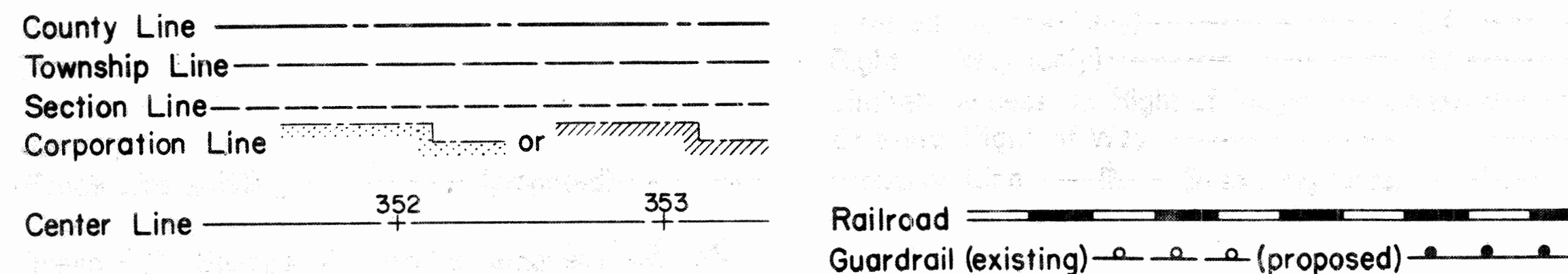

INDEX OF SHEETS

Title Sheet	1
Schematic Plan & Design Designation	2
General Notes	3
Subsummaries & General Summary	4
Plan Sheets	5-14
Drainage Details	15-18
Cross Sections	19-28
Guard Rail Details	29-30
Traffic Control	31-36 & 36A

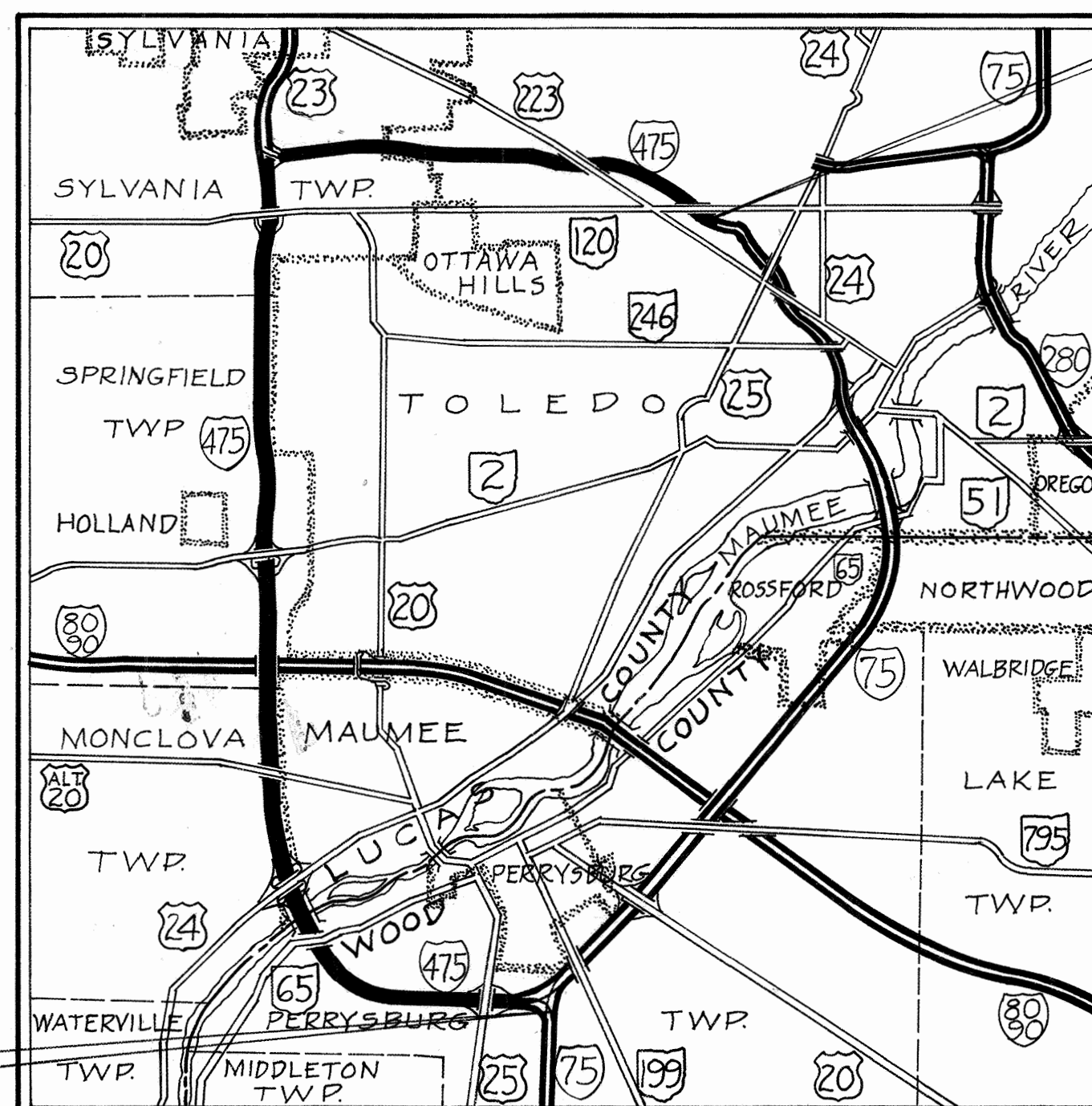

LOCATION MAP

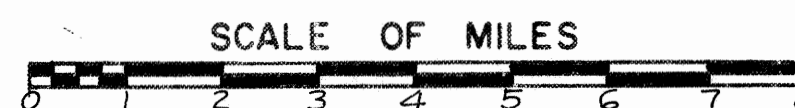

SCALES

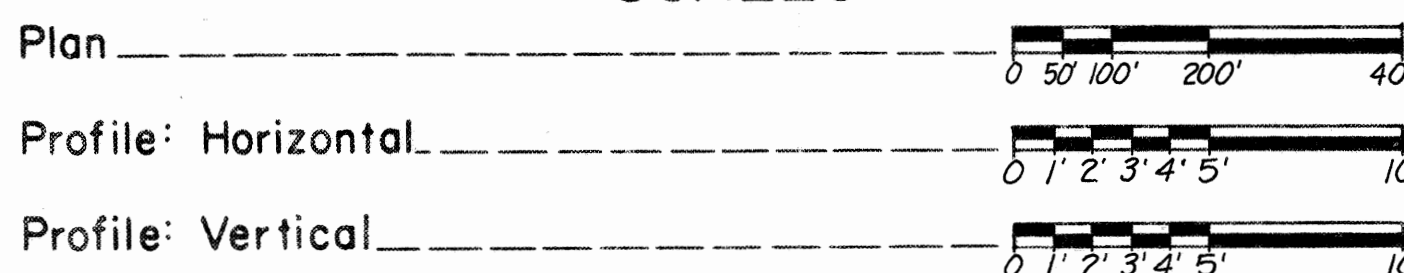

LINE DATA

Begin Work - Sta. 2+41  
End Work - Sta. 826+40  
Deduct for Station Equation = 100 Lin. Ft.  
Length of Work = 103,130.11 Lin. Ft. or 19.532 Mi.  
Work Additions:  
U.S.R. 25 - Sta. 7+43 to Sta. 33+31 — 2588.00 Lin. Ft.  
U.S.R. 24 - Sta. 668+25 to Sta. 725+25 — 5700.00 Lin. Ft.  
U.S.R. 20-A - Sta. 13+25 to Sta. 27+79.50 — 1454.50 Lin. Ft.  
Salisbury Rd. - Sta. 12+70.50 to Sta. 25+81.50 — 1311.00 Lin. Ft.  
Manley Rd. - Sta. 14+11 to Sta. 21+23.50 — 712.50 Lin. Ft.  
S.R. 2 - Sta. 7+75 to Sta. 31+75 — 2400.00 Lin. Ft.  
Bancroft St. - Sta. 14+05 to Sta. 25+86.50 — 1181.50 Lin. Ft.  
U.S.R. 23 - Sta. 505+50 to Sta. 539+81 — 3431.00 Lin. Ft.  
Length of Work Additions = 18,778.50 Lin. Ft.  
Total Length of Work = 103,130.11 + 18,778.50 = 121,908.61 Lin. Ft. or 23.088 Mi.  
Length of Project = 0.00 Lin. Ft. or 0.000 Mi.

QUANTITIES	
CALC BY	DATE
Q.C.W.	5-11-72
CKD BY	DATE
C.W.	5-31-72

SUPPLEMENTAL PRINTS OF STANDARD CONSTRUCTION DRAWINGS			
CB-2-5 #2-6	6-1-65	GR-2A	1-1-71
FACI-1	4-20-71	BP-2	12-1-68
FACI-2	4-20-71		
GR-2B	11-9-71		
GR-3	11-9-71		
GR-4	11-9-71		
GR-5	1-1-71		
GR-6	1-1-71		
HW-4	1-1-70		
MC-3	6-20-69		
MC-4	6-13-69		
MH-1	10-1-68		
MH-1A	10-1-68		

SUPPLEMENTAL SPECIFICATIONS	
815	1-1-69
816	1-1-69
941	11-25-70

1971 SPECIFICATIONS

The standard specifications of the State of Ohio, Department of Highways, including changes and supplemental specifications listed in the proposal shall govern this improvement.

The right of way for this improvement will be provided by the State of Ohio.

I hereby approve these plans and declare that the making of this improvement will not require the closing to traffic of the highway and that provisions for the maintenance and safety of traffic will be as set forth on the plans and estimates.

Approved: *James M. Carstensen*  
Date: 8-8-72 Division Deputy Director

Approved: \_\_\_\_\_  
Date: \_\_\_\_\_ Engineer of Bridges

Approved: *E. J. Schaefer*  
Date: 9-8-72 Engineer of Location & Design

Approved: *H. Krause*  
Date: 9/11/72 Deputy Director of Design & Construction

Approved: *Bill Pennington*  
Date: 9/21/72 Deputy Director of Right of Way

Approved: *William Bunkley*  
Date: 9-27-72 Deputy Director of Planning & Programming

Approved: *William P. McKenna*  
Date: 9-27-72 First Assistant Director

Approved: *Phil Suley*  
Date: 9/27/72 Director of Highways

DEPARTMENT OF TRANSPORTATION  
FEDERAL HIGHWAY ADMINISTRATION

APPROVED: \_\_\_\_\_

DIVISION ENGINEER \_\_\_\_\_ DATE \_\_\_\_\_

Project: W00-475-(0.05-0.67) Luc-475-(0.00-15.63)  
Date of Letting: 19\_\_\_\_ Contract No. \_\_\_\_\_

SEAL

BRUNING 44-560 14116

FED. RD. DIVISION	STATE	PROJECT	
2	OHIO		

5  
36

W00-475-(0.05-0.67)  
LUC-475-(0.00-15.63)

# GUARD RAIL TABLE

REF. No.	STATION		SIDE	202		606		ANCHOR ASSEMBLY EACH	BRIDGE TERMINAL ASSEMBLY, TYPE	
	FROM	TO		GUARD RAIL REMOVED FOR REUSE OR STORAGE LIN. FT.	GUARD RAIL REBUILT, TYPE 5 AS PER PLAN LIN. FT.	GUARD RAIL REBUILT, TYPE 5 AS PER PLAN LIN. FT.	E		F	
									EACH	
1-G	2+41 IR475 NB	16+43 IR475 NB	Lt.	25	27	1350				
2-G	4+51 IR475 NB	16+78 IR475 NB	Rt.	25	27	1175				
3-G	19+79 IR475 NB	34+56 IR475 NB	Lt.	25	27	1425				
4-G	19+94 IR475 NB	31+21 IR475 NB	Rt.	25	27	1075				
5-G	17+305 US 23 SB	28+33 US 23 SR	Rt.	25	27.50	1050				
6-G	17+73 US 23 SB	27+00 US 23 SB	Lt.	25	27	875				
7-G	2+72 US 23 SB	14+99 US 23 SB	Rt.	25	27.50	1175				
8-G	6+28 US 23 SB	15+55 US 23 SB	Lt.	25	27.50	875				
TOTALS TO GUARD RAIL SUMMARY				200		217.5	9000	8	4	4

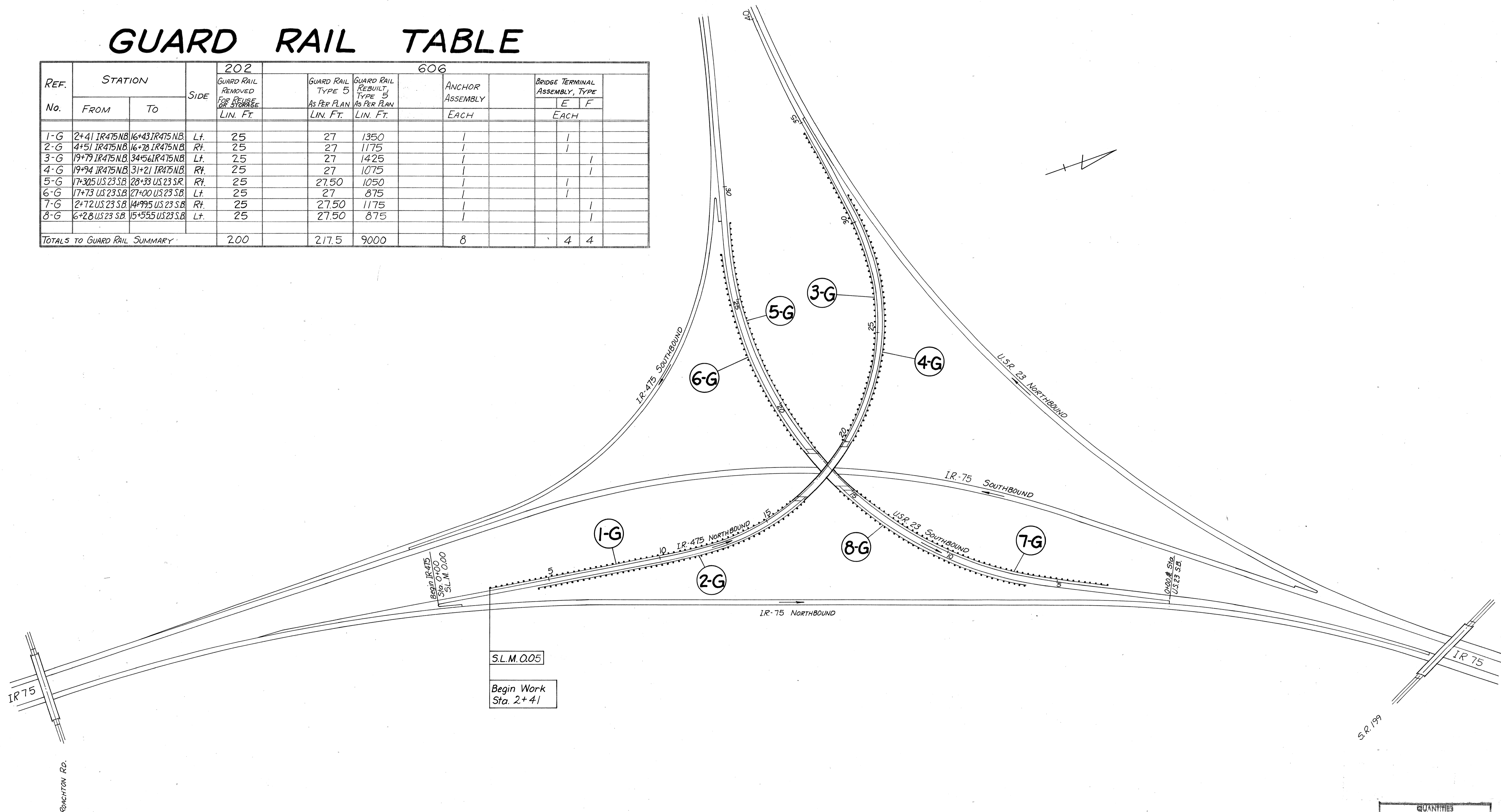

QUANTITIES	
CALC BY JEN	DATE 4-17-72
CKD BY G.W.W.	DATE 5-11-72

STA. 0+00 TO STA. 40+00 - Wood County

FED. RD. DIVISION	STATE	PROJECT
2	OHIO	

6  
36

W00-475-(005-067)  
LUC-475-(0.00-1563)

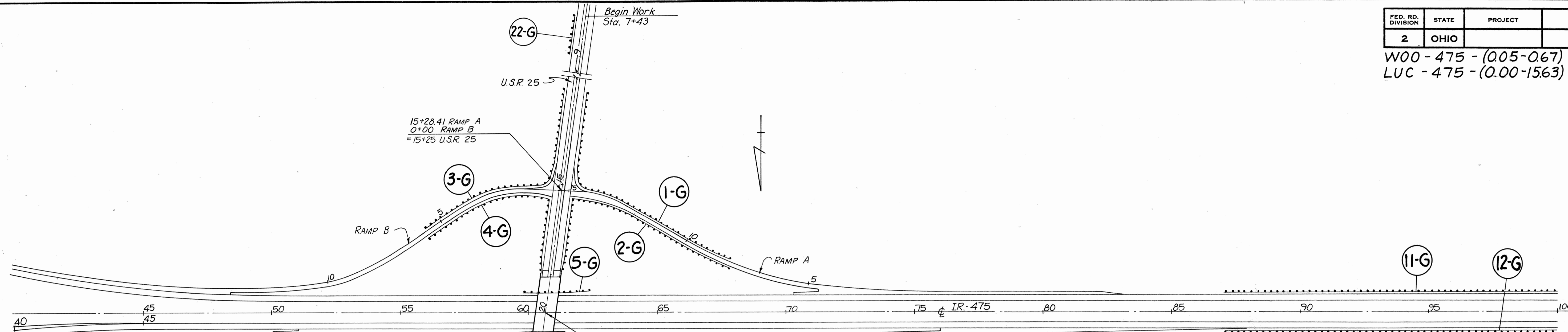

### GUARD RAIL TABLE

REF. NO.	STATION		SIDE	202		606					REMARKS				
	FROM	TO		GUARD RAIL REMOVED FOR REUSE OR STORAGE	BARRIER RAIL REMOVED FOR REUSE OR STORAGE	GUARD RAIL REBUILT, TYPE 5 AS PER PLAN	GUARD RAIL REBUILT, TYPE 5, BARRIER AS PER PLAN	BARRIER RAIL REBUILT, TYPE 5 BARRIER AS PER PLAN	ANCHOR ASSEMBLY	ANCHOR ASSEMBLY BARRIER DESIGN		BRIDGE TERMINAL ASSEMBLY, TYPE			
				LIN. FT.	LIN. FT.	LIN. FT.	LIN. FT.	LIN. FT.	EACH	EACH		C	D	F	
1-G	8+17 Ramp A	11+35 USR 25	Rt.	75*		75*	900			2					
2-G	8+10 Ramp A	18+41 USR 25	Lt.	25		26.50	912.50			1					
3-G	5+67 Ramp B	11+25 USR 25	Rt.	62.50*		62.50*	787.50			2					
4-G	5+75 Ramp B	18+52 USR 25	Lt.	25		26.50	712.50			1					
5-G	59+84 I.R. 475	62+34 I.R. 475	Lt.			12.50	187.50			2					
6-G	58+87 I.R. 475	61+37 I.R. 475	Rt.			12.50	187.50			2					
7-G	8+27 Ramp C	21+59 USR 25	Lt.	25		26.50	850			1					
8-G	8+95 Ramp C	28+27 USR 25	Rt.	100*		75*	787.50			2				25' 202 at Sta. 28+27.5	
9-G	8+87 Ramp D	21+48 USR 25	Lt.	25		26.50	912.50			1					
10-G	8+25 Ramp D	29+55 USR 25	Rt.				975			2					
11-G	87+10 I.R. 475	104+76 I.R. 475	Lt.	25		28.50	1712.50			1					
12-G	87+07.5 I.R. 475	103+86.5 I.R. 475	Rt.	25		29	1625			1					
13-G	101+08 I.R. 475	104+11.5 I.R. 475	Med.	25	25	28.50	125	125						25' 202 at Sta. 28+27.5	
14-G	106+39.91 I.R. 475	113+26.26 I.R. 475	Lt.	50		57.50	628.85							25' 202 at Sta. 28+27.5	
15-G	105+50.21 I.R. 475	113+26.26 I.R. 475	Rt.	50		57	719.05							25' 202 at Sta. 28+27.5	
16-G	106+15.5 I.R. 475	109+19 I.R. 475	Med.	25	25	28.50	125	125							
17-G	110+23 I.R. 475	113+26 I.R. 475	Med.	25	25	28	125	125							
18-G	114+39 I.R. 475	124+54.50 I.R. 475	Lt.	25		28	962.50			1					
19-G	114+39 I.R. 475	124+54.50 I.R. 475	Rt.	25		28	962.50			1					
20-G	114+39 I.R. 475	117+42 I.R. 475	Med.	25	25	28	125	125							
21-G	113+23.51 I.R. 475	113+26 I.R. 475	Med.			2.50								Connect Type 5 to parapet	
22-G	7+43 USR 25	8+93 USR 25	Rt.			100				2					
23-G	32+50 USR 25	33+31 USR 25	Lt.			62.5				1					
TOTALS TO GUARD RAIL SUMMARY						637.50	100	849.5	14322.90	500	23	4	8	2	7

\* Radius guard rail at intersection of ramp & U.S.R. 25

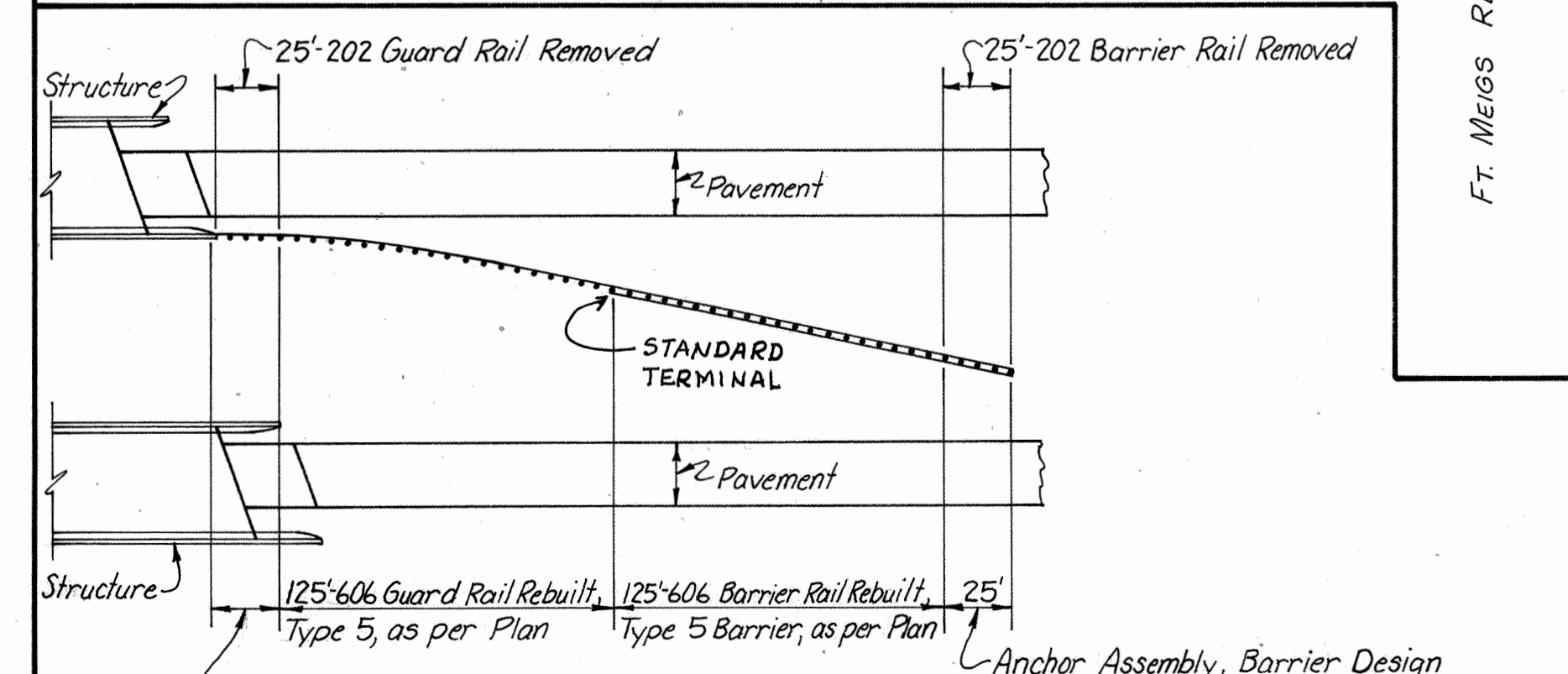
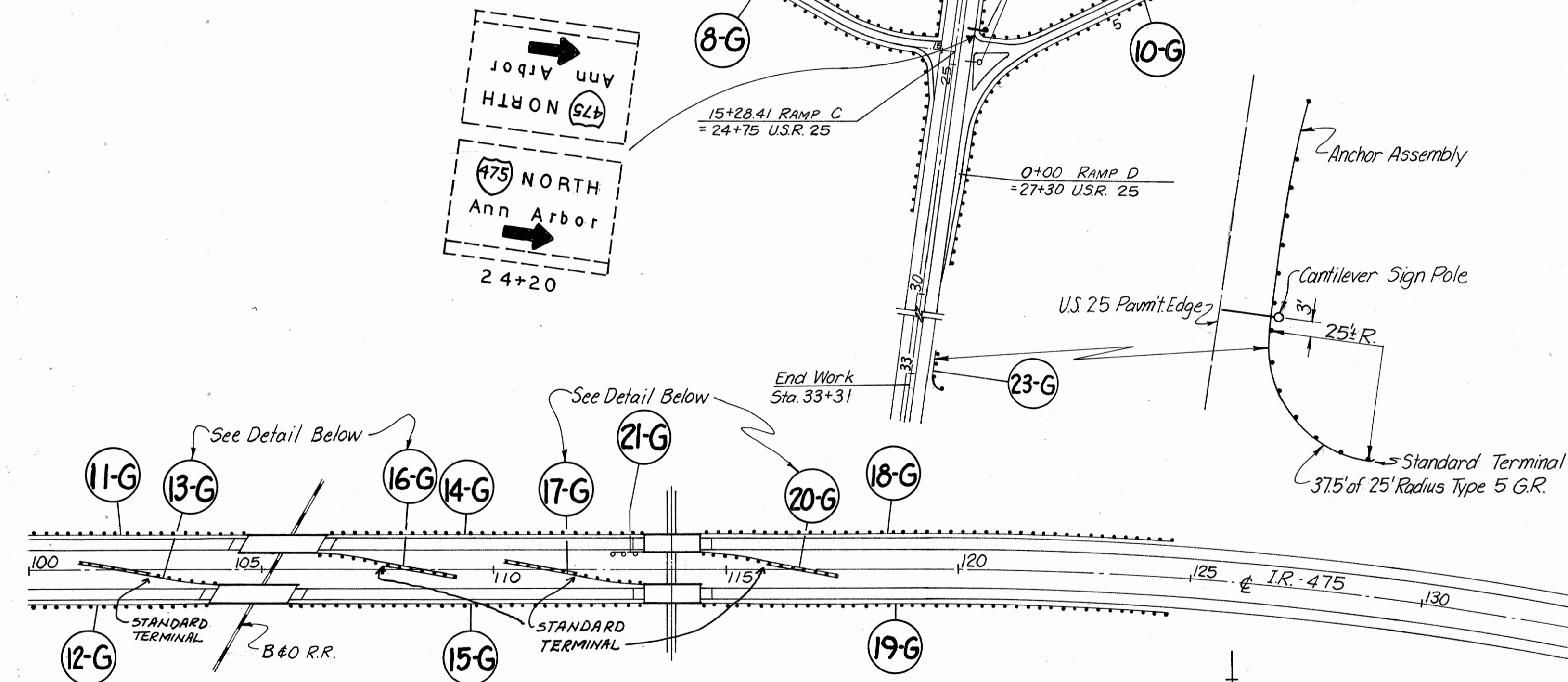

DETAIL FOR 13-G, 16-G, 17-G & 20-G  
& 5-G, SH. No. 7

### (S) SIGNING

See Sheet Nos. 32 & 33 For Quantities & Locations

REF. NO.	STATION	WORK REQUIRED
1-S	25+00 US. 25	Remove & Re-erect Existing Overhead Signs and Support at New Location

QUANTITIES  
CALC BY JCK DATE 4-17-72  
CKD BY GWW DATE 5-10-72

W00-475-(0.05-0.67)  
LUC-475-(0.00-15.63)

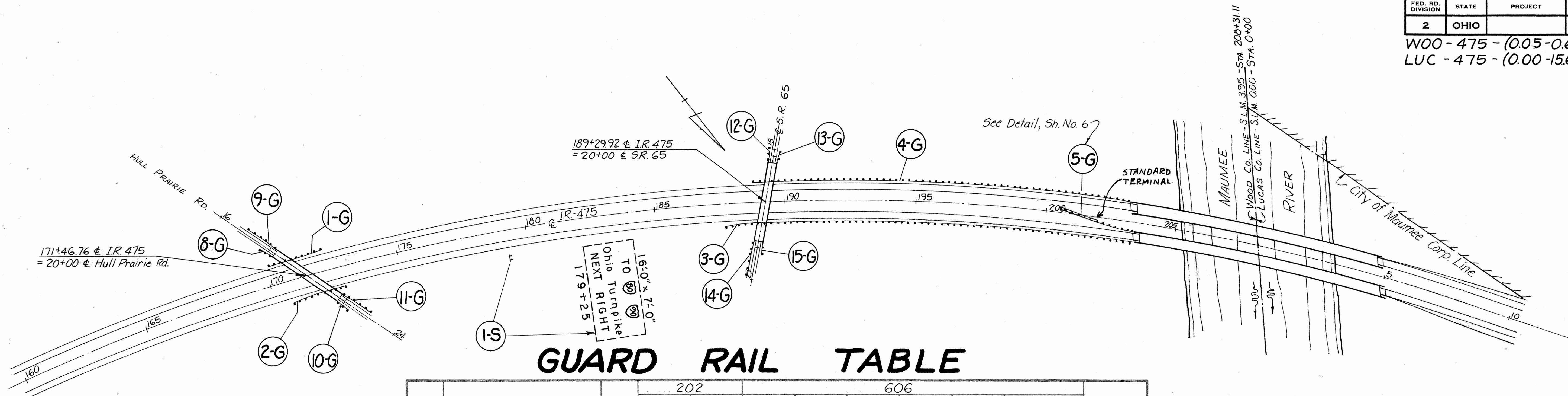

## GUARD RAIL TABLE

REF. No	STATION		SIDE	202		606			BRIDGE TERMINAL ASSEMBLY, TYPE			REMARKS			
	FROM	TO		GUARD RAIL REMOVED FOR REUSE OR STORAGE	BARRIER RAIL REMOVED FOR REUSE OR STORAGE	GUARD RAIL REBUILT, TYPE 5 AS PER PLAN	BARRIER RAIL REBUILT, TYPE 5 BARRIER AS PER PLAN	ANCHOR ASSEMBLY	ANCHOR ASSEMBLY BARRIER DESIGN	D	G		F		
				LIN. FT.	LIN. FT.	LIN. FT.	LIN. FT.	LIN. FT.	EACH	EACH	EACH		EACH		
1-G	170+12.5 IR 475	172+25 IR 475	Lt.			25	137.5								
2-G	170+69 IR 475	172+81.5 IR 475	Rt.			25	137.5								
3-G	187+60.5 IR 475	203+62 IR 475	Rt.	25		239	1337.5			1					
4-G	188+80.5 IR 475	203+32 IR 475	Lt.	25		151.5	1275					1			
5-G	200+54 IR 475	203+55.5 IR 475	Med.	25	25	26.5	125	125		1	1				
6-G	See Detail		Rt.	50		975									
7-G	See Detail		Lt.	50		850									
8-G	17+36.5*	17+86.5*	Rt.	50		25									
9-G	16+85.5*	18+10.5*	Lt.	25		100									
10-G	21+87*	22+37*	Rt.	25		25									
11-G	22+10.5*	23+35.5*	Lt.	50		100									
12-G	17+94.5 SR 65	18+44.5 SR 65	Rt.	50		25									
13-G	17+99 SR 65	18+36.5 SR 65	Lt.	37.5		12.5									
14-G	21+62 SR 65	22+87 SR 65	Rt.	25		100									
15-G	21+54.5 SR 65	21+92 SR 65	Lt.	37.5		12.5									
TOTALS TO GUARD RAIL SUMMARY						475	25	2692	3012.5	125	18	1	2	0	1

\* @ HULL PRAIRIE RD.

### SIGNING

See Sheet No. 33 For Quantities & Locations

REF. NO.	STATION	WORK REQUIRED
1-S	179+25 IR 475	Erect Ground Mounted Sign on New Breakaway Supports

See Sh. No. 8 for IR 475 & U.S. 24 Interchange Details

See Detail Below

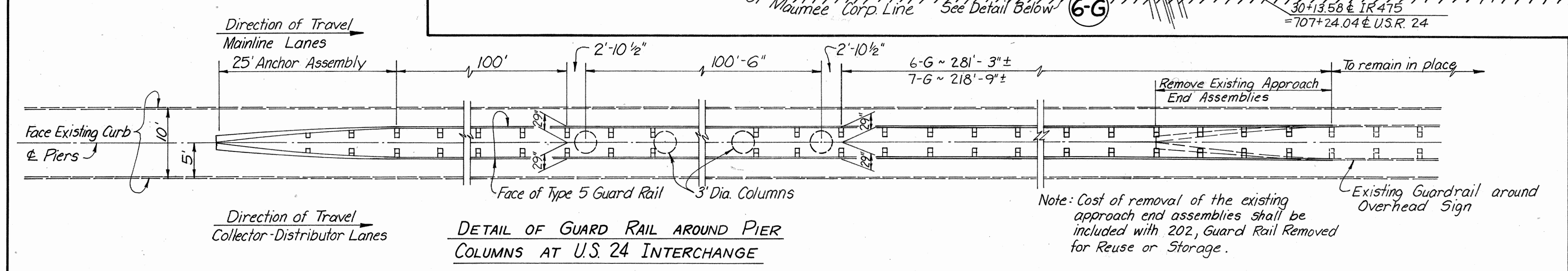
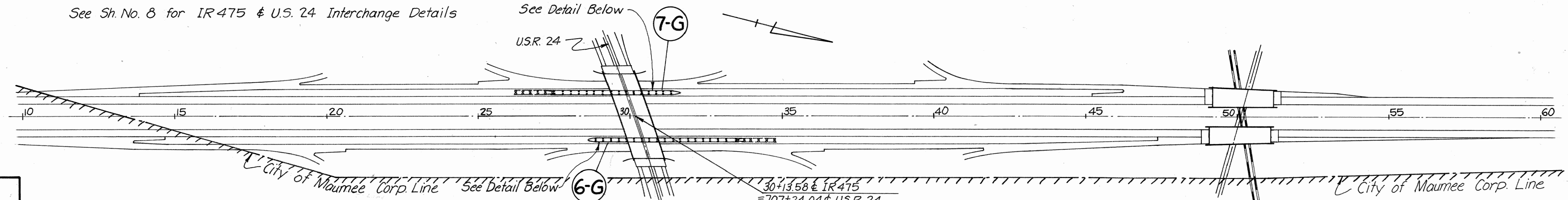

QUANTITIES  
CALC BY J.C.W. DATE 4-12-72  
CHKD BY G.W.W. DATE 5-10-72

W00 - 475 - (0.05-0.67)  
LUC - 475 - (0.00-15.63)

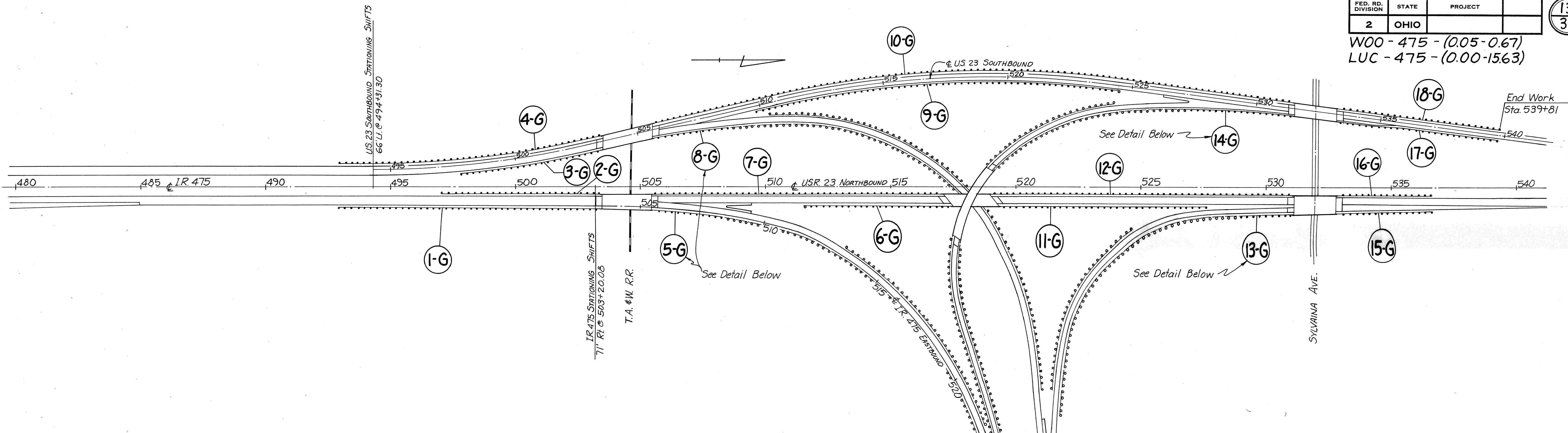

## GUARD RAIL TABLE

REF. No.	STATION		SIDE	202		606		ANCHOR ASSEMBLY	BRIDGE TERMINAL ASSEMBLY, TYPE		REMARKS
				GUARD RAIL REMOVED FOR REUSE OR STORAGE	GUARD RAIL REBUILT, TYPE 5, AS PER PLAN	GUARD RAIL REBUILT, TYPE 5, AS PER PLAN	C		F		
	FROM	TO		LIN. FT.	LIN. FT.	LIN. FT.	EACH		EACH		
1-G	492+85 IR 475	503+37.5 IR 475	Rt.	25	27.50	1000					
2-G	496+98 IR 475	503+38 IR 475	Rt.	25	27.50	589.50					
3-G	497+67 US 23 S.B.	503+44.5 US 23 S.B.	Rt.	25	27.50	525					
4-G	492+81 US 23 S.B.	503+58.5 US 23 S.B.	Lt.	25	27.50	1025					
5-G	505+49.5 IR 475	508+27 IR 475	Rt.	75	77.50	200*				25' 202 at bridge	
6-G	511+60.5 US 23 N.B.	517+25.5 US 23 N.B.	Rt.	25	27.50	537.50	†				
7-G	505+50 US 23 N.B.	516+84.5 US 23 N.B.	Rt.	50	54.50	1082				25' 202 at each bridge	
8-G	505+49.5 US 23 S.B.	508+52 US 23 S.B.	Rt.	75	77.50	225*				25' 202 of bridge	
9-G	509+91 US 23 S.B.	524+28.5 US 23 S.B.	Rt.	25		1412.50	†			25' 202 from 509+91 to 510+16	
10-G	505+70.5 US 23 S.B.	531+32.5 US 23 S.B.	Lt.	50	55	2507				25' 202 of each bridge	
11-G	519+37.5 US 23 N.B.	527+65 US 23 N.B.	Rt.	50	27.50	775				25' 202 from 527+65 to 527+65	
12-G	518+98.5 US 23 N.B.	530+91 US 23 N.B.	Rt.	50	55	1137.50				25' 202 of each bridge	
13-G	528+75.5 US 23 N.B.	530+90.5 US 23 N.B.	Rt.	75	77.50	137.50*				25' 202 at bridge	
14-G	527+24.5 US 23 S.B.	531+39.5 US 23 S.B.	Rt.	75	77.50	337.50*				25' 202 of bridge	
15-G	532+86.5 US 23 N.B.	536+64 US 23 N.B.	Rt.	25	27.50	325					
16-G	532+86.5 US 23 N.B.	536+64 US 23 N.B.	Rt.	25	27.50	325					
17-G	533+35.5 US 23 S.B.	539+75.5 US 23 S.B.	Rt.	25	27.50	592.5					
18-G	533+28.5 US 23 S.B.	539+81 US 23 S.B.	Lt.	25	27.50	600					
19-G	537+40 IR 475	538+65 IR 475	Lt.	125							
<b>TOTALS TO GUARD RAIL SUMMARY</b>				875	749.50	13,333.50	10	9	11		

\* Connect to existing Type 5 G.R. - See Detail  
 † Existing anchor assembly shall remain in place and shall be connected to rebuilt Type 5 G.R.

### S SIGNING

See Sheet No. 33 For Quantities & Locations

REF. NO.	STATION	WORK REQUIRED
1-S	537+50 I-475	Remove, re-erect on new breakaway supports

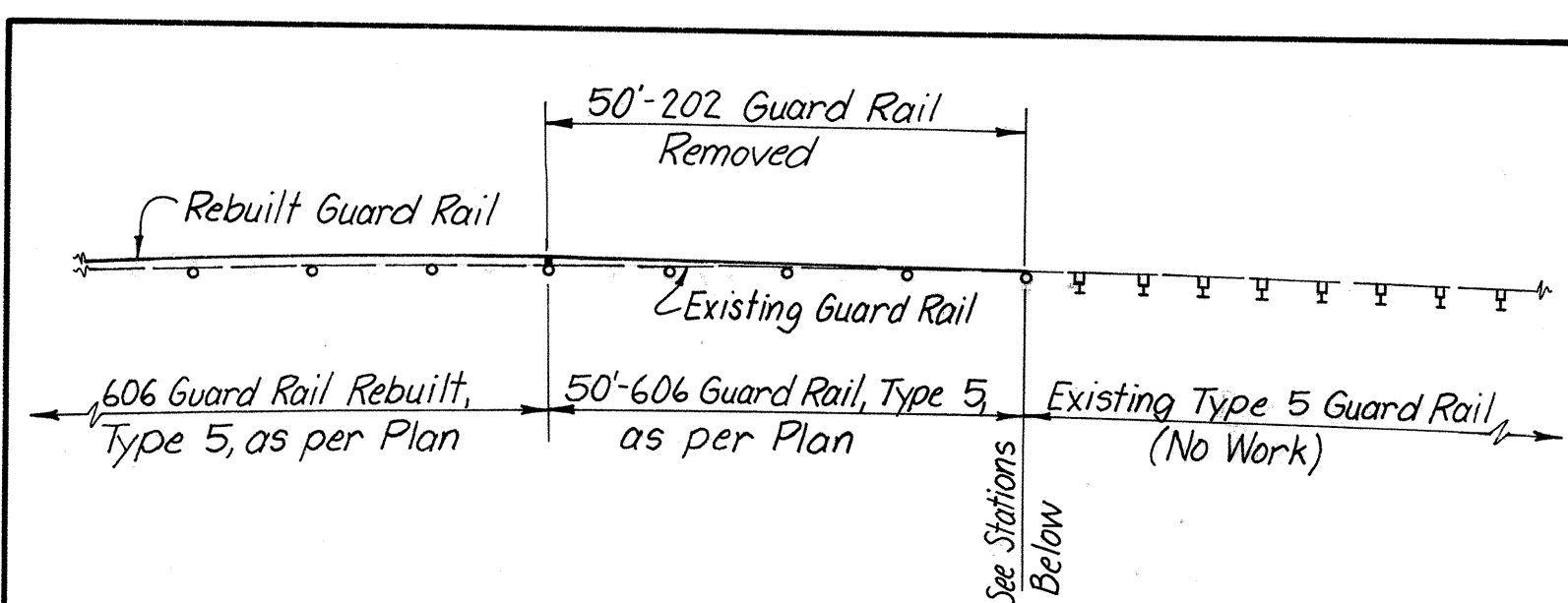
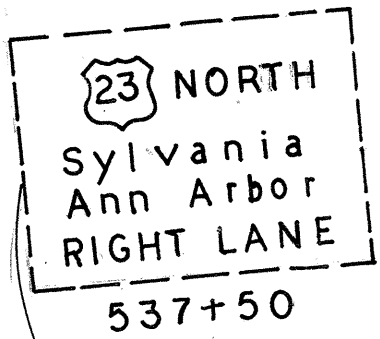

### DETAIL - 5-G, 8-G, 13-G & 14-G

- 5-G : 508+27 Rt. IR 475
- 8-G : 508+52 Rt. US 23 S.B.
- 13-G : 528+75.5 Rt. US 23 N.B.
- 14-G : 527+24.5 Rt. US 23 S.B.

QUANTITIES  
 CALC BY JCL DATE 4-26-22  
 CKD BY GMM DATE 5-30-22

FED. RD. DIVISION	STATE	PROJECT
2	OHIO	

14  
36

W00-475-(0.05-0.67)  
LUC-475-(0.00-15.63)

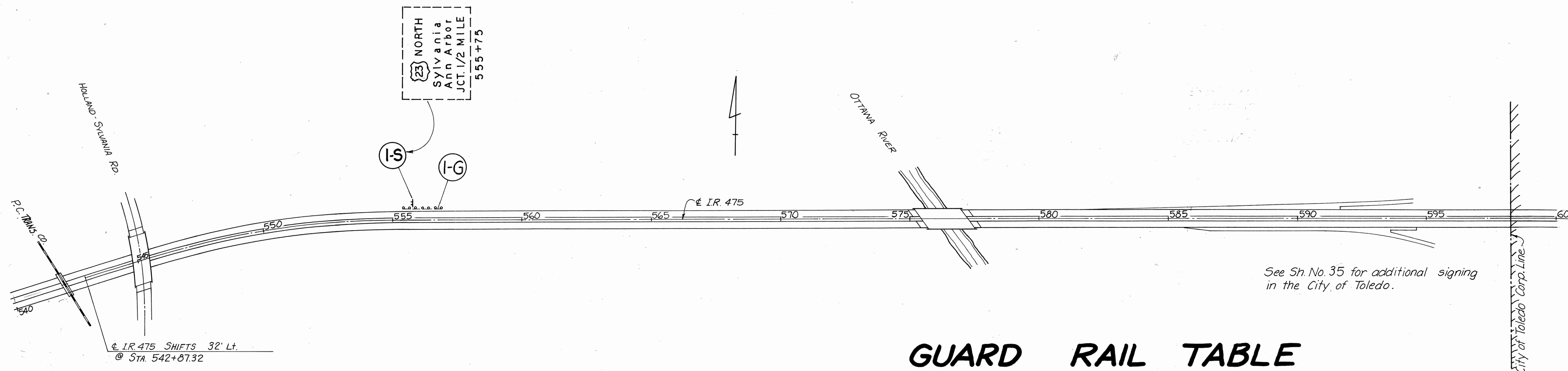

I.R. 475 SHIFTS 32' Lt.  
@ Sta. 542+87.32

### GUARD RAIL TABLE

REF. No.	STATION		SIDE	202 GUARD RAIL REMOVED FOR REUSE OR STORAGE LIN. FT.	REMARKS
	FROM	TO			
I-G	555+40 I.R.475	556+90 I.R.475	Lt.	150	
TOTAL TO GUARD RAIL SUMMARY				150	

### ⑤ SIGNING

See Sheet No. 33 For Quantities & Locations

REF. No.	STATION	WORK REQUIRED
I-S	555+75 I.475	Remove, re-erect on new breakaway supports

QUANTITIES  
CHECKED BY JCH DATE 2-2-72  
CND BY GWW DATE 5-10-72