

PARCEL No. 1
 A.E. & Florence Baker
 Luckey, Ohio
 0.75

PARCEL No. 2
 Frank E. Pollex
 Luckey, Ohio
 1.91

DESCRIPTION OF LAND DEDICATED

The North 10 Feet of the South 30 Feet of Section 20, Webster Township.
 The North 10 Feet of the South 30 Feet of Section 21, Troy Township.
 The South 10 Feet of the North 30 Feet of Section 29, Webster Township.
 The South 10 Feet of the North 30 Feet of Section 28, Troy Township.
 All in TOWN 6 NORTH RANGE 12 EAST. Panels Shown thus

We, the undersigned owners of the above described property hereby dedicate the same to public use for road and other public purposes consistent therewith, clear of all obstructions which interfere with the improvement and/or maintenance of the highway.

OWNERS	WITNESS	WITNESS
<i>Henry F. Borcharding</i>	<i>Paul A. Dumipace</i>	<i>W.E. Hessman</i>
<i>Alice Kirk</i>	<i>Paul A. Dumipace</i>	<i>W.E. Hessman</i>
<i>William Geisbuhler</i>	<i>Paul A. Dumipace</i>	<i>W.E. Hessman</i>
<i>Herman H. Fahle</i>	<i>Paul A. Dumipace</i>	<i>W.E. Hessman</i>
<i>Anna M.E. Meyer</i>	<i>Paul A. Dumipace</i>	<i>W.E. Hessman</i>
<i>Geo. J. Meyer</i>	<i>Paul A. Dumipace</i>	<i>W.E. Hessman</i>
<i>Lawrence J. Meyer</i>	<i>Paul A. Dumipace</i>	<i>W.E. Hessman</i>
<i>Robert Smith</i>	<i>Paul A. Dumipace</i>	<i>W.E. Hessman</i>
<i>Lucian Miller</i>	<i>Paul A. Dumipace</i>	<i>W.E. Hessman</i>
<i>Henry H. Fahle</i>	<i>Paul A. Dumipace</i>	<i>W.E. Hessman</i>
<i>Ernest W. Fahle</i>	<i>Paul A. Dumipace</i>	<i>W.E. Hessman</i>
<i>Henry Landwehr</i>	<i>Paul A. Dumipace</i>	<i>W.E. Hessman</i>
<i>G.F. Landwehr</i>	<i>Paul A. Dumipace</i>	<i>W.E. Hessman</i>
<i>Clara M. Bushman</i>	<i>Paul A. Dumipace</i>	<i>W.E. Hessman</i>
<i>Frank Miller</i>	<i>Paul A. Dumipace</i>	<i>W.E. Hessman</i>
<i>Mrs. Julia Miller</i>	<i>Paul A. Dumipace</i>	<i>W.E. Hessman</i>
<i>Ernest Miller</i>	<i>Paul A. Dumipace</i>	<i>W.E. Hessman</i>
<i>Amelia Fortlander</i>	<i>Paul A. Dumipace</i>	<i>W.E. Hessman</i>
<i>Harley W. Miller</i>	<i>Paul A. Dumipace</i>	<i>W.E. Hessman</i>
<i>Dora Miller Goodman</i>	<i>Paul A. Dumipace</i>	<i>W.E. Hessman</i>
<i>Junior Miller</i>	<i>Paul A. Dumipace</i>	<i>W.E. Hessman</i>
<i>Ernest W. Fahle</i>	<i>Paul A. Dumipace</i>	<i>W.E. Hessman</i>
<i>Henry H. Fahle</i>	<i>Paul A. Dumipace</i>	<i>W.E. Hessman</i>
<i>Orville Miller</i>	<i>Paul A. Dumipace</i>	<i>W.E. Hessman</i>
<i>Robert Smith</i>	<i>Paul A. Dumipace</i>	<i>W.E. Hessman</i>
<i>G.F. Landwehr</i>	<i>Paul A. Dumipace</i>	<i>W.E. Hessman</i>

County of Wood } ss
 State of Ohio }
 On or about November 28, 1938, before me, the County Engineer for said county, personally appeared the following: Henry F. Borcharding, Alice Kirk, William Geisbuhler, Harmon H. Fahle, Anna M.E. Meyer, Geo. J. Meyer, Lawrence J. Meyer, Henry Landwehr, Clara M. Bushman, Frank Miller, Mrs. Julia Miller, Elvena Miller, Emanuel Miller, Ernest Miller, Amelia Fortlander, Harley W. Miller, Dora Miller Goodman, Junior Miller, Ernest W. Fahle, Henry H. Fahle, Orville Miller, Robert Smith, G.F. Landwehr, who acknowledged the signing of this plat to be their voluntary act and deed for the purposes hereon mentioned.
 Witness my hand and seal this 28th day of Nov. 1938
E. F. Metzger
 County Engineer, Wood Co., Ohio.

APPROVED AS TO OWNERS this 12th day of December 1938
 RECORDED in Vol. _____ Page _____ of Wood County Road Record
 this _____ day of _____ 1938

C. L. Filice
 County Auditor

OFFICE OF THE COUNTY COMMISSIONERS
 WOOD COUNTY, BOWLING GREEN, OHIO
 This Plat has been approved and accepted by us this
 12th day of December 1938
E. F. Metzger
John F. Becker
R. H. Eckert
 Board of County Commissioners.

APPROVED and ACCEPTED by me this 13th day of December 1938
E. F. Metzger
 County Engineer

DEDICATION PLAT
 HASKINS - DUNBRIDGE ROAD NO. 20-SECT '6'
 FROM STONY RIDGE, TOLEDO ROAD TO LEMOYNE ROAD
 OFFICE OF E. F. METZGER, COUNTY ENGINEER
 BY *Paul A. Dumipace* DEPUTY

RECORDED IN VOL. 15-11-38

TOWN 6 NORTH RANGE 11 EAST

TOWN 6 NORTH RANGE 12 EAST

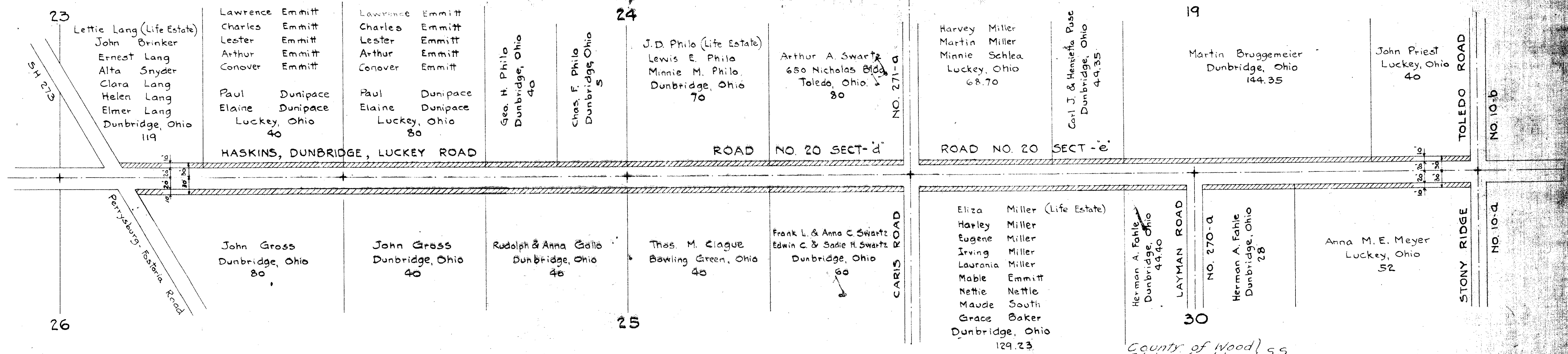

DESCRIPTION OF LAND DEDICATED

The North 10 feet of the South 30 feet of Section 23, T6N, R11E, East of S.H. 273
 The North 10 feet of the South 30 feet of Section 24, T6N, R11E
 The North 10 feet of the South 30 feet of Section 19, T6N, R12E
 The South 10 feet of the North 30 feet of Section 26, T6N, R11E, East of S.H. 273
 The South 10 feet of the North 30 feet of Section 25, T6N, R11E
 The South 10 feet of the North 30 feet of Section 30, T6N, R12E

Sections shown thus

We, the undersigned owners of the above described property hereby dedicate the same to public use for road and public purposes consistent therewith, clear of all obstructions which interfere with the improvement and/or maintenance of the highway.

OWNERS	WITNESS	WITNESS
<i>John Brinker</i>	<i>Paul A. Dunipace</i>	<i>W.E. Hessman</i>
<i>Mrs. Alta Buehring</i>	<i>Paul A. Dunipace</i>	<i>W.E. Hessman</i>
<i>Mrs. Ernest Lang</i>	<i>Paul A. Dunipace</i>	<i>W.E. Hessman</i>
<i>Ernest Lang</i>	<i>Paul A. Dunipace</i>	<i>W.E. Hessman</i>
<i>Alta Snyder</i>	<i>Paul A. Dunipace</i>	<i>W.E. Hessman</i>
<i>Clara Lang</i>	<i>Paul A. Dunipace</i>	<i>W.E. Hessman</i>
<i>Helen Lang</i>	<i>Paul A. Dunipace</i>	<i>W.E. Hessman</i>
<i>Elmer Lang</i>	<i>Paul A. Dunipace</i>	<i>W.E. Hessman</i>
<i>Dunbridge, Ohio 119</i>		
<i>Lawrence Emmitt</i>	<i>Paul A. Dunipace</i>	<i>W.E. Hessman</i>
<i>Charles Emmitt</i>	<i>Paul A. Dunipace</i>	<i>W.E. Hessman</i>
<i>Lester Emmitt</i>	<i>Paul A. Dunipace</i>	<i>W.E. Hessman</i>
<i>Arthur Emmitt</i>	<i>Paul A. Dunipace</i>	<i>W.E. Hessman</i>
<i>Conover Emmitt</i>	<i>Paul A. Dunipace</i>	<i>W.E. Hessman</i>
<i>Paul Dunipace</i>	<i>Paul A. Dunipace</i>	<i>W.E. Hessman</i>
<i>Elaine Dunipace</i>	<i>Paul A. Dunipace</i>	<i>W.E. Hessman</i>
<i>Lucky, Ohio 40</i>		
<i>Lawrence Emmitt</i>	<i>Paul A. Dunipace</i>	<i>W.E. Hessman</i>
<i>Charles Emmitt</i>	<i>Paul A. Dunipace</i>	<i>W.E. Hessman</i>
<i>Lester Emmitt</i>	<i>Paul A. Dunipace</i>	<i>W.E. Hessman</i>
<i>Arthur Emmitt</i>	<i>Paul A. Dunipace</i>	<i>W.E. Hessman</i>
<i>Conover Emmitt</i>	<i>Paul A. Dunipace</i>	<i>W.E. Hessman</i>
<i>Paul Dunipace</i>	<i>Paul A. Dunipace</i>	<i>W.E. Hessman</i>
<i>Elaine Dunipace</i>	<i>Paul A. Dunipace</i>	<i>W.E. Hessman</i>
<i>Lucky, Ohio 80</i>		
<i>John Gross</i>	<i>Paul A. Dunipace</i>	<i>W.E. Hessman</i>
<i>Dunbridge, Ohio 80</i>		
<i>John Gross</i>	<i>Paul A. Dunipace</i>	<i>W.E. Hessman</i>
<i>Dunbridge, Ohio 40</i>		
<i>Rudolph & Anna Gallo</i>	<i>Paul A. Dunipace</i>	<i>W.E. Hessman</i>
<i>Dunbridge, Ohio 40</i>		
<i>Thos. M. Clague</i>	<i>Paul A. Dunipace</i>	<i>W.E. Hessman</i>
<i>Bowling Green, Ohio 40</i>		
<i>Frank L. & Anna C. Swartz</i>	<i>Paul A. Dunipace</i>	<i>W.E. Hessman</i>
<i>Edwin C. & Sadie H. Swartz</i>	<i>Paul A. Dunipace</i>	<i>W.E. Hessman</i>
<i>Dunbridge, Ohio 60</i>		
<i>Eliza Miller (Life Estate)</i>	<i>Paul A. Dunipace</i>	<i>W.E. Hessman</i>
<i>Harley Miller</i>	<i>Paul A. Dunipace</i>	<i>W.E. Hessman</i>
<i>Eugene Miller</i>	<i>Paul A. Dunipace</i>	<i>W.E. Hessman</i>
<i>Irving Miller</i>	<i>Paul A. Dunipace</i>	<i>W.E. Hessman</i>
<i>Laurania Miller</i>	<i>Paul A. Dunipace</i>	<i>W.E. Hessman</i>
<i>Mable Emmitt</i>	<i>Paul A. Dunipace</i>	<i>W.E. Hessman</i>
<i>Nettie Nettle</i>	<i>Paul A. Dunipace</i>	<i>W.E. Hessman</i>
<i>Maude South</i>	<i>Paul A. Dunipace</i>	<i>W.E. Hessman</i>
<i>Grace Baker</i>	<i>Paul A. Dunipace</i>	<i>W.E. Hessman</i>
<i>Dunbridge, Ohio 129.23</i>		
<i>John Priest</i>	<i>Paul A. Dunipace</i>	<i>W.E. Hessman</i>
<i>Lucky, Ohio 40</i>		
<i>Martin Bruggemeier</i>	<i>Paul A. Dunipace</i>	<i>W.E. Hessman</i>
<i>Dunbridge, Ohio 144.35</i>		
<i>Harvey Miller</i>	<i>Paul A. Dunipace</i>	<i>W.E. Hessman</i>
<i>Martin Miller</i>	<i>Paul A. Dunipace</i>	<i>W.E. Hessman</i>
<i>Minnie Schlea</i>	<i>Paul A. Dunipace</i>	<i>W.E. Hessman</i>
<i>Lucky, Ohio 68.70</i>		
<i>Arthur A. Swartz</i>	<i>Paul A. Dunipace</i>	<i>W.E. Hessman</i>
<i>650 Nicholas Bldg.</i>		
<i>Toledo, Ohio 80</i>		
<i>Carl J. & Henrietta Puse</i>	<i>Paul A. Dunipace</i>	<i>W.E. Hessman</i>
<i>Dunbridge, Ohio 49.35</i>		
<i>Anna M.E. Meyer</i>	<i>Paul A. Dunipace</i>	<i>W.E. Hessman</i>
<i>Lucky, Ohio 52</i>		

OWNERS	WITNESS	WITNESS
<i>John Brinker</i>	<i>Paul A. Dunipace</i>	<i>W.E. Hessman</i>
<i>Mrs. Alta Buehring</i>	<i>Paul A. Dunipace</i>	<i>W.E. Hessman</i>
<i>Mrs. Ernest Lang</i>	<i>Paul A. Dunipace</i>	<i>W.E. Hessman</i>
<i>Ernest Lang</i>	<i>Paul A. Dunipace</i>	<i>W.E. Hessman</i>
<i>Alta Snyder</i>	<i>Paul A. Dunipace</i>	<i>W.E. Hessman</i>
<i>Clara Lang</i>	<i>Paul A. Dunipace</i>	<i>W.E. Hessman</i>
<i>Helen Lang</i>	<i>Paul A. Dunipace</i>	<i>W.E. Hessman</i>
<i>Elmer Lang</i>	<i>Paul A. Dunipace</i>	<i>W.E. Hessman</i>
<i>Dunbridge, Ohio 119</i>		
<i>Lawrence Emmitt</i>	<i>Paul A. Dunipace</i>	<i>W.E. Hessman</i>
<i>Charles Emmitt</i>	<i>Paul A. Dunipace</i>	<i>W.E. Hessman</i>
<i>Lester Emmitt</i>	<i>Paul A. Dunipace</i>	<i>W.E. Hessman</i>
<i>Arthur Emmitt</i>	<i>Paul A. Dunipace</i>	<i>W.E. Hessman</i>
<i>Conover Emmitt</i>	<i>Paul A. Dunipace</i>	<i>W.E. Hessman</i>
<i>Paul Dunipace</i>	<i>Paul A. Dunipace</i>	<i>W.E. Hessman</i>
<i>Elaine Dunipace</i>	<i>Paul A. Dunipace</i>	<i>W.E. Hessman</i>
<i>Lucky, Ohio 40</i>		
<i>John Gross</i>	<i>Paul A. Dunipace</i>	<i>W.E. Hessman</i>
<i>Dunbridge, Ohio 80</i>		
<i>John Gross</i>	<i>Paul A. Dunipace</i>	<i>W.E. Hessman</i>
<i>Dunbridge, Ohio 40</i>		
<i>Rudolph & Anna Gallo</i>	<i>Paul A. Dunipace</i>	<i>W.E. Hessman</i>
<i>Dunbridge, Ohio 40</i>		
<i>Thos. M. Clague</i>	<i>Paul A. Dunipace</i>	<i>W.E. Hessman</i>
<i>Bowling Green, Ohio 40</i>		
<i>Frank L. & Anna C. Swartz</i>	<i>Paul A. Dunipace</i>	<i>W.E. Hessman</i>
<i>Edwin C. & Sadie H. Swartz</i>	<i>Paul A. Dunipace</i>	<i>W.E. Hessman</i>
<i>Dunbridge, Ohio 60</i>		
<i>Eliza Miller (Life Estate)</i>	<i>Paul A. Dunipace</i>	<i>W.E. Hessman</i>
<i>Harley Miller</i>	<i>Paul A. Dunipace</i>	<i>W.E. Hessman</i>
<i>Eugene Miller</i>	<i>Paul A. Dunipace</i>	<i>W.E. Hessman</i>
<i>Irving Miller</i>	<i>Paul A. Dunipace</i>	<i>W.E. Hessman</i>
<i>Laurania Miller</i>	<i>Paul A. Dunipace</i>	<i>W.E. Hessman</i>
<i>Mable Emmitt</i>	<i>Paul A. Dunipace</i>	<i>W.E. Hessman</i>
<i>Nettie Nettle</i>	<i>Paul A. Dunipace</i>	<i>W.E. Hessman</i>
<i>Maude South</i>	<i>Paul A. Dunipace</i>	<i>W.E. Hessman</i>
<i>Grace Baker</i>	<i>Paul A. Dunipace</i>	<i>W.E. Hessman</i>
<i>Dunbridge, Ohio 129.23</i>		
<i>John Priest</i>	<i>Paul A. Dunipace</i>	<i>W.E. Hessman</i>
<i>Lucky, Ohio 40</i>		
<i>Martin Bruggemeier</i>	<i>Paul A. Dunipace</i>	<i>W.E. Hessman</i>
<i>Dunbridge, Ohio 144.35</i>		
<i>Harvey Miller</i>	<i>Paul A. Dunipace</i>	<i>W.E. Hessman</i>
<i>Martin Miller</i>	<i>Paul A. Dunipace</i>	<i>W.E. Hessman</i>
<i>Minnie Schlea</i>	<i>Paul A. Dunipace</i>	<i>W.E. Hessman</i>
<i>Lucky, Ohio 68.70</i>		
<i>Arthur A. Swartz</i>	<i>Paul A. Dunipace</i>	<i>W.E. Hessman</i>
<i>650 Nicholas Bldg.</i>		
<i>Toledo, Ohio 80</i>		
<i>Carl J. & Henrietta Puse</i>	<i>Paul A. Dunipace</i>	<i>W.E. Hessman</i>
<i>Dunbridge, Ohio 49.35</i>		
<i>Anna M.E. Meyer</i>	<i>Paul A. Dunipace</i>	<i>W.E. Hessman</i>
<i>Lucky, Ohio 52</i>		

County of Wood } 55
 State of Ohio }
 On or about November 13 1938 before me the County Engineer for said county personally appeared the following: John Brinker, Mrs. Alta Buehring, Mrs. Ernest Lang, Ernest Lang, Clara Dierksheide, Conover Emmitt, Lawrence Emmitt, Lester Emmitt, Arthur Emmitt, Paul H. Dunipace, Elaine Dunipace, Paul H. Dunipace, Clifford E. Philo, Floyd Philo, Miss Frieda Philo, Mrs. Mary Philo, Mrs. Minnie Philo, Lewis E. Philo, Arthur A. Swartz, Minnie Schlea, Martin Miller, Harvey Miller, Carl Puse, Henrietta Puse, Martin Bruggemeier, Martha Priest, Melvin Priest, Anna M.E. Meyer, Herman A. Fahle, Eliza Miller, Irving Miller, Eugene Miller, Mable Emmitt, Grace Baker, Sylvia Hagmyer, Lucille Lutes, Fanny Loomis, Eddie Priest, Maggie P. Baker, Frank L. Swartz, Edwin C. Swartz, Sadie H. Swartz, Clara Philo, Anna C. Swartz, Rudolph Gallo, Anna Gallo, John Gross, John Priest, Joe Priest, who acknowledged the signing of this plat to be their voluntary act and deed for the purposes hereon mentioned Witness my hand this 12th day of November 1938.

E. F. Metzger
 County Engineer Wood Co., Ohio

APPROVED AS TO OWNERS this 12th day of December 1938

RECORDED in Vol. _____ Page _____ of Wood County Road Records this _____ day of _____ 1938

C. L. Filmer
 County Auditor

OFFICE OF THE COUNTY COMMISSIONERS
 WOOD COUNTY, BOWLING GREEN, OHIO

This Plat has been approved and accepted by us this 12th day of December 1938

E. R. Shiner
John F. Goetze
R. H. Eckert

Board of County Commissioners

APPROVED and ACCEPTED by me this 13th day of December 1938

E. F. Metzger
 County Engineer

Sworn Before Me this 14th day of Nov 14th, 1938. (Edith John)

DEDICATION PLAT
 HASKINS - DUNBRIDGE ROAD NO. 20-(PT) d&e
 FROM PERRYSBURG-FOSTORIA ROAD (S.H. 273) TO STONY RIDGE TOLEDO ROAD
 OFFICE OF E. F. METZGER, COUNTY ENGINEER
 BY Paul A. Dunipace DEPUTY

State Wash
 County Engineer
 Samuel P. ...
 Comm Exp Mar 28 1940

R-8582

62

76