

O.D.O.T. DISTRICT 2 SURVEY OFFICE (USE ONLY)

PERSONNEL \_\_\_\_\_

21

SHEET 26 OF 29

NOTES NIESE DATE 12/4/19  
 H.C. LEU WEATHER CLOUDY  
 R.C. NASON TEMP. 37°

ROUTE SR 582  
 COUNTY WOOD  
 TOWNSHIP MIDDLETON  
 SECTION 29

DWG BY BALBAUGH PID 81000

T 6 N R 11 E

TYPE MONUMENT MAG/WASHER

ON SURFACE - ~~BELOW~~ ON

OFFSET Q PAVEMENT 13.8' ~~RT~~ : RT

2.7' TO RT EDGE PAVEMENT

STATION: 378+26.88

HORZ. DATUM: NAD83 (2011)

GEOID: 2012A

GRID: NORTHING: 654541.051

EASTING: 1662655.862

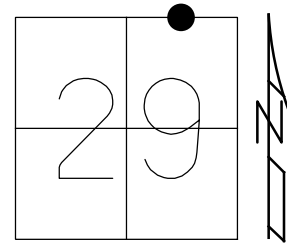

RECORD:  
 FD P.K./WASHER  
 4/26/04, MC  
 SET MAG/WASHER  
 10/20/04, MC  
 FD MAG/WASHER  
 REF21  
 4/14/15, EBW  
 FD MAG/WASHER  
 4/23/19, JLL  
 SET MAG/WASHER  
 12/4/19, JLL

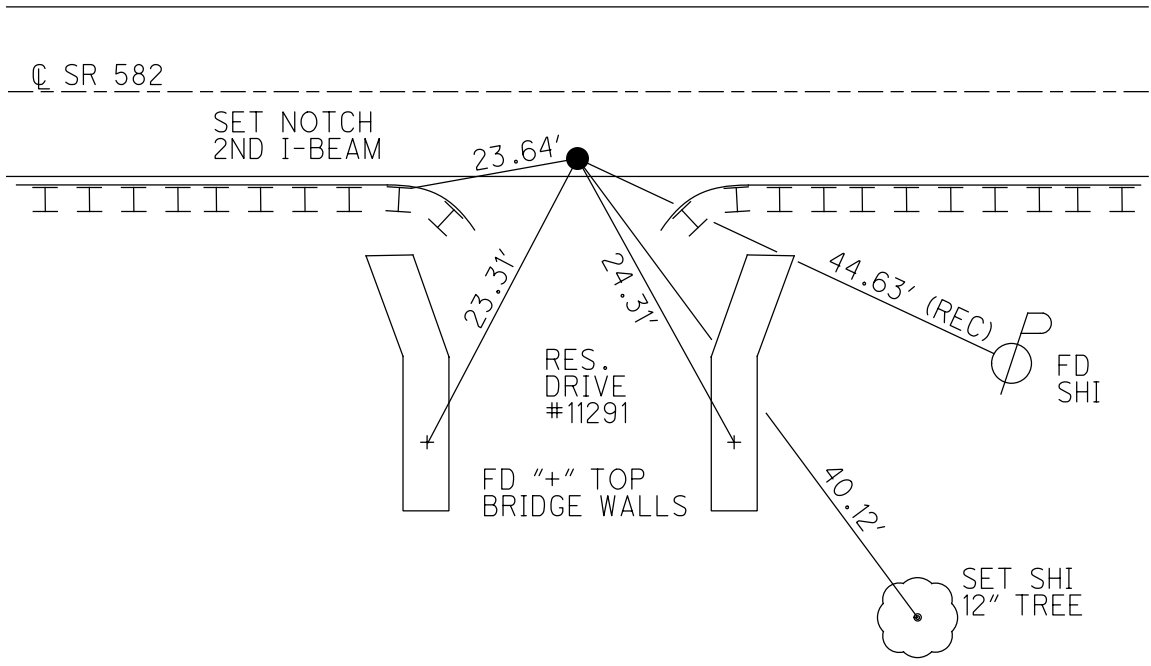
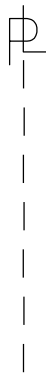

O.D.O.T. DISTRICT 2 SURVEY OFFICE

PERSONNEL \_\_\_\_\_

REFERENCE NO. 21

SHEET 23 OF 25

NOTES CANTERBURY

DATE 4/26/04

ROUTE SR 582

H.C. BARNHISEL

WEATHER CLOUDY

COUNTY WOOD

R.C. CANTERBURY

TEMP. 65°

TOWNSHIP MIDDLETON

SECTION 29

T 6 N R 11 E

TYPE MONUMENT P.K./WASHER

~~ON SURFACE~~ - BELOW 2"

~~LEFT~~ - Q PAV'T - RIGHT 11.4'  
1.6' TO RT EDGE PAVEMENT

S.L.M. 377+86

Grid: Northing: \_\_\_\_\_ Easting: \_\_\_\_\_

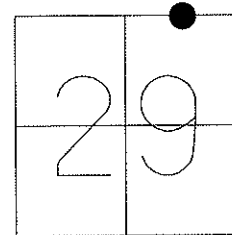

RESET MAG/WASHER  
 10/20/04, MC

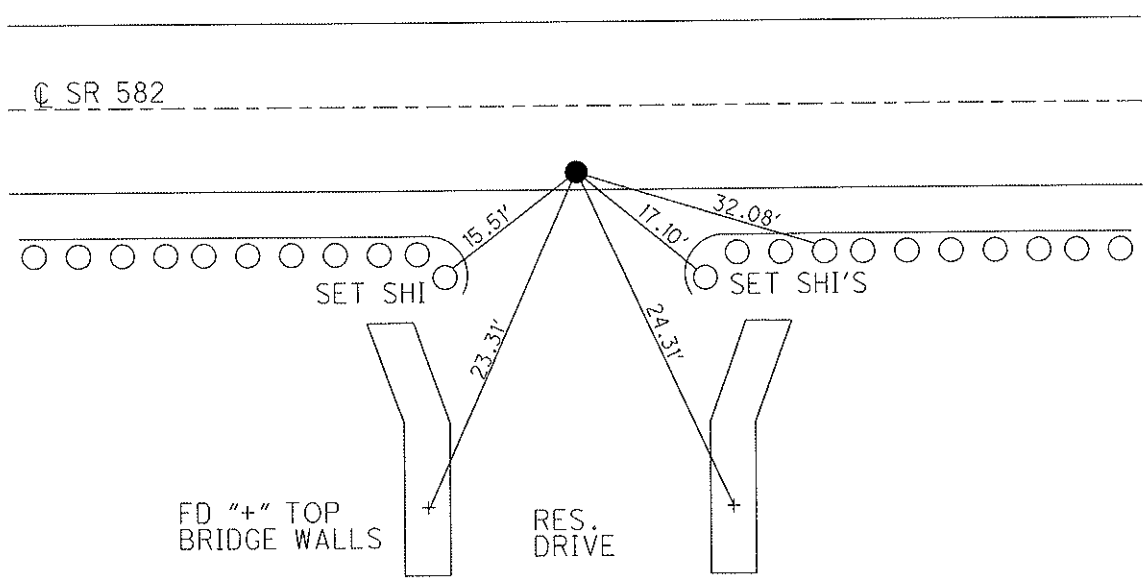

# O.D.O.T. DISTRICT 2 SURVEY OFFICE

PERSONNEL

REFERENCE NO. 21

SHEET 21 OF 23

NOTES CANTERBURY  
 H.C. BARNHISEL  
 R.C. CANTERBURY

DATE 4-26-04  
 WEATHER CLOUDY  
 TEMP. +65°

ROUTE S.R. 582  
 COUNTY WOOD  
 TOWNSHIP MIDDLETON  
 SECTION 29  
 T6 N R 11 E

TYPE MONUMENT P.K. / WASHER  
 ON SURFACE - ~~BELOW~~ 2" DOWN  
~~LEFT - & PAVT.~~ - RIGHT 11.4' RT &  
~~I.G. RT TO~~ RT EDGE PAVEMENT  
 S.L.M. 377 + 86

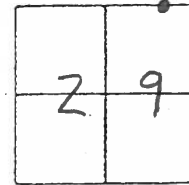

RESET MAG/WASHER  
 10/20/04  
 M.C.

& PAVT.

S.R. 582

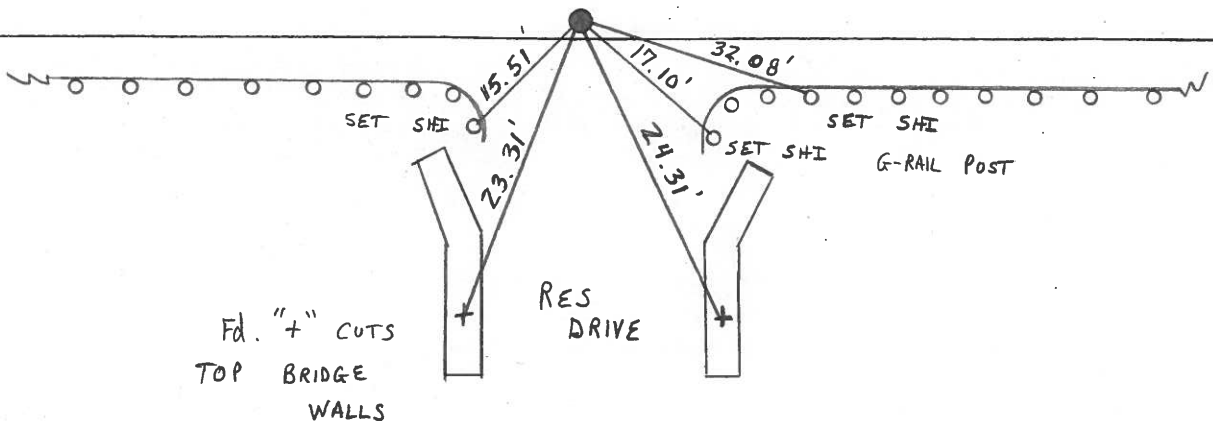

# O.D.O.T. DISTRICT 2 SURVEY OFFICE

PERSONNEL

REFERENCE NO. 21

SHEET 4 OF 6

NOTES CHENEY

H.C. BARROUR

R.C. GEYMAN

DATE 10-4-1991

WEATHER CLOUDY

TEMP. 65°

ROUTE 582

COUNTY WOOD

TOWNSHIP MIDDLETON

SECTION 29

T. 6 N R. 11 E

TYPE MONUMENT RE-SET PK/WASHER

ON SURFACE - BELOW

LEFT- & PAV'T. - RIGHT 10.7'

1.3' TO S. EDGE PAVEMENT

S.L.M. 377 + 87

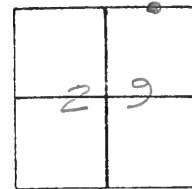

PREVIOUS MONUMENTS:

PK/WASHER

PK. NAIL

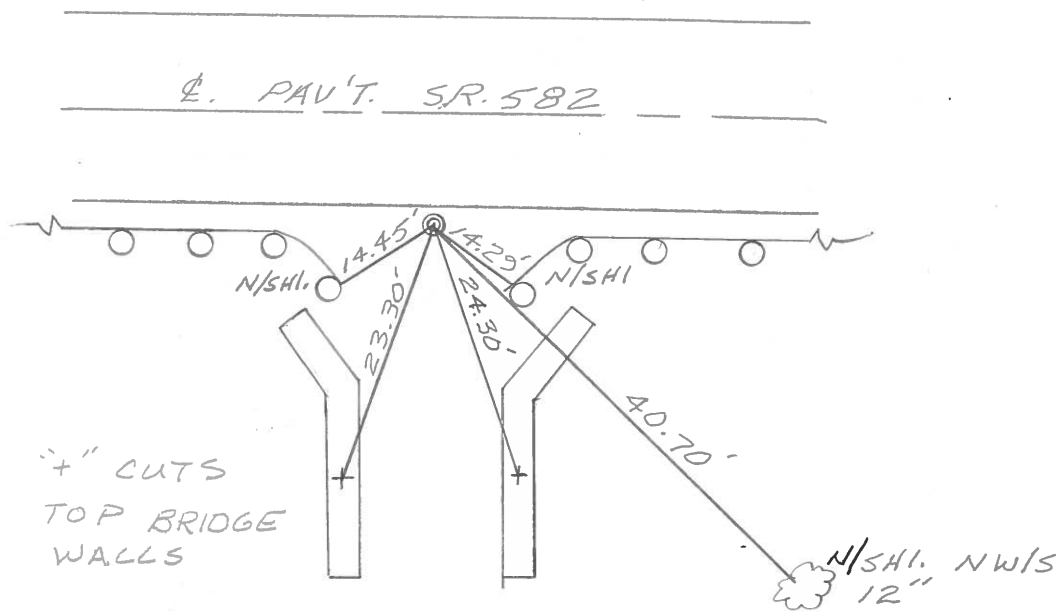

County Wood S.R. 582

Township MIDDLETON

Section 29

T6N, R1E

Personnel HOFFMAN

#21

&  
crew

Date 5-6-82

Weather clear - windy

Temp. +75°

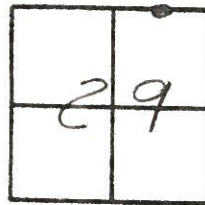

Fd P.K. 1 1/2" Below surface  
10.7' RT. of & PAUT  
1.3' S. of S.E.P.

SLM sta ± 377+87

Set PK nail/washer  
6-17-82  
SWA

& PAUT S.R. 582

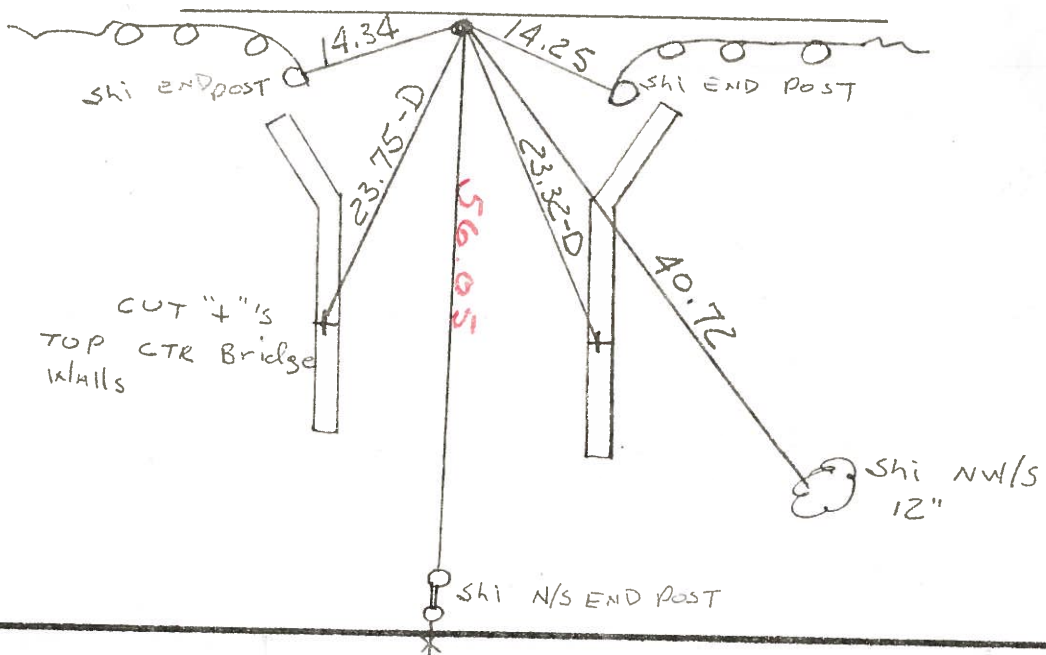

County Wood S.R. 582

Date 5-6-82

Township MIDDLETON

Weather clear - WINDY

Section 29

Temp. +75°

T6N, R11E

Personnel HOFFMAN

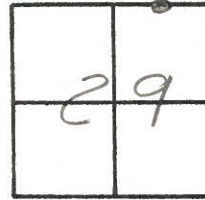

#21

+  
crew

Fd P.K. 1 1/2" Below surface

SLM sta ± 377+87

10.7' RT. of & PAUT

RE-SET P.K./WASHER  
6-17-82  
S.W.H.

1.3' S. of S.E.P.

& PAUT S.R. 582

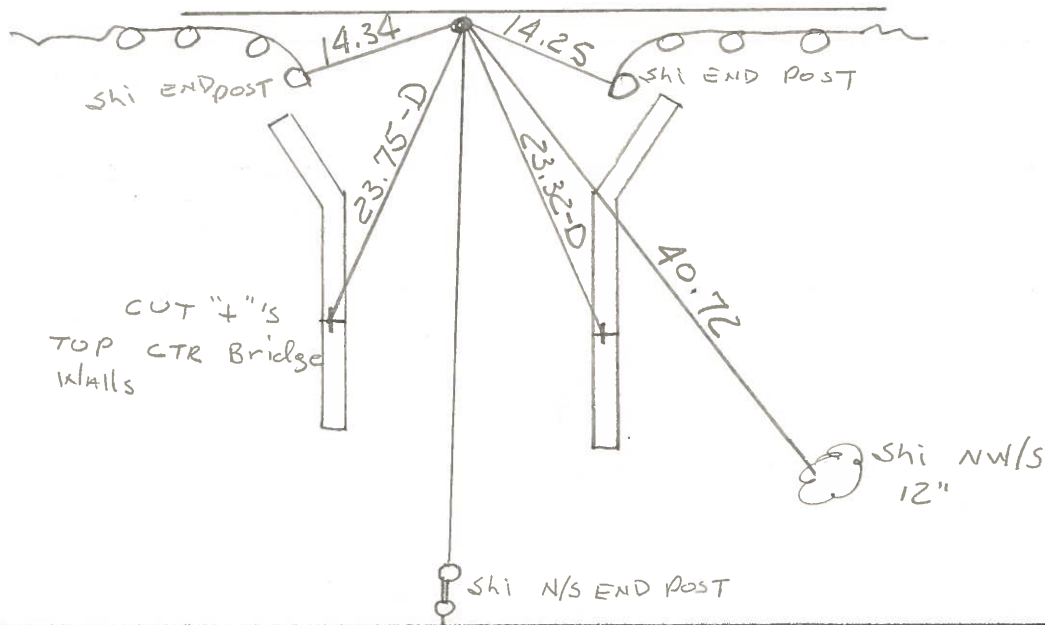

CUT "4" IS  
TOP CTR Bridge  
walls

PERSONNEL TITLE PERSONNEL TITLE

COUNTY Wood DATE April 16 1900

S. R. 2782 WEATHER Clear

SEC. \_\_\_\_\_ TEMP. +70°

DESCRIPTION Ties to Contour Points JOB NO. \_\_\_\_\_

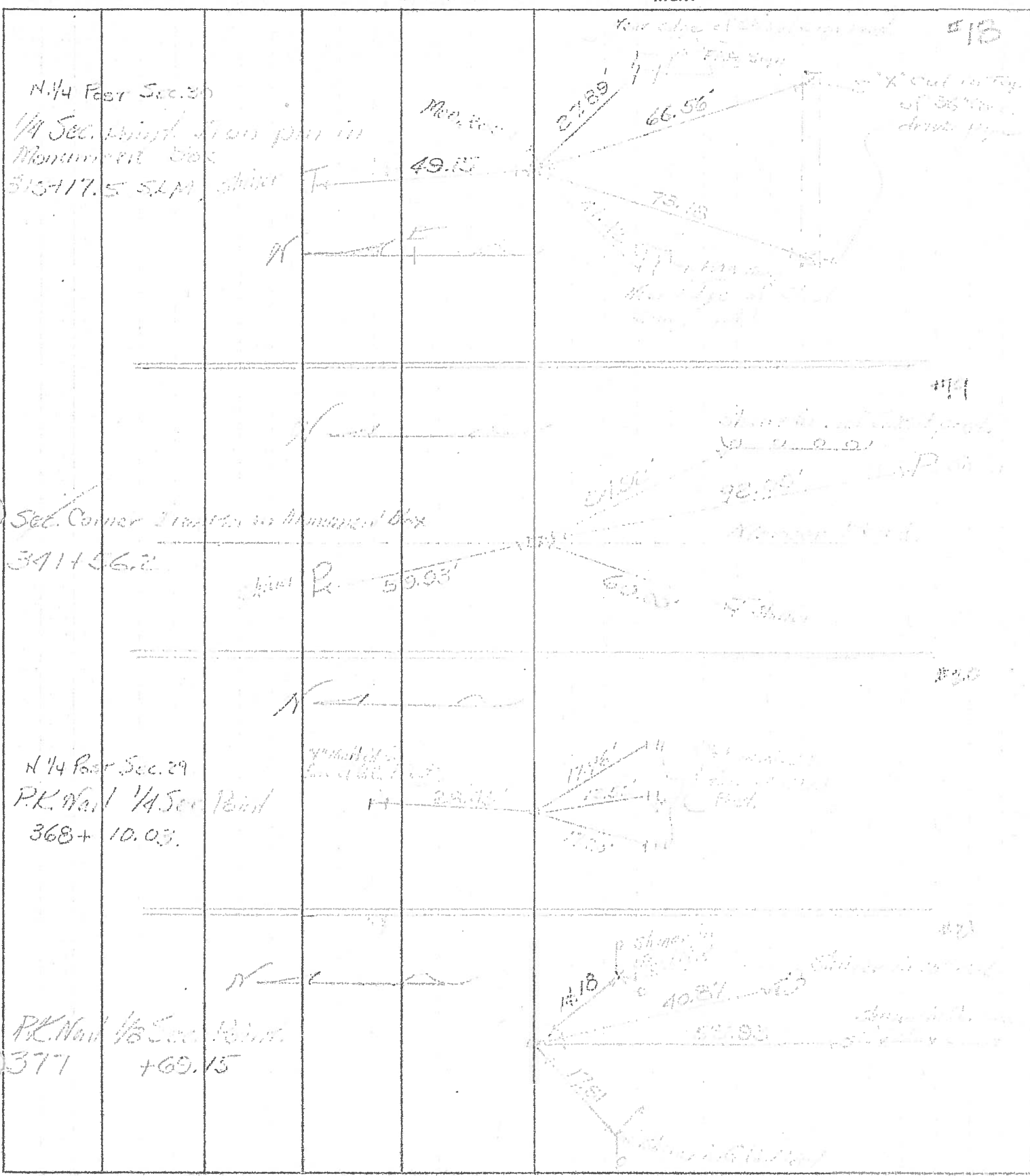



PERSONNEL	TITLE	PERSONNEL	TITLE	COUNTY <u>Wood</u>	DATE <u>12-27-57</u>
_____	_____	_____	_____	_____	<u>Sworden-4-4-60</u>
_____	_____	_____	_____	S. R. <u>#582</u>	WEATHER _____
_____	_____	_____	_____	SEC. _____	TEMP. _____

DESCRIPTION	LEFT	CENTER LINE	RIGHT	JOB NO.
-------------	------	-------------	-------	---------

			Shiner in Tele. Pole N.W.	54.00
			Shiner 24" Elm N.N.W.	37.58
N.E. cor. sec. 30 Middleton twp.			Conc. man.	S.W. 47.98
Fd. iron pin Mercer Rd.		O.K.	Cross in W. Hdwl.	29.32' 27.23
	#446	19	Cross in E. Hdwl.	32.03
			Shiner in 28" oak	S.E. 45.27' 45.35
N. 1/4 post sec. 29 Middleton twp.			Shiner in T.P.	S of E. 16.25
Stone is at S. edge of pavement.		O.K.	Shiner in cor. fence post N.	27.80
	#447	20	Center large boulder S.	32.22
			Shiner in P.P.	S.E. 40.30
			Shiner in G. rail	S. ± 3.5
Stone 1664.25' W. of N.E. Cor. sec. 29 Middleton twp.			Shiner Guard Rail Post E.S.E.	16.25'
Stone is near S. edge pavement. (Fd. Wood Hub.)		O.K.	N.E. cor. E. wing farm br.	S.E. 13.9'
	#448	21	N.W. cor. W. wing farm br.	S.W. 13.1
			S.W. cor. br. wall	W of S. 356'
			S.E. cor. br. wall	E of S. 35.85
			Shiner Cor. Post	S. 47.45
			Shiner 10" Hickory	S.E. 40.95
N.E. cor. sec. 29 Middleton Twp.			Shiner in P.P.	S.E. 40.7'
Stone - iron pin		O.K.	X-in S.W. cor. conc. walk N.E.	42.72
	#449	23	S.E. cor. conc. fdn.	N.W. 40.52'
			S.E. cor. conc. well curb	S.W. 30.28