

# O.D.O.T. DISTRICT 2 SURVEY OFFICE

PERSONNEL \_\_\_\_\_ REFERENCE NO. 42 B SHEET 22 OF 29  
 NOTES HOMAN DATE 4-27-10 ROUTE SR 582  
 H.C. HOMAN WEATHER SUNNY COUNTY WOOD  
 R.C. ROUSOS TEMP. 45° TOWNSHIP TROY  
 \_\_\_\_\_ SECTION 27  
 \_\_\_\_\_ T 6 N R 12 E

TYPE MONUMENT \_\_\_\_\_ PK Nail  
 ON SURFACE - ~~BELOW~~ \_\_\_\_\_ On Surface  
~~LEFT - C PAV'T~~ - RIGHT 2.8'  
6.7' TO RT EDGE PAVEMENT  
 S.L.M. \_\_\_\_\_ 836+21.68  
 GRID: NORTHING: 652456.250 EASTING: 1705718.920

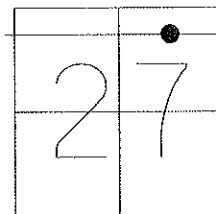

NOTE: EITHER POSSIBLE 1/4 QUARTER POINT, ORIGIN UNKNOWN

SET PK NAIL  
11-07-90 MB

RESET MAG/WASHER  
NEWREFB42, 7-9-10 DCH

SET SHI IN STUMP  
OF 12" ASH, SE/S

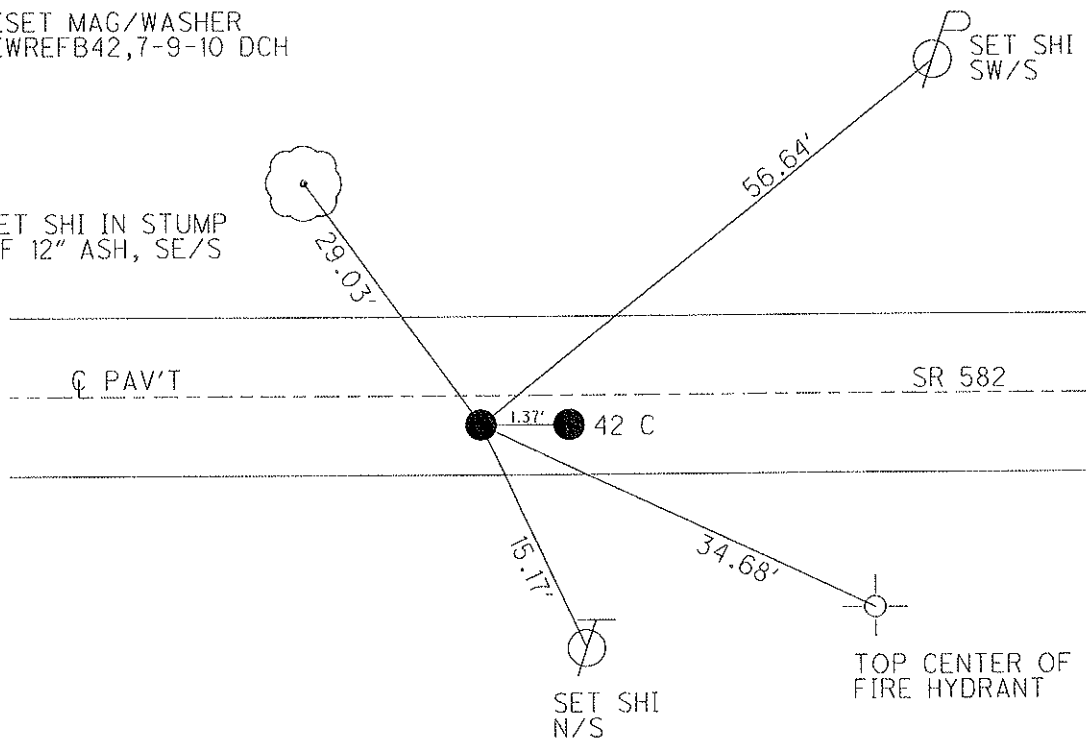

# O.D.O.T. DISTRICT 2 SURVEY OFFICE

PERSONNEL

REFERENCE NO. 42-A

SHEET \_\_\_\_\_ OF \_\_\_\_\_

NOTES LOEHRKE

H.C. LOEHRKE

R.C. BARNHISEL

DATE 7-26-90

WEATHER CLOUDY

TEMP. +81

ROUTE S.R 582

COUNTY WOOD

TOWNSHIP TROY

SECTION 27

T 6 N R 12 E

TYPE MONUMENT A - Lg RR Sp B - P.K. Nail & Shi.

ON SURFACE - ~~BELOW~~ yes

LEFT- & PAV'T. - RIGHT 2.8

6.7 TO Rt EDGE PAVEMENT

S.L.M. A - 837 + 10 B 837 + 19.5

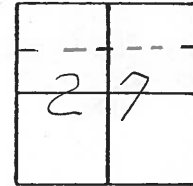

Either Possible 1/4 Quarter point  
ORIGIN UNKNOWN

SET P.K. NAILS  
11-7-90  
MB

