

4 LANE

MAINTENANCE PROGRAM 1981

PART 1
OF 1

(TOP) TYPE 404 THICKNESS 1 1/2" PRIORITY

(BASE) TYPE _____ THICKNESS _____ PENETRATION

END LOG S.L.M. 5.00 (Construction Joint (East of Oregon Rail))

BEGIN LOG S.L.M. 0.69 (Perrysburg Corp. (ECL) = 36+43.20)

TOTAL LENGTH 4.31

COUNTY WOOD SECTION 0.69 WIDTH (2@24') BERM CURBED () ()

ROUTE SR 795 SECTION 5.00 WIDTH () ()

SECTION _____ WIDTH () ()

ORDINANCE _____ SECTION _____ WIDTH () ()

END LOG _____ SECTION _____ WIDTH () ()

BEGIN LOG _____ SECTION _____ WIDTH () ()

EXISTING BERM TYPE Stabilized EXISTING BERM WIDTH 8' outside MAILBOX APPROACHES No. _____

(PAVED, STABILIZED, AGGREGATE)

MANHOLES _____

PROPOSED BERM TYPE _____ PROPOSED BERM WIDTH _____ X INLETS CATCH BASINS _____

INTERSECTIONS _____ ASPHALT DRIVEWAYS _____ CONCRETE DRIVEWAYS _____

STRUCTURES

STRUCTURE NO.	WIDTH	LENGTH	APPR. SLABS
W00-795-0191	26'	32.6'	2@25' 101+54 Mees
" "	26'	32.6'	2@25'
W00-795-0227	31'	352.00	2@25' 120+33 E.B
" "	30'	352.00	2@25' 120+84 W.B
W00-795-0301	28'	315.00	2@25' 158+74 W.B
" "	31'	346.00	2@25' 159+71 E.B
W00-795-0408	38'	228.00	2@25' 216+06 E.B
" "	38'	228.00	2@25' 216+22 W.B

RAILROAD CROSSINGS

NAME R. R.	STATION	(*)	()	No.	TRACKS
		()	()	()	TRACKS
		()	()	()	TRACKS
		()	()	()	TRACKS
		()	()	()	TRACKS

*Indicate length of crossing along C Pav't.

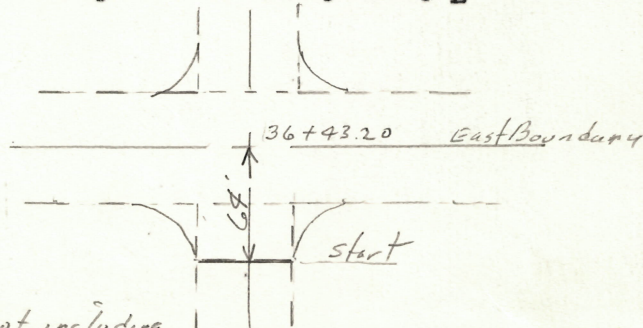

NOTES

From 36+43.20 To (106+30±) Pavement is 50' wide not including conc. curb & gutter. The Medium with joggle bars is 4' wide making traveled lanes 23' wide

PERSONNEL TITLE PERSONNEL TITLE

CRONIN SCHNEIDER

GEYMAN MOSSER

BARBOUR

COUNTY Wood

DATE 12/23/80

S. R. # 795

WEATHER OVERCAST

SEC. 0.69 - 5.00 - 5.2M

TEMP. 30°

DESCRIPTION Topo - Signs - Guard Rail etc.

JOB NO.

	LEFT	CENTER LINE	RIGHT	
53+52		<p>steel sign post</p>	<p>steel sign post</p>	Good shape
44+49 Lt.		<p>steel sign post</p>		Good but leaning
41+51 Lt.	<p>steel sign post</p>			Good but leaning
39+27 Rt.			<p>steel sign post</p>	sign is badly checked
37+26 Rt.			<p>steel sign post CONC. base</p>	Good Shape
36+91 Lt.		<p>steel sign posts conc. bases</p>		Good shape

PERSONNEL	TITLE	PERSONNEL	TITLE	COUNTY	DATE
CROVIN		SCHNEIDER		Wood	12/23/80
GEYMAN		MOSSER		S. R. # 795	WEATHER OVERCAST
		BARBOOR		SEC. 0.69-500 SLM	TEMP. 30°

DESCRIPTION Topo - Signs - Guard Rail etc. JOB NO. _____

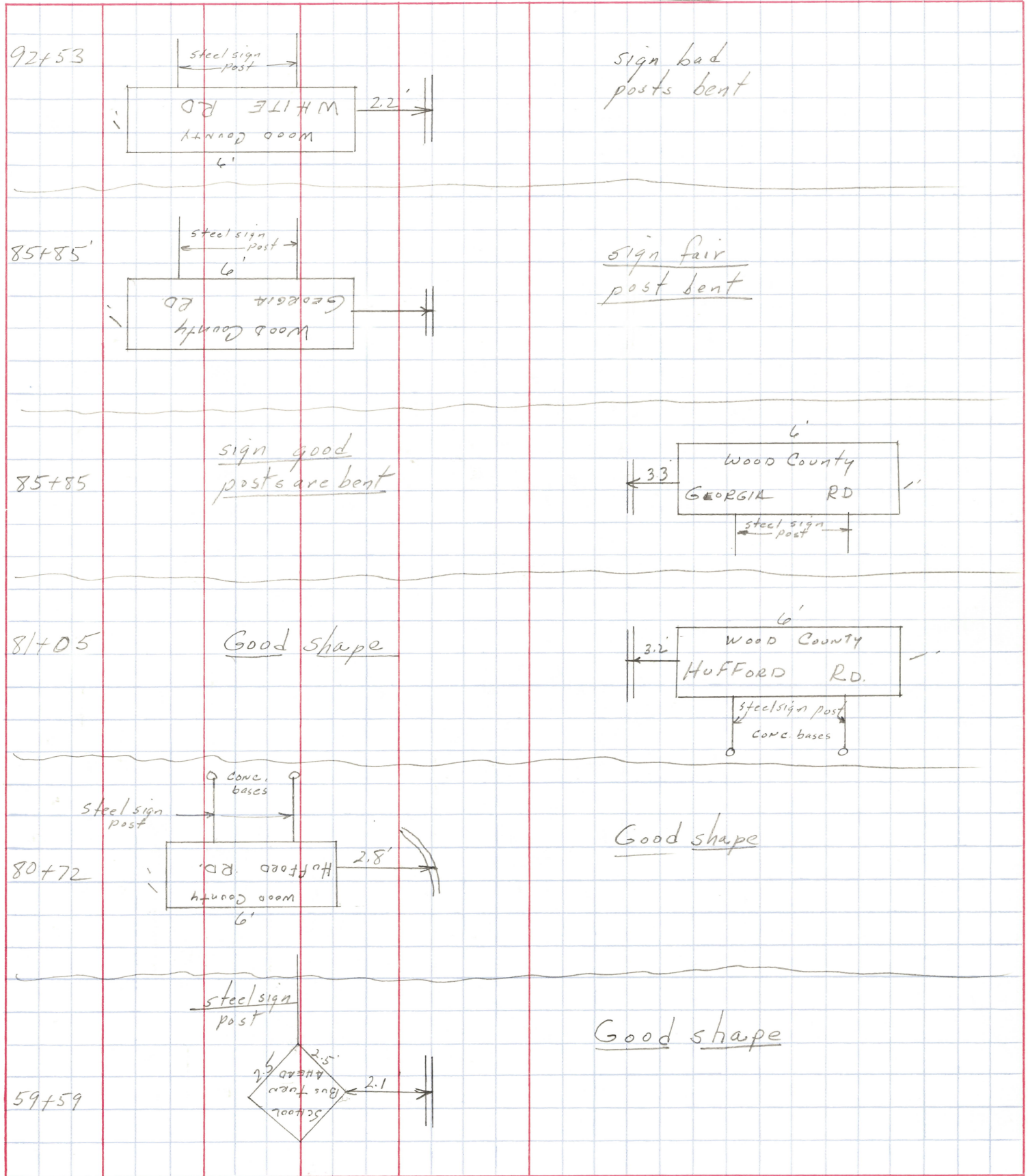

PERSONNEL	TITLE	PERSONNEL	TITLE
CRONIN		SCHEIDER	
GEYMAN		MOSSER	
		BARBOUR	

COUNTY Wood DATE 12/23/80

S. R. #795 WEATHER OVERCAST

SEC. 0.69 - 5.00 SLM TEMP. 30°

DESCRIPTION Topo - Signs - Guard Rail etc. JOB NO.

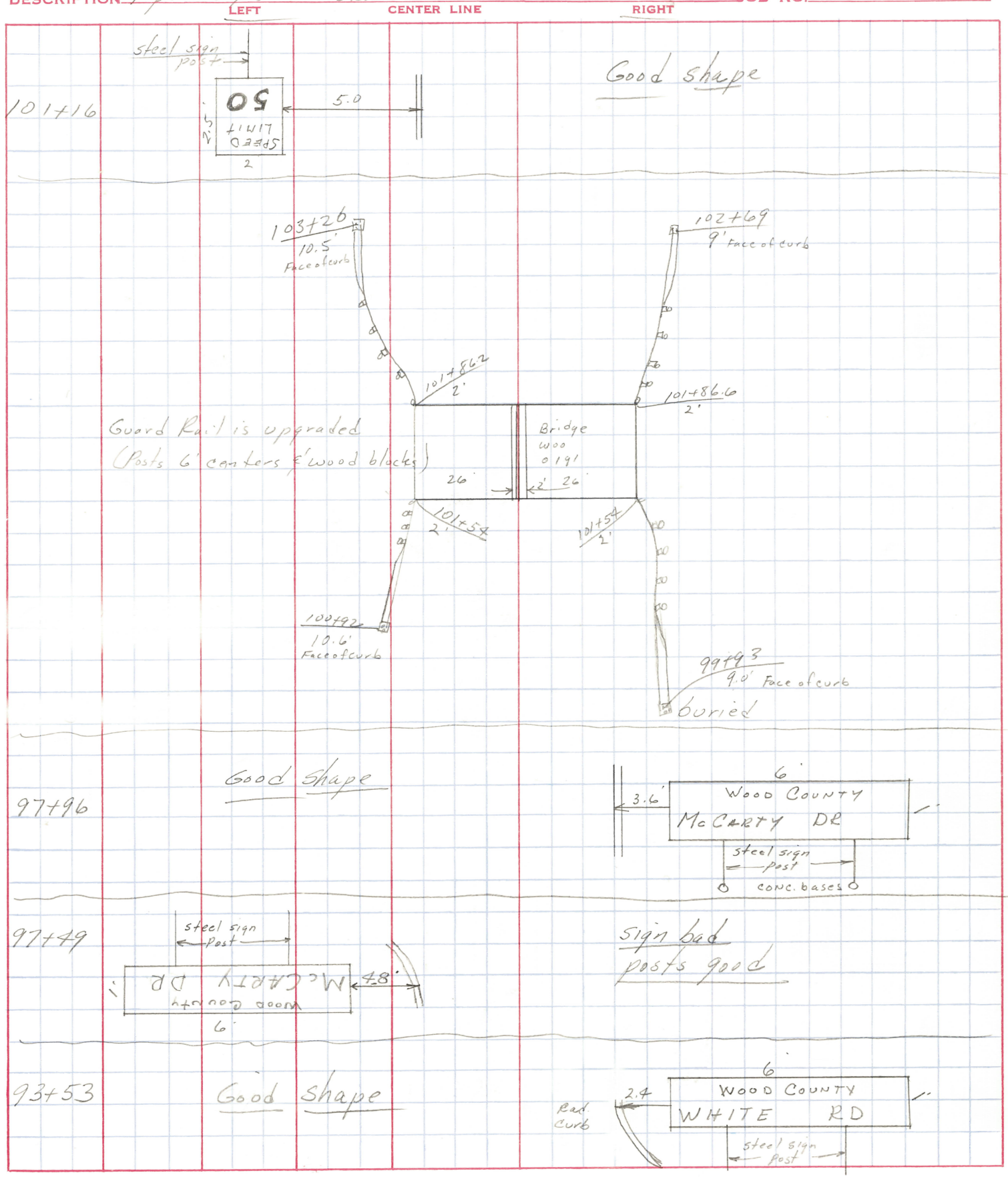

PERSONNEL	TITLE	PERSONNEL	TITLE
CRONIN		SCHNEIDER	
LEYMAN		MOSSER	
		BARBOUR	

COUNTY Wood

DATE 12/23/80

S. R. #795

WEATHER OVERCAST

SEC. 0.69 - 5.00 SLM TEMP. 32°

DESCRIPTION Topo - Signs - Guard Rail etc

JOB NO. _____

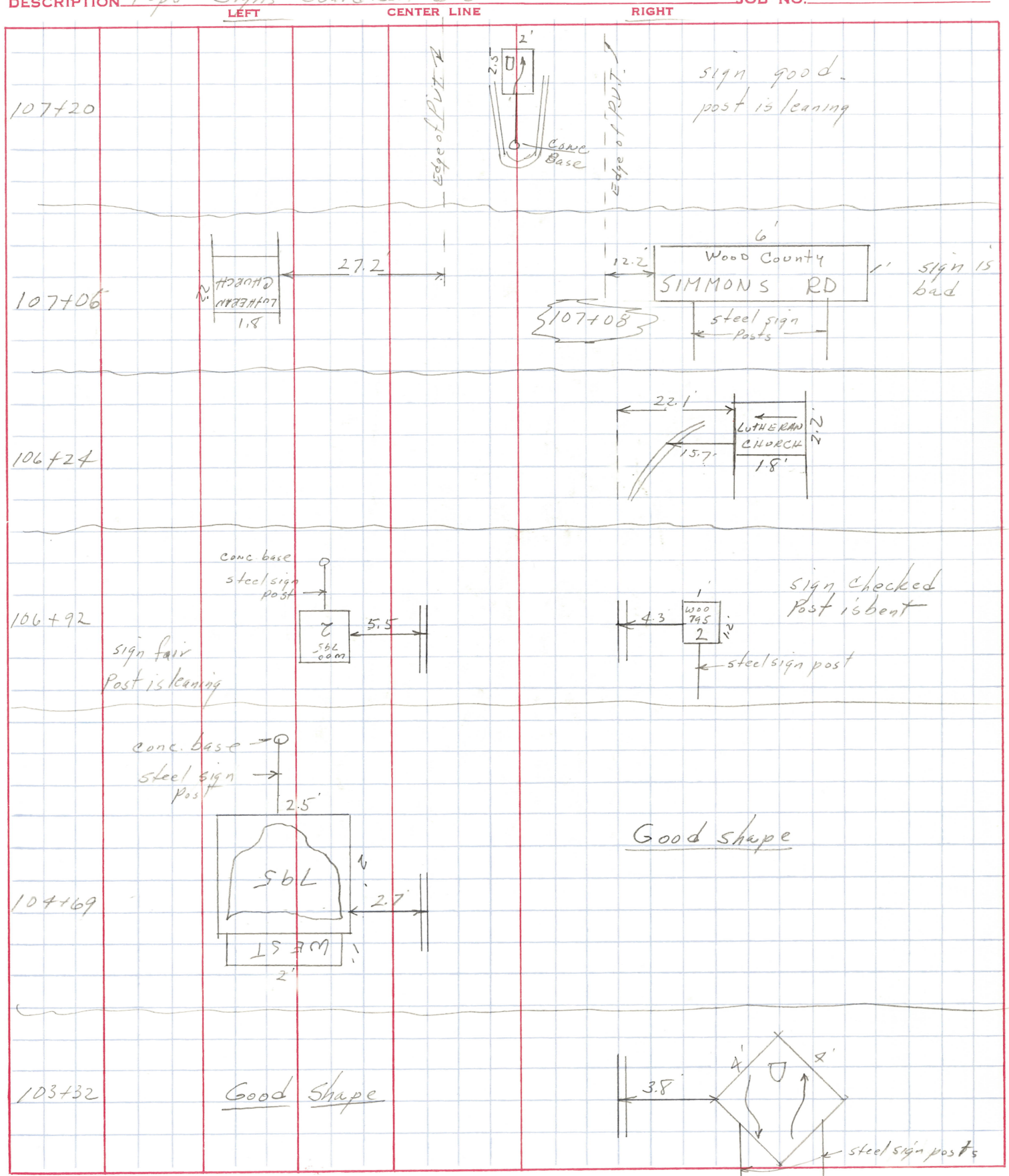

PERSONNEL	TITLE	PERSONNEL	TITLE	COUNTY	DATE
Cronin				Wood	11/14/81
Ripple				S. R. #795	WEATHER overcast
Geyman				SEC. 0.69 - 3.00 SLM	TEMP. 20°

DESCRIPTION Topo-Signs LEFT CENTER LINE RIGHT JOB NO.

110+63	<u>Good Shape</u>		
109+38	<u>Good Shape</u>		
108+65			<u>Good Shape</u>
108+15	<u>Good Shape</u>		

PERSONNEL TITLE PERSONNEL TITLE
 CROWIN SNIEDER
 RIPLE BARBOUR
 GEYMAN

COUNTY Wood

DATE 1/14/81

S. R. 4795

WEATHER overcast

SEC. 0.69-500

TEMP. 20°

DESCRIPTION Topo - Signs

JOB NO. 6

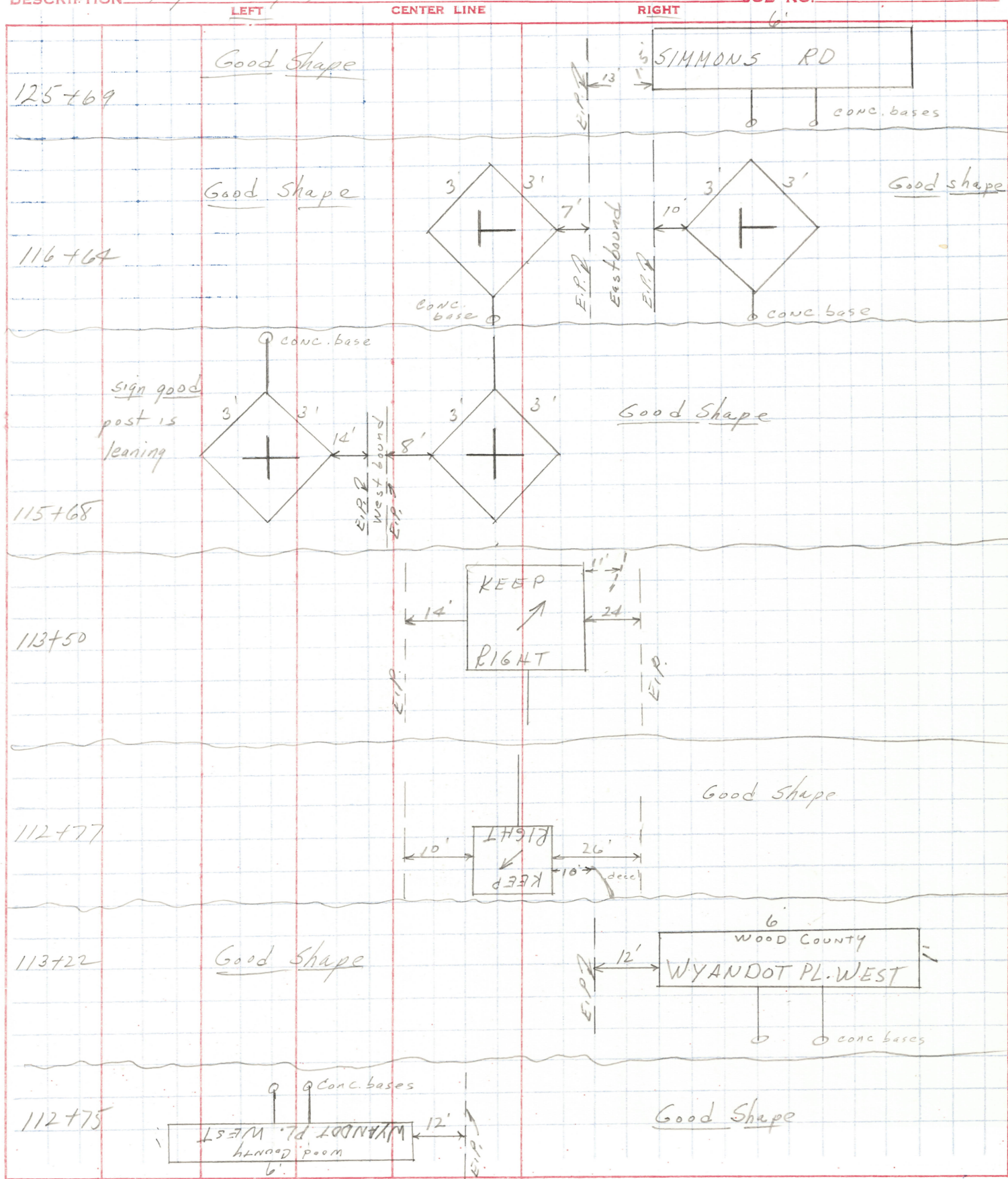

PERSONNEL TITLE PERSONNEL TITLE

CRONIN SCHNEIDER

COUNTY Wood

DATE 1/14/81

RIPPE BARBOUR

S. R. # 795

WEATHER OVERCAST

GEYMAN

SEC. 0.69-5.00

TEMP. 20°

DESCRIPTION Topo-Signs JOB NO.

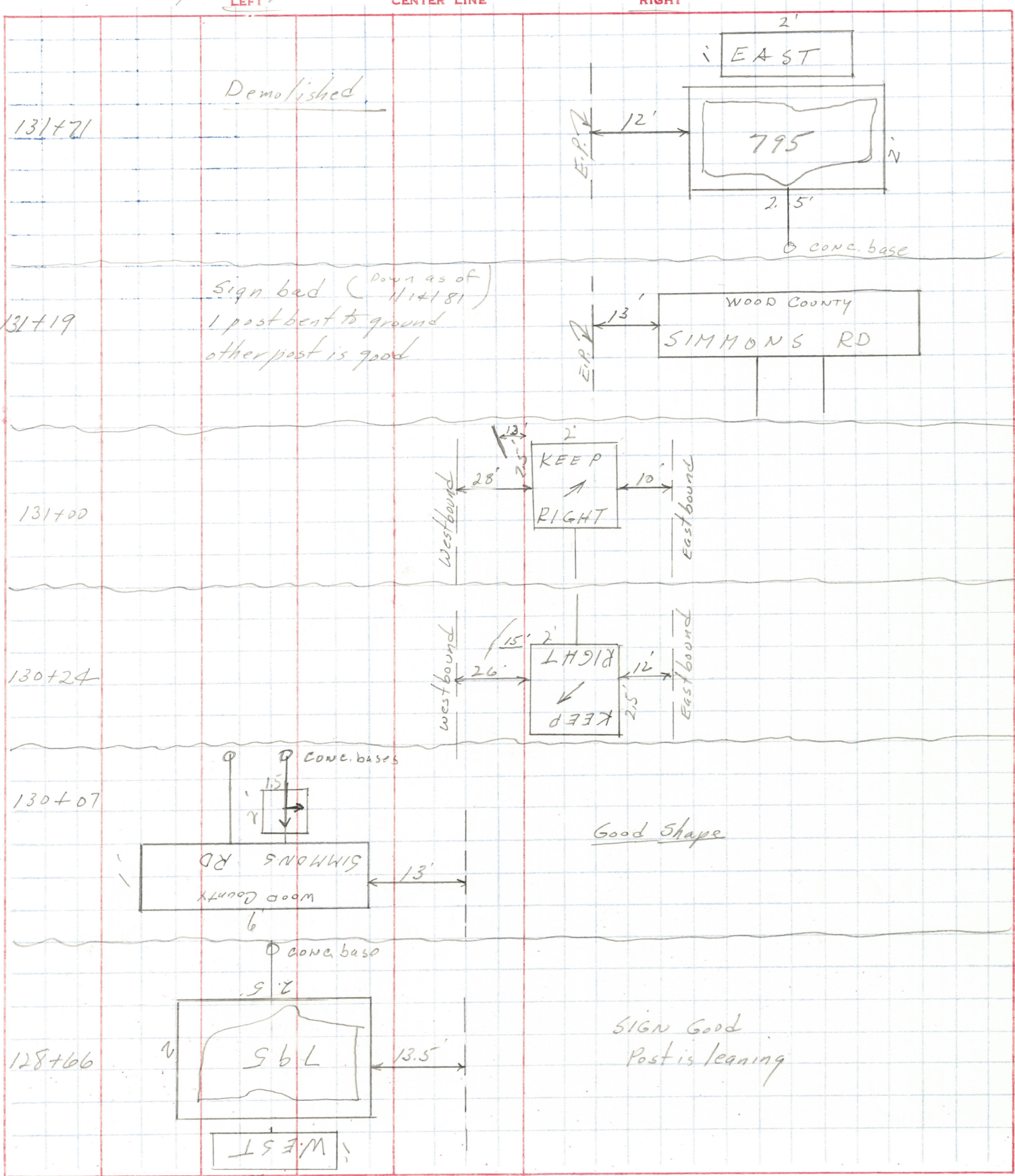

PERSONNEL: CRONIN, RIPPLE, GEYMAN
 TITLE: _____
 PERSONNEL: SCHNEIDER, BARBOUR
 TITLE: _____
 COUNTY: Wood
 DATE: 1/14/81
 S. R. # 795
 WEATHER: overcast
 SEC. 0.69-5.00
 TEMP. 20°

DESCRIPTION: Topo - Signs JOB NO. _____

	LEFT	CENTER LINE	RIGHT
144+69			Good Shape
141+56	<p>WHITE ON GREEN WHITE IS CHECKED Badly Post ARE GOOD</p>		
140+72	<p>GOOD SHAPE</p>		<p>GOOD SHAPE</p>
136+48	<p>Good SHAPE</p>		<p>SIGN GOOD Post BENT</p>
135+69			<p>Sign is fair (checked) posts are OK</p>
132+41			<p>GOOD SHAPE</p>

PERSONNEL TITLE PERSONNEL TITLE
 CRONIN SCHNEIDER
 RIPPLE BARBOUR
 GEYMAN

COUNTY Wood DATE 1/14/81
 S. R. # 795 WEATHER OVERCAST
 SEC. 0.69 - 5.00 5.2M TEMP. 24°

DESCRIPTION Topo Signs LEFT CENTER LINE RIGHT JOB NO.

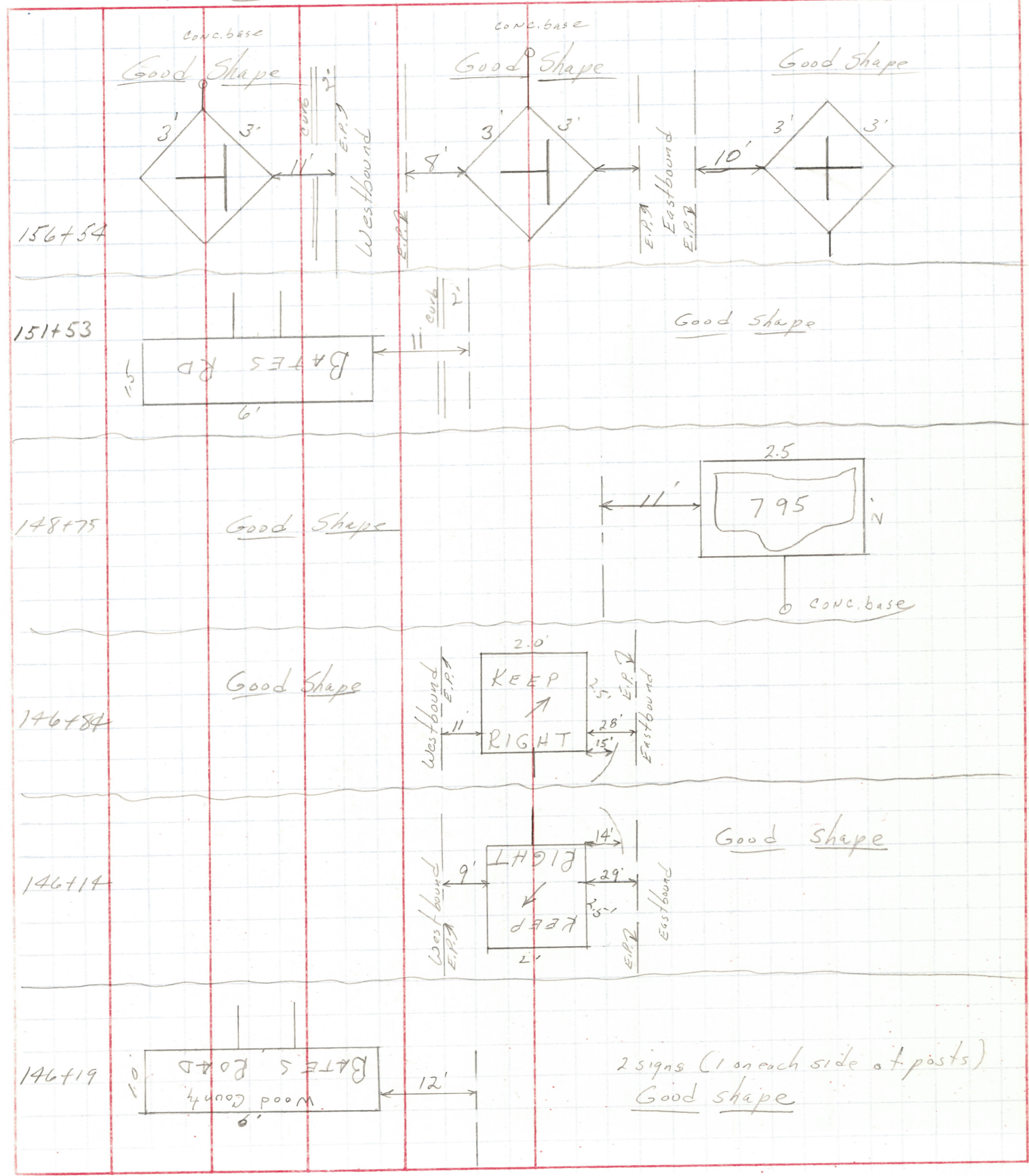

PERSONNEL	TITLE	PERSONNEL	TITLE
CROWN		Schwartz	
RIPPLE		BARBOUR	
GEYMAN			

COUNTY Wood DATE 1/14/81

S. R. #795 WEATHER OVERCAST

SEC. 0.69-5.00 SLM TEMP. 2

DESCRIPTION Topo - Signs JOB NO.

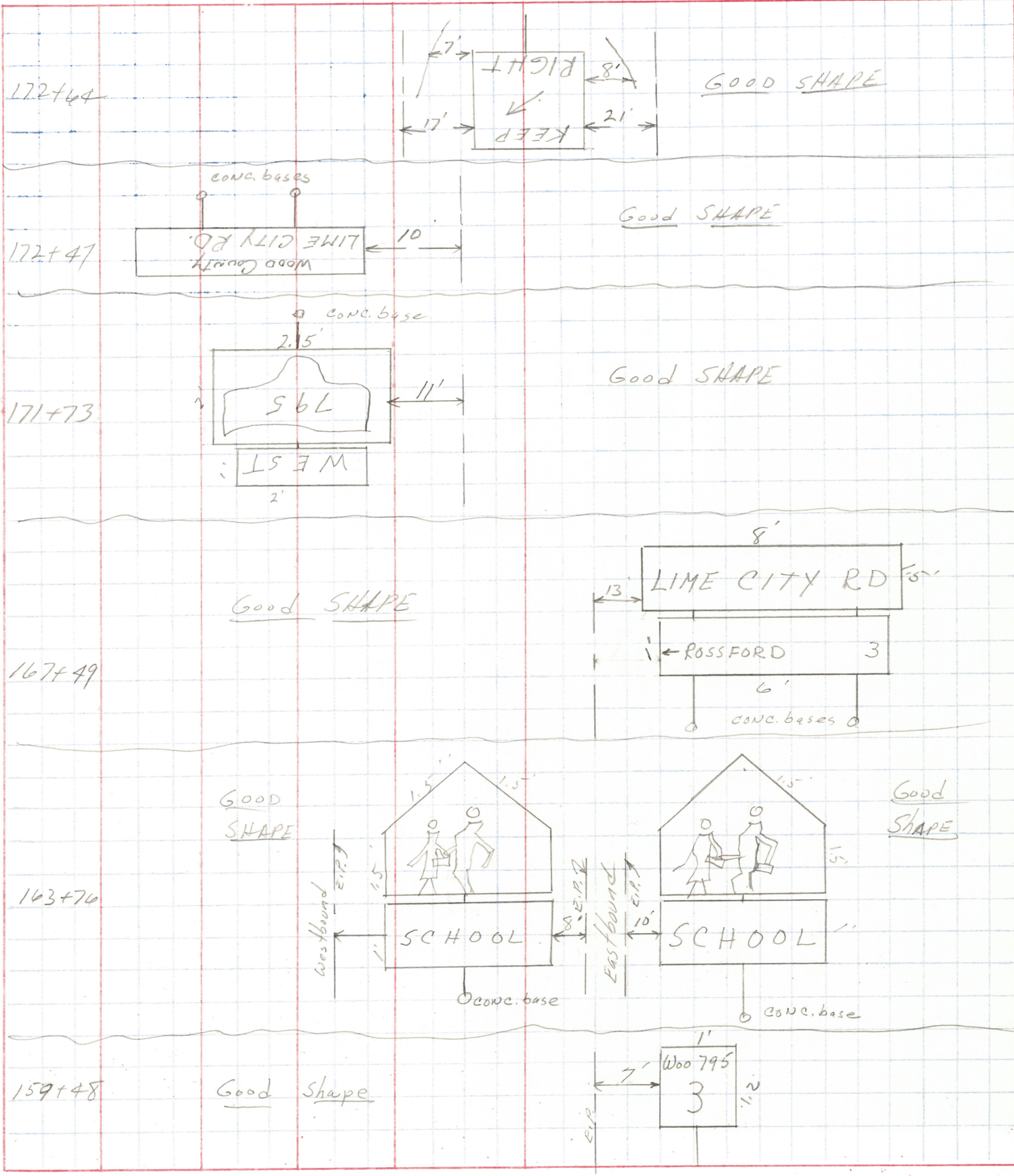

PERSONNEL TITLE PERSONNEL TITLE

CROBIN SCNEIDER (Drawings)

COUNTY Wood

DATE 11/15/81

RIPPLE

S. R. #795

WEATHER overcast-snow

GEYMAN

SEC. 0.69-5.00 SLM

TEMP. 25°

DESCRIPTION Top Signs

JOB NO.

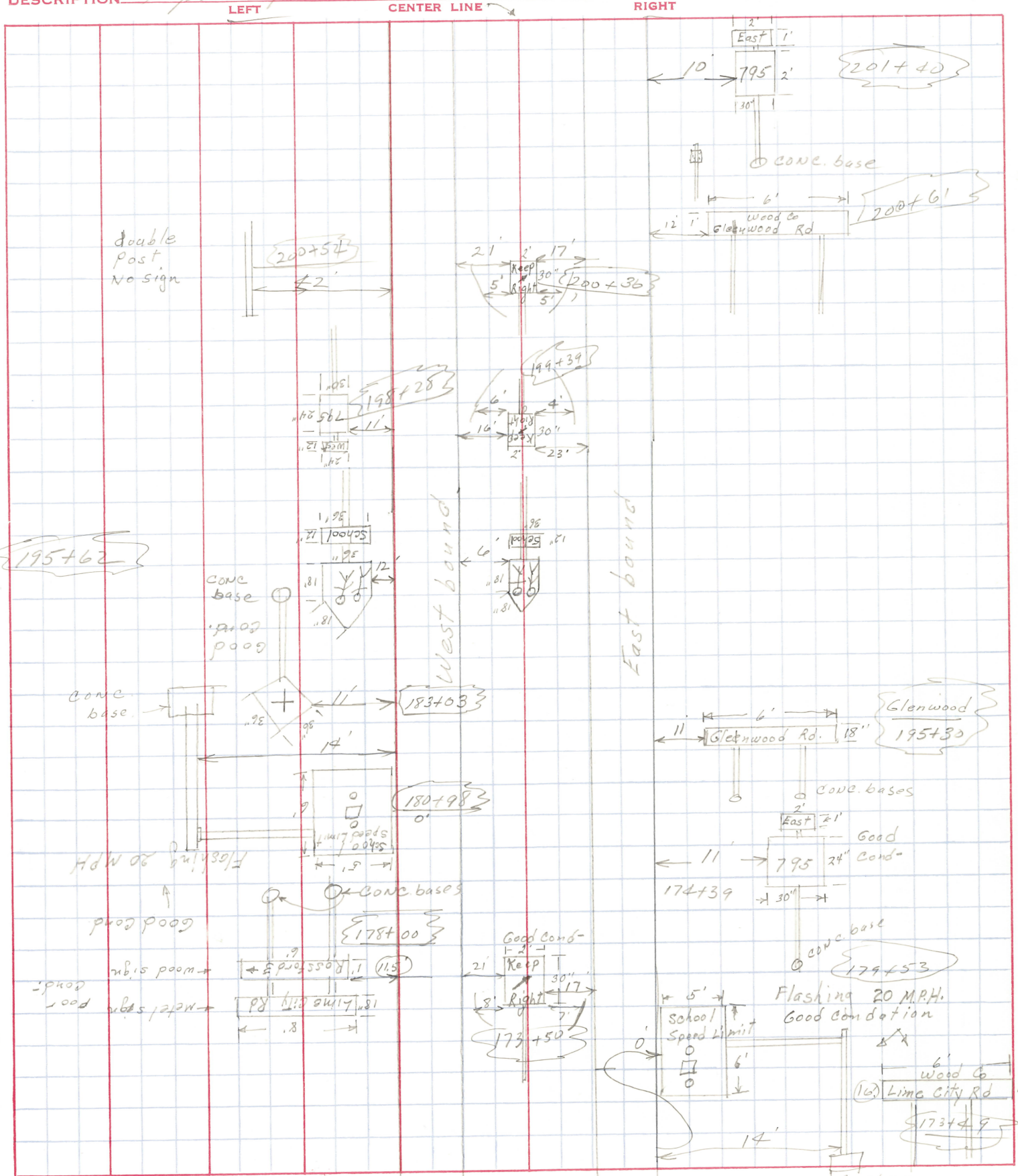

PERSONNEL	TITLE	PERSONNEL	TITLE
Cronin		SCHNEIDER (Drawing)	
RIPPLE			
GEYMAN			

COUNTY Wood DATE 1/15/81
 S. R. # 795 WEATHER OVERCAST-SNOW
 SEC. 0.69-5.00 S.L.M TEMP. 25°

DESCRIPTION Topo - Signs & Guard Rail JOB NO. _____

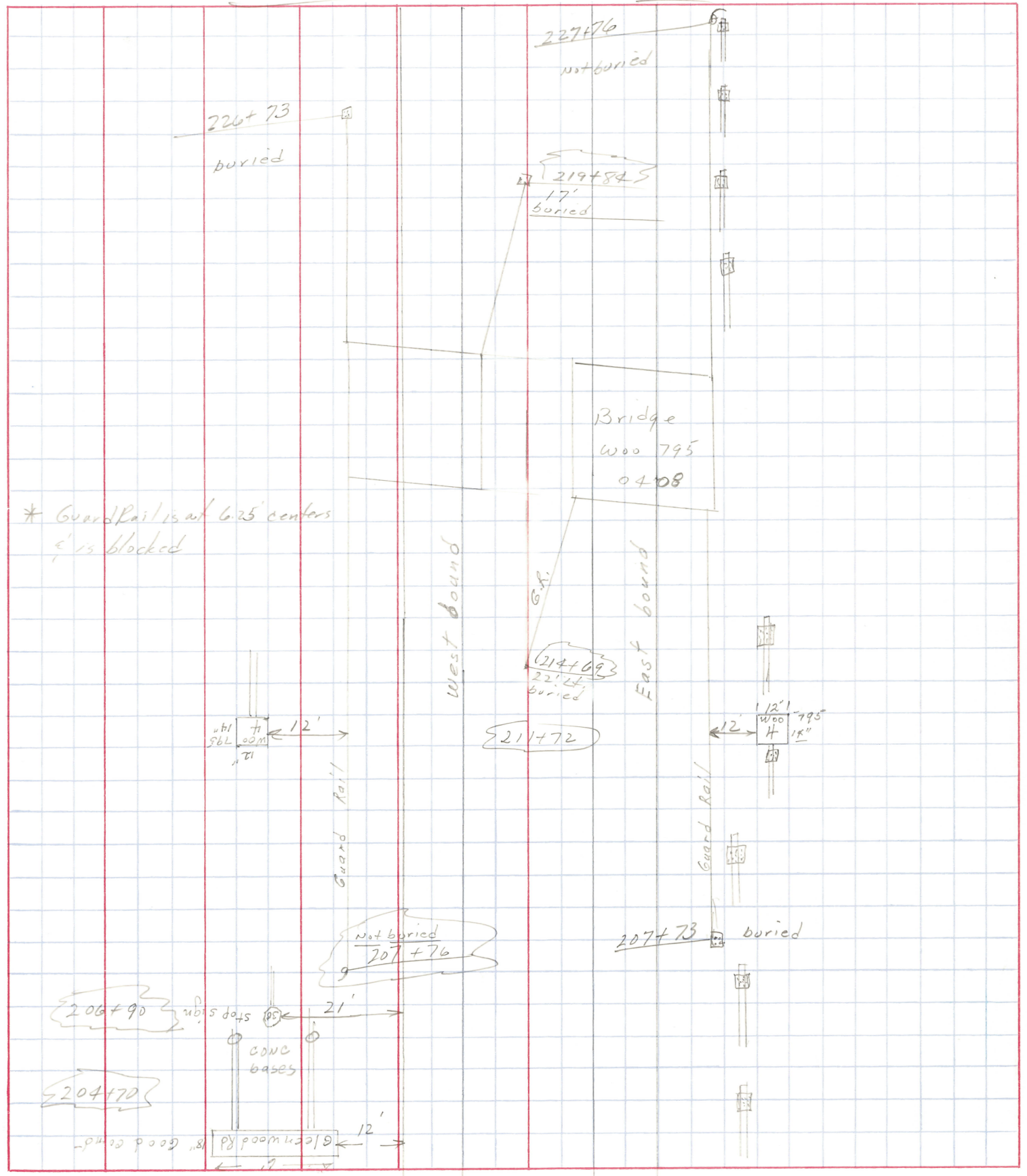

* Guard Rail is at 6.25' centers & is blocked

Bridge
Woo 795
0408

West bound

East bound

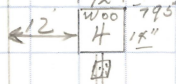
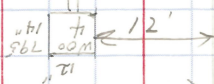

Not buried
207+76

207+73 buried

206+90

204+70

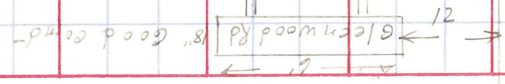

PERSONNEL	TITLE	PERSONNEL	TITLE	COUNTY	DATE	WEATHER	TEMP.
CRONIN		SCHNEIDER	(Drawings)	Wood	1/15/81	OVERCAST-SNOW	25°
RIPPLE		BARBOUR		# 795			
GEYMAN				SEC. 0.69-5.00 SLM			

DESCRIPTION: Topo - Signs JOB NO. _____

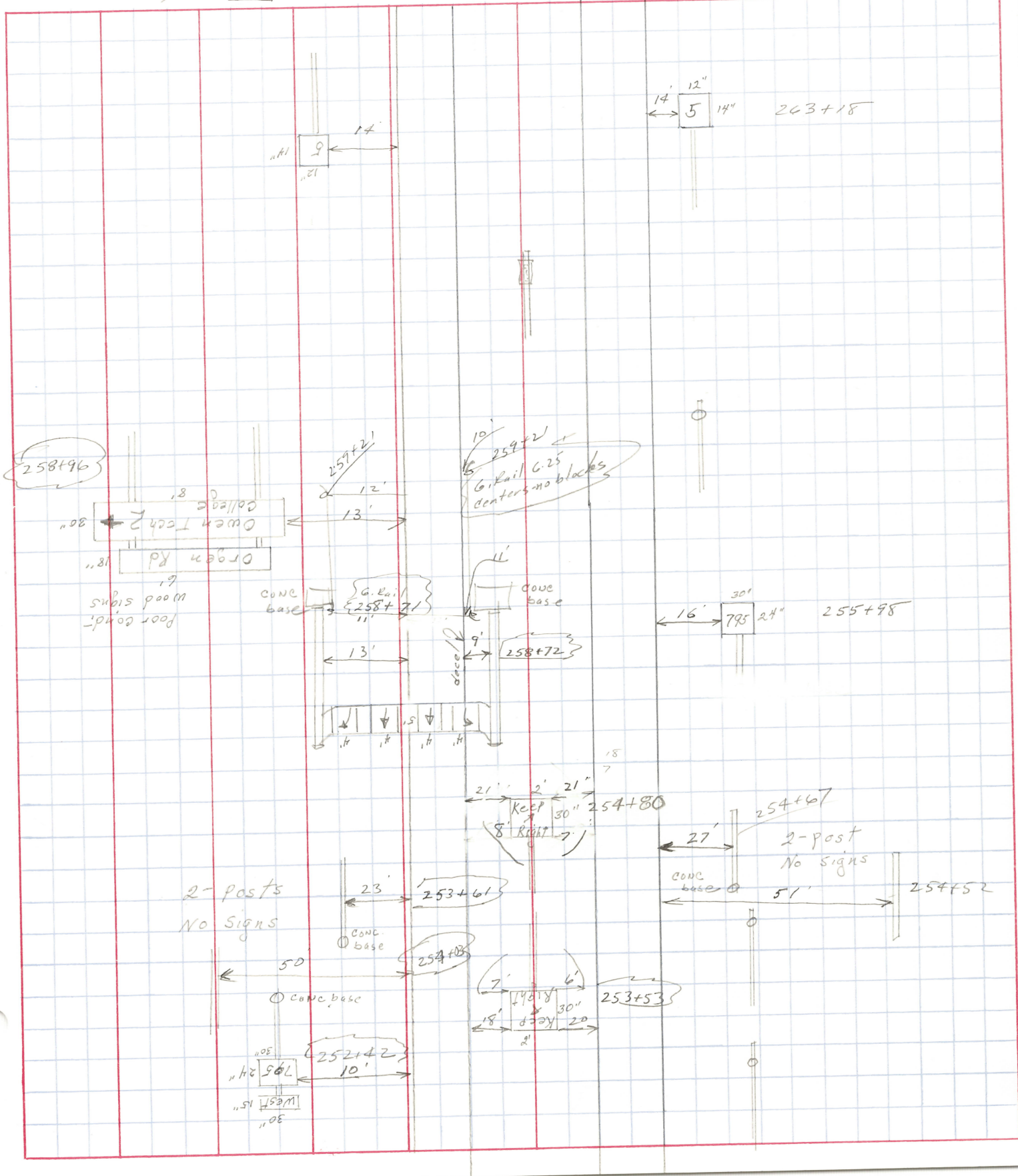

PERSONNEL	TITLE	PERSONNEL	TITLE
OPONIN			
RIPPLE			
GEYMAN			

COUNTY Wood DATE 1/15/81

S. R. #795 WEATHER overcast

SEC. 0.69-5.00 SLM TEMP. 28°

DESCRIPTION Coard Rail JOB NO. _____

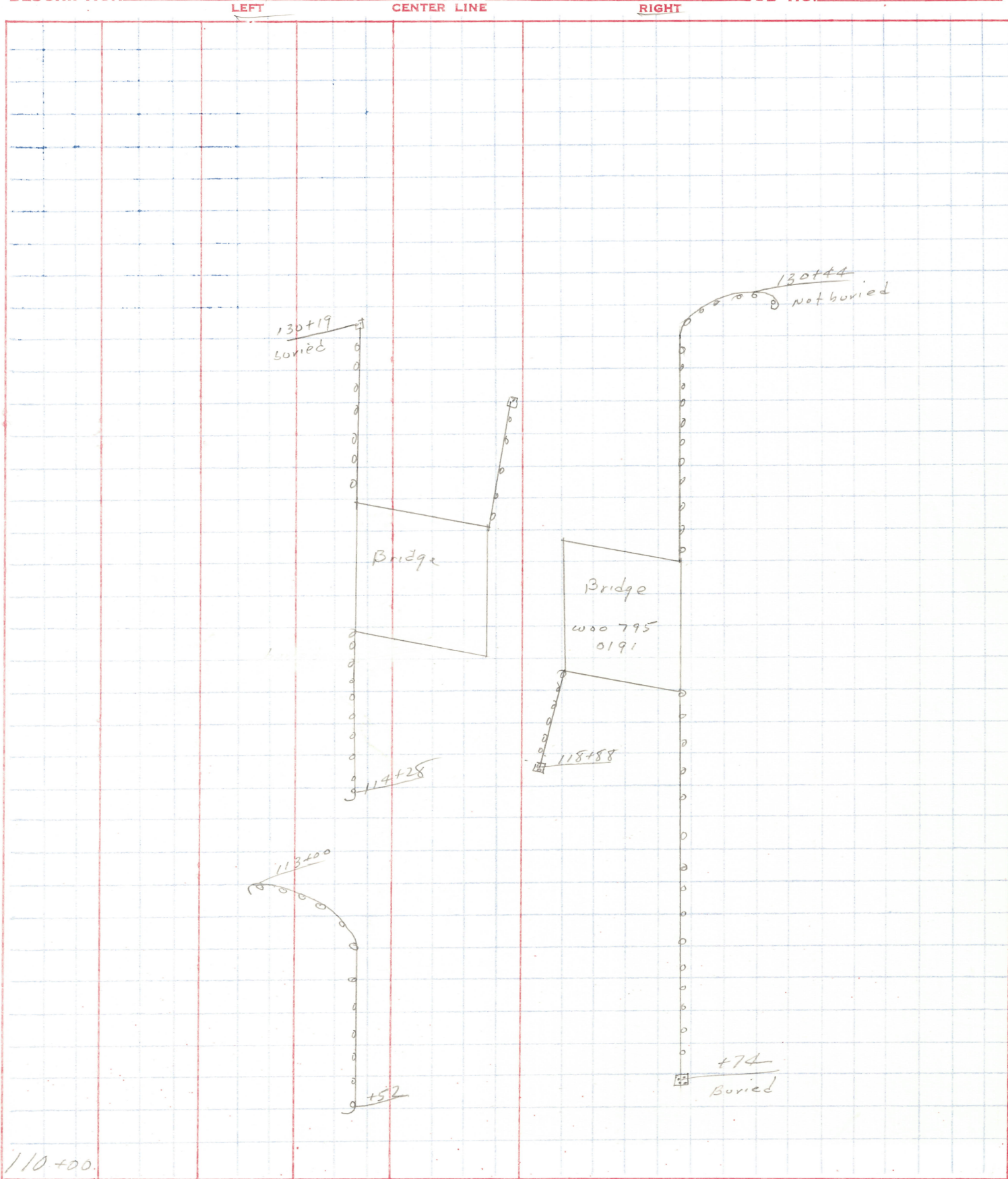

110+00

PERSONNEL	TITLE	PERSONNEL	TITLE
CROWIN			
RIPPLE			
GEYMAN			

COUNTY Wood

DATE 1/15/81

S. R. #795

WEATHER overcast

SEC. 0.69-5.00 SLM TEMP. 28°

DESCRIPTION Guard Rail

JOB NO.

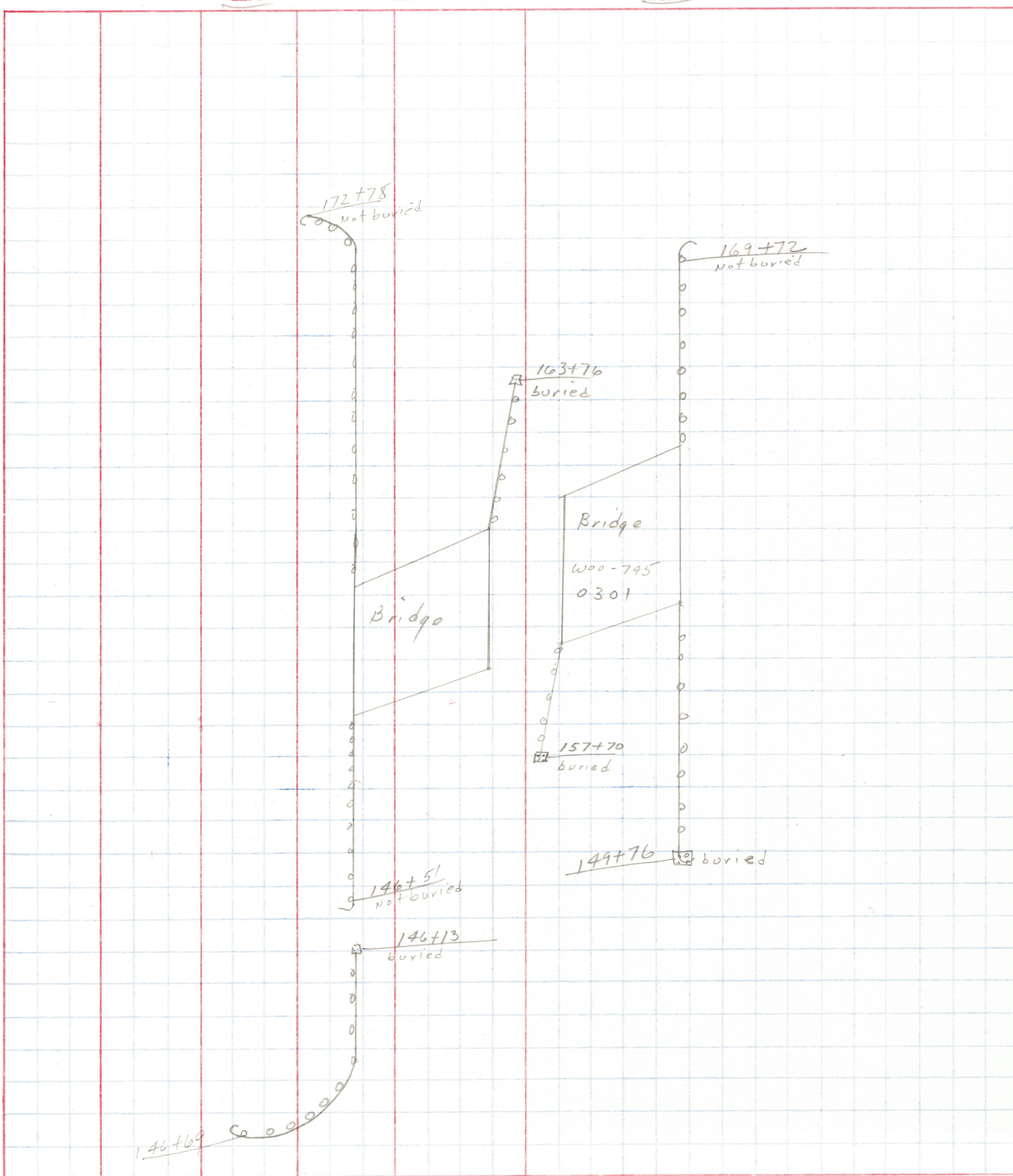

PERSONNEL	TITLE	PERSONNEL	TITLE
<u>CRONIN</u>		<u>SCHNEIDER</u>	
<u>RIPPLE</u>		<u>MOSSER</u>	
<u>GEYMAN</u>		<u>BARBOUR</u>	

COUNTY WOOD DATE 1/21/81

S. R. #795 WEATHER overcast

SEC. 0.69-5.00 SLM. TEMP. 26°

DESCRIPTION Topo - Driveways

STATION	LEFT		CENTER LINE	RIGHT		JOB NO.
<u>Sta.</u>	<u>@ 8.0' LT of L.T.E.P.</u>	<u>@ 14' LT of L.T.E.P.</u>		<u>Sta.</u>	<u>@ 8.0' RT of R.T.E.P.</u>	<u>@ 14.0' RT of R.T.E.P.</u>
<u>229+94</u>	<u>48.0'</u>	<u>37.5'</u>				
<u>207+08</u>	<u>47.0'</u>	<u>36.5'</u>				
<u>197+28</u>	<u>24.0'</u>	<u>15.5'</u>				
<u>195+91</u>	<u>51.0'</u>	<u>42.0'</u>				
<u>194+74</u>	<u>23.0'</u>	<u>16.5'</u>				
<u>194+13</u>	<u>24.5'</u>	<u>17.0'</u>				
<u>191+70</u>	<u>26.5'</u>	<u>17.5'</u>				
<u>190+21</u>	<u>23.5'</u>	<u>17.0'</u>				
<u>188+06</u>	<u>24.0'</u>	<u>16.5'</u>		<u>189+51</u>	<u>36.5'</u>	<u>24.0'</u>
<u>175+70</u>	<u>58.5'</u>	<u>46.5'</u>		<u>183+06</u>	<u>24.5'</u>	<u>17.5'</u>
<u>174+09</u>	<u>54.0'</u>	<u>41.5'</u>				
<u>145+13</u>	<u>25.5'</u>	<u>19.5'</u>				
<u>144+14</u>	<u>27.5'</u>	<u>18.5'</u>				
<u>141+79</u>	<u>25.5'</u>	<u>17.5'</u>				
<u>136+82</u>	<u>23.0'</u>	<u>16.0'</u>				
<u>130+45</u>	<u>27.5'</u>	<u>18.5'</u>				

Drives about 8.0' berm

Drives about 8.0' berm

PERSONNEL TITLE PERSONNEL TITLE SHEET NO. 1/2
CLONIN _____ COUNTY Wood DATE 1/20/81
RIPPLE _____ S. R. #795 WEATHER overcast
GEYMAN _____ SEC. 0.69-5.00 SLM TEMP. 36°

DESCRIPTION Guard Rail - (Height) JOB NO. _____

LEFT		CENTER LINE		RIGHT	
	Height	Dist. Out.		Height	Dist. Out.
130+00	29 ³ / ₄ "	10'		130+00	30" 10'
128+00	26 ¹ / ₂ "	10'		128+00	27" 10'
126+50	24"	10'		126+00	27" 10'
119+00	26 ³ / ₄ "	10'		118+00	25" 10'
116+00	25"	10'		116+00	25 ¹ / ₂ " 10'
114+28	27"	10'		112+00	28 ¹ / ₂ " 10'
112+00	26 ¹ / ₂ "	10'			
110+75	22"	10'			

Feb 21 81

SHEET NO. 2/2

PERSONNEL	TITLE	PERSONNEL	TITLE
Schneider			
Barbour			
Mosser			

COUNTY Wood DATE 1/20/81

S. R. 795 WEATHER overcast

SEC. 0.69-5.00 S.L.M TEMP. 36°

DESCRIPTION Guard Rail - (Height) JOB NO.

		LEFT	CENTER LINE	RIGHT		
				150+0	10' Rt.	26"
				152+0	10' Rt.	27 1/2"
				156+0	10' Rt.	26"
				166+0	10' Rt.	26 1/2"
				168+0	10' Rt.	23"
208+0	10' Lt.	22 1/2"		208+0	10' Rt.	24"
212+0	10' Lt.	22 1/2"		212+0	10' Rt.	25 1/2"
220+0	10' Lt.	27"		220+0	10' Rt.	25"
224+0	10' Lt.	27"		224+0	10' Rt.	25 1/2"

PERSONNEL	TITLE	PERSONNEL	TITLE
CROBIN			
RIPPLE			
GEYMAN			

COUNTY Wood DATE 1/22/81
 S. R. #795 WEATHER OVERCAST-WINDY
 SEC. 0.69- 5.00 S.L.M. TEMP. 30°

DESCRIPTION Intersection & X-OVER JOB NO. _____
 LEFT CENTER LINE RIGHT

