

O.D.O.T. DISTRICT 2 SURVEY OFFICE (USE ONLY)

PERSONNEL _____ REFERENCE NO. 14 SHEET 11 OF 19
 NOTES HUSS DATE 5/24/12 ROUTE SR 795
 H.C. HUSS WEATHER FAIR COUNTY WOOD
 R.C. CANTERBURY TEMP. 82° TOWNSHIP LAKE
 _____ SECTION 18
 _____ T 7 N R 12 E

TYPE MONUMENT CONC. MON.
 ON SURFACE - ~~BELOW~~ ON _____
 LEFT - Q PAV'T - RIGHT _____
26.8' N TO N _____ EDGE PAVEMENT
 S.L.M. 297+98.11
 GRID: NORTHING: 692941.731 EASTING: 1688930.409

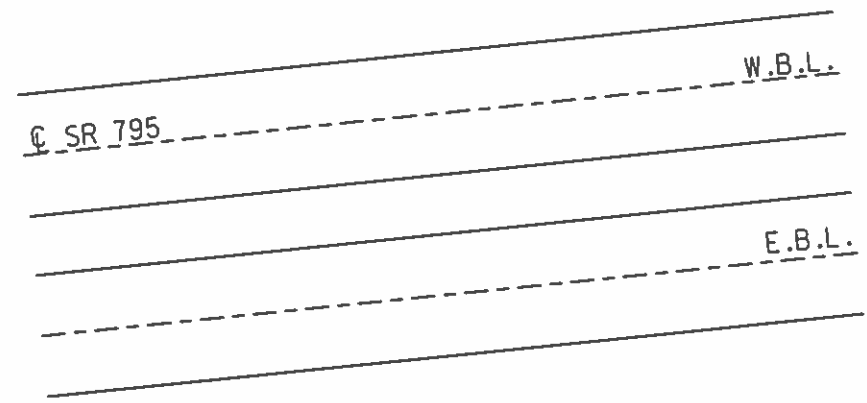
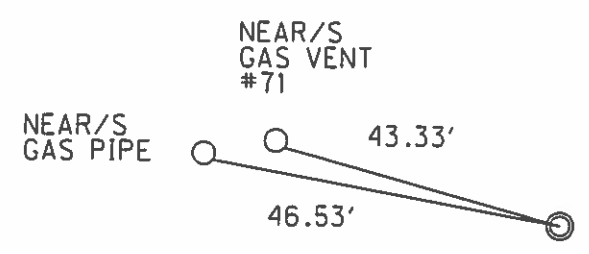
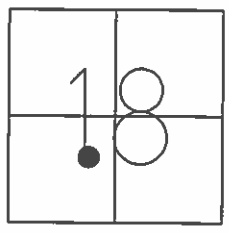

RECORD: P.I.
 STA. 297+98.11
 FD IPIN IN CONC.
 26.8' TO W.B.L.
 N/EDGE
 8/16/71, I.S.
 FD CONC. MON.
 GPS, REF14