

O.D.O.T. DISTRICT 2 SURVEY OFFICE (USE ONLY)

PERSONNEL \_\_\_\_\_ REFERENCE NO. 19 SHEET 17 OF 19  
 NOTES HUSS DATE 5/23/12 ROUTE SR 795  
 H.C. CANTERBURY WEATHER SUNNY COUNTY WOOD  
 R.C. HUSS TEMP. 80° TOWNSHIP LAKE  
 \_\_\_\_\_ SECTION 21  
 \_\_\_\_\_ T 7 N R 12 E

TYPE MONUMENT P.K.NAIL  
 ON SURFACE - ~~BELOW~~ ON \_\_\_\_\_  
 LEFT - Q PAV'T - RIGHT \_\_\_\_\_  
 \_\_\_\_\_ TO \_\_\_\_\_ EDGE PAVEMENT  
 S.L.M. 417+64

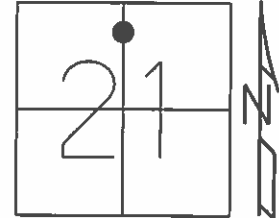

GRID: NORTHING: 690272.911 EASTING: 1699518.615

RECORD:  
 STA. 417+84 ±  
 FD P.K.NAIL  
 13.2' TO N/EP  
 9/10/71, I.S.  
 GPS, REF19  
 5/23/12, MC

TOP S/E COR.  
 ON E/S OF  
 ODOT CONTROL  
 BOX

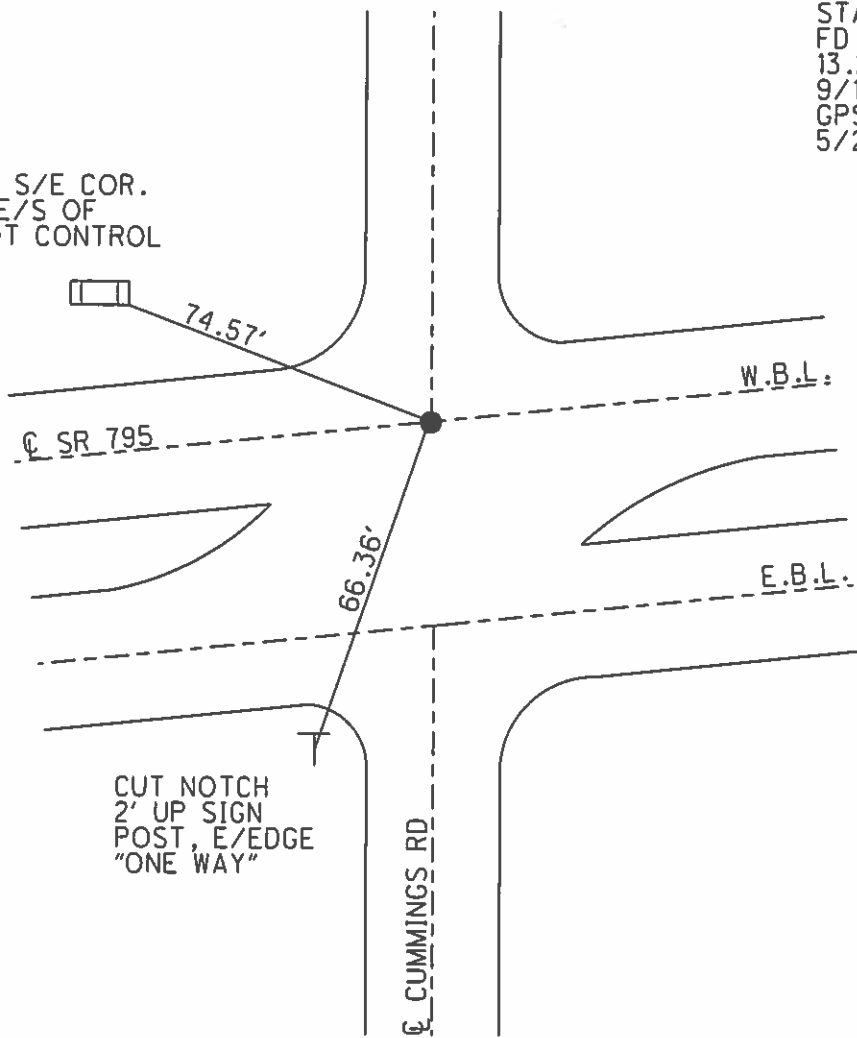

CUT NOTCH  
 2' UP SIGN  
 POST, E/EDGE  
 "ONE WAY"

Q CUMMINGS RD