

8005

STATE OF OHIO DEPARTMENT OF HIGHWAYS W00-6-(11.13-13.11) WOOD COUNTY CITY OF BOWLING GREEN

FED. RD. DIVISION	STATE	PROJECT	
2	OHIO	STATE	
W00-6 (11.13-13.11)			

1
17

SEP 20 1962
GROUND PHOTOLAB

CONVENTIONAL SIGNS

County Line	-----
Township Line	-----
Section Line	-----
Corporation Line	-----
Center Line	-----
Pole Line	⊕ ⊕ ⊕ ⊕ ⊕ ⊕ ⊕ ⊕ ⊕ ⊕ ⊕ ⊕ ⊕ ⊕
Railroad	-----
Drainage	Exist ----- New -----

INDEX OF SHEETS

Title Sheet	1
Typical Sections	2-3
General Notes	4
General Summary	4
Catch Basin Detail	5
Sub Summaries	5-6
Calculations	7
Plan & Profile Sheets	8-17

LINE DATA

	PROJECT	LIN. FT.	MILES	WORK	LINE	MILE
Begin	587+7665			587+7665		
Suspend	624+052	3628.55		624+052	3,628.55	
Resume	624+140			624+140		
Suspend	641+80	1,766.00		641+962	1,782.20	
Resume	642+65			642+522		
Suspend	658+44	1,579.00		658+440	1,591.80	
Resume	658+76			658+76.0		
End	699+8175	4,105.75		699+81.75	4,105.75	
TOTAL		11,079.30	2.098		11,108.30	2.103

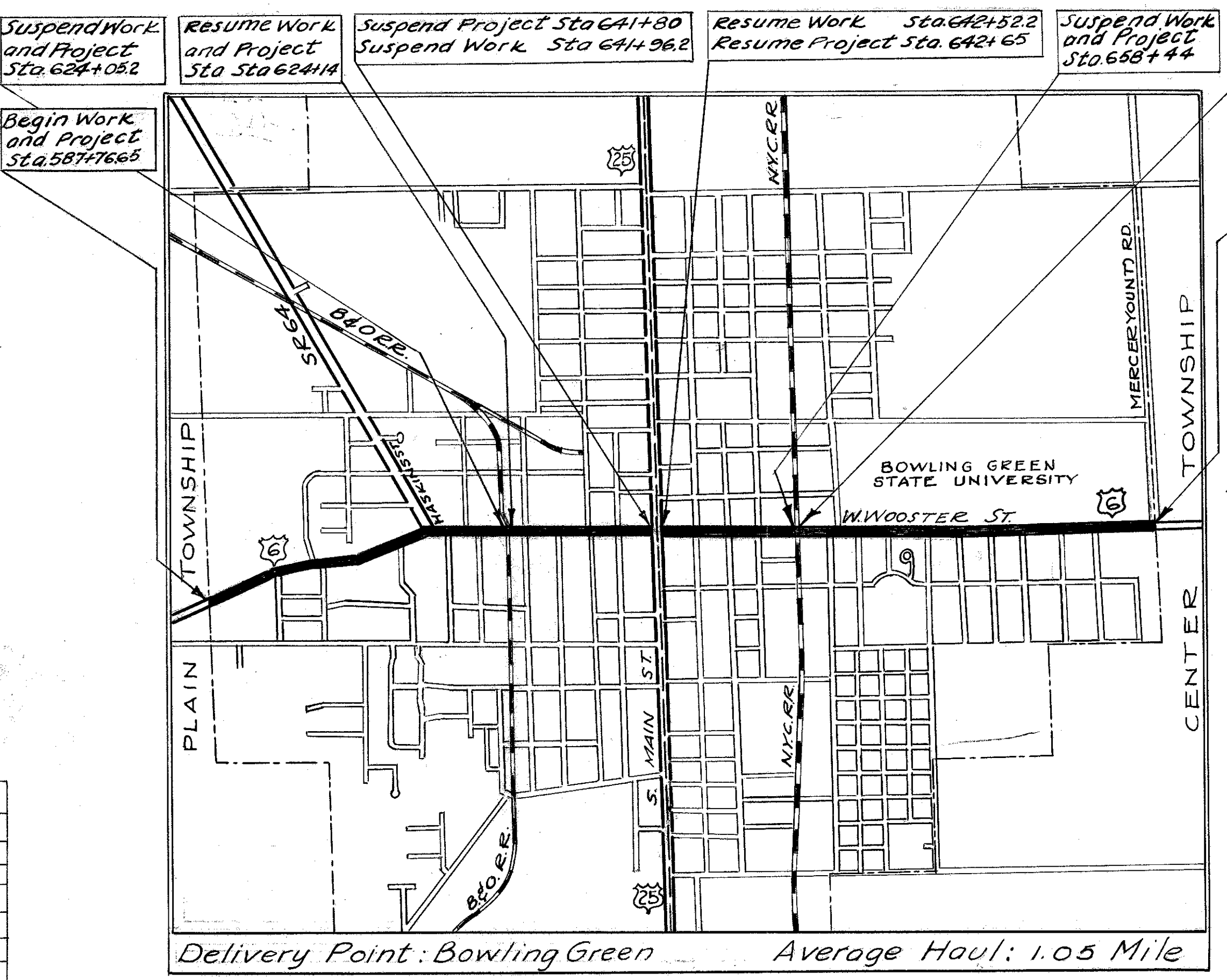

LOCATION MAP
Scale in feet
0 800 1200 2400 3600

The standard specifications of the State of Ohio Department of Highways, including changes and supplemental specifications listed in the proposal shall govern this improvement.

The right-of-way for this improvement will be provided by the State of Ohio.

I hereby approve these plans and declare the making of this improvement will not require the closing of the highway to traffic, and that provisions for the maintenance and safety of traffic will be as set forth on the plans and estimates.

Approved G. W. Leubner
Date 4-22-60 Division Deputy Director

Approved Ray E. Yeager
Date 5-18-60 Deputy Director of Planning & Programming

Approved _____
Date _____ Engineer of Bridges

Approved W. M. McManis
Date 5-16-60 Engineer of Location and Design

Approved C. W. McCaughey
Date 5-16-60 Deputy Director of Design and Construction

Approved G. A. Berry
Date 5-19-60 First Assistant Director

Approved E. S. Preston
Date 5-20-60 Director of Highways

STANDARD DRAWINGS

I-8 M.H. No 1	1-26-59	B.T-50-70-71E*	10-1-47
I-1, 2, 3, 4, 5	4-24-58	B.T-71R	3-2-53
I-12	7-1-54	G-7.07	6-1-56
L-3	4-1-50	L.J. No 1	7-1-55
L-3-A	4-1-50	T.J.	5-1-56
R1-1	7-15-58		
T-35	1-2-56		

SUPPLEMENTAL SPECIFICATIONS

SEP 20 1962
GROUND PHOTOLAB

DEPARTMENT OF COMMERCE
BUREAU OF PUBLIC ROADS

DIVISION ENGINEER _____ DATE _____

FILE NO **WOOD COUNTY**
SECS W00-6 (11.13) (13.11)

DATE OF LETTING CONTRACT _____

P.I. Sta. 588+12.1
Δ = 11°26' Lt.

P.I. Sta. 596+05.3
Δ = 5°57' Rt.

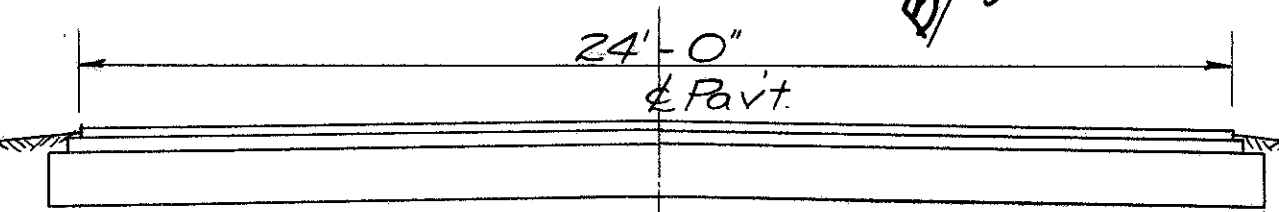
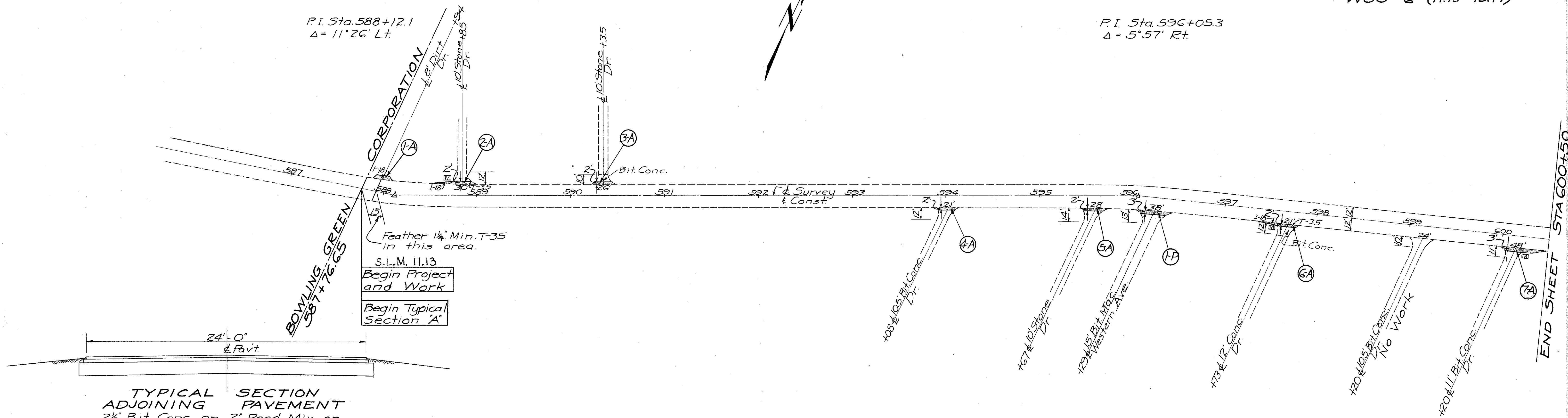

TYPICAL SECTION ADJOINING PAVEMENT
2 1/2" Bit Conc. on 2" Road Mix on 10" Waterbound Macadam, 24' wide.

S.L.M. 11.13
Begin Project and Work
Begin Typical Section 'A'

B.M. 5 bolt flange hydrant
Sta. 593+35
Elev. = 696.23

B.M. 5 bolt flange hydrant
Sta. 597+75
Elev. = 692.66

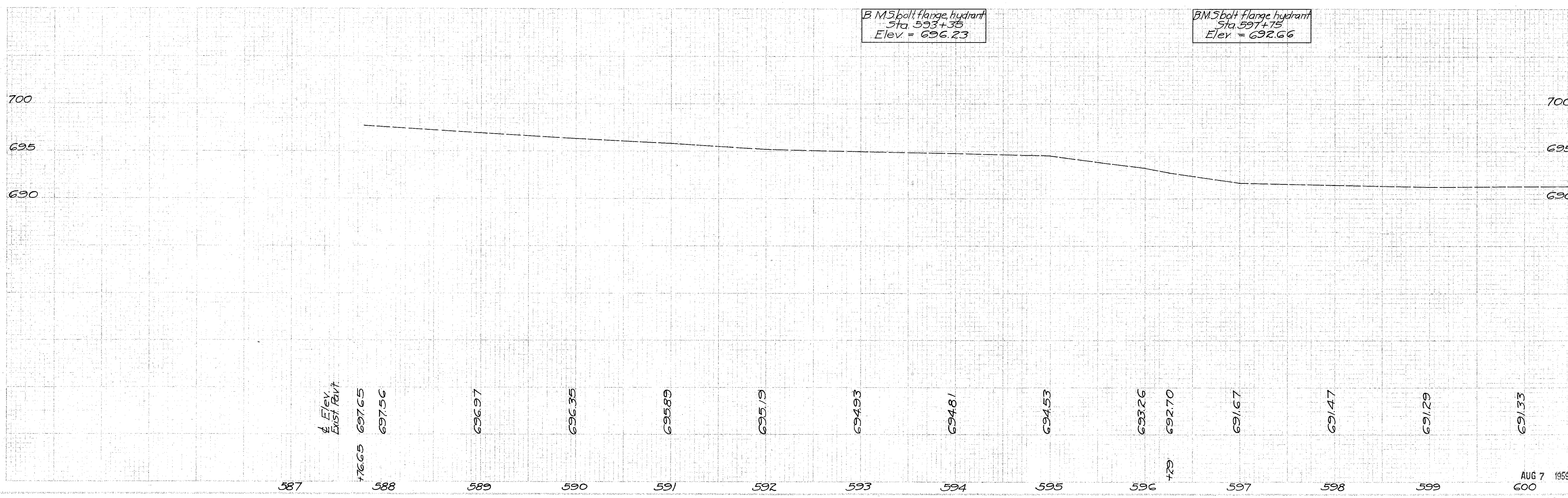

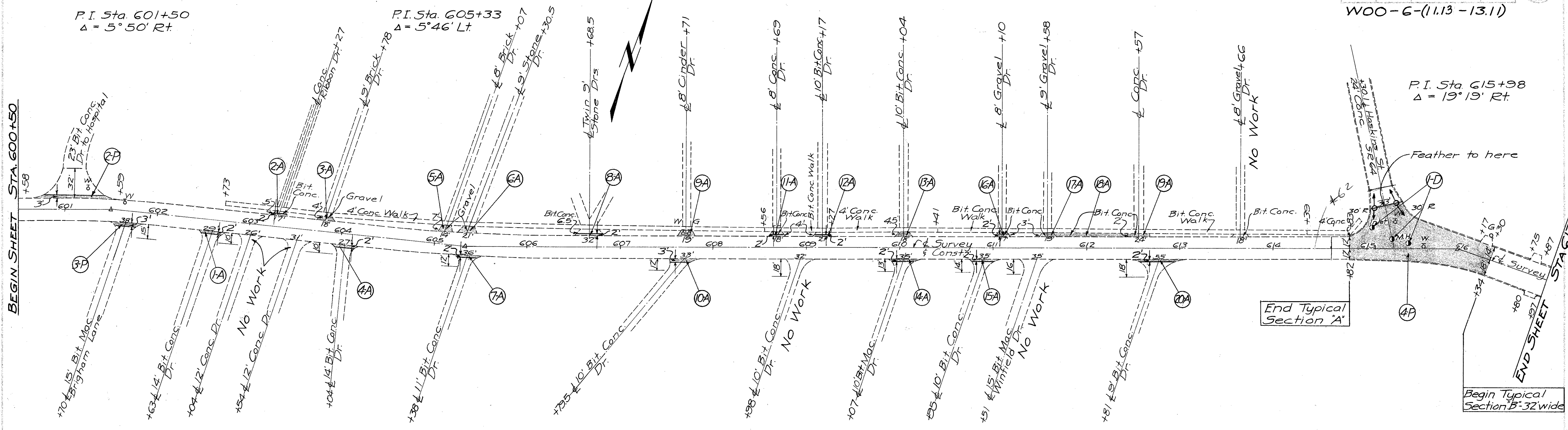

B.M. W. bolt flange hydrant
Sta. 602+20
Elev. = 692.93

B.M. S. bolt flange hydrant
Sta. 606+35
Elev. = 690.88

B.M. S. bolt flange hydrant
Sta. 611+28
Elev. = 691.14

B.M. S.W. bolt flange hydrant
Haskins & Wooster Sts.
Elev. = 691.00

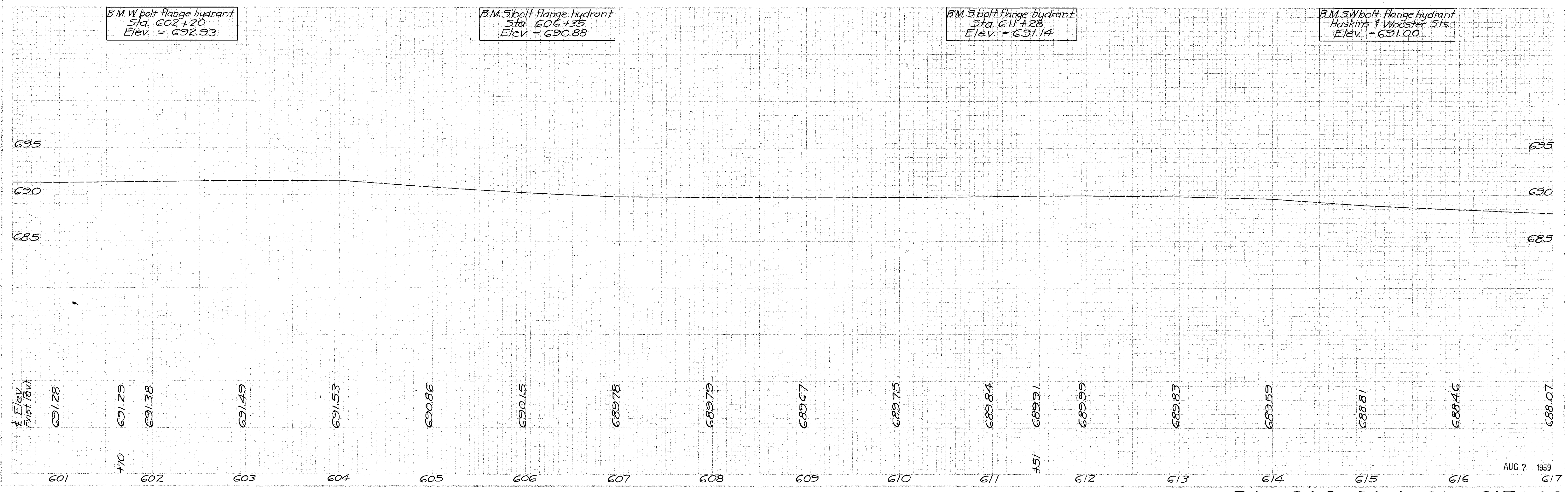

Sta. 600+50 to Sta. 617+00

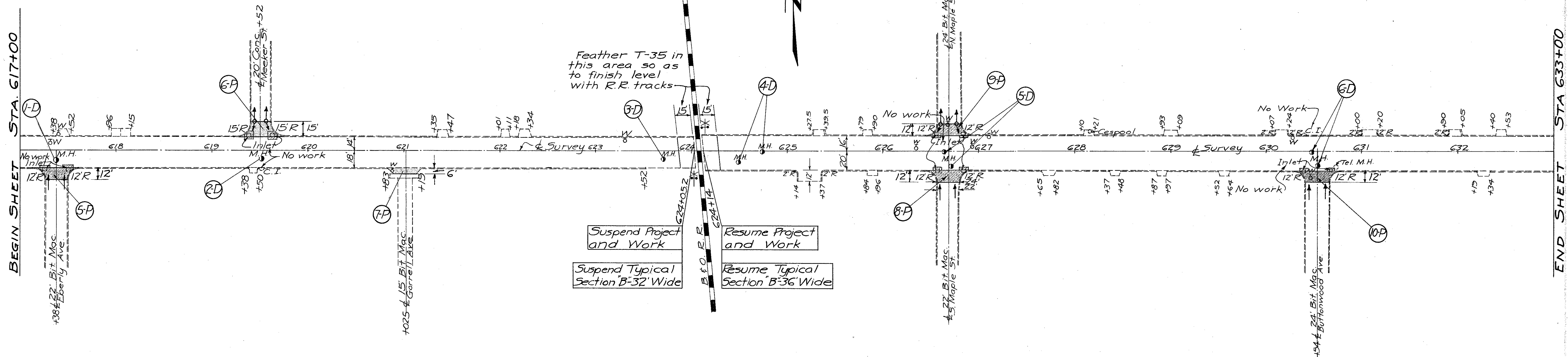

B.M. SW Cor. bot. step, house
Lt. & 608 W. Wooster
Elev. = 688.09

B.M. NE Cor. frdn. Rt. &
Avery Coal & Supply
Elev. = 688.94

B.M. SE Cor. bot. step, house
Lt. & 422 W. Wooster
Elev. = 691.03

B.M. SE Cor. bot. step, house
Lt. & 316 W. Wooster
Elev. = 692.39

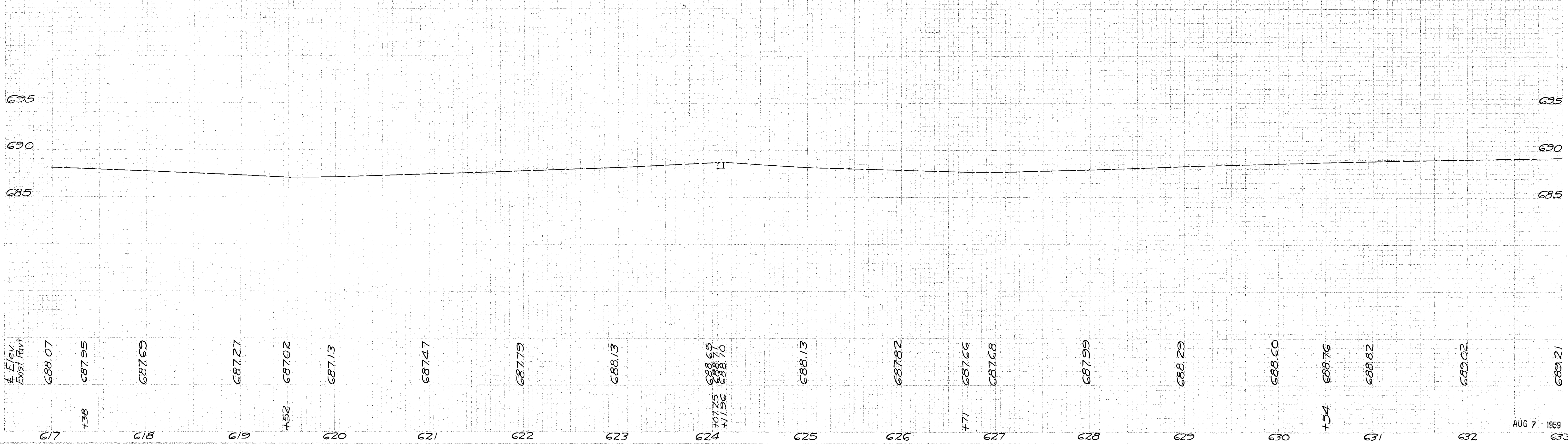

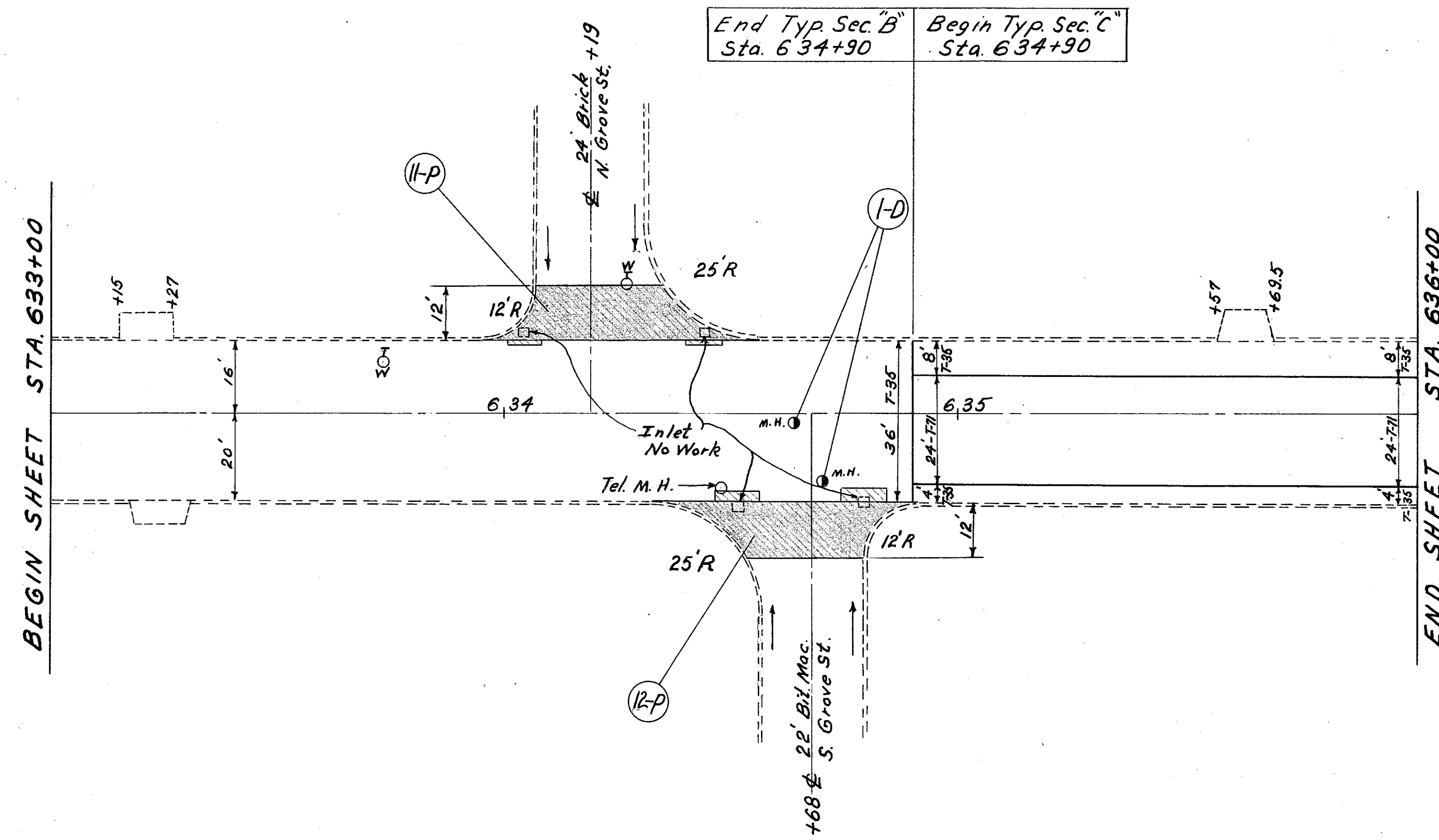

B.M. N.E. Cor. base light pole
 Rt. @ Sta. 635+52
 Elev. = 692.33

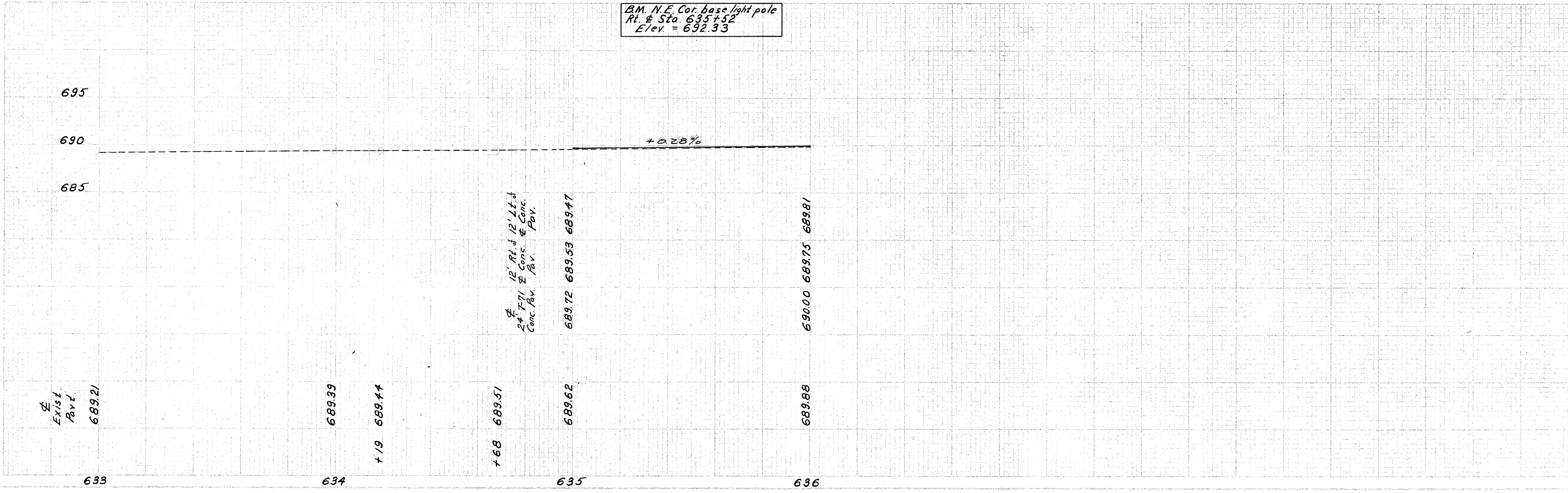

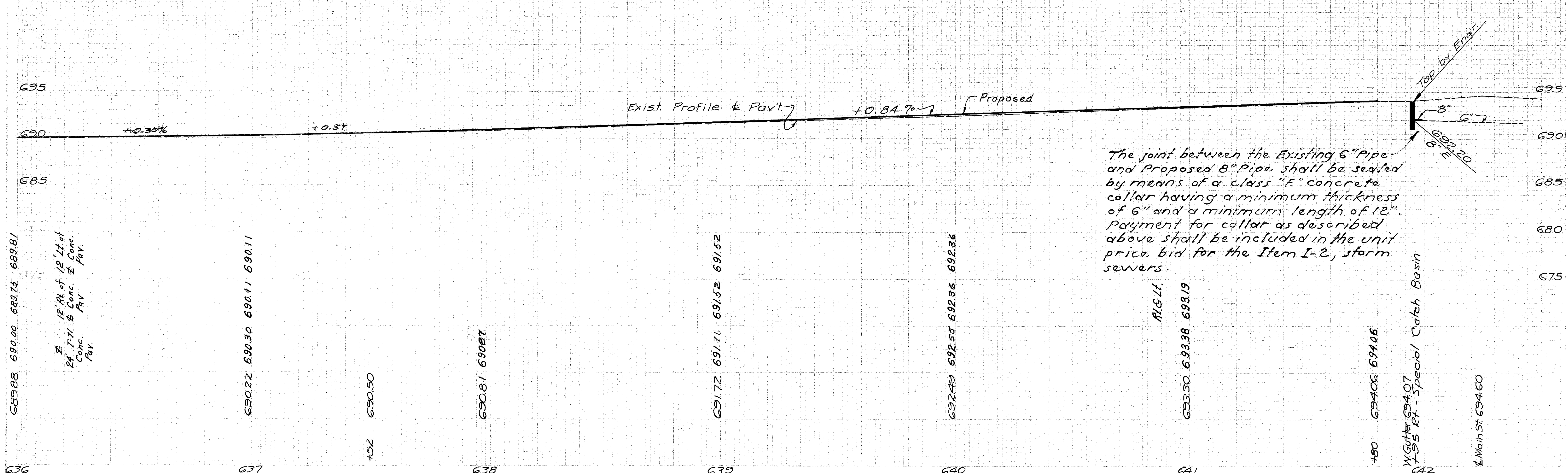
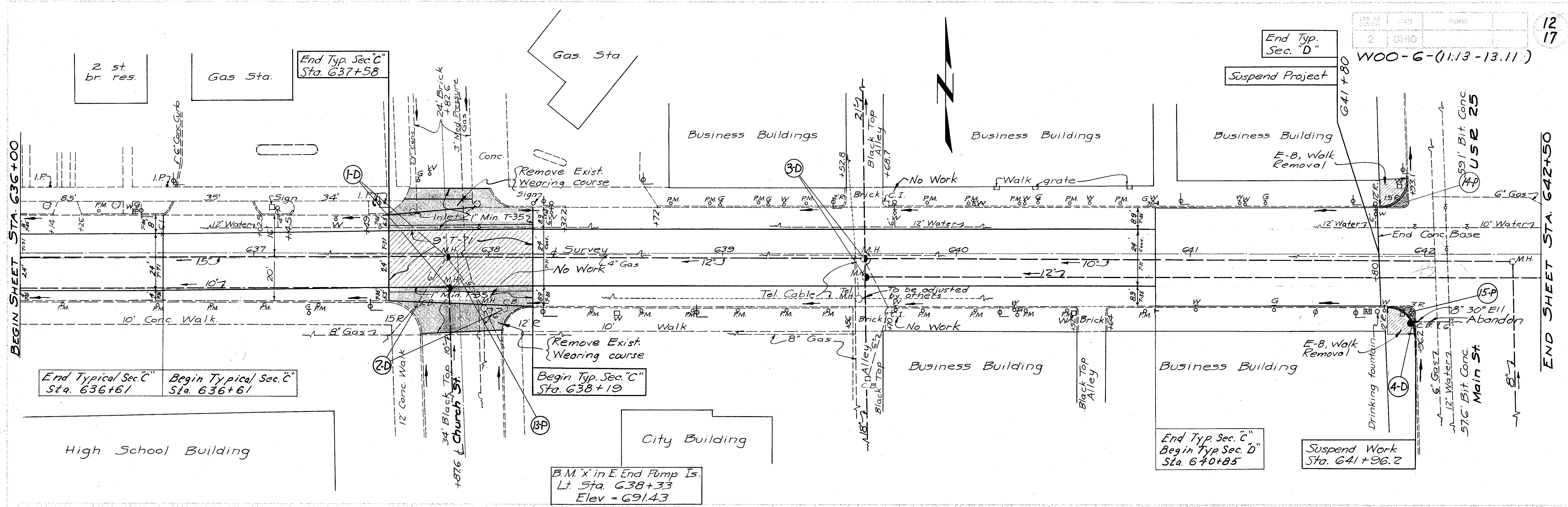

Sta. 636+00 to Sta. 642+50

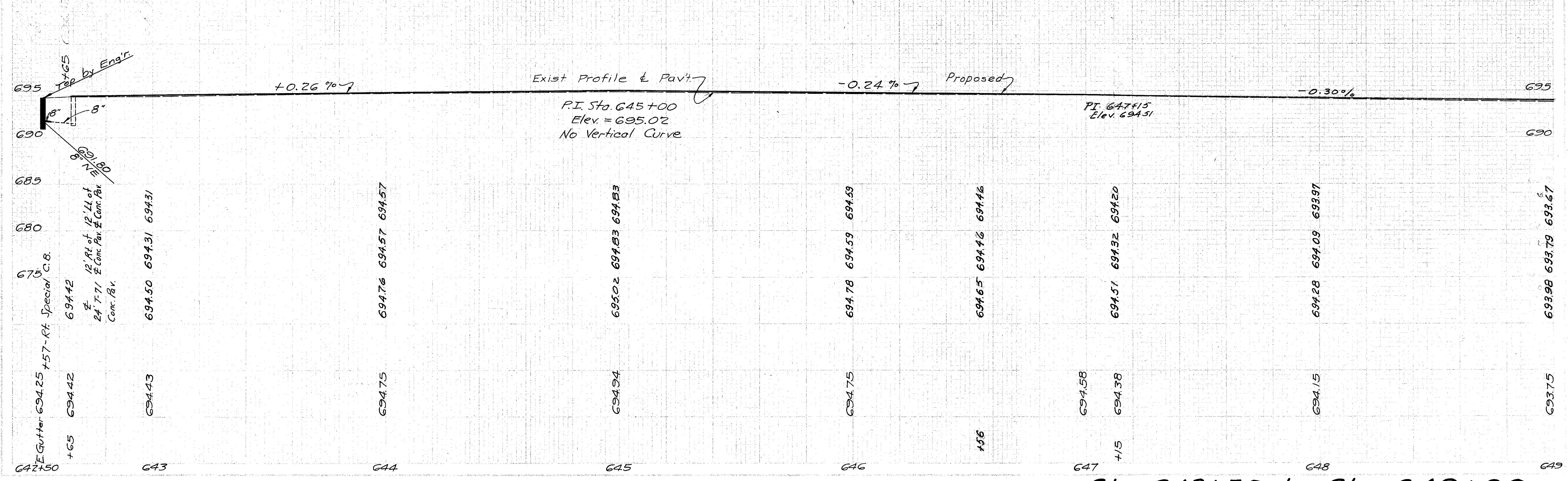
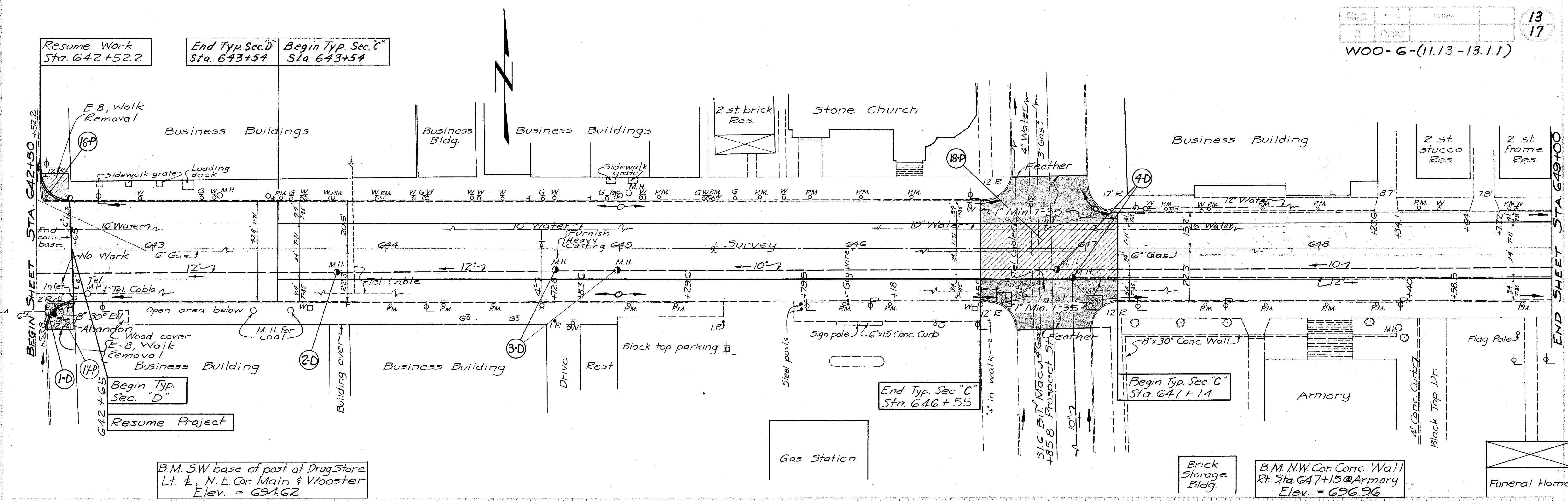

Sta. 642+50 to Sta. 649+00

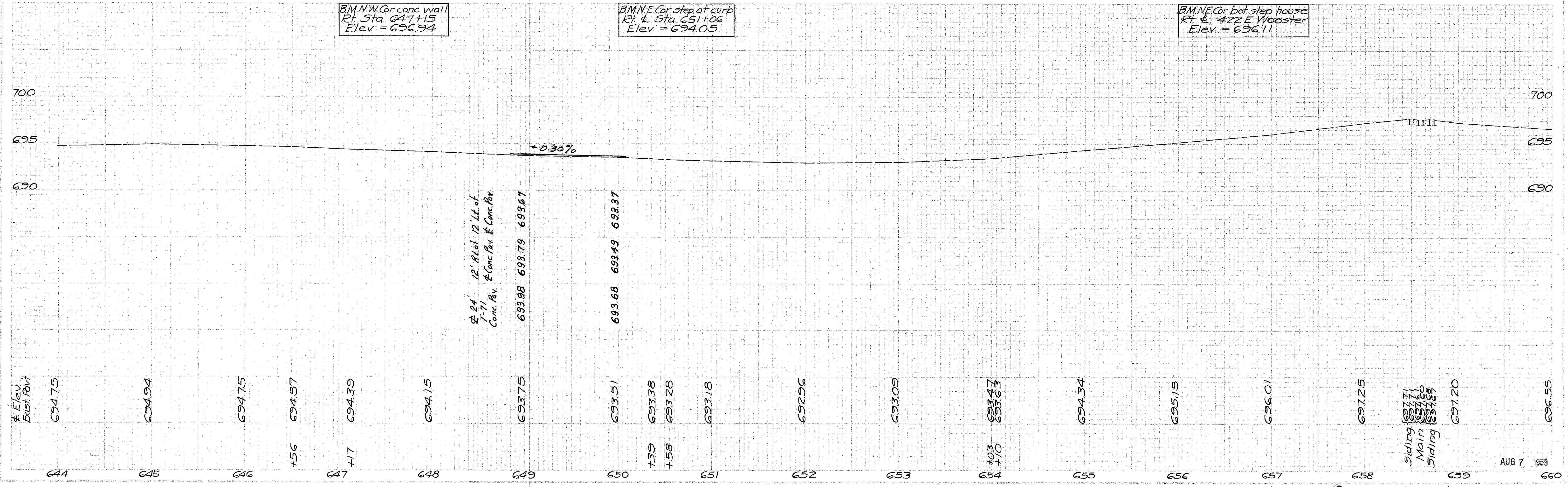
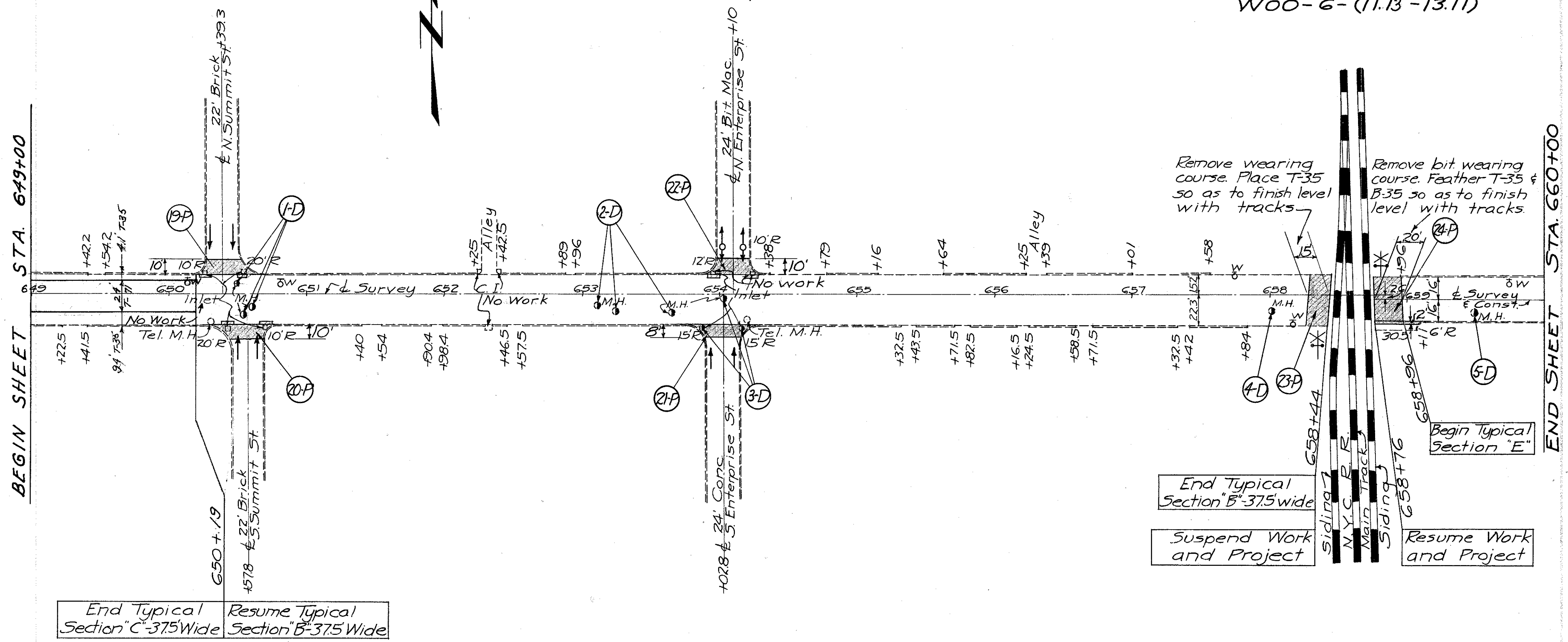

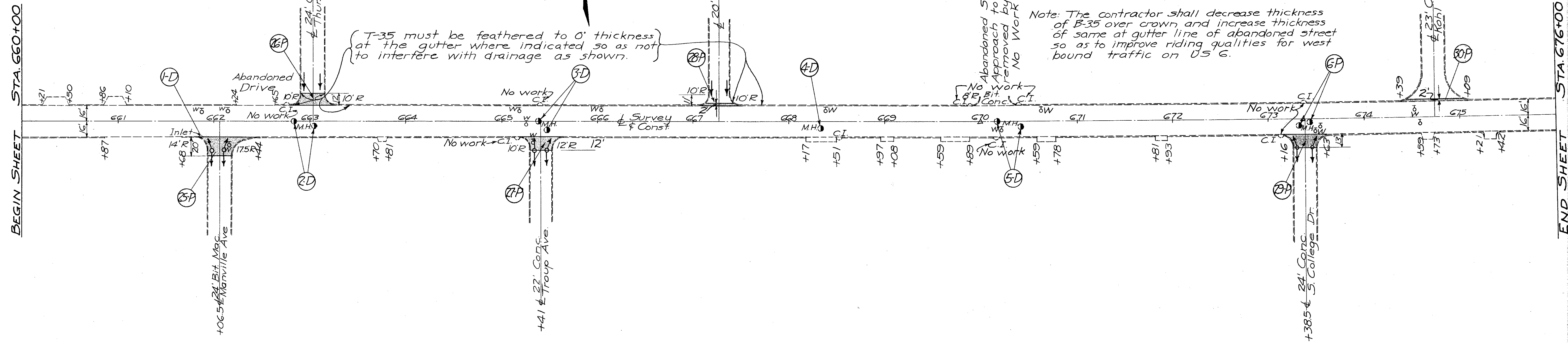

B.M. N.E. Cor. conc base
Hamblin Cleaners sign Rt. &
Elev. = 698.10

B.M. S.E. Cor. 1st step Dormitory
Lt. & Sta. 665+59
Elev. = 695.56

B.M. Top N. bolt flange hydrant
Rt. & Sta. 670+78
Elev. = 694.92

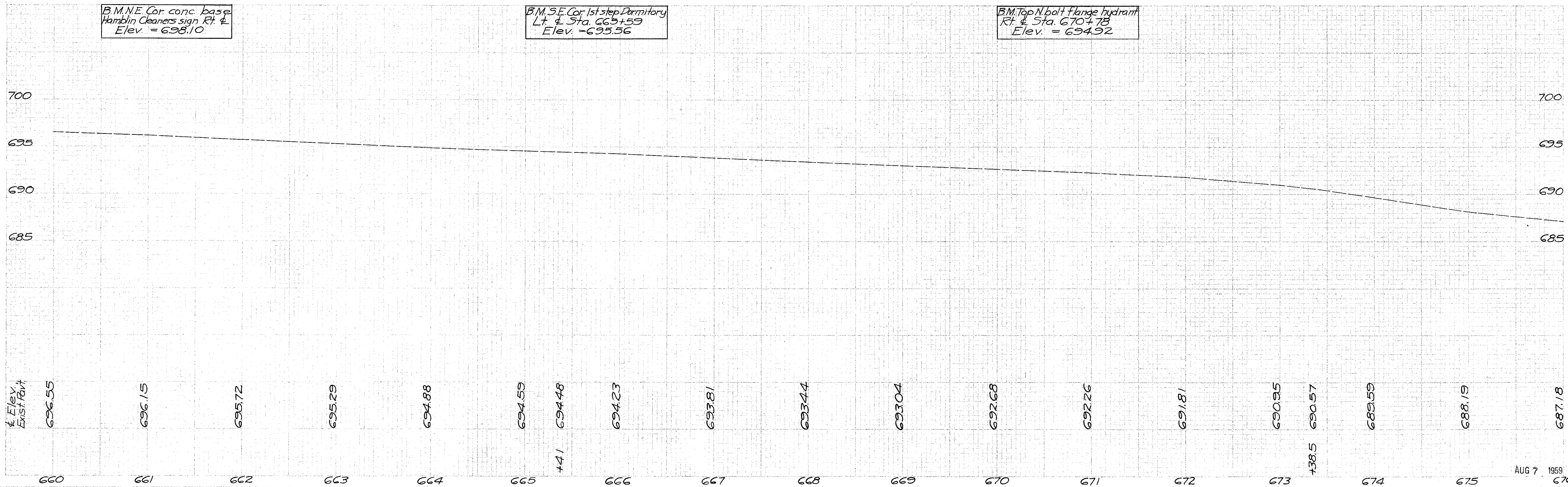

Sta. 660+00 to Sta. 676+00

FOR ANY QUESTIONS PLEASE CONTACT ODOT DISTRICT 2 REAL ESTATE AT 419-353-8131

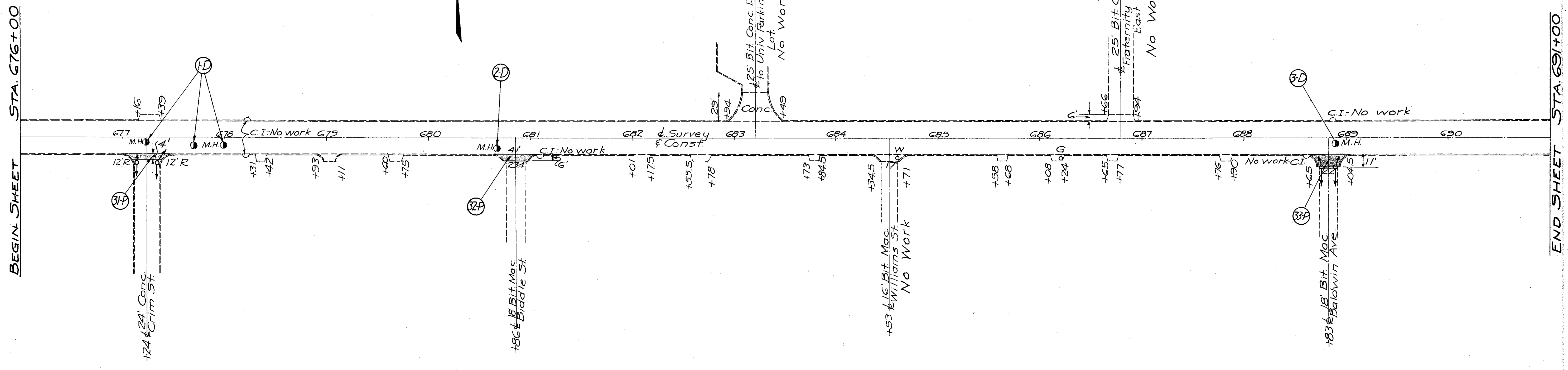

BM NE Cor 1st step walk
Rt. Sta. 676+02
Elev. = 688.09

BM Nail Power Pole
Rt. Sta. 680+65
Elev. = 686.37

BM N bolt flange hydrant
Rt. Sta. 684+29
Elev. = 687.63

BM NW Cor 1st step house
Rt. Sta. 1240 E Wooster
Elev. = 684.54

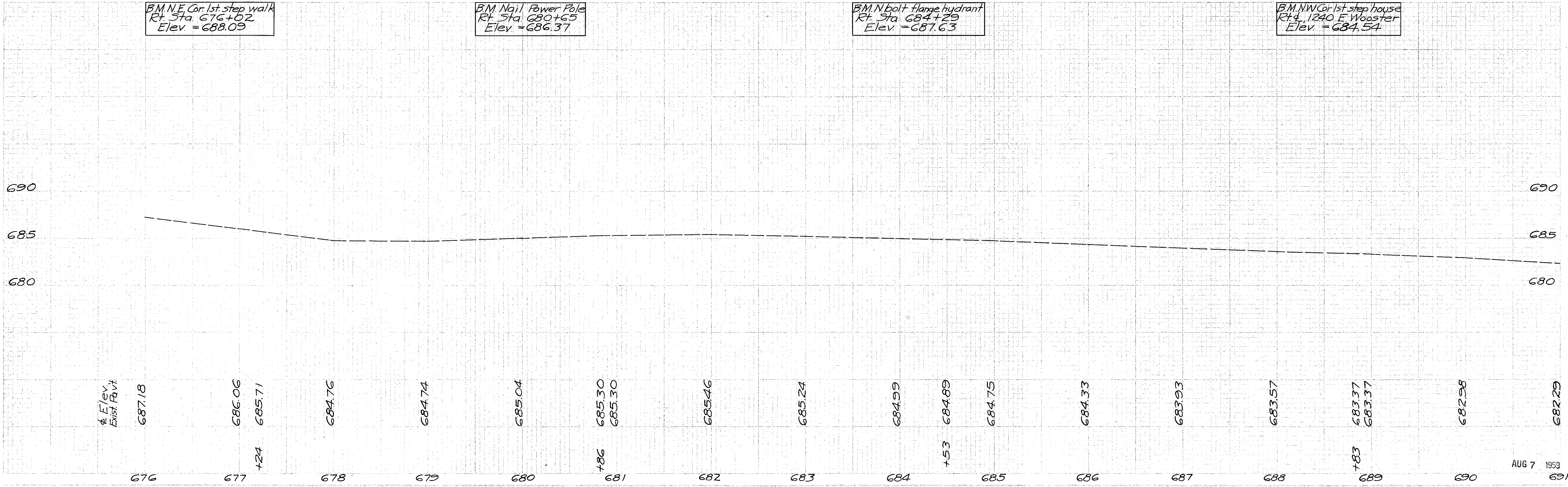

Sta. 676+00 to Sta. 691+00

P.I. Sta. 691+85.8
Δ = 0°33' Lt.

BEGIN SHEET STA. 691+00

Note: Resurfacing of 2 1/4" min. west or back to 1 1/4" min. east or ahead shall be adjusted in 15' so as to give a smooth transition from one to the other

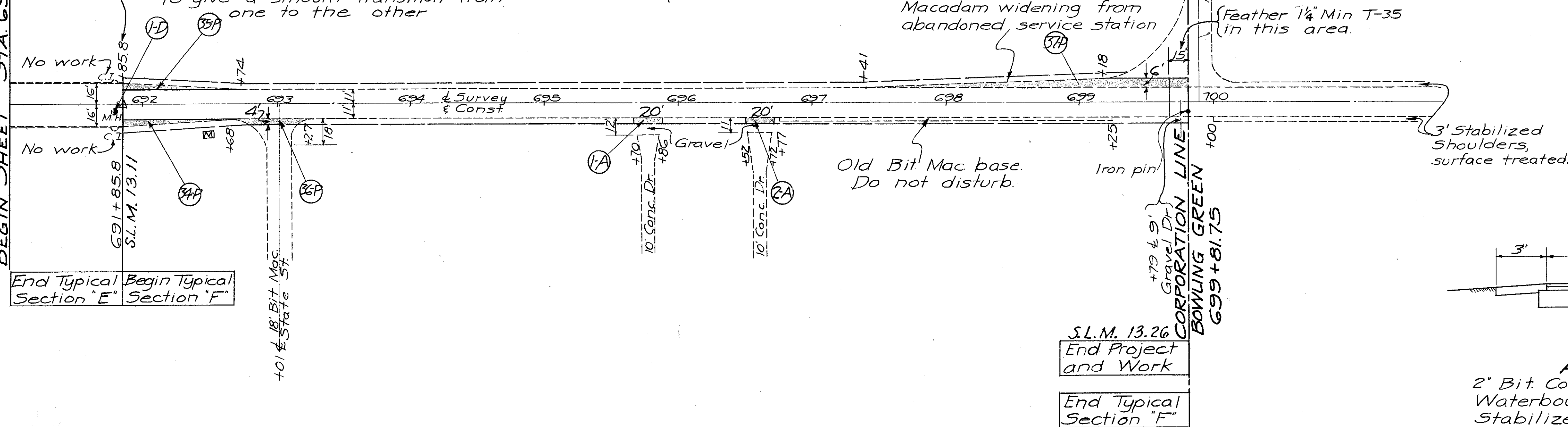

End Typical Section "E" / Begin Typical Section "F"

S.L.M. 13.26
End Project and Work
End Typical Section "F"

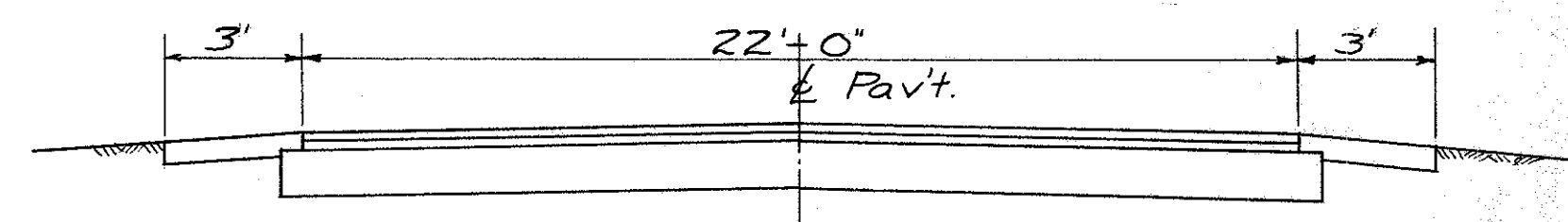

TYPICAL SECTION ADJOINING PAVEMENT
2" Bit Conc on 2" Surface Treatment on 10"± Waterbound Macadam, 22' wide with 3' wide Stabilized Shoulders, Surface Treated, on each side.

B.M. Bolt flange hydrant
Rt. Sta. 693+64
Elev. = 682.53

B.M. Spk Power Pole
Rt. Sta. 699+64
Elev. = 678.68

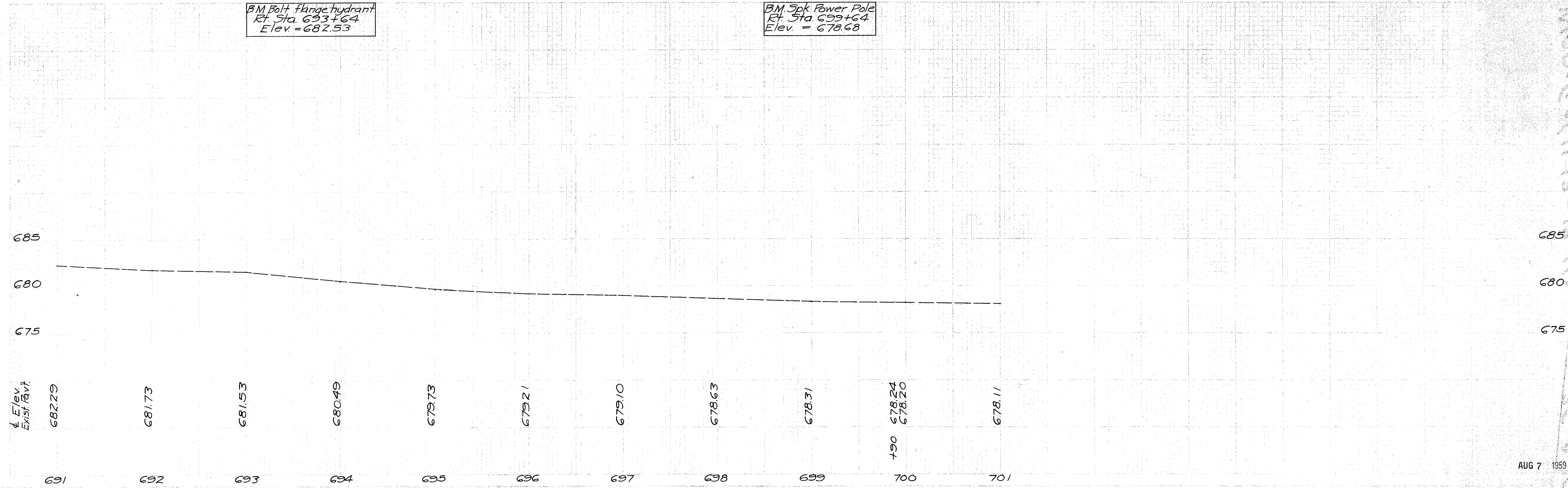

Sta. 691+00 to Sta. 699+81.75