

MONUMENT TABLE

| MON. NO. | STATION/OFFSET | NORTHING/WESTING | DESCRIPTION | ALIGNMENT |
|----------|----------------------------|-------------------------------|--------------------------------------|-----------|
| R104 | STA. 810+44.82, 34.03' RT. | N 524905.863 / W 2479907.462 | 1" PIN IN MON. BOX FD. | S.R. 62 |
| R105 | STA. 811+99.27, 34.00' RT. | N 524918.342 / W 2480061.409 | 1" PIN IN MON. BOX FD. & USED | S.R. 62 |
| R106 | STA. 4+89.57, 2.00' RT. | N 524897.502 / W 2480113.310 | 1" PIN IN MON. BOX FD. & USED | RAMP BZ |
| R107 | STA. 2+10.88, 2.00' RT. | N 524841.533 / W 2479841.135 | 1" PIN IN MON. BOX FD. & USED | RAMP BZ |
| R108 | STA. 840+56.02, 4.75' LT | N 526179.110 / W 2482547.863 | 1" PIN IN MON. BOX FD. | S.R. 62 |
| R1005 | STA. 836+56.79, 5.00' LT | N 525907.558 / W 2482257.353 | 3/4" REBAR SET INSIDE ROUND MON. BOX | S.R. 62 |
| R1006 | STA. 810+44.82, 5.00' LT. | N 524944.763 / W 2479904.3167 | 1" PIN IN MON. BOX FD. & USED | S.R. 62 |

- ① CURVE USR 62-1
P.I. Sta. 823+62.86
Δ = 34° 50' 02" (LT)
Dc = 2° 00' 00"
R = 2,864.79'
T = 898.70'
L = 1,741.69'
E = 137.66'
C = 1,714.99'
C.B. = N 67° 57' 37" E
- ② CURVE USR 62-2
P.I. Sta. 846+69.93
Δ = 76° 04' 23" (LT)
Dc = 5° 30' 00"
R = 1,041.74'
θ
Δc = 65° 04' 23" (LT)
Lc = 1,183.15'
Es = 284.97'
C = 1,120.57'
C.B.1 = N 46° 52' 40" E
C.B. = N 7° 00' 24" E
- ③ CURVE RAMP A-1
P.I. Sta. 2+05.00
Δ = 12° 15' 11" (RT)
Dc = 3° 00' 00"
R = 1,909.86'
T = 205.00'
L = 408.44'
E = 10.97'
C = 407.66'
C.B. = N 56° 40' 12" E
- ④ SPIRAL RAMP A-1
P.I. STA. 11+38.79
Ls = 150.00'
θs = 24° 33' 20"
LT = 100.98'
ST = 50.89'
x = 147.27'
y = 21.15'
k = 74.54'
p = 5.32'
- ⑤ CURVE RAMP A-2
P.I. Sta. 12+20.51
Δ = 64° 37' 40" (LT)
Dc = 32° 44' 26"
R = 175.00'
θ
Δc = 40° 04' 21" (LT)
Lc = 122.39'
Es = 35.28'
C = 119.92'
C.B.1 = N 54° 37' 28" E
C.B. = N 18° 12' 20" E

- ⑥ CURVE RAMP B-1
P.I. Sta. 2+13.66
Δ = 30° 47' 53" (RT)
Dc = 12° 00' 00"
R = 477.46'
T = 131.51'
L = 256.65'
E = 17.78'
C = 253.57'
C.B. = S 13° 42' 46" W
- ⑦ CURVE RAMP B-2
P.I. Sta. 4+14.08
Δ = 12° 00' 00" (RT)
Dc = 8° 00' 00"
R = 716.20'
T = 75.28'
L = 150.00'
E = 3.95'
C = 149.73'
C.B. = S 35° 06' 42" W
- ⑧ CURVE RAMP B-3
P.I. Sta. 5+88.96
Δ = 8° 00' 00" (RT)
Dc = 4° 00' 00"
R = 1,432.39'
T = 100.16'
L = 200.00'
E = 3.50'
C = 199.84'
C.B. = S 45° 06' 42" W

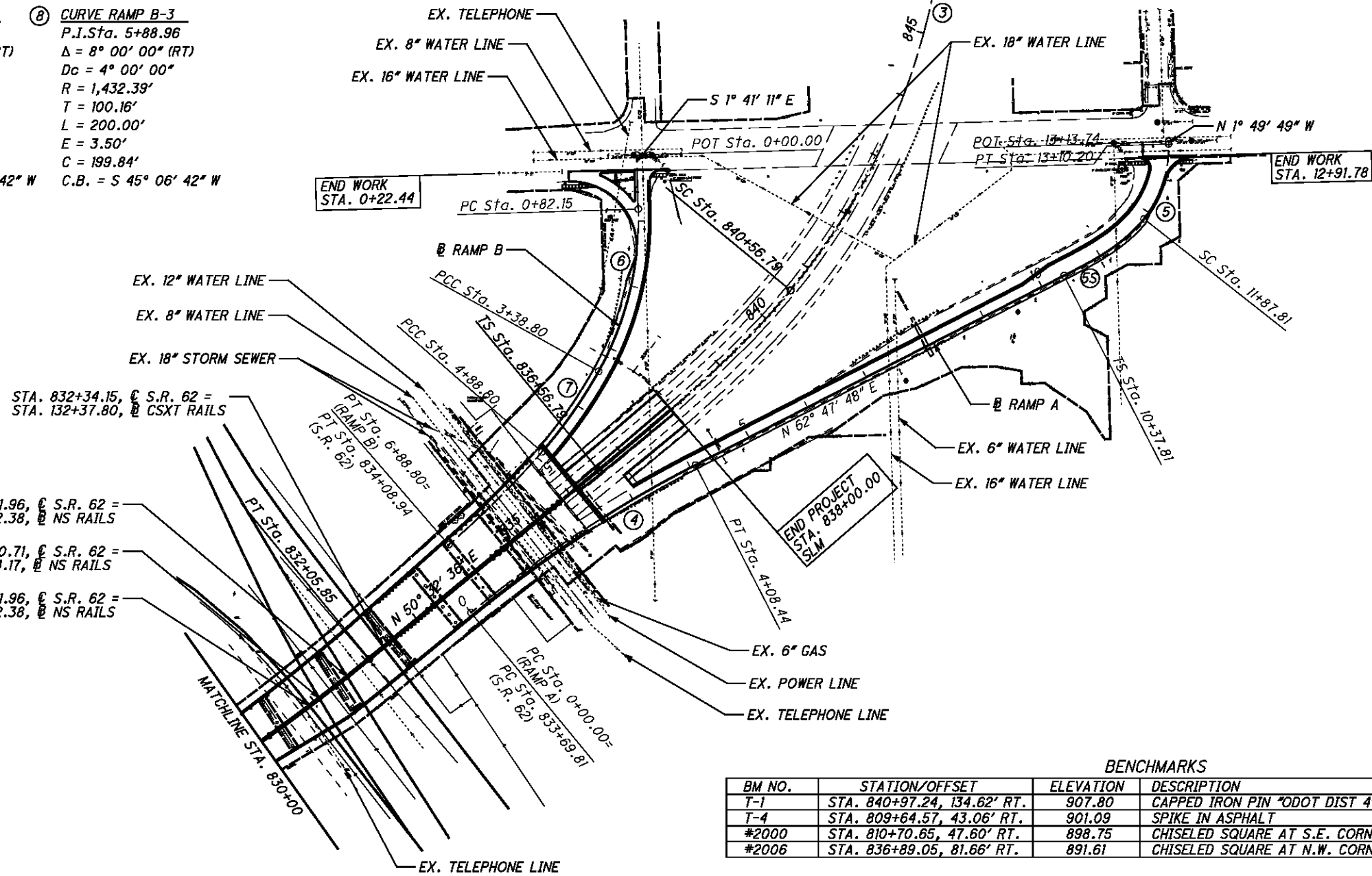

BENCHMARKS

| BM NO. | STATION/OFFSET | ELEVATION | DESCRIPTION |
|--------|-----------------------------|-----------|---|
| T-1 | STA. 840+97.24, 134.62' RT. | 907.80 | CAPPED IRON PIN "ODOT DIST 4" |
| T-4 | STA. 809+64.57, 43.06' RT. | 901.09 | SPIKE IN ASPHALT |
| *2000 | STA. 810+70.65, 47.60' RT. | 898.75 | CHISELED SQUARE AT S.E. CORNER OF CONCRETE LIGHT BASE |
| *2006 | STA. 836+89.05, 81.66' RT. | 891.61 | CHISELED SQUARE AT N.W. CORNER OF CONCRETE LIGHT BASE |

P:\PR51084\mah\24073\roadway\sheets\240730B002.dgn 4/27/2012 8:46:20 AM pennoc