

SEE ODOT SCD MT-101.60 FOR ADDITIONAL ROAD CLOSURE REQUIREMENTS

- | | | | | |
|----------------------------|---------------------------|----------------------------|-----------------------------|-----------------------------|
| ⑪ | ⑫ | ⑬ | ⑭ | ⑮ |
| EAST
62
DETOUR
→ | EAST
62
DETOUR
↑ | EAST
62
DETOUR
← | EAST
62
DETOUR
↗ | EAST
62
END
DETOUR |
| M3-2-24
M1-4-2
M4-9R | M3-2-24
M1-4-2
M4-9 | M3-2-24
M1-4-2
M4-9L | M3-2-24
M1-4-2
M4-9RA | M3-2-24
M1-4-2
M4-8a |

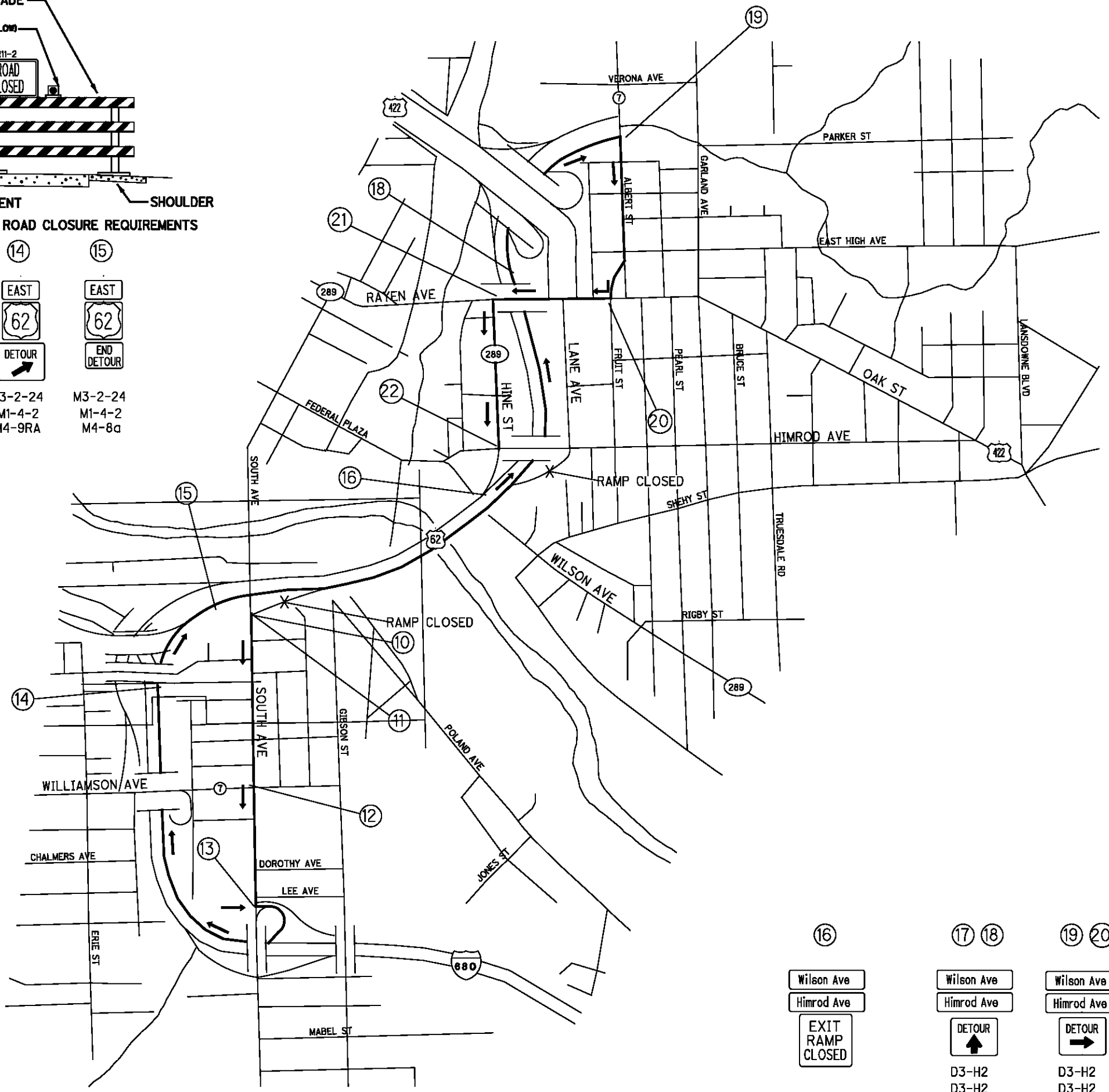

- | | | | | |
|--|---|--|---|--|
| ⑯ | ⑰ ⑱ | ⑲ ⑳ | ㉑ | ㉒ |
| Wilson Ave
Himrod Ave
EXIT
RAMP
CLOSED | Wilson Ave
Himrod Ave
DETOUR
↑
D3-H2
D3-H2
M4-9 | Wilson Ave
Himrod Ave
DETOUR
→
D3-H2
D3-H2
M4-9R | Wilson Ave
Himrod Ave
DETOUR
←
D3-H2
D3-H2
M4-9 | Wilson Ave
Himrod Ave
END
DETOUR
D3-H2
D3-H2
M4-8a |

P:\PR51084\mah\24073\mot\sheet\24073MD002.dgn 4/27/2012 9:45:33 AM pennoc