

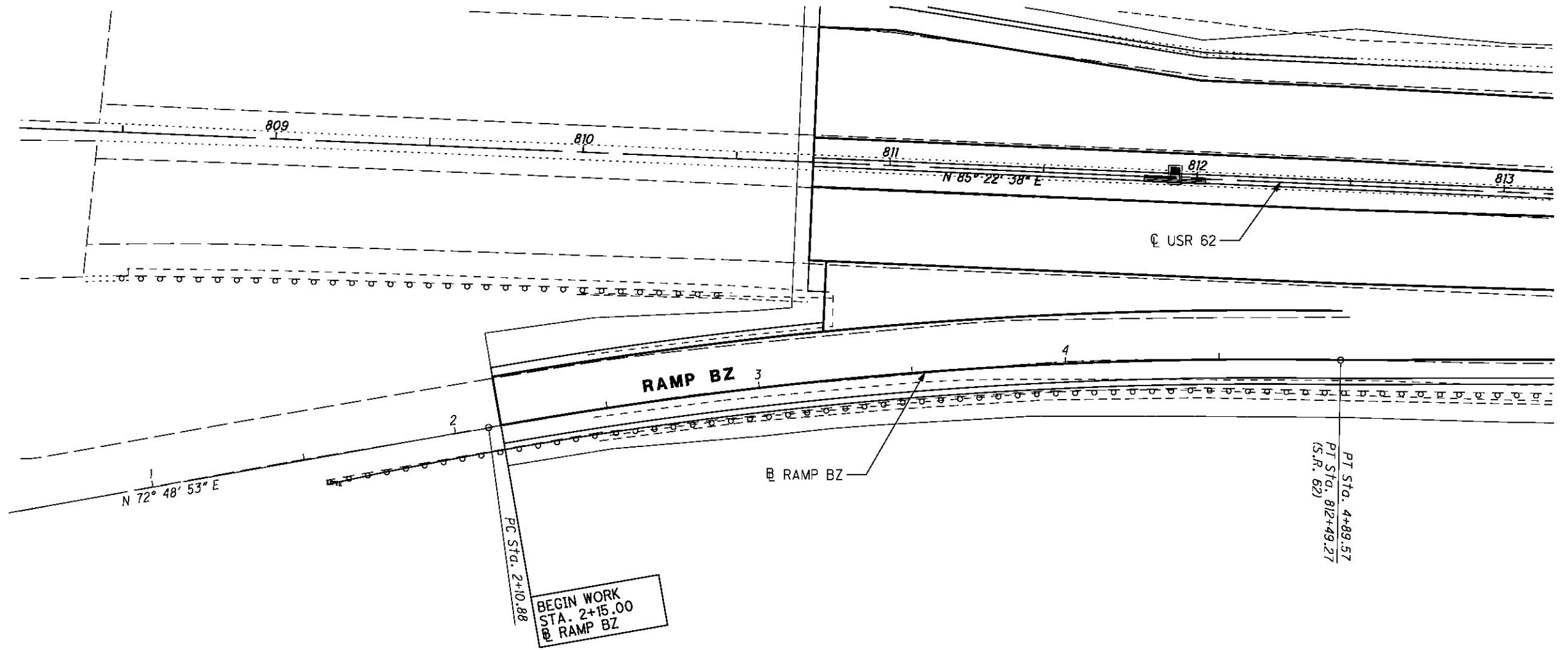

CALCULATED
JTP
CHECKED
NJG

PLAN AND PROFILE
RAMP BZ

MAH-62-18.23



P.I. Sta. 3+50.67
 $\Delta = 11^\circ 07' 50''$ (RT)
 $Dc = 3^\circ 59' 38''$
 $R = 1,434.61'$
 $T = 139.79'$
 $L = 278.69'$
 $E = 6.79'$
 $C = 278.26'$
 $C.B. = N 78^\circ 22' 48'' E$

