

P:\PR51084\msh\24073\roadway\sheets\24073GPO30.dgn 4/27/2012 9:12:34 AM pennoc

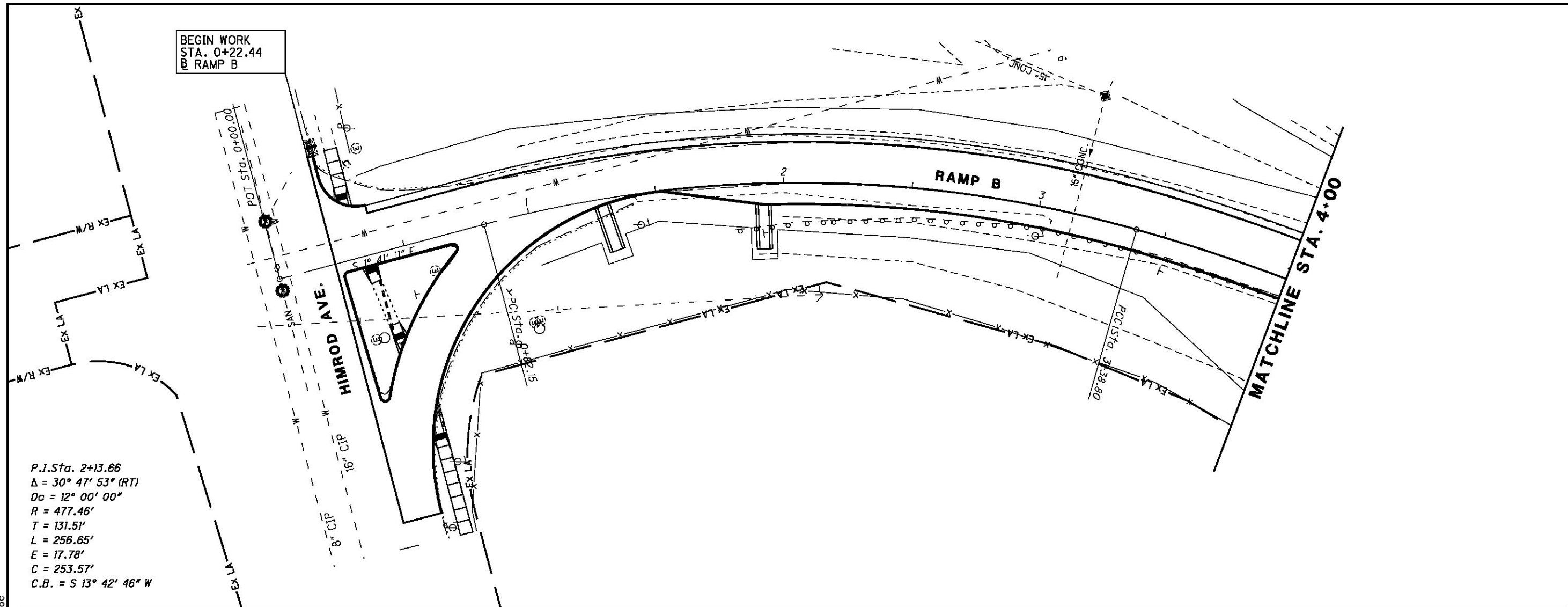

P.I. Sta. 2+13.66
 $\Delta = 30^\circ 47' 53''$ (RT)
 $Dc = 12^\circ 00' 00''$
 $R = 477.46'$
 $T = 131.51'$
 $L = 256.65'$
 $E = 17.78'$
 $C = 253.57'$
 $C.B. = S 13^\circ 42' 46'' W$

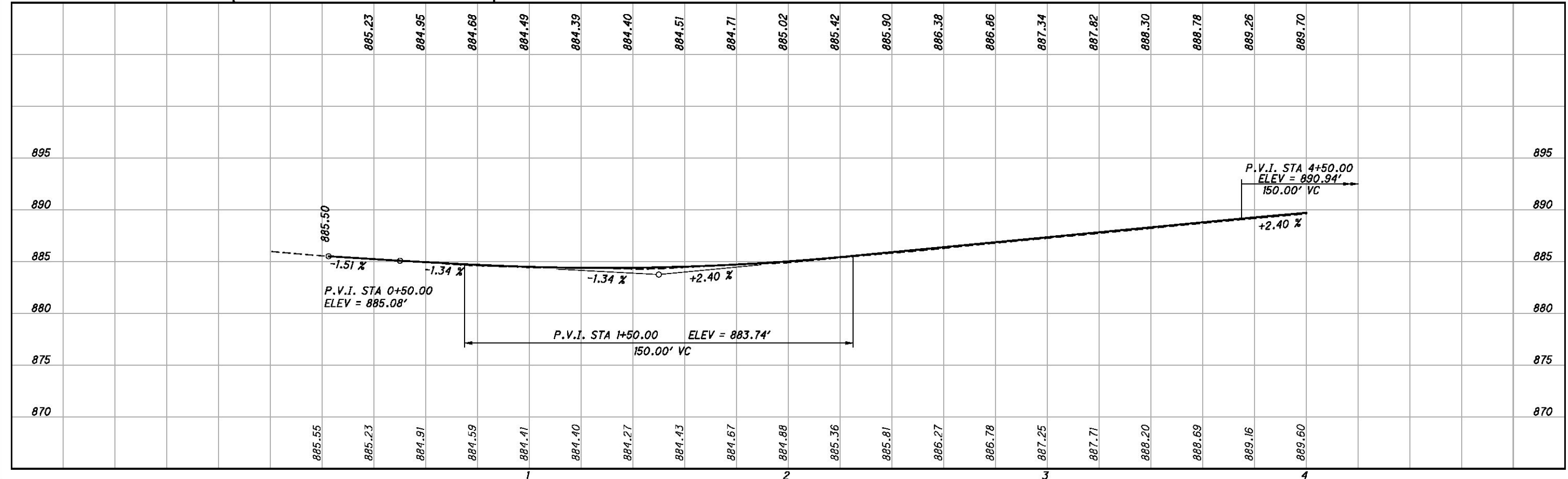

PLAN AND PROFILE
 RAMP B, STA. 0+00 TO STA. 4+00

MAH-62-18.23

