

P:\PR51084\msh\24073\structures\MAH-62-1825C\sheet\062\_1825CSP001.dgn 4/26/2012 5:08:02 PM speck

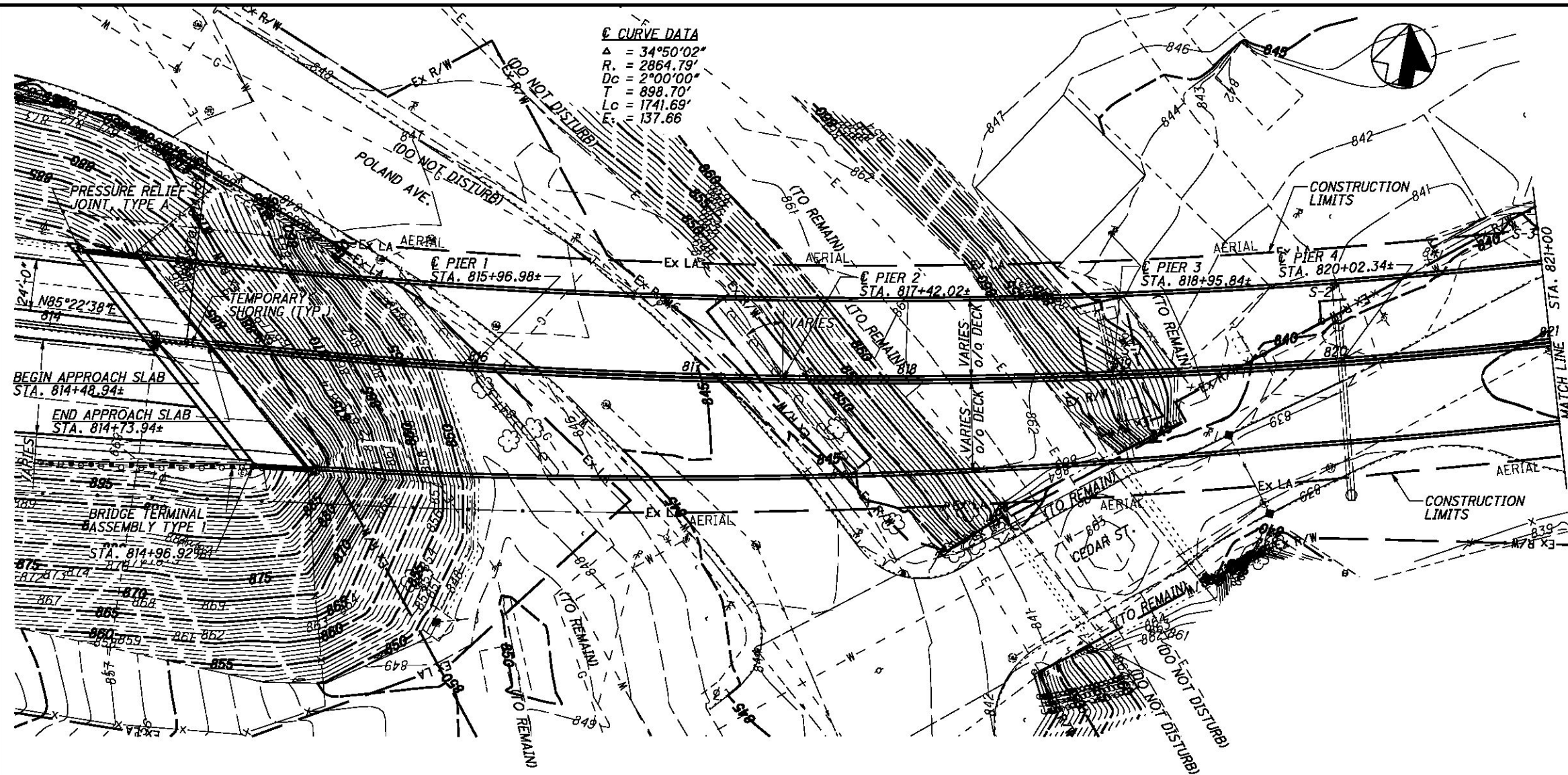

**PLAN**

**NOTES:**  
 EARTHWORK LIMITS SHOWN ARE APPROXIMATE. ACTUAL SLOPES SHALL CONFORM TO PLAN CROSS-SECTIONS.

**LEGEND:**  
 EXP. = EXPANSION  
 FIX. = FIXED

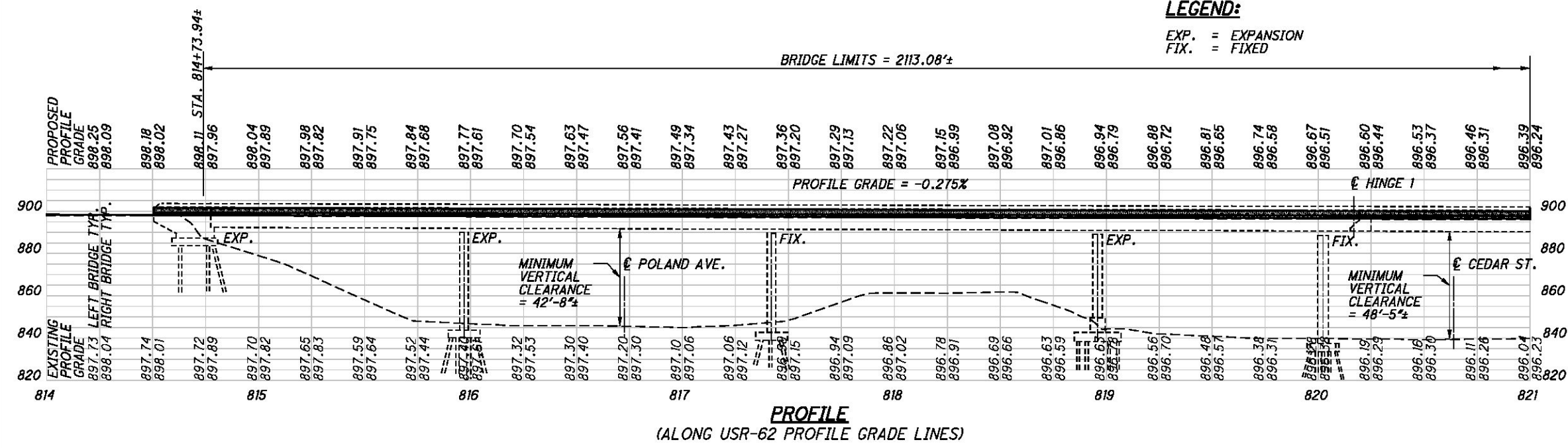

**SOIL BORING INFORMATION**

BORING NO.	STATION	OFFSET	TOP OF ROCK ELEVATION
S-1	819+01.10	15.47' LT.	768.9
S-2	820+01.86	35.44' LT.	763.4
S-3	820+88.88	55.56' LT.	770.3
S-4	825+92.71	4.44' LT.	797.8
S-5	828+11.82	9.39' LT.	800.1

**BENCHMARK INFORMATION**

TO BE PROVIDED IN STAGE 2

**EXISTING STRUCTURE**

TYPE: CONTINUOUS STEEL GIRDERS AND STEEL BEAMS WITH REINFORCED CONCRETE DECK AND SUBSTRUCTURE

SKEW: VARIES SEE PLANS

SPANS: c/c BEARINGS  
 UNIT 1 - 120.0'±, 145.0'±, 153.56'±, 106.44'±, 15.0'±  
 UNIT 2 - 95.0'±, 120.0'±, 105.0'±, 75.0'±, 15.0'±  
 UNIT 3 - 15.0'±, 191.0'±, 254.0'±, 165.0'±, 15.0'±  
 UNIT 4 - 94.0'±, 104.0'±, 94.0'±, 10.0'±, 15.0'±  
 UNIT 5 - 56.0'±, 70.0'±, 64.5'±, 42.0'±

ROADWAY: VARIABLE, 73'-0" MIN. ±/± BARRIERS  
 LOADING: CF-2000 & ALT. MILITARY  
 WEARING SURFACE: 3/4" MICRO-SILICA MODIFIED CONCRETE OVERLAY  
 APPROACH SLABS: 25' LONG (AS-1-67)  
 ALIGNMENT: 2° 0'0" CURVE LEFT  
 SUPERELEVATION: 0.033 FT/FT MAX.  
 DATE BUILT: 1973

**PROPOSED STRUCTURE**

PROPOSED WORK: REPLACE REINFORCED CONCRETE DECK, PROVIDE SEALED EXPANSION JOINTS, ADD BEARINGS, RETROFIT FATIGUE-PRONE STEEL DETAILS BELOW HANGERS, RETROFIT STEEL PIER CAPS, ADD PIER COLUMNS AND STRENGTHEN PIER CAPS, REPLACE PINS AND HANGERS, REPLACE DRAINAGE, BACKWALLS, APPROACH SLABS, AND LIGHTING, AND PATCH AND SEAL CONCRETE BRIDGE ELEMENTS

TYPE: CONTINUOUS STEEL GIRDERS AND STEEL BEAMS WITH COMPOSITE REINFORCED CONCRETE DECK AND SUBSTRUCTURE

SKEW: VARIES SEE PLANS

SPANS: c/c BEARINGS  
 UNIT 1 - 120.0'±, 145.0'±, 153.56'±, 106.44'±, 15.0'±  
 UNIT 2 - 95.0'±, 120.0'±, 105.0'±, 75.0'±, 15.0'±  
 UNIT 3 - 15.0'±, 191.0'±, 254.0'±, 165.0'±, 15.0'±  
 UNIT 4 - 94.0'±, 104.0'±, 94.0'±, 10.0'±, 15.0'±  
 UNIT 5 - 56.0'±, 70.0'±, 64.5'±, 42.0'±

ROADWAY: VARIABLE, 73'-0" MIN. ±/± BARRIERS  
 LOADING: HS-20 & ALT. MILITARY  
 30 PSF FUTURE WEARING SURFACE  
 WEARING SURFACE: 1" MONOLITHIC CONCRETE  
 APPROACH SLABS: 25' LONG (AS-1-81)  
 ALIGNMENT: 2° 0'0" CURVE LEFT  
 SUPERELEVATION: 0.04 FT/FT MAX.  
 ADT: (2005) 28,280  
 ADT: (2026) 36,700  
 ADTT: (2005) 1,940  
 LATITUDE: 41°5'34"N, LONGITUDE: 80°38'36"W

DESIGN AGENCY: BURGESS & NIPLE  
 80 WEST ERIE STREET PAINESVILLE, OHIO 44017

DATE: 4-12  
 REVISIONS: DWL  
 DRAWN: DCF  
 CHECKED: AKS  
 MAHONING COUNTY: STA. 814+73.94±  
 MAHONING COUNTY: STA. 835+81.02±

SITE PLAN 1 OF 3  
 BRIDGE NO. MAH-62-1825  
 USR-62 OVER THE MAHONING RIVER AND RAILROADS

MAH-62-18-23  
 PID No. 24073

B1