

P:\PR51084\moh\24073\structures\MAH-62_sheets\062_1825CSP004.dgn 4/26/2012 10:14:22 AM speck

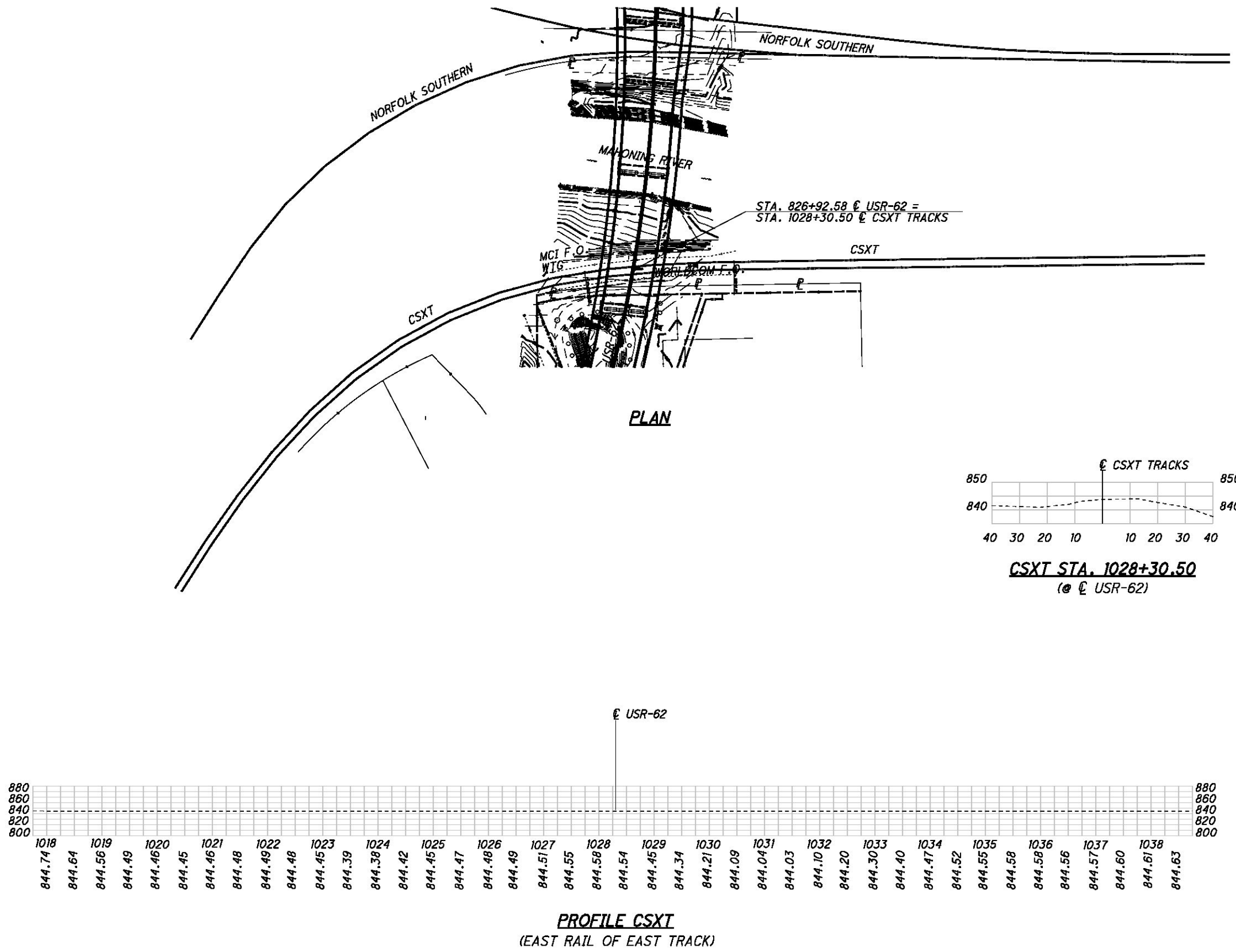

DESIGN AGENCY
BURGESS & NIPLÉ
80 WEST ERIE STREET PAINESVILLE, OHIO 44071

DESIGNED	DCP	CHECKED	JAA
DRAWN	DCF	REVIEWED	
REVIEWED	DWL	DATE	4-12
STRUCTURE FILE NUMBER	5008662		

SUPPLEMENTAL SITE PLAN - CSXT RAILROAD
BRIDGE NO. MAH-62-1825
USR-62 OVER THE MAHONING RIVER AND RAILROADS

MAH-62-18.23
PID No. 24073

