

BASIS FOR BEARINGS:

THE BASIS OF BEARING IS BASED UPON THE OHIO NORTH ZONE STATE PLANE COORDINATES NAD83(95) DATUM. THE BEARINGS SHOWN ARE FOR PROJECT USE ONLY.

⊙ CURVE DATA S.R. 62
 P.I. Sta. 823+62.86
 $\Delta = 34^\circ 50' 02''$ (LT)
 $Dc = 2^\circ 00' 00''$
 $R = 2,864.79'$
 $T = 898.70'$
 $L = 1,741.69'$
 $E = 137.66'$
 $C = 1,714.99'$
 C.B. = N $67^\circ 57' 37''$ E

T-2-N, R-2-W
 CITY OF YOUNGSTOWN
 MAHONING COUNTY, OHIO

THE EXISTING R/W WIDTH AND LOCATION WERE DETERMINED USING:
 RECORD PLATS
 MAHONING COUNTY RECORD DEEDS
 MAHONING COUNTY TAX MAP:
 CITY OF YOUNGSTOWN - PLATE 24
 CITY OF YOUNGSTOWN - PLATE 31
 EXISTING PROPERTY PINS
 EXISTING RIGHT OF WAY PLANS:
 MAH-7-15.51



PID NO.
24073

R/W DESIGNER
 JPS
 R/W REVIEWER
 WJS

RIGHT OF WAY TOPO SHEET
 STA. 789+00.00 TO STA. 816+00.00

MAH-62-18.23

5 / 24

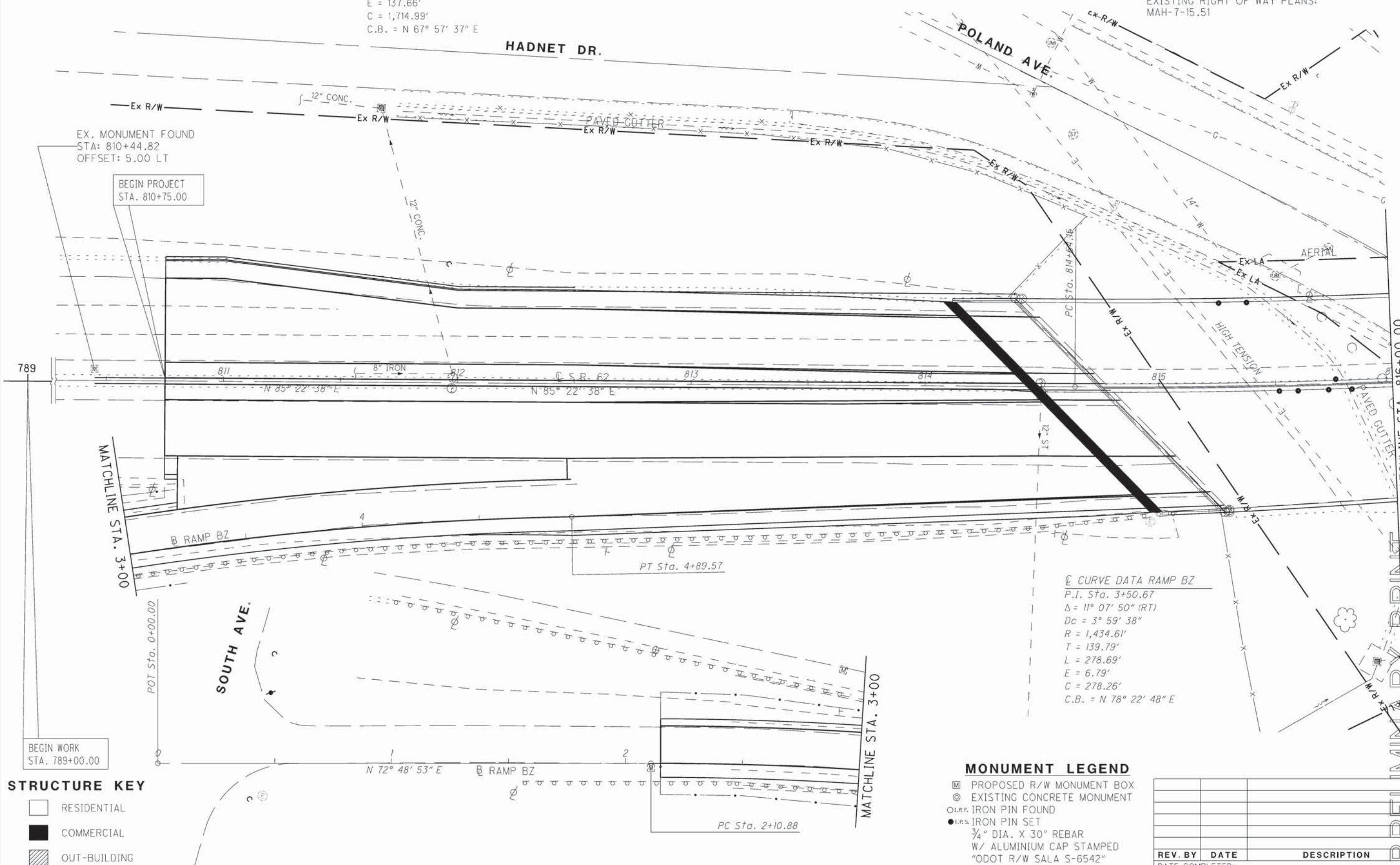

EX. MONUMENT FOUND
 STA: 810+44.82
 OFFSET: 5.00 LT

BEGIN PROJECT
 STA. 810+75.00

789

MATCHLINE STA. 3+00

POT Sta. 0+00.00

SOUTH AVE.

RAMP BZ

PT Sta. 4+89.57

MATCHLINE STA. 3+00

PC Sta. 2+10.88

⊙ CURVE DATA RAMP BZ
 P.I. Sta. 3+50.67
 $\Delta = 11^\circ 07' 50''$ (RT)
 $Dc = 3^\circ 59' 38''$
 $R = 1,434.61'$
 $T = 139.79'$
 $L = 278.69'$
 $E = 6.79'$
 $C = 278.26'$
 C.B. = N $78^\circ 22' 48''$ E

MONUMENT LEGEND

- ⊠ PROPOSED R/W MONUMENT BOX
- ⊙ EXISTING CONCRETE MONUMENT
- I.R.F. IRON PIN FOUND
- I.R.S. IRON PIN SET
- ▬ 3/4" DIA. X 30" REBAR
- ▬ W/ ALUMINIUM CAP STAMPED "ODOT R/W SALA S-6542"

STRUCTURE KEY

- RESIDENTIAL
- COMMERCIAL
- ▨ OUT-BUILDING

REV. BY	DATE	DESCRIPTION

DATE COMPLETED:

DATE: 27-APR-12 09:51
 FILE: J:\JOB\60466_MAH-62-18.23\PLAN_SHEETS\24_RIGHT_OF_WAY\05_PLAN_SHEETS\TOP\24073R1001.DGN
 SCALE: 1" = 100'

PRELIMINARY PRINT