

BASIS FOR BEARINGS:

THE BASIS OF BEARING IS BASED UPON THE OHIO NORTH ZONE STATE PLANE COORDINATES NAD83(95) DATUM. THE BEARINGS SHOWN ARE FOR PROJECT USE ONLY.

☺ CURVE DATA CSX

T-2-N, R-2-W
CITY OF YOUNGSTOWN
MAHONING COUNTY, OHIO

☺ CURVE DATA S.R. 62

P.I. Sta. 823+62.86
Δ = 34° 50' 02" (LT)
Dc = 2° 00' 00"
R = 2,864.79'
T = 898.70'
L = 1,741.69'
E = 137.66'
C = 1,714.99'
C.B. = N 67° 57' 37" E

THE EXISTING R/W WIDTH AND LOCATION WERE DETERMINED USING:
RECORD PLATS
MAHONING COUNTY RECORD DEEDS
MAHONING COUNTY TAX MAP:
CITY OF YOUNGSTOWN - PLATE 24
CITY OF YOUNGSTOWN - PLATE 31
EXISTING PROPERTY PINS
EXISTING RIGHT OF WAY PLANS:
MAH-7-15.51

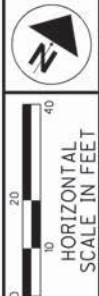

PID NO. **24073**
R/W DESIGNER: JPS
R/W REVIEWER: WJS

RIGHT OF WAY TOPO SHEET
STA. 826+00.00 TO STA. 831+00.00

MAH-62-18.23

11 / 24

PRELIMINARY PRINT

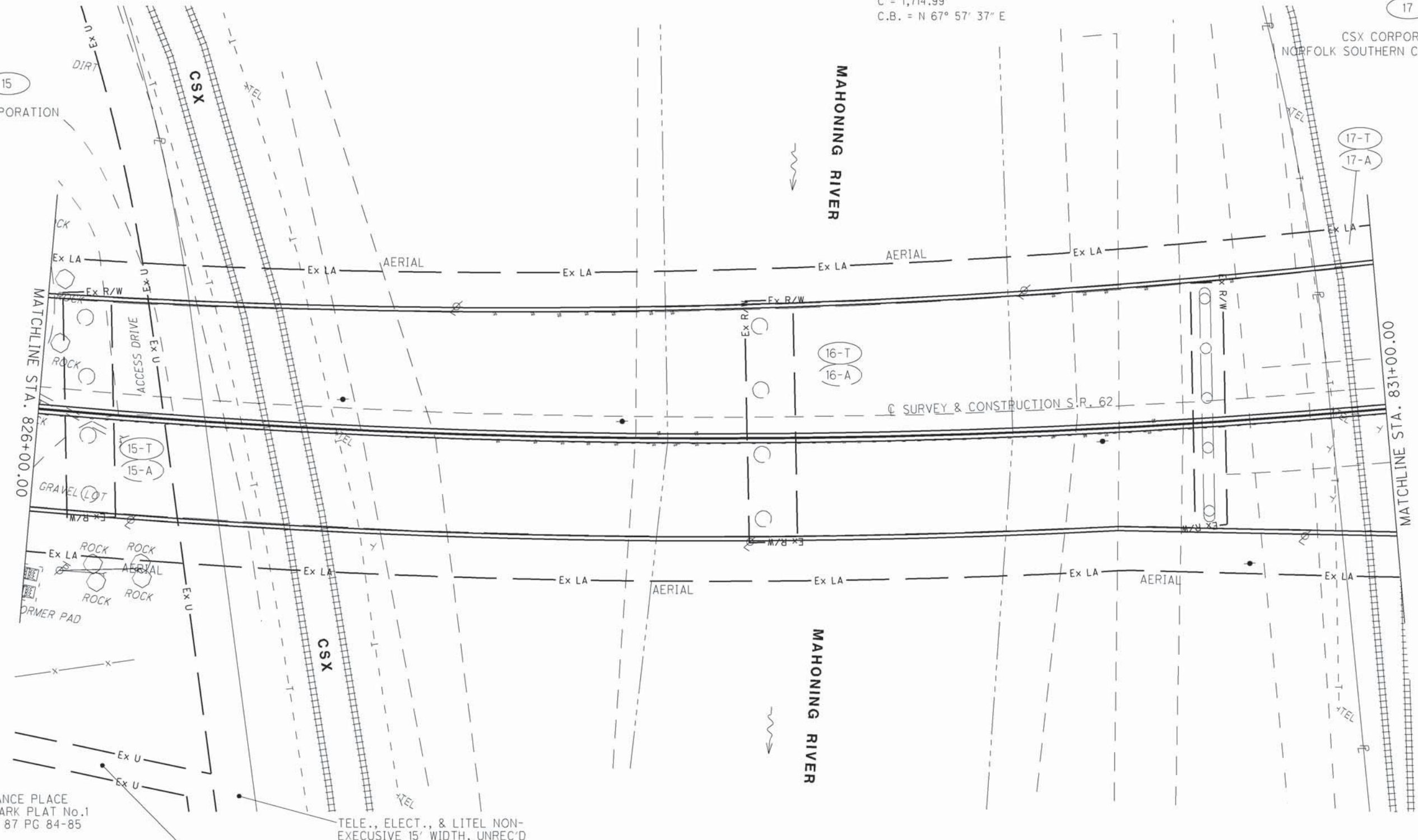

PERFORMANCE PLACE INDUSTRIAL PARK PLAT No.1
PLAT VOL. 87 PG 84-85

STRUCTURE KEY

- RESIDENTIAL
- COMMERCIAL
- OUT-BUILDING

10' WIDE TELEPHONE & ELECTRIC EASEMENT
O.R. VOL. 2081 PG. 144

CSX TRANSPORTATION, INC. A VIRGINIA CORPORATION, SUCCESSOR BY MERGER EFFECTIVE 9-2-87 TO THE CHESAPEAKE AND OHIO RAILWAY COMPANY, IN TURN SUCCESSOR BY MERGER EFFECTIVE 4-30-87, TO THE BALTIMORE AND OHIO RAILROAD COMPANY

MONUMENT LEGEND

- PROPOSED R/W MONUMENT BOX
- EXISTING CONCRETE MONUMENT
- O.I.P.F. IRON PIN FOUND
- I.P.S. IRON PIN SET
- 3/4" DIA. X 30" REBAR W/ ALUMINIUM CAP STAMPED "ODOT R/W SALA S-6542"

REV. BY	DATE	DESCRIPTION

DATE COMPLETED:

DATE: 27-APR-12 10:24
FILE: J:\JOB\6046B_MAH-62-18.23\PLAN_SHEETS\24_RIGHT_OF_WAY\05_PLAN_SHEETS\TOP\24073R1004.DGN
SCALE: 1" = 10'