

**Utility Note**  
**FRA-161-15.80 Noise Walls PID 117607**  
***Latest Update -May 21, 2024***

Text in *red italics* below indicates that coordination is ongoing with the utility companies and relocation information (if needed) will be added when confirmed.

**UTILITY COMPANIES KNOWN TO BE WITHIN THE PROJECT LIMITS**

**AMERICAN ELECTRIC POWER - DISTRIBUTION**

Contact: Paul Paxton  
777 Hopewell Drive  
Heath, Ohio 43056  
Office: (740) 348-5322  
AEP Solution Center: (800) 277-2177  
ptpaxton@aep.com

AEP Distribution has aerial distribution lines over the 81" barrier 3 at approximate station 3001+60. The clearance distances between 81" barrier 3 and the aerial distribution lines are as noted on the FRA-161-15.80 Plan. These aerial facilities are to remain during construction.

**AEP Distribution reported on 2-23-2024 that they are not seeing any issues with AEP Distribution.**

**On 5-21-2024, AEP reported they did not identify existing easements for the SR 161 crossings outlined in red on the attached plan sheets. The red outlined utilities are AEP lines that cross over SR 161 as identified in a 5-21-2024 email from AEP (Matt Wolfe) to Jeff Hackenbracht (Arcadis).**

**AMERICAN ELECTRIC POWER - TRANSMISSION**

Contact: Michael D. Carr / Coordinator  
8600 Smiths Mill  
Road  
New Albany, Ohio 43054  
Direct: (380) 205-5072  
TL\_PUBLICPROJECTS@AEP.COM

AEP Transmission has aerial transmission lines (Corridor - Morse 138kV line) located over noise wall 6 at approximate station 604+00. The clearance distances between noise wall 6 and the aerial transmission lines are as noted on the FRA-161-15.80 Plan. These aerial facilities are to remain during construction.

AEP Transmission has aerial transmission lines (Corridor - Morse 138kV line) located over 81" barrier 8 at approximate station 8005+00. The clearance distances between 81" barrier 8 and

the aerial transmission lines are as noted on the FRA-161-15.80 Plan. These aerial facilities are to remain during construction.

**AEP Transmission reported on 2-28-2024 that they are not seeing any concerns with the Stage 2 plans and the contact information on page 9 looks good.**

**AEP Transmission also urged to use EXTREME CAUTION when operating a crane, vehicle or mechanical equipment capable of having part of its structure elevated, near any equipment or energized lines. Please adhere to all OSHA standards when working near any energized line of this magnitude.**

**AEP Transmission has a private easement for the AEP Transmission lines that cross over noise wall 6 and 81" barrier 8.**

#### **AMERICAN ELECTRIC POWER - JOINT USE**

Contact: Paul Paxton  
777 Hopewell Drive  
Heath, Ohio 43056  
Office: (740) 348-5322  
AEP Solution Center: (800) 277-2177  
ptpaxton@aep.com

**AEP Distribution (Paul Paxton) reported on 2-23-2024 that they are not seeing any conflict issues. A follow up email was sent to AEP on 4-17-2024 to confirm AEP's Joint-Use Status and AEP's Paul Paxton reported that the onsite AEP pole lines have been identified and AEP believes they are good.**

**On 5-21-2024, AEP reported they did not identify existing easements for the SR 161 crossings outlined in red on the attached plan sheets. The red outlined utilities are AEP lines that cross over SR 161 as identified in a 5-21-2024 email from AEP (Matt Wolfe) to Jeff Hackenbracht (Arcadis).**

#### **COLUMBIA GAS OF OHIO TRANSMISSION AND TC-ENERGY**

Contact: Robert Reed  
Columbia Gas of Ohio Transmission  
1600 Eastgate Pkwy  
Gahanna, Ohio 43230  
740.279.0870  
robert1\_reed@tcenergy.com

Contact: Paul Jurovcik  
TC-Energy  
700 Louisiana Street, Suite 1300  
Houston, Texas 77002  
Paul Jurovcik <paul\_jurovcik@tcenergy.com>

TC-Energy/Columbia Gas Transmission 20-inch gas lines are located at the following

approximate locations (refer to plan sheets for exact locations):

- 81" Barrier 6 – Sta 6004+75
- 81" Barrier 8 – Sta 7999+95
- 81" Barrier 10 – Sta 1015+05 and Sta 1015+85
- Noise Wall 12 between drilled shaft 20 and 21
- Noise Wall 12 between drilled shaft 24 and 25

*The following Stage 3 comments were received on 5-2-2024 from Paul J (TC-Energy)*

*Jeff, on sheet P.57 can you please add a comment stating the supports for the sound wall must be 10' or greater from the outside edge of the pipelines? This language matches what we discussed during our meeting.*

*For the notes page please include the following statement: "Excavation within 25' of the TC Energy pipelines in this area is federally regulated. A TC Energy representative must be present during any excavation. In the event TC Energy is not present and excavation takes place, the excavator will be charged for all costs associated with the excavation to expose the TC Energy pipelines to confirm no damage has occurred. This applies to any excavation regardless of the depth."*

*In addition, the design team and ODOT D6 are working together to add a pay item with the tracing submittal for the contractor to expose and verify the TC-Energy Gas lines at the locations noted above. Appendix A provides additional TC-Energy locate information as determined by Subsurface Utility Consultant Surveying and Mapping.*

*The Tracing plan will comply with these comments.*

**Columbia Gas Transmission/TC-Energy has a private easement for the 20-inch gas line crossing locations noted above.**

### **COLUMBIA GAS OF OHIO**

Contacts: Rob Caldwell, Nicholas Wells, Lori Wade

3550 Johnny Appleseed Ct.

Columbus, Ohio 43231

614.818.2104 - O

614.370.1906 - C

rcaldwell@nisource.com

[LWade@nisource.com](mailto:LWade@nisource.com)

[nwells@nisource.com](mailto:nwells@nisource.com)

Columbia Gas of Ohio has the following known potential conflicts at the approximate locations stated below (refer to plan sheets for exact locations):

- Noise Wall 15 – Sta 1501+80
- Noise Wall 8 – Sta 817+85

*The plans have been updated to clear the locations above. In addition, the design team and ODOT D6 are working together to add a pay item with the tracing submittal for the contractor to expose and verify the Columbia Gas lines at the locations noted above. Appendix A provides additional Columbia Gas*

*locate information as determined by Subsurface Utility Consultant Surveying and Mapping.*

Utility Coordination with Columbia Gas of Ohio was held on 4-30-2024 with Arcadis, SAM and Columbia Gas. Resolution of the Columbia Gas Action items from the 4-30-24 call will be integrated into the Tracing submittal and the plan set revised accordingly. Minutes from the 4-30-24 call follow:

Hi Lori Wade (Columbia Gas),

Thanks for your time today discussing the gas line locate challenges at the west side of Harlem Road (please see attached PDF). We appreciate your offer to help with the following tasks:

1. Checking with your locator who marked the blue clouded alignment in the attached PDF of his confidence level, as well as discuss how the line was located (electronic signal, existing plans, etc.)
2. Checking with your engineering group if the line crossing under SR 161 could be abandoned/capped at the south R/W line thus eliminating any concern of a conflict. If this same check could be done at New Albany Condit Road that would be greatly appreciated, because we have a conflict at that location as shown in the attached PDF titled "SAM-GAS and Water LOCATE AT New Albany Condit".
3. Checking with your real estate group if a private easement is associated with the gas line within the EX R/W limits of SR 161 at the Harlem Crossing.
4. Checking with your engineering group if they can in the field mark/locate the line for us. Arcadis/SAM would survey the line once it is marked in the field.

As shared on the call, SAM's locate signals has the line located in the proximity of the green cloud. SAM shared that the signal was very apparent under the existing gas marker (see attached PDF for the marker). It's also believed from the locate maps you shared that there's only one gas line crossing SR 161 at this location. In addition, it's very unusual for a gas line to be located several feet from a gas marker unless an obstruction is causing the need for an offset which doesn't appear to be the case at this location.

Additional Correspondence with Columbia Gas:

- An email was sent on 4/14/24 notifying Columbia Gas of Ohio of potentially two conflicts.
- The Stage 3 plan set was sent on 4/18/24 requesting Columbia Gas of Ohio to review the set and provide any additional comments and/or concerns.

The Utility Note will be updated upon receipt of a response from Columbia Gas.

**On 5-20-2024 Columbia Gas reported their lines are in private right of way.**

#### **EVERSTREAM**

Contact: Scott Lancia and Kann Khay  
240 N 5th St. Suite 168  
Columbus, Ohio 43215  
m 614.354.7666

kkhay@everstream.net

Everstream reported on 10-9-23 by email that Everstream has aerial facilities within the project limits. The aerial facilities appear to be clear of the work. Everstream reported on 2-28-24 that Everstream's facilities have not changed from stage 1.

**As evidenced by the following 4/29<sup>th</sup> email exchange, Everstream is clear of the proposed work and their facilities are not in a private easement.**

Sent on 4-29-2024 by Jeff H to Kann Khay:

Thank you for your response!

Based on these locations shown in the attached PDF it's apparent that Everstream is clear of the proposed work. If Everstream feels otherwise, please advise.

Thanks,

Jeff

Received on 4-29-2024 from Kann Khay:

Hi Jeff,

Everstream's facilities within the projects limits are in ODOT R/W. Please see the attached mark ups. Let me know if you have any questions.

Thank you,

Kann Khay

OSP Engineer III

#### **MCI - VERIZON**

Contact: Maurice Donnell Jones

120 Ravine St.

Akron, Ohio 44303

330.253.8267

Maurice Donnell Jones <maurice.jones@one.verizon.com>

VZFiber-centralohio@verizon.com

The latest response from Verizon was received by email on 3-14-2024.

Please use the following for all correspondence: VZFiber-centralohio@verizon.com and provide an update of the projects status.

Thank you

Maurice D Jones

Network Engineer & Operations

7575 Commerce Ct, Lewis Ctr, OH 43035

O: 740-879-5259

M: 614-593-6685

E: maurice.jones@one.verizon.com

*Utility Coordination with Verizon is on-going most recently on 5-06-2024, when Arcadis (Jeff H) left a voice message on Maurice Jones's office and mobile phone numbers listed above, requesting that Verizon reply to our many attempts to reach them.*

*Additional coordination follows:*

*On 4-18-24 a Stage 3 plan set was provided for their review. Verizon was also notified that prior attempts to receive comments from them at Stage 1 and Stage 2 submittals have been unsuccessful. Verizon was also notified that the next submittal is the final tracing submittal which is scheduled on 5/22/2024, with the request to advise of any issues or conflicts as soon as possible (by 5/4th). Verizon was notified that construction is scheduled to commence per ODOT's schedule on 10/1/2024.*

*In addition, on 4-26-2024, the following information/response was requested from AT&T:*

- 1. Does Verizon have facilities within the project limits of the existing Right of Way of State Route 161?*
- 2. If Verizon does have facilities within the project limits of the existing Right of Way of State Route 161, are these facilities within a Verizon easement.*

*The Utility Note will be updated upon receipt of a response from Verizon.*

**SPECTRUM**

Contact: Mark-Henry Reynolds  
3760 Interchange Dr.  
Columbus, Ohio 43204  
614.255.6349  
[DL-MOH-CONSTRUCTION-FRELO-TEAM@charter.com](mailto:DL-MOH-CONSTRUCTION-FRELO-TEAM@charter.com)

**SPECTRUM is clear of the project construction, based on the following call on 5-6-2024 between Arcadis (Jeff H) and Spectrum (Mark-Henry). The call concluded the following:**

After jointly discussing the attached PDF titled "print" and the photo below (see 2-26-2024 email), we concluded Spectrum facilities will be clear of the subject project's construction. Confirmed during our discussion, the attached print shows that Spectrum fiber is outside of the existing SR 161 R/W, while an aerial line is along the west side of Harlem Road on an existing pole line.

One last question, please confirm if the Spectrum arial facilities along the west side of Harlem Road are located within a Spectrum private easement? ODOT District 6 has requested this information. Please let me know if you have any additional questions.

Arcadis sent an updated Stage 3 plan set on 4-17-2024 and requested that a teams call be set up to determine if conflicts exist, or to determine if Spectrum is clear of the project limits.

**On 5-7-2024 Spectrum responded (Mark-Henry) as follows:**

Jeff,

**Our lines are in public right of way. Thank you.**

**CITY OF COLUMBUS AND NEW ALBANY NOTIFICATIONS**

**CITY OF COLUMBUS DEPARTMENT OF PUBLIC SERVICE**

Stage 1, 2 and 3 Plans have been provided to the City of Columbus Department of Public

Service by ODOT District 6. The Design Team has worked with ODOT D6 to resolve Stage 1 and Stage 2 and Stage 3 comments appropriately.

From a utility perspective, the City of Columbus Traffic Division (see contact info below) commented at Stage 1 that the CTSS fiber needs to be exposed to verify adequate depth under the proposed 81" barrier. The limits the CTSS fiber shall be exposed are:

- 81" barrier 10 (Sta 1000+00 to 1003+00)
- 81" barrier 10 (Sta 1015+00 to 1016+50)

*In order to satisfy the COC concerns and comply with the comment, the following note was added to the plan:*

*EX CTSS FIBER DEPTH BASED ON FIELD SURVEY SHOTS AT EX. PULL BOX LOCATIONS. THE CONTRACTOR SHALL USE EXTREME CAUTION WHILE WORKING NEAR THE CTSS FIBER TO NOT EXCAVATE BELOW THE 81" BARRIER FOUNDATION LIMITS SHOWN ON THE TYPICAL SECTIONS.*

*In addition, NOTES were added with the tracing submittal for the contractor to expose and verify the CTSS fiber location where proposed storm sewers are being constructed.*

City of Columbus Traffic  
Contact: Scott Wolfe  
1881 E. 25th Street  
Columbus, Ohio 43215  
614.645.0423  
sawolfe@columbus.gov

**Review of the construction plans for the Columbus Traffic CTSS cable indicate the lines are in public right of way.**

#### **CITY OF COLUMBUS DEPARTMENT OF UTILITIES**

Stage 1, 2 and 3 Plans have been provided to the City of Columbus Department of Public Utilities by ODOT District 6. The Design Team has worked with ODOT D6 to resolve Stage 1 and Stage 2 comments appropriately. Stage 3 comments have yet to be received.

From a utility perspective, the City of Columbus Division of Water (see contact info below) has two waterlines that are of concern at the following approximate locations:

- 16" water at Wall 9 (approximately 3 feet west of Sta 900+00)
- 12" water at Wall 15 (Sta 1502+10)

*The design team worked with ODOT D6 to mitigate the potential wall 9 conflict by removing one panel and starting wall 9 further east (new location 900+16). This design change will be part of the tracing plan submittal. For the 12" water at wall 15, it was decided on a call with D6 (4/30<sup>th</sup> call) that pay items would be set up to have the contractor locate the 12" water at wall 15, and if needed a plan addendum would shift the drilled shaft locations to miss the existing 12" water. The COC has been*

*notified by email on 4-17-2024 of possible conflicts. Appendix A provides additional Division of Water locate information as determined by Subsurface Utility Consultant Surveying and Mapping.*

City of Columbus Division of Water  
910 Dublin Road  
Columbus, Ohio 43215  
614.645.6729  
[DPU\\_GIS\\_MAPPING@columbus.gov](mailto:DPU_GIS_MAPPING@columbus.gov)

**On 5-2-2024, the DOW (Dan Hill) confirmed that their facilities within the project limits and within the existing Right of Way of State Route 161 are NOT within a DOW easement.**

#### **CITY OF NEW ALBANY**

Contact: Justin Wilkinson  
Public Services Engineer  
614-939-2236  
City of New Albany Public Service  
7800 Bevelhymer Rd.  
New Albany, Ohio 43054  
[publicservice@newalbanyohio.org](mailto:publicservice@newalbanyohio.org)  
[jwilkinson@newalbanyohio.org](mailto:jwilkinson@newalbanyohio.org)

On 4-26-24 New Albany replied that they have 2-1.25" HDPE INNERDUCTS WITH TRACER WIRE AT A MINIMUM DEPTH OF 42" (ABOUT 5 FEET NORTH OF EXISTING FENCE LINE). **The line is a NEW ALBANY line and does not have a PRIVATE EASEMENT.** (*Arcadis believes the 2-1.25" ducts are clear of construction*).

The City of New Albany reported by email on 3-7-2024 that they have a fiber that runs on the East side of 605 but it goes aerial over 161. They have not confirmed if the work will be in conflict, but they propose to have their locator to mark the fiber. (*Arcadis believes the aerial line over 161 is clear of construction*).

### **UTILITY COMPANIES THAT REPORT TO BE CLEAR OF THE PROJECT LIMITS**

#### **AT&T - OHIO (3 contacts have been provided)**

Contact: Donald G. Marshall Jr.  
AT&T - Ohio  
111 N 4th Street Room 802  
Columbus, Ohio 43215  
MARSHALL, DONALD G [dm619w@att.com](mailto:dm619w@att.com)

Contact: Nicole Wilson  
AT&T Ohio Engineering  
Legal Mandate - Columbus  
111 N 4th St



Columbus, OH 43215  
c. 614-483-1065  
nw9565@att.com

Contact: William Taggart  
LEAD NETWORK PROJ/PROG MGMT OH, MI, KY, WV  
AT&T ACE Long Haul  
8372 E Broad St  
Reynoldsburg, OH 43068  
Off 614-868-2511  
Mob 614-370-5414  
TAGGART, WILLIAM R [wt2462@att.com](mailto:wt2462@att.com)

AT&T (Nicole Wilson) reported on 5-1-2024 (see below) that they have no conflicts and that all of their facilities are beyond the construction limits, contained within easements in subdivisions.

**From:** WILSON, NICOLE <[nw9565@att.com](mailto:nw9565@att.com)>  
**Sent:** Wednesday, May 1, 2024 2:46 PM  
**To:** Bryant, Troy <[Troy.Bryant@dot.ohio.gov](mailto:Troy.Bryant@dot.ohio.gov)>; MARSHALL, DONALD G <[dm619w@att.com](mailto:dm619w@att.com)>; TAGGART, WILLIAM R <[wt2462@att.com](mailto:wt2462@att.com)>; DIEDERICH, MICHAEL D <[md4145@att.com](mailto:md4145@att.com)>  
**Cc:** Montoya, Katherine <[Katherine.Montoya@dot.ohio.gov](mailto:Katherine.Montoya@dot.ohio.gov)>  
**Subject:** RE: FRA-161-15.80, PID 116322

Good Afternoon,

AT&T wireline has no conflicts. All of our facilities are beyond the construction limits, contained within easements in subdivisions. I advised Arcadis of this back in March.

#### **FRANKLIN COUNTY SANITARY ENGINEERS**

Contact: Stephen A Renner  
280 E. Broad Street, Suite 201  
Columbus, Ohio 43215-4520  
Direct Office: 614-525-5850  
Main Office: 614-525-3940  
Fax: 614-525-5210  
[sarenner@franklincountyohio.gov](mailto:sarenner@franklincountyohio.gov)  
[kmdoklov@franklincountyohio.gov](mailto:kmdoklov@franklincountyohio.gov)

On 4-26-2024, Franklin County Sanitary Engineers reported they do not have any assets in the project area so there are no comments, and there is no need to come back and wait on me.

#### **AMERICAN ELECTRIC POWER - TELECOM**

Contact: Jim Rigdon / Network Consultant  
[jerigdon@aep.com](mailto:jerigdon@aep.com)  
[OHFiberRelocate@aep.com](mailto:OHFiberRelocate@aep.com)

O:330-438-7159 | C:330.413.6132  
301 CLEVELAND AVE., S.W., CANTON, OH 44702-1623

AEP Telecom reported on 3-06-2024 the following:

I have reviewed the plans for installing noise walls along SR 161 and AEP does not have any fiber that is in conflict with your plans. There is a fiber cable that we installed for the City of New Albany on the East side of SR 605 and SR161. Our records indicate that this was installed aerial across SR 161 on the AEP Distribution poles. Please contact the City of New Albany for any locate requests on this fiber.

Thank you, Jim Rigdon

### **AQUA OHIO WATER AND SEWER**

Contact: Jake Logan  
Aqua Ohio - Sewer & Water  
6650 South Avenue  
Boardman, Ohio 44512  
330.726.8151 x50559  
[jelogan@aquaamerica.com](mailto:jelogan@aquaamerica.com)

Aqua Ohio Water and Sewer reported on 10/10/23 that Aqua Ohio has no facilities located along SR 161 between Ulry Rd. and US-62 and are clear of this project.

### **COLUMBUS FIBERNET**

Contact: Matt Blackstone & ChernorMarju Jalloh  
1600 Walcutt Road  
Columbus, Ohio 43215  
mablackstone@columbusfiber.net  
CFNinfo@columbusfiber.net  
cmjalloh@columbusfiber.net

Columbus Fibernet reported on 10/9/23 that CFN is not within the proposed construction areas.

### **ACD Net**

Contact: Noviana Marseline  
1800 N. Grand River Avenue  
Lansing, Michigan 48906  
517 999 3291  
Noviana Marseline <marseline.noviana@acd.net>  
Shirley Yohnka <yohnka.shirley@acd.net>

ACD Net reported on 2/27/24 that they have looked over the attached plans and KEPS Technologies dba ACD.net is clear of conflict with the proposed improvements.

Regards, Noviana Marseline

**AT&T Transmission Metropolitan Communications Group, Ohio (MCG)**

Contact: James Schneider  
155 Commerce Park Dr. Ste. 1  
Westerville, Ohio 43082  
[james.schneider@mcgfiber.com](mailto:james.schneider@mcgfiber.com)

AT&T Transmission Metropolitan Communications Group, Ohio (MCG) reported on 10/11/23 the following: On behalf of Bill Taggart, AT&T Transmission / Long Lines does not have facilities in the project area described. I have attached a map that shows this. I am not responding for AT&T Metro/LNS/ AT&T Ohio/Ohio Bell or any other affiliate of the Att Corp. These affiliates will respond on their own behalf.

**Buckeye Pipe Line Company, L.P.**

Contact: Brandon Allen  
993 Brodhead Road, Suite 100  
Coraopolis, PA 15108  
[Ballen@buckeye.com](mailto:Ballen@buckeye.com)

Buckeye Pipe Line Company reported by email on 10/9/23 that Buckeye will not be involved with the project.

**Crown Castle Fiber aka (Fibertech & Lighttower, Fiber Systems LLC)**

Contact: Jon Tarnowski  
2 Easton Oval - Suite 425  
Columbus, OH 43219  
[jon.tarnowski@crowncastle.com](mailto:jon.tarnowski@crowncastle.com)

Crown Castle reported on 2-27-24 that they received the prints, reviewed them, and can confirm they do not have any conflicts and no fiber cable utilities within the scope of this project.

**Del-CO Water Co., Inc.**

Contact: Dave Wolf  
6658 Olentangy River Road  
Delaware, Ohio 43015  
[dwolf@delcowater.com](mailto:dwolf@delcowater.com)

Del-CO Water Co. reported on 10/9/23 that Del-Co Water does not have any facilities in the area of this project.

**Del-CO Water Co., Inc. (Damage Prevention/Solution Center)**

Contact: Christine Myers  
6658 Olentangy River Road  
Delaware, Ohio 43015  
[cmyers@delcowater.org](mailto:cmyers@delcowater.org)

Del-CO Water Co. reported on 10/9/23 that Del-Co Water does not have any facilities in the area of this project.

**HORIZON**

Contact: Walter Martin / Outside Plant Engineer  
1123 Goodale Boulevard, Suite 550  
Columbus, Ohio 43212  
M: 740.215.9066  
Walter.Martin@HorizonConnects.com

Horizon confirmed on 3-15-2024 that they are not located on the project limits.

**Lumen (fka Centurylink/Level 3 Communications/TW Telecom/Qwest)**

Contact: Steve Kauffman  
SR NETWORK IMPLEMENTATION PROGRAM MANAGE  
6185 Huntley Rd, Suite E, Columbus, OH 43229  
tel: 614-255-2112 | cell: 614-554-7071  
steve.kauffman@lumen.com  
relocations@lumen.com

Lumen reported on 2-27-24 they do not see any conflict with our facilities. The only location we have facilities is at 161 & St Rt 605. This cable runs parallel to St Rt 605 and crosses over 161 via an aerial crossing of the AEP joint use poles. It does not appear that these lines will be impacted. Please let me know if you have any further questions or concerns. Steve Kauffman

**BRIGHTSPEED**

Xan Marie Rypkema  
Sr Analyst for Road Moves  
303 525 2994  
704-314--2659  
Rypkema, Xan <xan.rypkema@brightspeed.com>  
Relocations@Brightspeed.com

Brightspeed reported the following by email on 2-26-2024: they reviewed your utility notice dated 02/23/2024 regarding the P 143726 | PID117607 FRA-161-15.80 N Walls OH 161 - Uly Rd to Harlem Rd, Westerville OH ("Project"). In response to your inquiry please find the enclosed drawings indicating the approximate location of the Brightspeed facilities (the "Facilities") and that Brightspeed Local does not have facilities within your proposed construction area.

**MARATHON PIPE LINE LLC**

Contact: Landon Morris  
1900 West Avenue H  
Griffith, Indiana 46319  
Mobile: (419) 957-7792  
lrmorris@marathonpetroleum.com

Marathon reported by email on 2-23-24 that they are clear of this work.

**MMI ATLANTIC LLC (Facebook)**

Contact: Brian Gray

deguise@fb.com

[relocations@middlemileinfra.com](mailto:relocations@middlemileinfra.com)

MMI reported by email on 10-10-23 that they are not in conflict with the wall project. Should the project limits change please let me know so we can re-evaluate.

**NE Ohio Natural Gas Corp.**

Contact: Mark Callahan

5640 Lancaster - Newark Rd. NE

Pleasantville, Ohio 43148

office: 740-400-4319 | fax: 740-862-6330 | cell: 740-400-2509

qfortaleza@neogas.com | www.neogas.com

[mcallahan@neogas.net](mailto:mcallahan@neogas.net)

NEO reported by email on 2-26-2024 that they do not have any facilities in this area.

**COGENT COMMUNICATIONS (fka Sprint/T-Mobile)**

Contact: Becker, Paul <pbecker@cogentco.com>

11370 Enterprise Park Dr.

Sharonville, Ohio 43148

815-557-8416

Cogent Communications (formerly Sprint long-distance) reported on 2-29-2024 that they have NO fiber optic cable within the vicinity of your project. Please update your contact information for the former Sprint now Cogent Fiber Network. I am now the primary contact please update your records.

Paul Becker 815-557-8416

[pbecker@cogentco.com](mailto:pbecker@cogentco.com)

**SUMMIT IG**

Contact: Steve Ragland

[sragland@summitig.com](mailto:sragland@summitig.com)

dchelf@summitig.com

563-272-1575

Summit IG reported by email on 3-15-2024 that Summit IG is clear of the proposed work site and do not have any utilities in the area. Feel free to reach out if you have any questions.

Thanks Doug Chelf

Project Manager

dchelf@summitig.com

563-272-1575

**WINDSTREAM-KDL Inc. (McLeodUSA)**

Contact: Leon Taylor

2165 State Route 133 South

Blanchester, Ohio 45107  
[leon.taylor@windstream.com](mailto:leon.taylor@windstream.com)

Windstream reported by email on 10/9/23 that Windstream is clear in the proposed area.

**ZAYO GROUP (fka City Net)**

Contact: Eric Alexander  
251 Neilson Street  
Columbus, Ohio 43215  
eric.alexander@zayo.com  
Brendon.Eatmon@Cobbfindley.com

Zayo Group reported by email on 4-15-2024 that Zayo does not have facilities along the PID 117607 project scope.

**SOUTH CENTRAL POWER Co.**

Contact: Zach Reed  
720 Mill Park Drive  
Lancaster, Ohio 43130  
zreed@SouthCentralPower.com

South Central Power reported by email on 10/9/23 that South Central does not own or operate facilities within the proposed project area and is clear of all construction.

**SUBURBAN NATURAL GAS**

Contact: Aaron Roll  
2626 Lewis Center Rd.  
Lewis Center, Ohio 43035  
[aroll@sngco.com](mailto:aroll@sngco.com)

Suburban Natural Gas reported by email on 2-26-2024 that they don't have any pipelines involved in this project.

**BREEZELINE (fka WOW)**

Contact: Rebecca Thomas | Supervisor, OSPE  
t: 614-921-8635  
www.teamfishel.com  
3675 Corporate Drive  
Columbus, Ohio 43231  
DL\_CMHFR@atlanticbb.com

Breezeline reported on 3-14-2024 that there are no Breezeline conflicts in the area of this project, as shown.

**GENERAL COMMENTS**

The Contractor shall exercise caution when working in proximity to the existing and/or

relocated utility facilities.

The Contractor should confirm the depth of existing utilities that proposed storm sewers cross before ordering structures.

Section 105.07 of the ODOT 2019 Construction and Material Specifications requires, among other things, that the Contractor cooperate with all utilities within the limits of this construction project and take responsibility for the protection of the utility property and services.

Section 3781.30 of the Ohio Revised Code requires among other things, that the Contractor protect and preserve the markings of approximate locations of underground utility facilities and conduct the excavation in the vicinity of underground utility facilities in a careful and prudent manner.

**Appendix A**  
**FRA-161-15.80 Noise Walls PID 117607**





Surveying And Mapping, LLC (SAM)  
 12480 DeBartolo Drive, Unit F  
 North Jackson, OH 44451  
 Office: 330-794-4455

SUE QUALITY LEVEL A  
 TEST HOLE #1  
 NEW ALBANY, OH  
 12" D.I. WATER

<b>Project:</b>	FRA 161 NOISE WALL	<b>Date Performed:</b>	1/11/2024
<b>SAM, LLC Project #</b>	1023078248	<b>Client:</b>	ARCADIS

<b>Project Location:</b>	NEW ALBANY, OHIO 43084	<b>Surface Material &amp; Thickness:</b>	NATURAL GROUND
<b>Utility Location:</b>	I-70 NEW ALBANY CONDIT ROAD UNDERPASS	<b>Marker Elevation:</b>	924.82
<b>Utility Sta./Offset:</b>	N/A	<b>Surface Condition:</b>	GOOD
<b>Record Utility:</b>	12" DUCTILE IRON WATER	<b>Trench Material:</b>	CLAY
<b>Utility Owner:</b>	CITY OF NEW ALBANY	<b>Utility Bedding Material:</b>	CLAY
<b>Contact:</b>	N/A	<b>Utility Found:</b>	12" DUCTILE IRON WATER
<b>Phone/Email:</b>	N/A	<b>Utility Condition:</b>	GOOD
<b>Field Crew:</b>	TW/VS	<b>Utility Depth:</b>	7.08'
<b>Field Conditions:</b>	CLOUDY/ COLD		

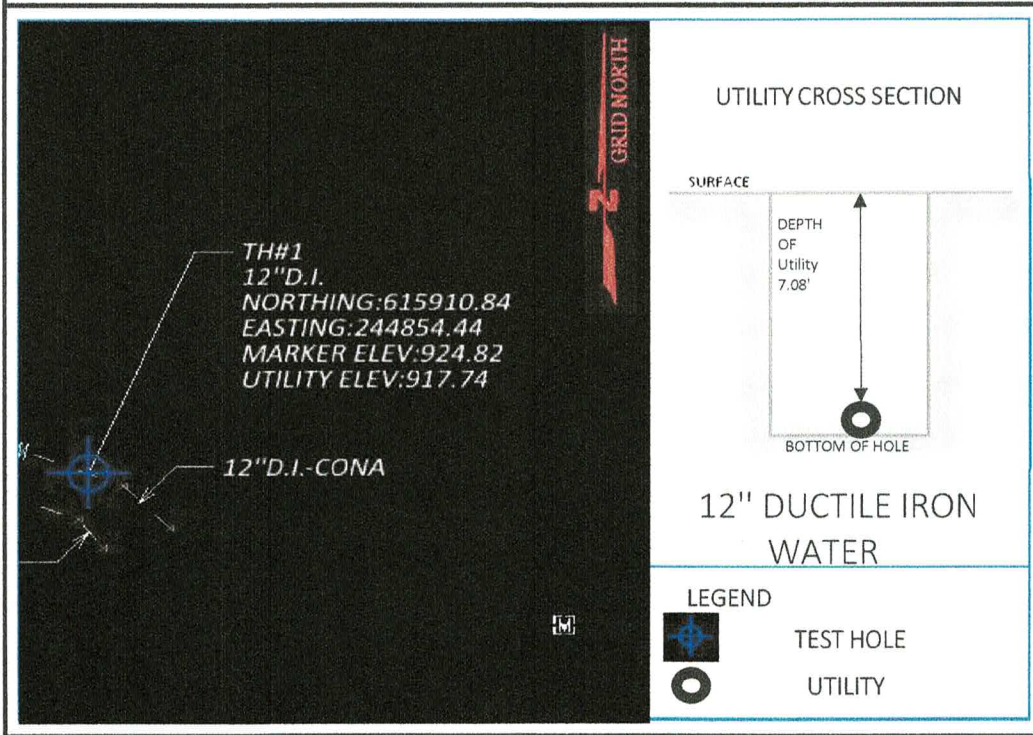

**PROJECT CONTROL**

Coordinates shown are based on OHDOT LDP, Franklin CO, Grid, derived from GPS observations utilizing the Trimble Network..

**EXCAVATION CENTERLINE COORD.**

NORTHING 615910.84  
 EASTING 244854.44  
 TOP ELEV. 917.74

**STATE OF OHIO**  
 RHETT P. SLOAN  
 8812  
 REGISTERED PROFESSIONAL SURVEYOR

*Rhett Sloan*

**Comments**

1. SAM, LLC laid out this Test Hole by designating the water prior to excavation of the utility.

2. Field crew unable to get visual ID on pipe due to large amounts of backfilling water.



Surveying And Mapping, LLC (SAM)  
 12480 DeBartolo Drive, Unit F  
 North Jackson, OH 44451  
 Office: 330-794-4455

SUE QUALITY LEVEL A  
 TEST HOLE #2  
 NEW ALBANY, OH  
 8" PLASTIC GAS

Project:	FRA 161 NOISE WALL	Date Performed:	1/11/2024
SAM, LLC Project #	1023078248	Client:	ARCADIS
Project Location:	NEW ALBANY, OHIO 43084	Surface Material & Thickness:	NATURAL GROUND
Utility Location:	I-70 NEW ALBANY CONDUIT ROAD UNDERPASS	Surface Elevation:	922.80
Utility Sta./Offset:	N/A	Surface Condition:	GOOD
Record Utility:	8" PLASTIC GAS	Trench Material:	CLAY
Utility Owner:	COLUMBIA GAS	Utility Bedding Material:	CLAY
Contact:	N/A	Utility Found:	8" PLASTIC GAS
Phone/Email:	N/A	Utility Condition:	GOOD
Field Crew:	TW/VS	Utility Depth:	5.10'
Field Conditions:	CLOUDY/ COLD		

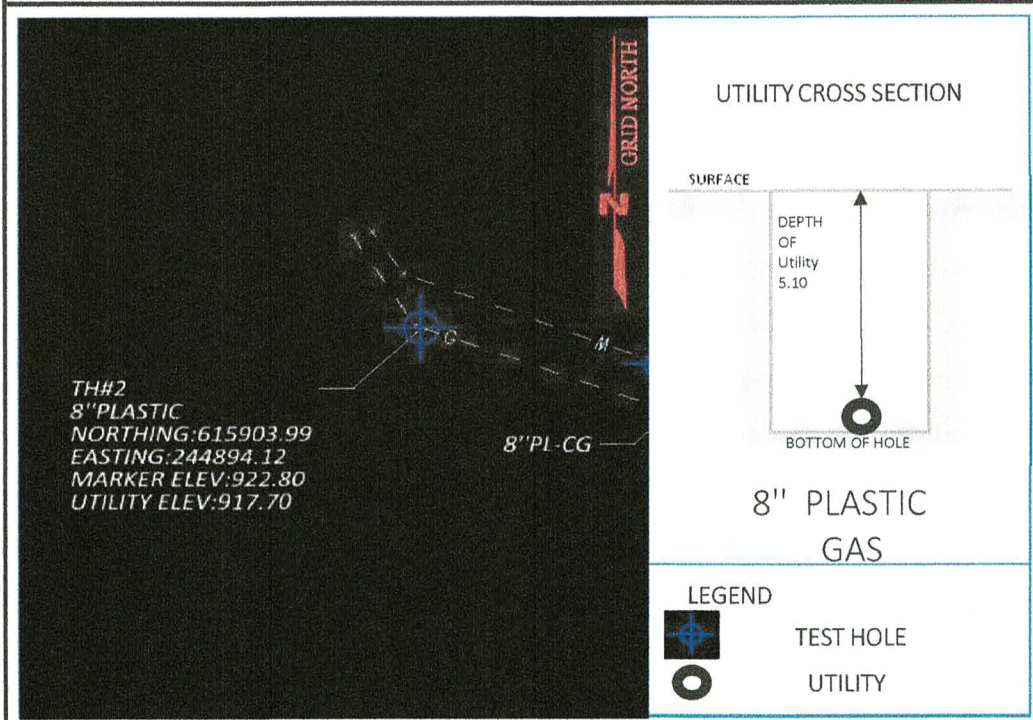

<b>PROJECT CONTROL</b>	
Coordinates shown are based on OHDOT LDP, Franklin CO, Grid, derived from GPS observations utilizing the Trimble Network.	
<b>EXCAVATION CENTERLINE COORD.</b>	
NORTHING	615903.99
EASTING	244894.12
TOP ELEV.	917.70

**Comments**

- SAM, LLC laid out this Test Hole by designating the gas prior to excavation of the utility.
- Field crew unable to get visual ID on pipe due to large amounts of backfilling water.



Surveying And Mapping, LLC (SAM)  
 12480 DeBartolo Drive, Unit F  
 North Jackson, OH 44451  
 Office: 330-794-4455

**SUE QUALITY LEVEL A  
 TEST HOLE #3  
 NEW ALBANY, OH  
 12" STEEL GAS**

<b>Project:</b>	<b>FRA 161 NOISE WALL</b>	<b>Date Performed:</b>	<b>1/19/2024</b>
<b>SAM, LLC Project #</b>	<b>1023078248</b>	<b>Client:</b>	<b>ARCADIS</b>
<b>Project Location:</b>	NEW ALBANY, OHIO 43084	<b>Surface Material &amp; Thickness:</b>	NATURAL GROUND
<b>Utility Location:</b>	I-70 NEW ALBANY RD EXIT RAMP	<b>Surface Elevation:</b>	990.22
<b>Utility Sta./Offset:</b>	N/A	<b>Surface Condition:</b>	POOR
<b>Record Utility:</b>	12" STEEL GAS	<b>Trench Material:</b>	CLAY
<b>Utility Owner:</b>	TC ENERGY	<b>Utility Bedding Material:</b>	UNK
<b>Contact:</b>	N/A	<b>Utility Found:</b>	N/A
<b>Phone/Email:</b>	N/A	<b>Utility Condition:</b>	UNK
<b>Field Crew:</b>	RA/JP	<b>Excav Depth:</b>	6.74'
<b>Field Conditions:</b>	CLOUDY/ COLD		

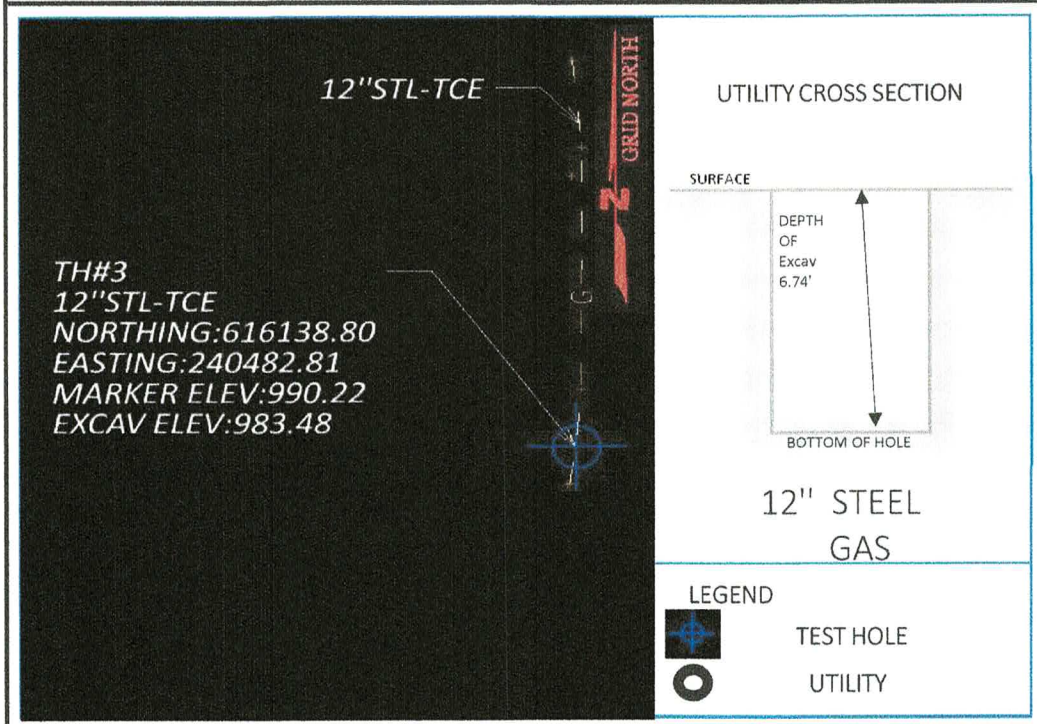

**PROJECT CONTROL**

Coordinates shown are based on OHDOT LDP, Franklin CO, Grid, derived from GPS observations utilizing the Trimble Network.

**EXCAVATION CENTERLINE COORD.**

**NORTHING** 616138.80  
**EASTING** 240482.81  
**EXCAV ELEV.** 983.48

**STATE OF OHIO**  
**RHETT P. SLOAN**  
**8812**  
**REGISTERED PROFESSIONAL SURVEYOR**

*Rhett Sloan*

**Comments**

1. SAM, LLC laid out this Test Hole by designating the gas prior to excavation of the utility.

2. Dug to a depth of 6.74' was unable to continue due to ground conditions. The crew encountered a rock shelf while performing vacuum excavation. SAM field staff spoke with Christian Grillo and were advised to not use the jack hammer to penetrate the rock to expose the pipeline. SAM field staff made additional efforts to locate the gas line north of the off ramp and surveyed the 2 other locations where vacuum excavation took place by others. This confirmed the horizontal alignment for the pipeline and provided electronic depths that coincide with information from TC Energy stating "The south side of 161 this line is approx. 12' to top of pipe and on the North side of 161 the line is approx. 15'6" to Top of pipe"



Surveying And Mapping, LLC (SAM)  
 12480 DeBartolo Drive, Unit F  
 North Jackson, OH 44451  
 Office: 330-794-4455

SUE QUALITY LEVEL A  
 HARLEM RD WATER  
 NEW ALBANY, OH  
 16" METALLIC WATER

Project:	FRA 161 NOISE WALL	Date Performed:	4/12/2024
SAM, LLC Project #	1023078248	Client:	ARCADIS
Project Location:	NEW ALBANY, OHIO 43084	Surface Material & Thickness:	NATURAL GROUND
Utility Location:	SR161/HARLEM RD UNDERPASS	Surface Elevation:	975.41
Utility Sta./Offset:	N/A	Surface Condition:	POOR
Record Utility:	16" METALLIC WATER	Trench Material:	CLAY
Utility Owner:	CITY OF COLUMBUS	Utility Bedding Material:	UNK
Contact:	N/A	Utility Found:	N/A
Phone/Email:	N/A	Utility Condition:	UNK
Field Crew:	TW/V5	Excav Depth:	PROBE

### UTILITY CROSS SECTION

SURFACE

BOTTOM OF HOLE

LEGEND

○ UTILITY

#### PROJECT CONTROL

Coordinates shown are based on OHDOT LDP, Franklin CO, Grid, derived from GPS observations utilizing the Trimble Network.

#### EXCAVATION CENTERLINE COORD.

NORTHING	615909.36
EASTING	237875.48
TOP ELEV.	

**Comments**

We made an attempt on the water line but encountered a few issues. We gathered as much data as we could to help build a narrative for you to try to move forward with the design/construction. Tom Turner was on site with us and provided information as to how the water mark got where it is. Tom stated

- The water is 73' feet from the CL of Harlem Rd.
- It is estimated at 15' in depth near the fence line
- The water is under the 54" CMP storm drain that crosses the area

Our equipment could not detect the water line with accuracy where Tom had it marked by the ROW fence, but north of the ROW we could detect it. We feel comfortable saying the horizontal alignment is "close" but not to the level as we did at the ramp or the other utilities. We have a signal at the blow off valve back away from 161 but the signal dies there. We took a depth measurement at the valve but hit an obstruction at 6'. Due to the "weak" signal we had with our pipe and cable locator and some GPR data we have depicted the location in the SUE base map.

We did attempt to dig and hydro probe on the one-call marks but encountered lots of roots and then rock below that at 3' at the preferred location and along the line in other locations. We depicted some of the probing locations for reference. Being that there is minimal hope for finding this line with out some major additional efforts, and being that there is an engineered drawing, I would advise to use the water record to build the vertical profile into your design for this area. I know all of this is not ideal, but we put a lot of effort into just getting this far.



Surveying And Mapping, LLC (SAM)  
 12480 DeBartolo Drive, Unit F  
 North Jackson, OH 44451  
 Office: 330-794-4455

SUE QUALITY LEVEL A  
 TEST HOLE #4  
 NEW ALBANY, OH  
 12" STEEL GAS

<b>Project:</b>	FRA 161 NOISE WALL	<b>Date Performed:</b>	1/19/2024
<b>SAM, LLC Project #</b>	1023078248	<b>Client:</b>	ARCADIS
<b>Project Location:</b>	NEW ALBANY, OHIO 43084	<b>Surface Material &amp; Thickness:</b>	NATURAL GROUND
<b>Utility Location:</b>	I-70 NEW ALBANY ROAD EXIT	<b>Surface Elevation:</b>	991.20
<b>Utility Sta./Offset:</b>	N/A	<b>Surface Condition:</b>	POOR
<b>Record Utility:</b>	12" STEEL GAS	<b>Trench Material:</b>	CLAY
<b>Utility Owner:</b>	TC ENERGY	<b>Utility Bedding Material:</b>	UNK
<b>Contact:</b>	N/A	<b>Utility Found:</b>	N/A
<b>Phone/Email:</b>	N/A	<b>Utility Condition:</b>	UNK
<b>Field Crew:</b>	TW/VIS	<b>Excav Depth:</b>	DUG:4.53 PROBE:6.33
<b>Field Conditions:</b>	CLOUDY/ COLD		

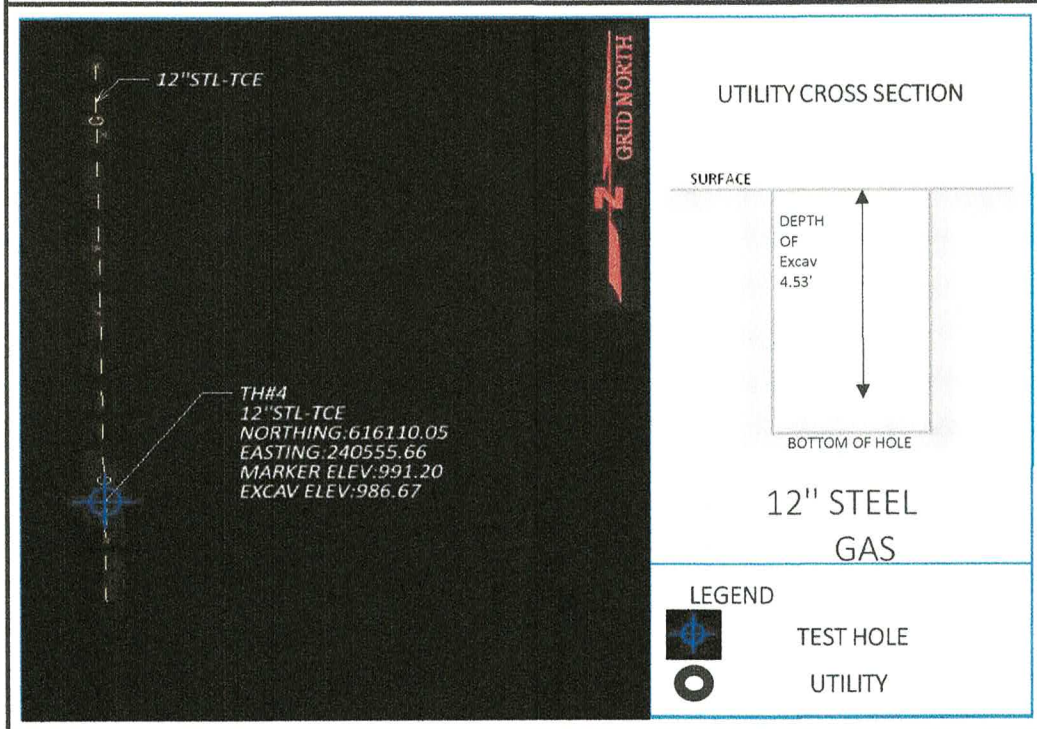

**PROJECT CONTROL**

Coordinates shown are based on OHDOT LDP, Franklin CO, Grid, derived from GPS observations utilizing the Trimble Network.

**EXCAVATION CENTERLINE COORD.**

NORTHING 616110.05  
 EASTING 240555.66  
 TOP ELEV. 986.67

STATE OF OHIO  
 RHETT P. SLOAN  
 8812  
 REGISTERED PROFESSIONAL SURVEYOR

*Rhett Sloan*

**Comments**

- SAM, LLC laid out this Test Hole by designating the gas prior to excavation of the utility.
- Dug to a depth of 4.53' probe to 6.33' was unable to continue due to ground conditions and obstructions. The crew encountered a rock shelf while performing vacuum excavation. SAM field staff spoke with Christian Grillo and were advised to not use the jack hammer to penetrate the rock to expose the pipeline. SAM field staff made additional efforts to locate the gas line north of the off ramp and surveyed the 2 other locations where vacuum excavation took place by others. This confirmed the horizontal alignment for the pipeline and provided electronic depths that coincide with information from TC Energy stating "The south side of 161 this line is approx. 12' to top of pipe and on the North side of 161 the line is approx. 15'6" to Top of pipe"



Surveying And Mapping, LLC (SAM)  
 12480 DeBartolo Drive, Unit F  
 North Jackson, OH 44451  
 Office: 330-794-4455

**SUE QUALITY LEVEL A  
 TEST HOLE #5  
 NEW ALBANY, OH  
 12" STEEL GAS**

**Project:** FRA 161 NOISE WALL **Date Performed:** 1/19/2024

**SAM, LLC Project #** 1023078248 **Client:** ARCADIS

Project Location:	NEW ALBANY, OHIO 43084	Surface Material & Thickness:	NATURAL GROUND
Utility Location:	I-70 NEW ALBANY CONDIT ROAD UNDERPASS	Surface Elevation:	973.56
Utility Sta./Offset:	N/A	Surface Condition:	POOR
Record Utility:	6" STEELGAS	Trench Material:	CLAY
Utility Owner:	COLUMBIA GAS	Utility Bedding Material:	UNK
Contact:	N/A	<b>Utility Found:</b>	<b>N/A</b>
Phone/Email:	N/A	<b>Utility Condition:</b>	<b>UNK</b>
Field Crew:	TW/VS	<b>Excav Depth:</b>	<b>DUG:5.82 PROBE:7.86</b>
Field Conditions:	CLOUDY/ COLD		

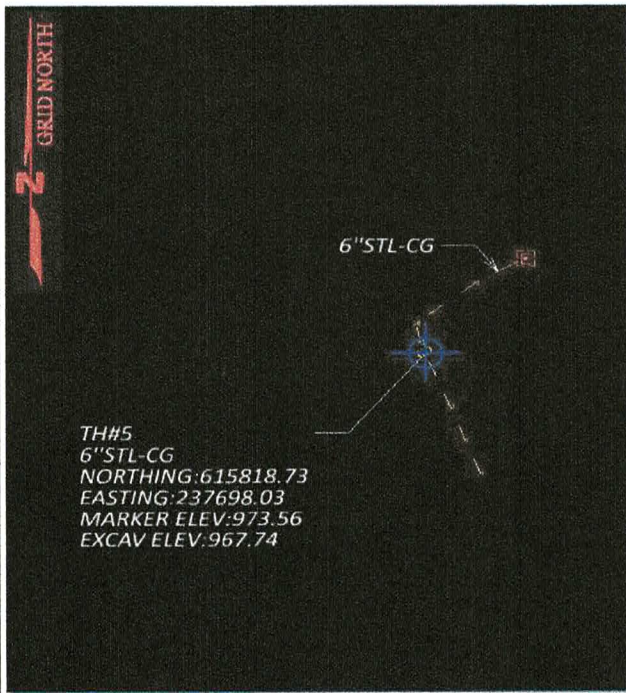

TH#5  
 6"STL-CG  
 NORTHING:615818.73  
 EASTING:237698.03  
 MARKER ELEV:973.56  
 EXCAV ELEV:967.74

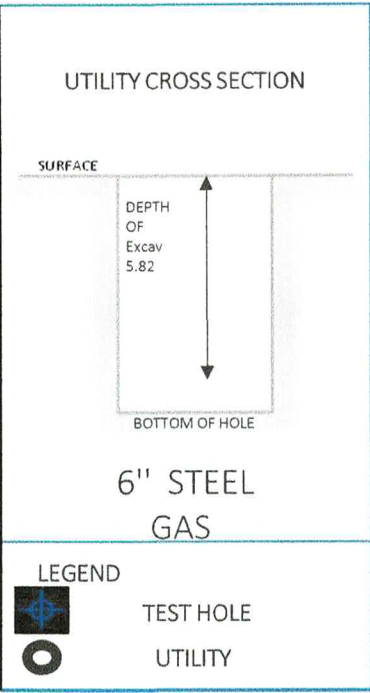

**LEGEND**

	TEST HOLE
	UTILITY

**PROJECT CONTROL**  
 Coordinates shown are based on OHDOT LDP, Franklin CO, Grid, derived from GPS observations utilizing the Trimble Network.

**EXCAVATION CENTERLINE COORD.**

NORTHING	615818.73
EASTING	237698.03
TOP ELEV.	967.74

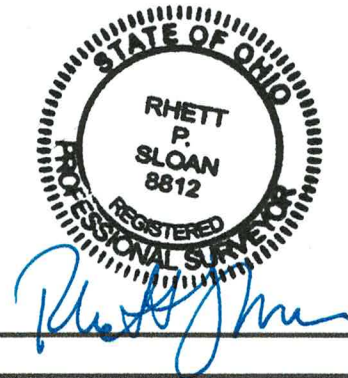

**Comments**

- SAM, LLC laid out this Test Hole by designating the gas prior to excavation of the utility.
- Dug to a depth of 5.82' and probed to 7.86' was unable to continue due to ground conditions and obstructions. No pipeline was exposed. This test hole was on a NiSource/Columbia Gas line on the north side of FRA 161 and was difficult to detect directly under FRA 161 and was only detected on the slopes of wither side of the highway. Per a Teams call with Arcadis/SAM/Columbia there is only one gas line crossing just west of Harlem Road.