

**10D CURVE DATA**  
 CONST. 81" BARRIER 10  
 P.I. = STA. 1014+82.35  
 $\Delta = 15^{\circ}41'58''$  LT  
 $Dc = 04^{\circ}46'29''$   
 $R = 1,200.00'$   
 $T = 165.44'$   
 $L = 328.81'$   
 $E = 11.35'$

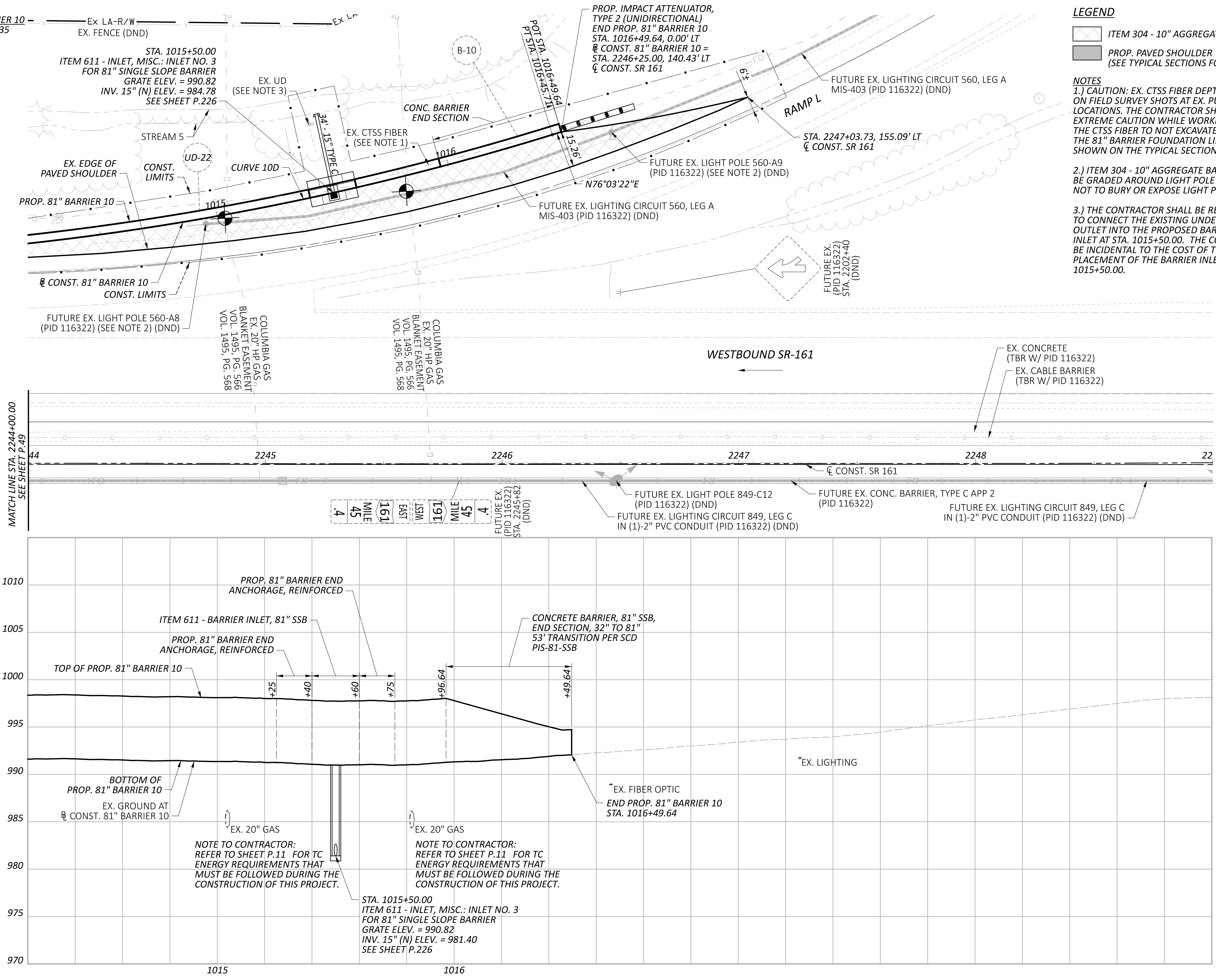

**LEGEND**

- ITEM 304 - 10" AGGREGATE BASE
- PROP. PAVED SHOULDER (SEE TYPICAL SECTIONS FOR PAVEMENT BUILDUP)

**NOTES**

- CAUTION: EX. CTSS FIBER DEPTH BASED ON FIELD SURVEY SHOTS AT EX. PULL BOX LOCATIONS. THE CONTRACTOR SHALL USE EXTREME CAUTION WHILE WORKING NEAR THE CTSS FIBER TO NOT EXCAVATE BELOW THE 81" BARRIER FOUNDATION LIMITS SHOWN ON THE TYPICAL SECTIONS.
- ITEM 304 - 10" AGGREGATE BASE SHALL BE GRADED AROUND LIGHT POLE SO AS NOT TO BURY OR EXPOSE LIGHT POLE BASE.
- THE CONTRACTOR SHALL BE REQUIRED TO CONNECT THE EXISTING UNDERDRAIN OUTLET INTO THE PROPOSED BARRIER INLET AT STA. 1015+50.00. THE COST SHALL BE INCIDENTAL TO THE COST OF THE PLACEMENT OF THE BARRIER INLET AT STA. 1015+50.00.

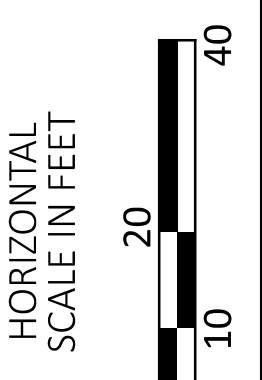
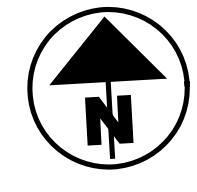

**PLAN & PROFILE - 81" BARRIER 10  
 STA. 2244+00.00 TO STA. 2249+00.00**

DESIGN AGENCY	
ARCADIS	
8101 NORTH HIGHWAY 300 SUITE 100 COLUMBIA, MD 21046-4900 www.arcadis.com	
DESIGNER	
JMK	
REVIEWER	
JDH 05-22-24	
PROJECT ID	
117607	
SHEET	TOTAL
P.50	P.297