

FED. RD. DIST. NO.	STATE	PROJECT	FISCAL YEAR
10	OHIO		1943

1
8

MADISON COUNTY
S.H. 1 SEC. D1, D2, C & B
& WEST JEFFERSON (PT.)

STATE OF OHIO DEPARTMENT OF HIGHWAYS NATIONAL ROAD

S.H. 1 Sec. D1, D2, C, B & West Jefferson (Pt.)

MADISON COUNTY

SUMMERFORD, DEER CREEK & JEFFERSON TWP'S. VILLAGE OF WEST JEFFERSON

LINE DATA

BEGIN PROJECT & SECTION D1 & D2	STA. 0 +00	= 37,006.0	LIN. FT.
END SECTION D1 & D2	STA. 370 +06		
BEGIN SECTION C	STA. 0 +00	= 28,847.0	LIN. FT.
END SECTION C	STA. 288 +47		
BEGIN SEC. B & W. Jefferson (pt.)	STA. 0 +00	= 6,200.0	LIN. FT.
END SEC. B & W. Jefferson (pt.)	STA. 62 +00		
GROSS LENGTH OF PROJECT		72,053.0	LIN. FT. OR 13.646 MILES
NO ADDITIONS OR DEDUCTIONS NET LENGTH OF PROJECT		72,053.0	LIN. FT. OR 13.646 MILES

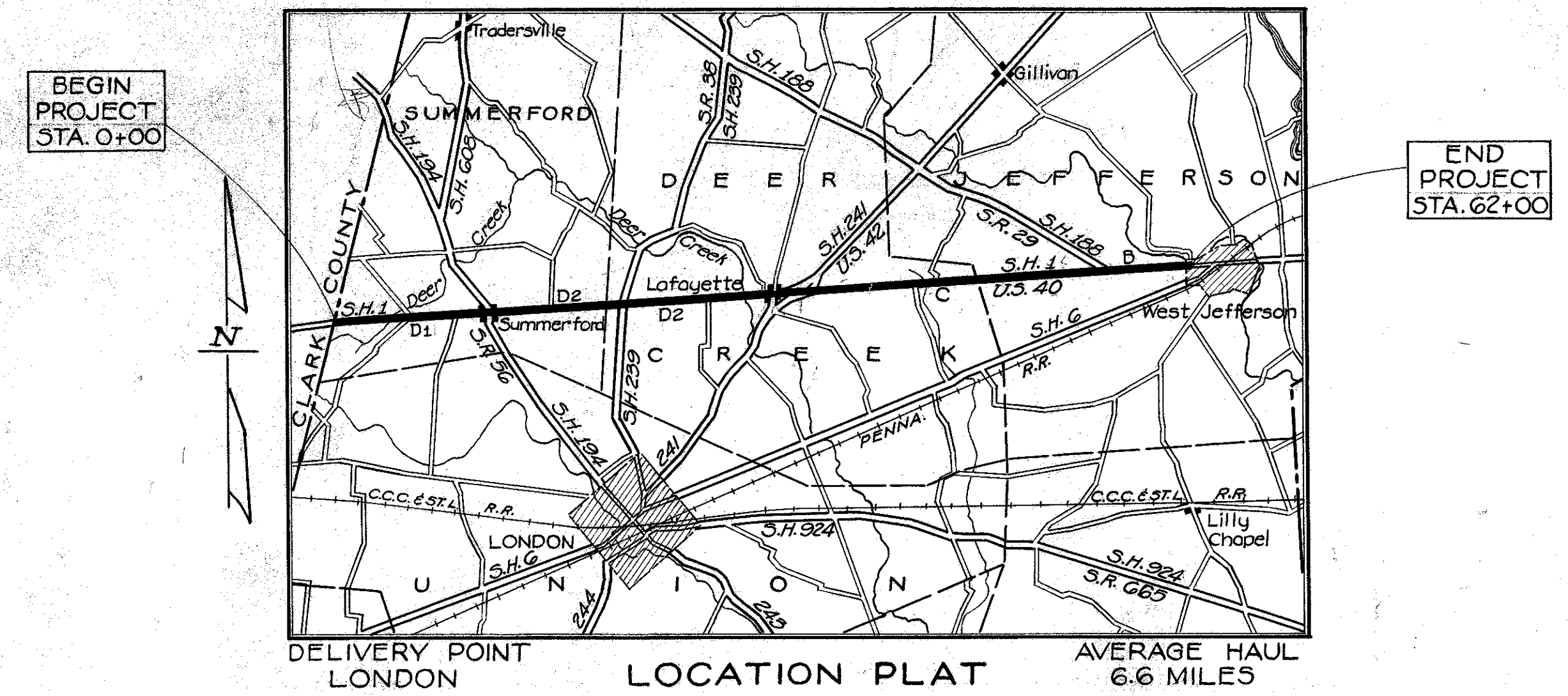

The Standard Specifications of the State of Ohio Department of Highways including changes and Supplemental Specifications listed in the proposal shall govern this improvement.

The right of way necessary for this improvement will be provided by the State of Ohio.

I hereby approve these plans and declare that the making of this improvement will not require the closing of the highway to traffic.

CONVENTIONAL SIGNS

STATE LINE	-----
COUNTY LINE	-----
TOWNSHIP LINE	-----
SECTION LINE	-----
CENTER LINE	120 121
PROPERTY LINE	----- P/L
CITY OR VILLAGE LINE	-----
FENCE LINE	x x x x
STEAM RAILROAD	-----
POLE LINE	φ φ φ φ φ

LOCATION PLAT

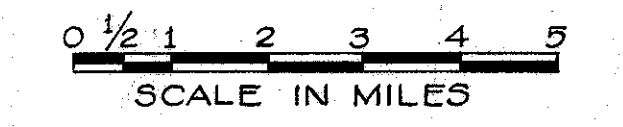

PORTION TO BE IMPROVED	=====
STATE HIGHWAYS	=====
COUNTY ROADS	=====
PLAN	1" = 500'
PROFILE VERTICAL	1" = 50'
PROFILE HORIZONTAL	1" = 500'

File
D-2

APPROVED	<i>J. P. Dhemaker</i>	RESIDENT DIVISION DEPUTY DIRECTOR
DATE	7-1-43	
APPROVED		CHIEF ENGR. BUREAU OF MAINTENANCE
DATE		
APPROVED		CHIEF ENGR. BUREAU OF BRIDGES & R.R. CROSSINGS
DATE		
APPROVED	<i>Murray D. Shaffer</i>	CHIEF ENGR. BUREAU OF LOCATION & RIGHT OF WAY
DATE	3-4-43	
APPROVED	<i>G. V. Hoque</i>	FIRST ASST. DIRECTOR & CHIEF ENGINEER
DATE	3-4-43	
APPROVED	<i>H. J. Sours</i>	DIRECTOR OF HIGHWAYS
DATE	3-4-43	

INDEX OF SHEETS

TITLE SHEET	1
TYPICAL SECTIONS	2
PLAN & PROFILE	3-7
SUMMARY	8

CONSTRUCTION BUREAU
MAY 4 1956
GROUND PHOTOLAB

SUPPLEMENTAL SPECIFICATIONS
NONE

SUPPLEMENTAL PRINTS OF STANDARD CONSTRUCTION DRAWINGS	
G-707	6-1-48

File No.	MADISON COUNTY S.H. 1 SEC. D1, D2, C, B & W. Jefferson (Pt.)
DATE OF LETTING	
CONTRACT No.	

TYPICAL SECTIONS

TYPE T-35

FED. RD. DIST. NO.	STATE	PROJECT	FISCAL YEAR
10	OHIO		1943

MADISON COUNTY
S.H. 1 SEC. D₁, D₂, C & B
& WEST JEFFERSON (PT.)

GENERAL NOTES

EXTRA LEVELING MATERIAL - Of the extra leveling material provided, a sufficient amount shall be used to increase the crown of the existing pavement to that shown on the typical sections.

TRAFFIC - Shall be maintained at all times to the satisfaction of the Director. The item of "Maintaining traffic" shall include furnishing lights, signs, barricades and watchmen necessary to secure the unimpeded flow of traffic twenty four hours daily.

PROFILE - The profile of the proposed surface course shall be approximately 2" inches above that of the existing Pavement.

I-17 AGGREGATES - If the volume of I-17 material incorporated in the project is determined by converting weight to volume, the volume shall be calculated from the actual loose dry weight of the material used, as determined by the laboratory.

FEATHER EDGING - Before placing the asphaltic concrete, a paint coat of bituminous material meeting the requirements of Section M-5.1 shall be applied to the area of existing pavement under the area to be feather-edged. Payment for this paint coat shall be included in the unit price bid for Item T-35

SUPERELEVATION - Superelevation of existing pavement is adequate.

PAVEMENT REMOVAL AND REPLACEMENT - The existing pavement to be removed and replaced shall be determined by the engineer. The existing pavement removed shall be disposed of by the contractor beyond the limits of the project.

LEVELING COURSE - Wherever the depth of the leveling course exceeds 1 3/4", the leveling material below the minimum thickness specified on the plan shall be spread and compacted in one or more courses. No course shall exceed 3" in depth when compacted.

PRIME COAT - Bituminous Prime Coat Federal Specifications 55-A-674 with Amend. 1, Type II shall be applied by distributor or by brooms at the rate of 0.10 gallon per square yard. After the bituminous material has been applied, all material not required to give a uniform coating to the surface shall be swept into all cracks and open joints before the sand cover is placed. (Payment for sand cover is included in price bid per gallon for bituminous material.) Sand cover shall be

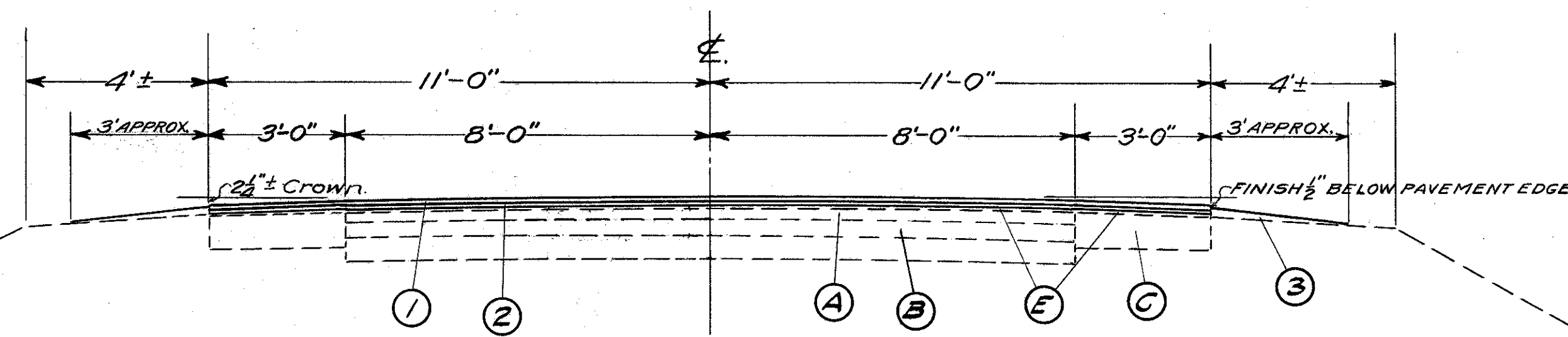

TO BE USED BETWEEN STA. 0+00 AND 130+27 SECTION D₁

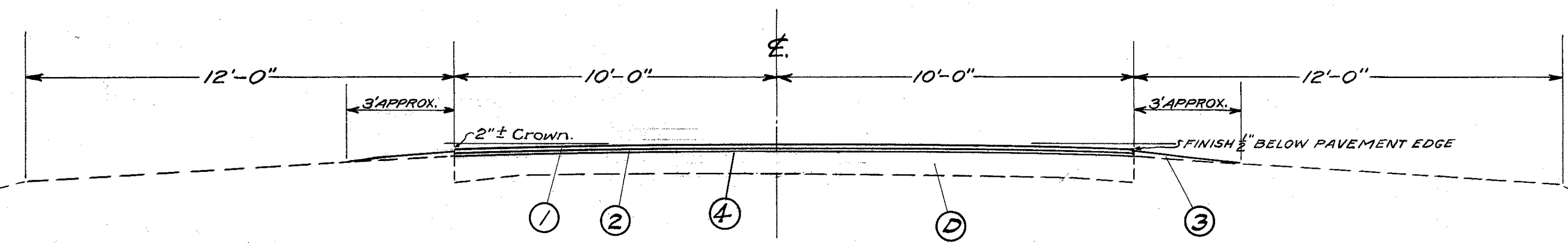

TO BE USED BETWEEN STA. 130+27 AND 370+06 SECTION D₂
STA. 0+00 AND 288+47 SECTION C

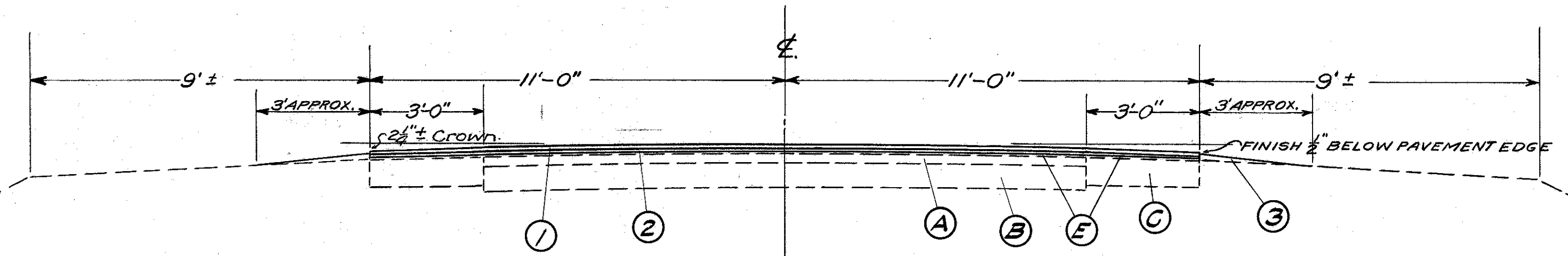

TO BE USED BETWEEN STA. 0+00 AND 62+00 SECTION B & WEST JEFFERSON (PT.)

From W. Jeff. Westerly

- (A) Existing 3"-3 1/2" Bituminous Concrete Surface Course
- (B) Existing Macadam Base Courses 8" Minimum Thickness
- (C) Existing 9" Plain Portland Cement Concrete Widening
- (D) Existing 9"-7"-7"-9" Plain Portland Cement Concrete Pavement 1/4" Crown
- (E) Existing 1/2" Kentucky Rock Asphalt Surface Treatment

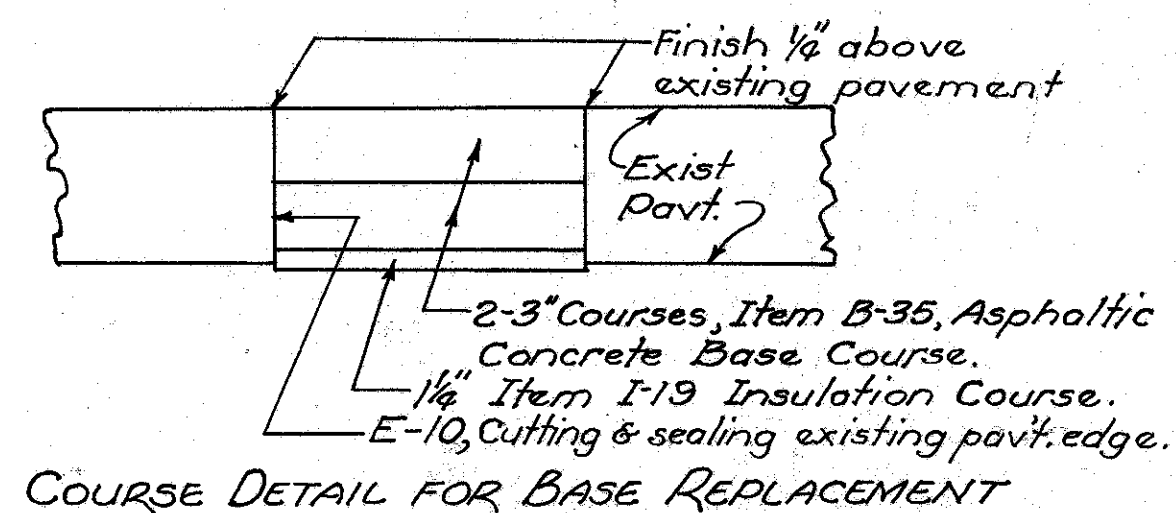

COURSE DETAIL FOR BASE REPLACEMENT

- (1) 1 1/4" Asphaltic Concrete Surface Course (Type-A) Item T-35
- (2) 3/4" (Minimum Thickness) Asphaltic Concrete Leveling Course Item B-35
- (3) Aggregate For Traffic Bound Side Approaches And Berms Item I-17
- (4) Bituminous Prime Coat, Fed Spec. 55-A-674 with Amend 1 Type II including sand cover, Item T-30.

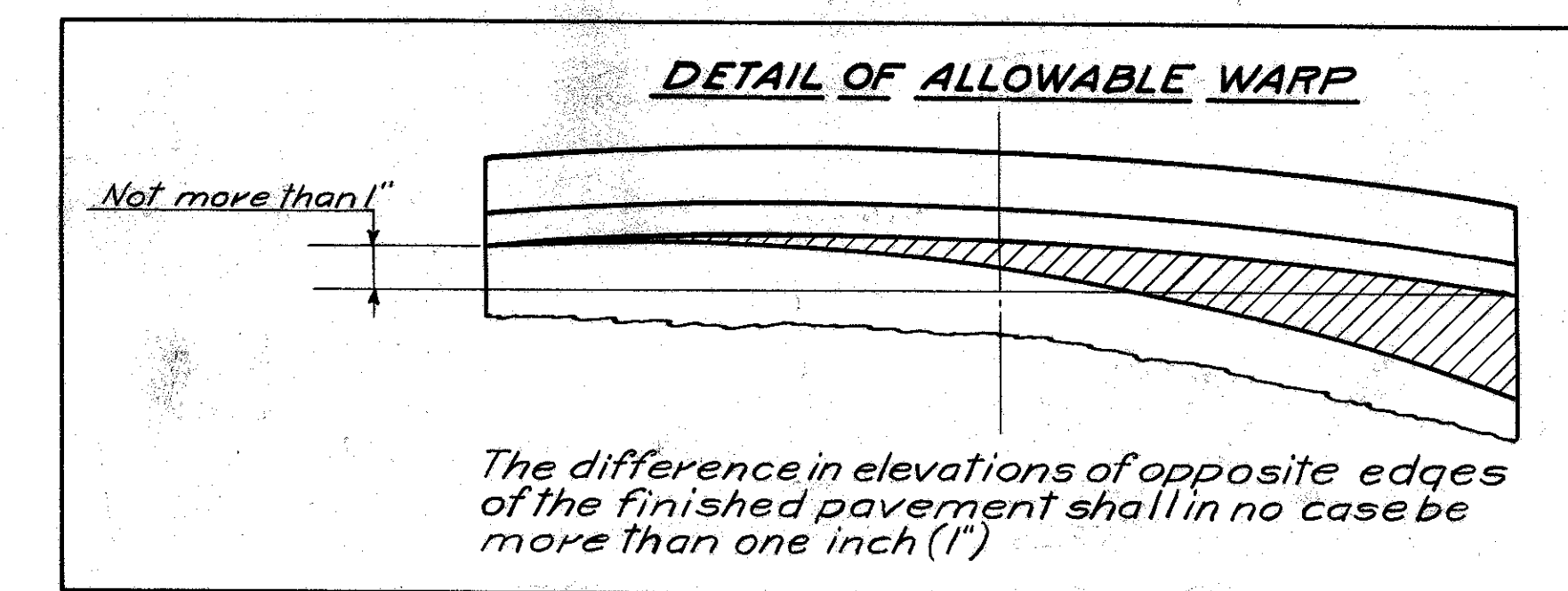

The difference in elevations of opposite edges of the finished pavement shall in no case be more than one inch (1")

uniformly spread at the rate of two to five pounds per square yard at such time and shall be in such condition as to adhere to the bituminous material.

BITUMINOUS CONCRETE BASE COURSE - Base course may be constructed of type A composition.

MADISON COUNTY
S.H. 1 SEC. D₁, D₂, C & B
& WEST JEFFERSON (PT.)

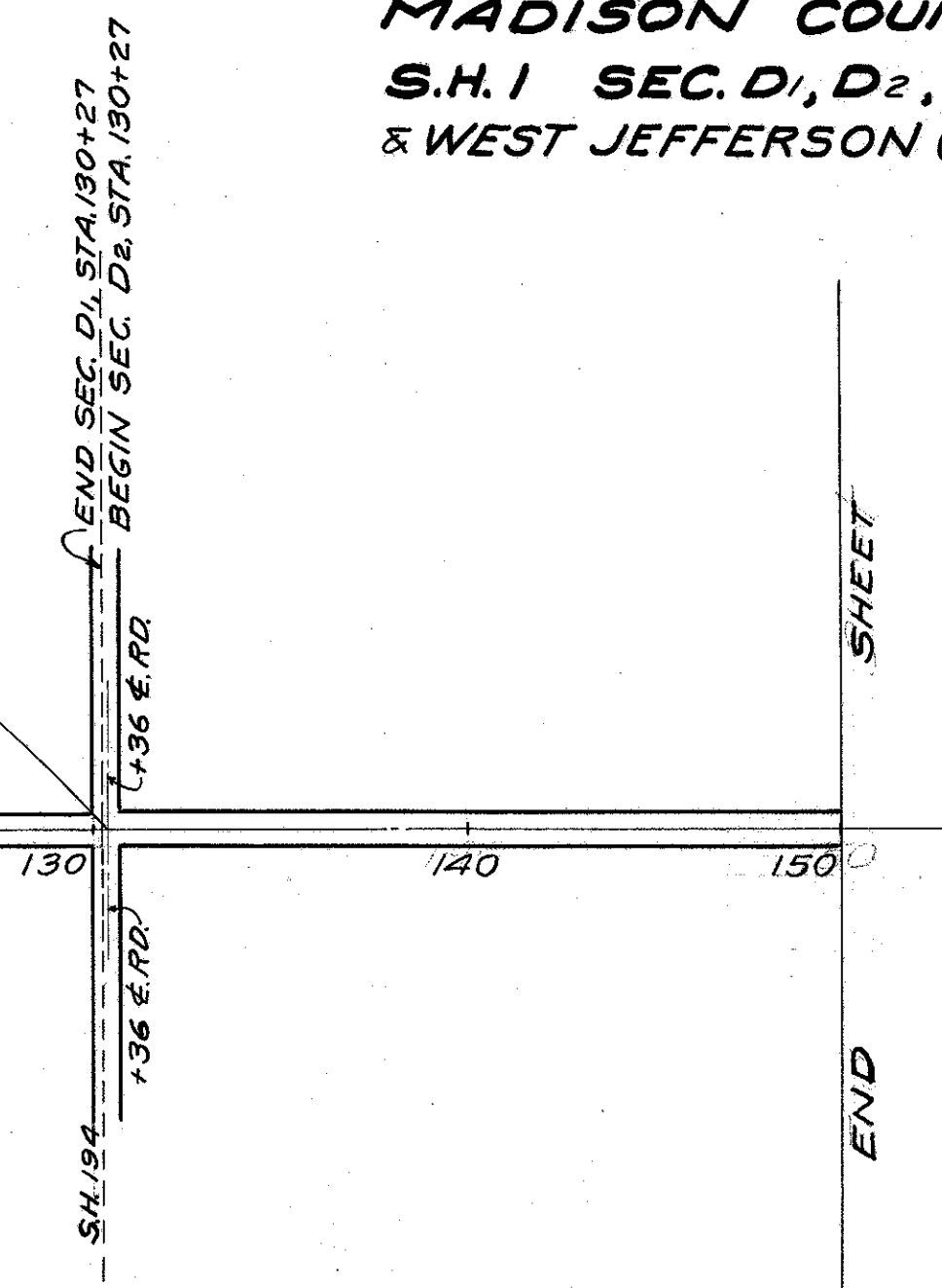
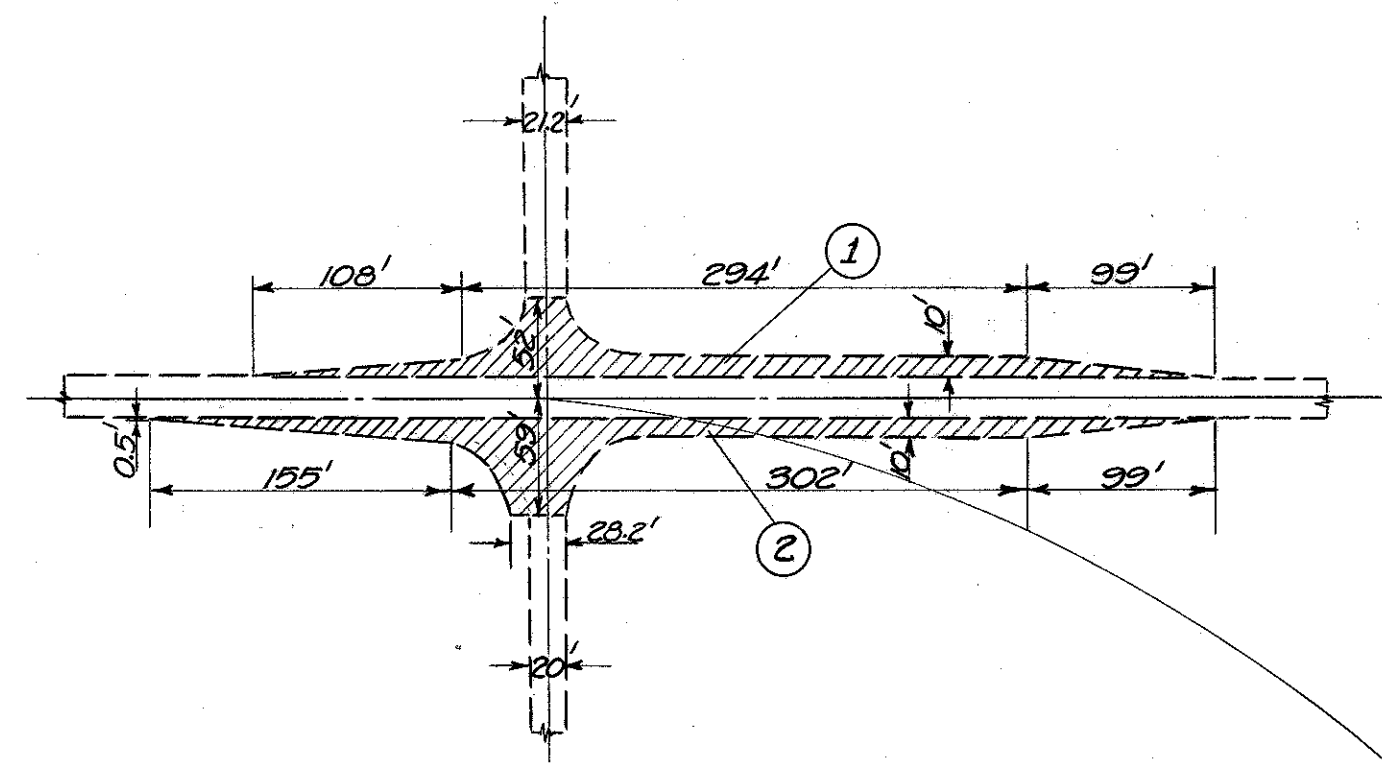

STATION 00+00
 BEGIN PROJECT

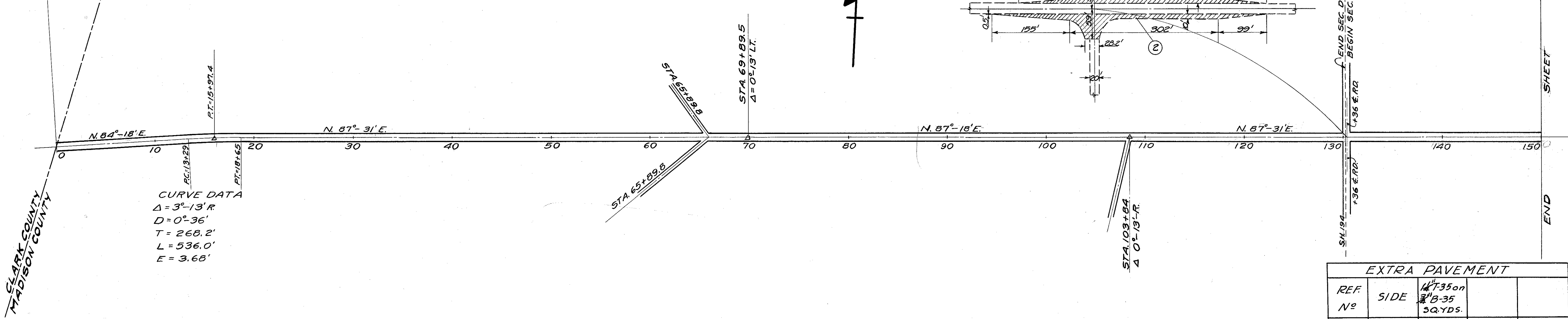

CURVE DATA
 $\Delta = 3^\circ-13'R$
 $D = 0^\circ-36'$
 $T = 260.2'$
 $L = 536.0'$
 $E = 3.68'$

EXTRA PAVEMENT			
REF No	SIDE	14" T-35 on 8" B-35 SQ. YDS.	
1	Lt.	575.5	
2	Rt.	677.5	
TOTAL		1253.0	

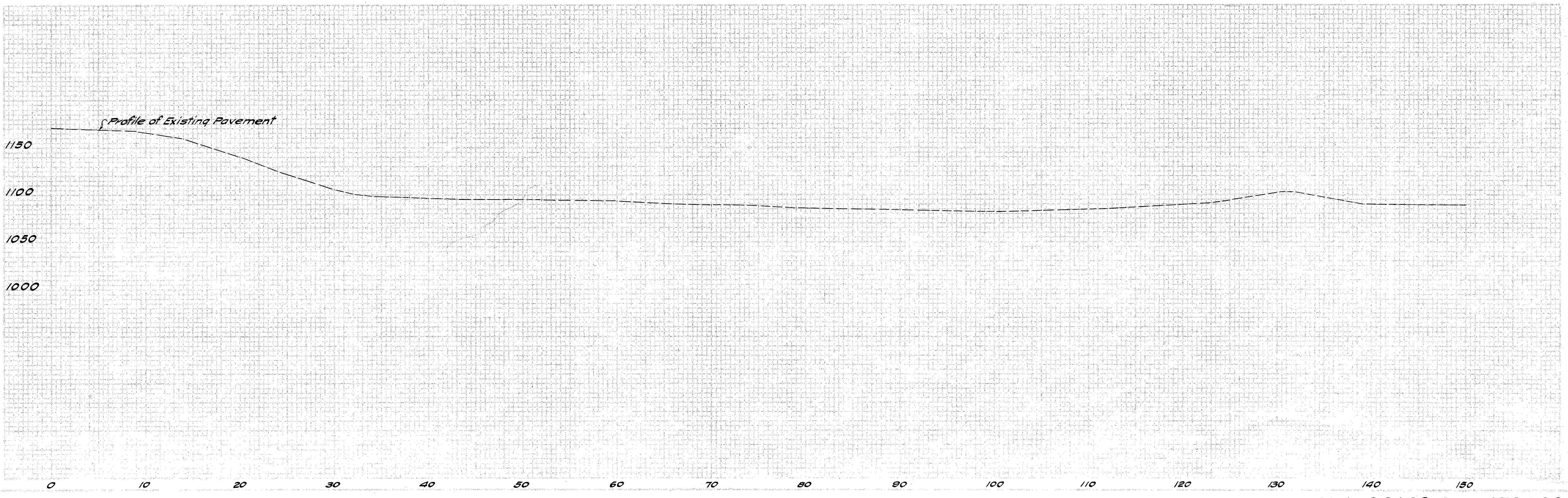

MADISON COUNTY
S.H. 1 SEC. D1, D2, C & B
& WEST JEFFERSON (Pt.)

EXTRA PAVEMENT			
REF. No	SIDE	$\frac{1}{4}$ " T-35 on $\frac{3}{4}$ " B-35 SQYDS.	B-35 WEDGE COURSE CU.YDS.
1	Lt.	862.7	
2	Rt.	853.8	
3	Rt. & Lt.		4.6
4	Rt. & Lt.		34.7
5	Rt. & Lt.		4.6
TOTAL		1716.5	43.9

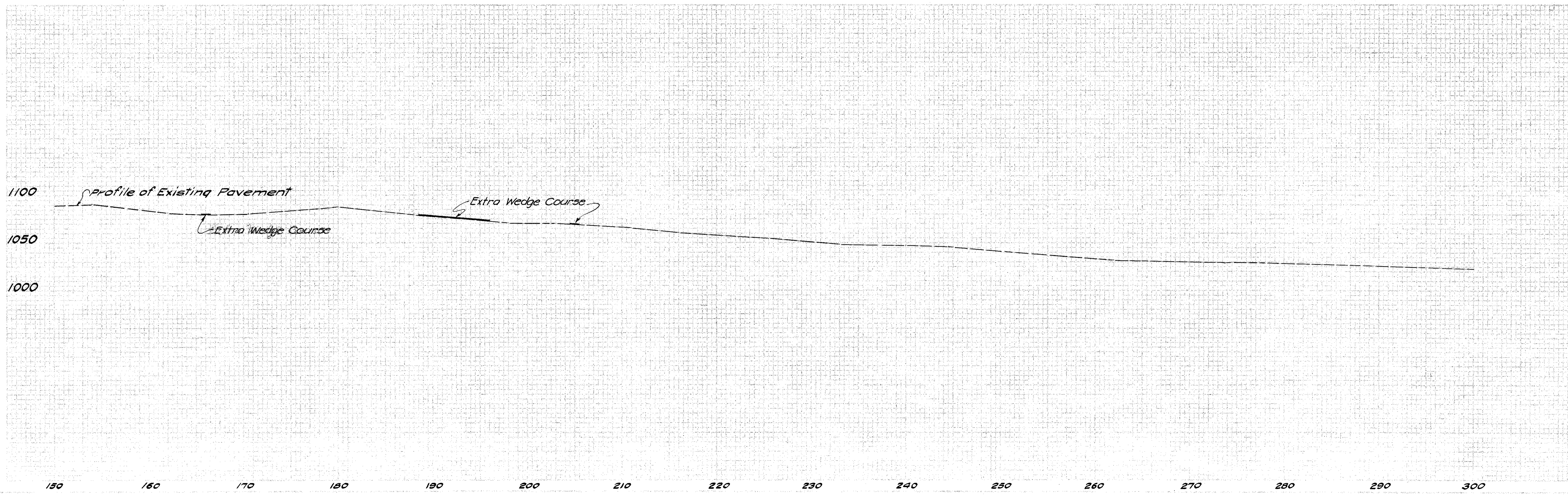
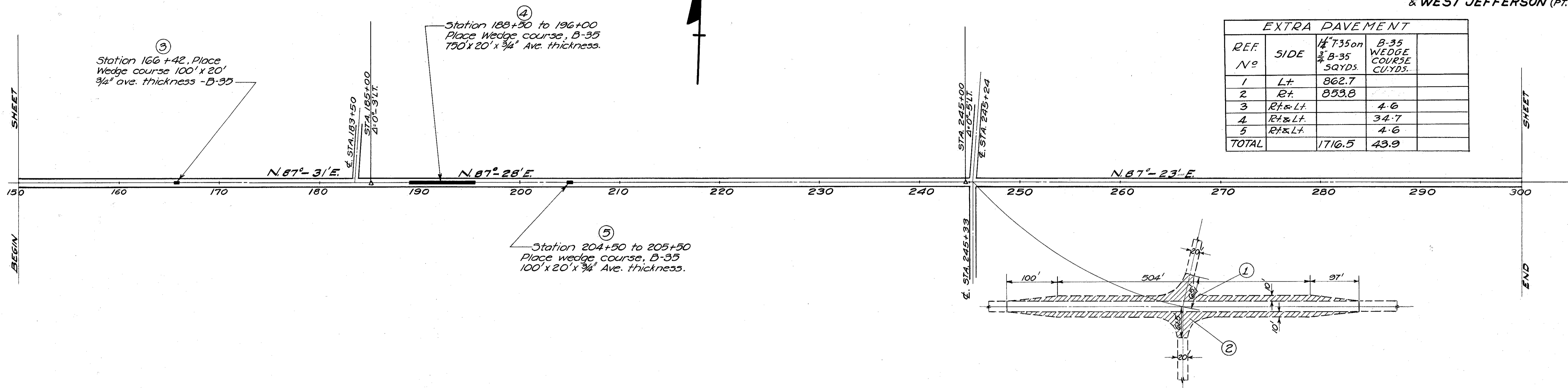

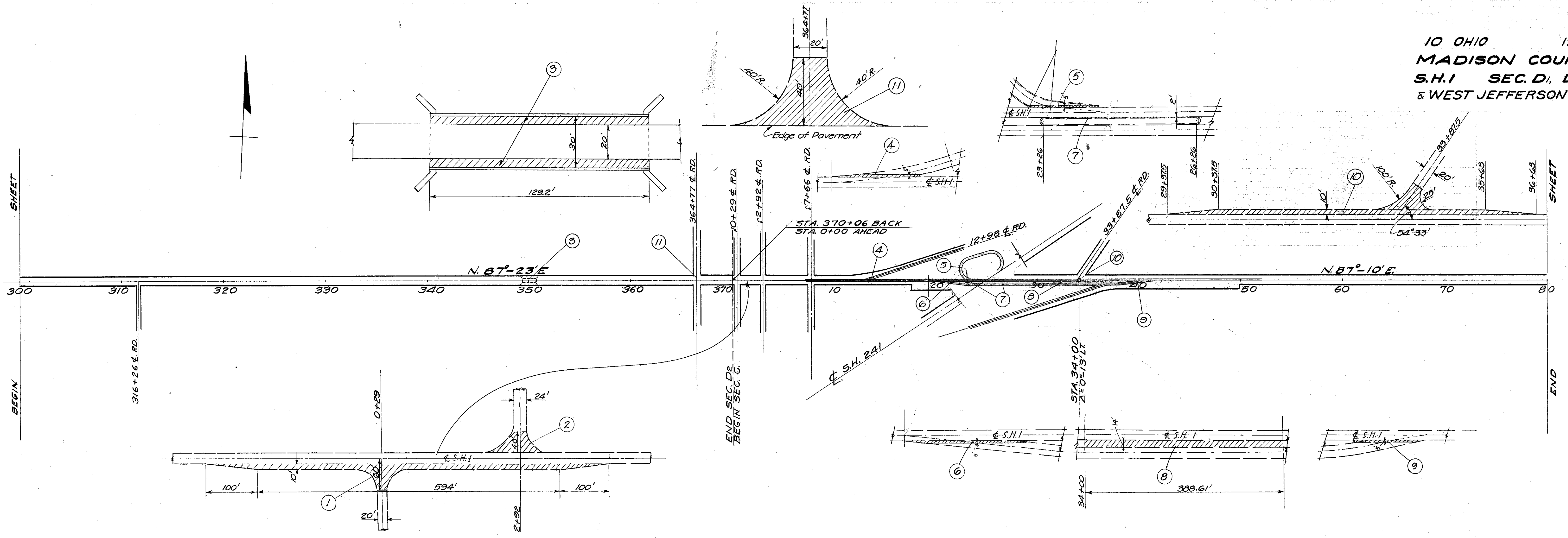

EXTRA PAVEMENT		
REF. NO.	SIDE	1/4" T-35 on 3/4" B-35 SQ. YDS
1	Rt.	947.0
2	Lt.	249.0
3	Bridge	143.6
4	Lt.	93.7
5	Lt.	66.5
6	Rt.	134.3
7	Rt.	66.7
8	Rt.	605.0
9	Rt.	77.0
10	Lt.	923.0
11	Lt.	165.2
TOTAL		3471.0

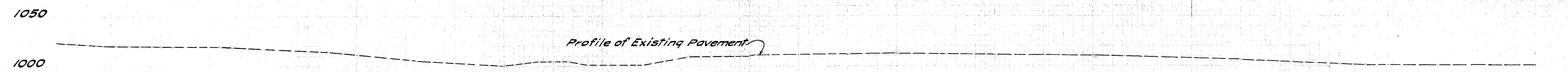

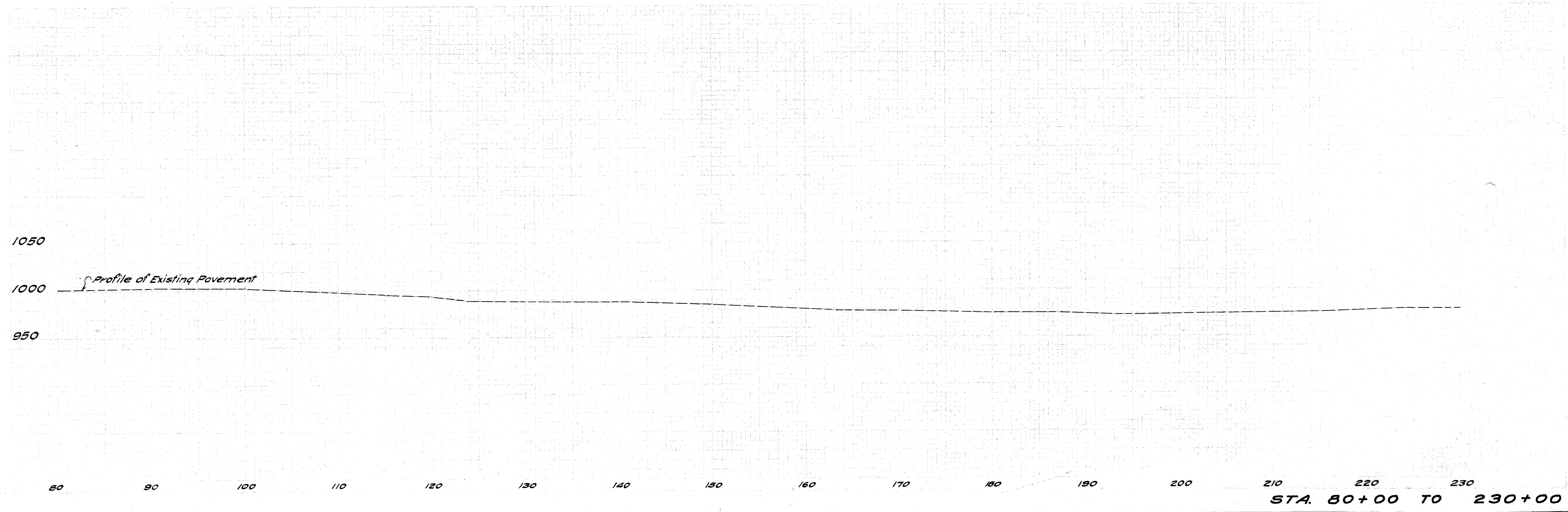
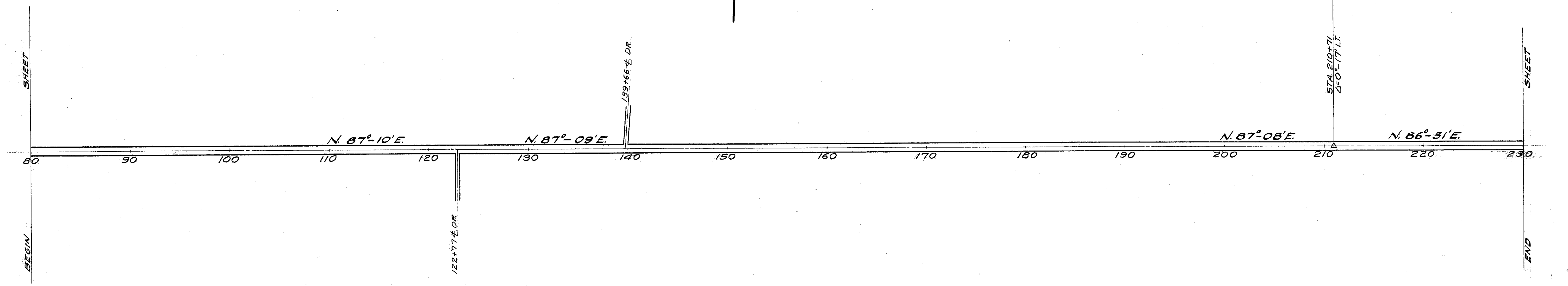
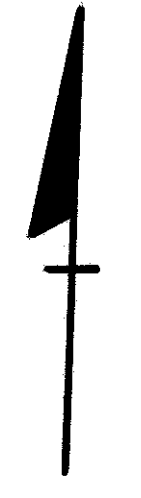

STA. 80+00 TO 230+00

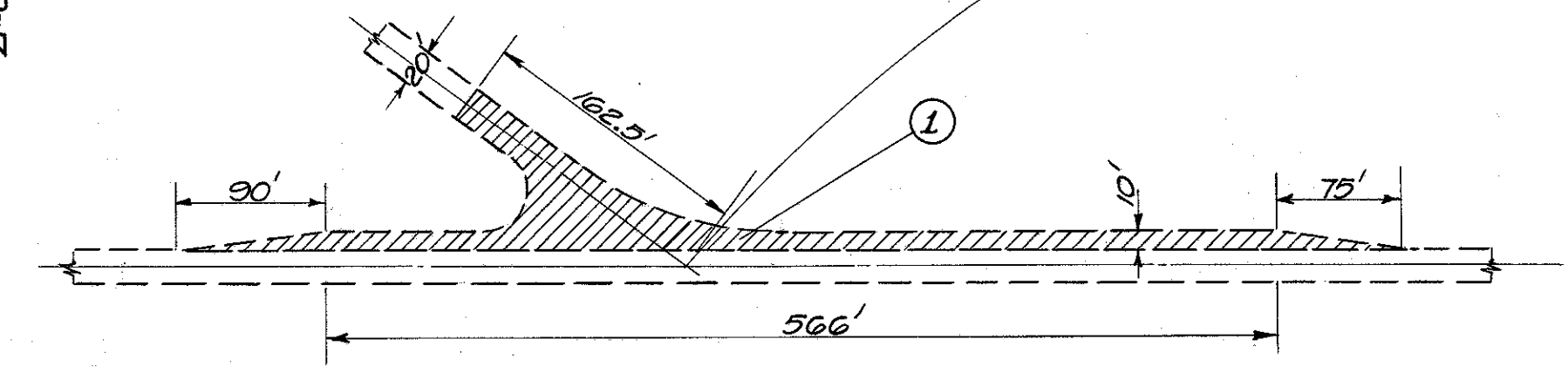
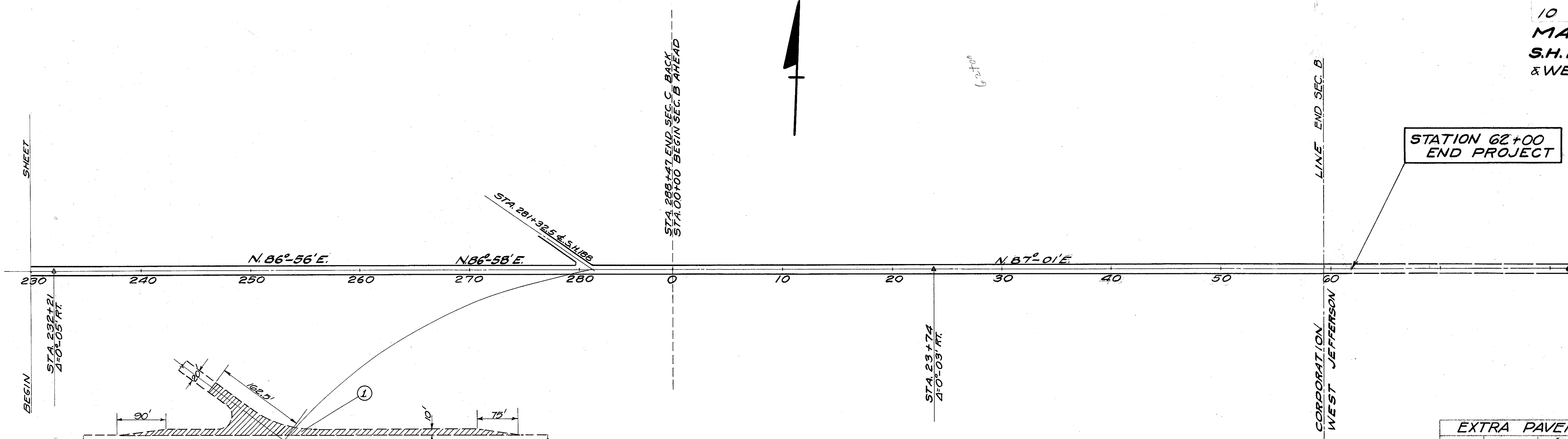

EXTRA PAVEMENT		
REF. No.	SIDE	1/4" 7-35 or 3/4" B-35 Sq. Yds.
1	Lt.	1180
TOTAL		1180

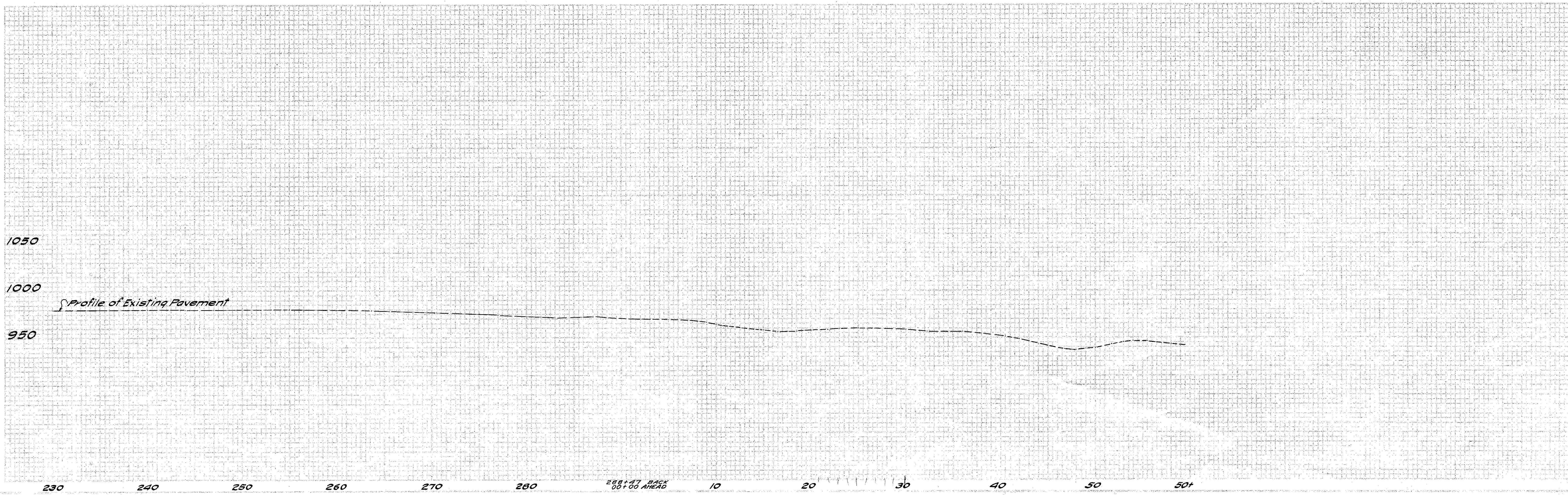

STA. 230+00 TO 288+47 & STA. 00+00 TO 62+00

MADISON COUNTY
S.H. 1 Sec. D1, D2, C, B
& West Jefferson (Pt.)

PAVEMENT CALCULATIONS	
22' WIDTH PAVEMENT	
Station 0+00 to 130+27 (Sec. D1) =	13027.0 Lin. Ft.
Station 0+00 to 62+00 (Sec. B) =	6200.0 Lin. Ft.
Total	19,227.0 Lin. Ft.
20' WIDTH PAVEMENT	
Station 130+27 to 370+06 (Sec. D2) =	23979.0 Lin. Ft.
Station 0+00 to 288+47 (Sec. C) =	28847.0 Lin. Ft.
Total	52,826.0 Lin. Ft.
Net length of Project	72,053.0 Lin. Ft. or 13.646 Miles
T-35 1/4" ASPHALTIC CONCRETE SURFACE COURSE (Type A)	
19,227.0 x 22 x 0.1042 x 1/27 =	1632.44 Cu. Yds.
52,826.0 x 20 x 0.1042 x 1/27 =	4077.38 Cu. Yds.
Add from table "P" 7620.5 x 1.25 ÷ 36 =	264.60 Cu. Yds.
Total	5974.4 Cu. Yds.
B-35 3/4" ASPHALTIC CONCRETE LEVELING COURSE	
19,227.0 x 22 x .0625 x 1/27 =	979.2 Cu. Yds.
52,826.0 x 20 x .0625 x 1/27 =	2445.6 Cu. Yds.
Add from table "P" 7620.5 x 0.75 ÷ 36 =	158.8 Cu. Yds.
Add for crown correction, 13.646 miles @ 200 cu. yds. per mile =	2729.2 Cu. Yds.
Add for Longitudinal correction, 13.646 miles @ 65 cu. yds. per mile =	887.0 Cu. Yds.
Add from Table "P"	43.9 Cu. Yds.
Total	7243.7 Cu. Yds.
I-17 AGGREGATE FOR TRAFFIC BOUND SIDE APPROACHES AND BERMS.	
72,053.0 x 2 x 3 x 0.12 x 1/27 =	1921.4 Cu. Yds.
B-35 ASPHALTIC CONCRETE BASE COURSE (2-3" COURSES) (REPLACEMENT)	
275 x 6 ÷ 36 =	45.8 Cu. Yds.
E-8 REMOVAL AND DISPOSAL OF 9'-7'-9" CONCRETE PAVEMENT	
Estimated	250.0 Sq. Yds.
E-8 REMOVAL AND DISPOSAL OF 1 1/2" BITUMINOUS MACADAM PAVEMENT	
Estimated	25.0 Sq. Yds.
I-19 1/2" INSULATION COURSE	
Estimated	275.0 Sq. Yds.
T-30 BITUMINOUS PRIME COAT	
Sta. 130+27 to 370+06 = 23979' + Sta. 0+00 to 288+47 = 28847' (see sheet No 2)	
23,979' + 28847' = 52,826'; 52,826 x 20 ÷ 9 x 0.10 =	11,739 Gals.
E-10 CUTTING & SEALING OF EXISTING PAVEMENT EDGE	
Estimated	3300 Lin. Ft.

GENERAL SUMMARY			
ITEM	QUANTITY	UNIT	DESCRIPTION
E-8	25	Sq. Yds.	Removal and Disposal of Bituminous Macadam pavement.
E-8	250	Sq. Yds.	Removal and Disposal of Concrete pavement.
I-17	1922	Cu. Yds.	Aggregate for Traffic Bound Side Approaches and Berms.
E-10	3300	Lin. Ft.	Cutting & sealing of existing pavement edge.
T-30	11,739	Gals.	Bituminous Prime Coat Federal Specification 55-A-674 with Amend. 1 Type II including sand cover
T-35	5975	Cu. Yds.	Asphaltic Concrete Surface Course (Type A)
B-35	7244	Cu. Yds.	Asphaltic Concrete Leveling Course
B-35	46	Cu. Yds.	Asphaltic Concrete Base Course
I-19	275	Sq. Yds.	1/2" Insulation Course

EXTRA PAVEMENT "P"			
SHEET No	1/4" T-35 on 3/4" B-35	B-35 Wedge Course	
	SQ. YDS.	CU. YDS.	
3	1253.0		
4	1716.5	43.9	
5	3471.0		
6	0.0	0.0	
7	1180.0		
TOTAL	7620.5	43.9	