

MR 678

Office Use Only	
County or Jurisdiction	NOT
Rte	4
Log Pt	1109
AccCat	11.22

State of Ohio
Department of Transportation
Permit Inspection Certificate

To be completed by District Office

[1] Permittee Name Greater Moraine - B'creek Sewer District Contact _____

Address _____ Phone _____

[2] Permit No. 7-318-07 Date Issued 11-2-07

Work Authorized Sewer extension

To be completed by Inspector

[3] Was work completed? Yes No As authorized? Yes No If No, explain variation(s)

VOID

[4] Is work approved? Yes No If No, explain conditions _____

If work is not approved, advise person in charge at work site, noting his/her name and relationship to permittee and the date and time of the inspection; note any instructions given such person, including work stoppage if warranted. If no one is present at work site, so note.

Date 1/6/11

Signed Spongenech

Title Ptech 2

2/4/08 Not started

9/18/08 NOT STARTED



Ohio Department of Transportation

Central Office • 1980 West Broad Street • Columbus, OH 43223

Ted Strickland, Governor • Jolene M. Motitoris, Director

January 6, 2011



Greater Moraine-Beavercreek Sewer District
1550 Soldiers Home-West Carrollton Rd.
Dayton Ohio 45418

RE: Sanitary sewer extension, Permit #7-378-07, SR 4, Montgomery County

11.04mm

To whom it may concern:

This letter is to inform you that Permit # 7-378-07, to install 640' of 8" sanitary sewer and 2 manholes within State right-of-way, is now voided. Several inspections of the site since issuance of the permit in 2007 has shown there to be no evidence of work performed. This location is along the west side of Germantown Pike between Derby Road and Liscum Drive, noted as Sewer Improvement Area #1 on the plans.

Should you wish to make this installation in the future a new permit request to the Ohio Department of Transportation is necessary and it will be reviewed for compliance with any new policies and standards.

If you have any questions please call me at 937-497-6716.

Respectfully,

Sandra L. Longenecker
Permit Technician 2

C: file

PROJECT No. 572

Office Use Only	
County or Jurisdiction	MOT
Rte	4
Log Pt	11.04
AccCat	11.22

State of Ohio
Department of Transportation
Permit Inspection Certificate

To be completed by District Office

[1] Permittee Name MORaine BEAVERCREEK SEWER DISTRICT contact _____

Address _____ Phone 937-263-2676

[2] Permit No. 7-378-07 Date Issued 11/2/07

Work Authorized _____
INSTALL AN 8" SANITARY SEWER ON SR 4
BETWEEN DERBY & LISCOM.

To be completed by Inspector

[3] Was work completed? ___ Yes ___ No As authorized? ___ Yes ___ No If No, explain variation(s)

_____ VOID _____

[4] Is work approved? ___ Yes ___ No If No, explain conditions _____

If work is not approved, advise person in charge at work site, noting his/her name and relationship to permittee and the date and time of the inspection; note any instructions given such person, including work stoppage if warranted. If no one is present at work site, so note.

Date 1/6/11
Signed [Signature]
Title PTech 2

1/6/11
no work ever done.
VOID



Ohio Department of Transportation

Central Office • 1980 West Broad Street • Columbus, OH 43223

Ted Strickland, Governor • Jolene M. Molitoris, Director

January 6, 2011

Greater Moraine-Beavercreek Sewer District
1550 Soldiers Home-West Carrollton Rd.
Dayton Ohio 45418

RE: Sanitary sewer extension, Permit #7-378-07, SR 4, Montgomery County

To whom it may concern:

This letter is to inform you that Permit # 7-378-07, to install 640' of 8" sanitary sewer and 2 manholes within State right-of-way, is now voided. Several inspections of the site since issuance of the permit in 2007 has shown there to be no evidence of work performed. This location is along the west side of Germantown Pike between Derby Road and Liscum Drive, noted as Sewer Improvement Area #1 on the plans.

Should you wish to make this installation in the future a new permit request to the Ohio Department of Transportation is necessary and it will be reviewed for compliance with any new policies and standards.

If you have any questions please call me at 937-497-6716.

Respectfully,

A handwritten signature in cursive script that reads "S Longenecker".

Sandra L. Longenecker
Permit Technician 2

C: file

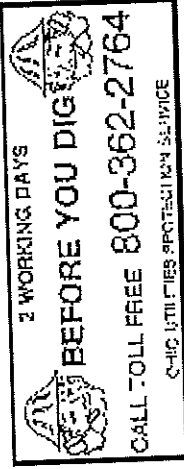

MIR-509
Rev. 5-82

7-378-07

County: Montgomery SR: 4
Section: 11.04 to 11.22

Subject to all of the terms, conditions and restrictions printed or written below, and on the reverse side hereof, permission is hereby granted to

Greater Moraine-Beavercre

1550 Soldiers Home-
W Carr (937) 263-2676

Dayton OH 45418

Dayton OH 45418

All highway use permits are governed by the Ohio Revised Code 5515.01 and 5515.02. All proposed work shall be done as per attached plan, which becomes a part of this permit. Any changes must be approved by the Permit Department prior to work being performed.

Permittee Agent will have a copy of the permit and Ohio Department of Transportation approved, stamped plan on the job. If Permittee is excavating, he is responsible to call "OUPS" at 1-800-362-2764, as well as, all non-OUPS utilities at least 2 days prior to start of work, for location of buried facilities.

Installation, maintenance and/or repair of this installation shall in no way be the responsibility of the State or Federal government. Any damage done by this installation is to be restored to its original condition or better.

Permit holder shall furnish all labor, equipment and materials necessary for this installation. The Permittee will abide by current State and/or Local laws pertaining to storm water pollution and/or erosion control.

The Permittee shall furnish sufficient flagmen and/or signs to protect the traveling public at all times, as per the Ohio Manual of Traffic Control Devices. Through traffic will be maintained at all times.

This permit is not a substitute for satisfying the rights of any other party that may have an interest in the underlying fee. All disturbed earth shall be replaced, compacted, and reshaped to its original cross-section and then re-seed it to the satisfaction of the Director of Transportation or his agent.

No open bore pits or trenches permitted during dark hours without barricades and flashing lights. The State of Ohio or Federal Highway Administration will not participate in the cost of this installation.

Install 640' of 8" sanitary sewer and 2 manholes, as per plan and attached traffic control template.

NOTE: MANHOLES MUST BE FLUSH WITH SURROUNDING GRADE - NO MOUNDING IS PERMITTED.

NOTE: PERMITTEE MUST CALL SANDY LONGENECKER, 937-497-6716, 2 WORKING DAYS PRIOR TO WORK.

This permit is to be in the possession of employees in charge of work at all times. To be shown upon request to any employee of the Department of Transportation.

No work shall be done under this permit until the party or parties to whom it is granted shall have communicated with and received instructions from Sandy Longenecker 937-497-6716

Ohio Department of Transportation, P.O. Box 969, Sidney, Ohio 45365

6/1/2008

This permit shall be void unless the work herein contemplated shall have been completed before

Dated this 2nd day of November . 2007

Roy Dickey
DISTRICT DEPUTY DIRECTOR

FILE COPY

STATE OF OHIO
DEPARTMENT OF TRANSPORTATION
PERMIT



"John Burkhardt "
<john@burkengr.com>

09/24/2007 04:41 PM

Please respond to
"John Burkhardt"
<john@burkengr.com>

To <Sandy.Longenecker@dot.state.oh.us>

cc

bcc

Subject Re: State Route 4 (Germantown Pike) / Montgomery
County, OH

Sandy,

There is no existing easement outside of the R/W. We are creating a new one along the R/W per the Montgomery County Sanitary Engineering Department regs because of where we are installing the sewer. There is also a problem with existing power poles, light poles, and a large sign for the shopping center if we move out of the R/W.

Thanks, John

John T. Burkhardt P.E., P.S.
Burkhardt Engineering Company
195 Byers Road Suite 202
Miamisburg, Ohio 45342
Phone: (937)388-0060
Fax: (937) 388-0062

----- Original Message -----

From: Sandy.Longenecker@dot.state.oh.us

To: [John Burkhardt](mailto:John.Burkhardt)

Sent: Monday, September 24, 2007 3:49 PM

Subject: Re: State Route 4 (Germantown Pike) / Montgomery County, OH

Thanks for the reply & I apologize for forwarding incorrect information. I will check to see what other "activity on SR 4" there would be. I knew of no other.

I had just received the following comment on the plans

* If there is an existing sewer easement, that is to be utilized in lieu of the state right-of-way.

Sandra L. Longenecker
ODOT-District 7
P.O. Box 969
Sidney, OH 45365
VOICE: 937.497.6716
fax: 937.497.9734
email: sandy.longenecker@dot.state.oh.us

MR 505-
App No 7-378-07

State of Ohio
Department of Transportation

SEP 05 2007 See Reverse side for additional requirements

Office Use Only	
County/ Jurisdiction	<u>MbT</u>
Rte <u>4</u>	Log Pt <u>11.04</u>
Acc Cat _____	<u>11.22</u>

[1] This form must be completed by the property owner or agents working for a utility company (if applicable). Application by contractor is unacceptable.

Name GREATER MORRAINE-BEAVERCROCK SEWER DISTRICT
Address 1550 SOLDIERS HOME-W. CARR. ROAD City DAYTON State OH
Zip 45418 Phone (937) 263-2676 Other (Fax, E-mail) FAX 1937-268-3845

[2] Type of Permit requested: _____ Commercial (See other side) _____ Residential _____ Field Utility _____ Drainage
_____ Beautification (See other side) _____ Spraying, trimming, tree removal _____ Other

[3] Briefly describe work to be performed. (Attach plans and see Instructions.)

APPLICATION IS FOR A PERMIT FOR INSTALLATION OF
6 TO LF OF 8" SANITARY SEWER AND TWO MANHOLES
ALONG THE WEST RIGHT-OF-WAY OF STATE ROUTE 4.

Traffic Plan SEE ATTACHED TRANSMITTAL

[4] Location where work is to be performed. Give sufficient detail to locate the site accurately, such as the distance in miles or feet from a mile post or from some geographical feature such as an intersecting highway.

In MONTGOMERY County (along, across) State Route 4, _____ miles or 900 feet
North _____ East _____ West _____ South of LISCUM DRIVE on the North _____ East _____ West South _____ side of the road.
Work to commence on SEPT. 2007 and will require 30 days to complete.

[5] Does the property owner own or have any interests in any adjacent property? Yes _____ No

If yes, please describe. RANCH OWNS ALL THE ADJACENT TRACTS
ON THE WEST SIDE OF S.R. 4

[6] Prior to any excavation in the highway right-of-way, the Ohio Utilities Protection Service (OUPS) must be contacted in accordance with ORC Section 3781.25 to 3781.32. OUPS can be reached at 1-800-362-2764. A call must be made to OGPUPS at 1-800-925-0988.

[7] Open cutting of pavement shall not be permitted unless no reasonable alternate method is available. Written approval of the Ohio Department of Transportation District Office must be obtained.

[8] All work requiring men or vehicles within ODOT right of way shall comply with all applicable requirements of the Ohio Manual of Traffic Control Devices and Item 614 (Maintaining Traffic) of the Construction and Material Specifications, latest editions. Failure to comply with these requirements will be cause for immediate revocation or suspension of the permit until the proper traffic control devices have been provided.

[9] I have received a copy of the policies and regulations pertaining to the permit for which I have applied. If a permit is subsequently issued to me by the Ohio Department of Transportation, I understand that the permit will state the terms and conditions for its use, and I agree to comply with all conditions and regulations stipulated on or attached to the permit. I also understand and agree that failure to comply fully with all conditions and regulations of the permit or any change in the use of the permit inconsistent with its terms and conditions will be considered a violation and cause for suspension, revocation, or annulment of the permit thereby rendering the permit illegal and subject to appropriate Department action, up to an including removal of the installation at the permittee's expense.

SIGN and
PRINT here

JOHN T. BURKHARDT
= [Signature]
Signature of Property Owner or Agent for Owner
Date 8-29-07
Day time Phone 937-388-0060

Office use only	
Date Received _____	
By _____	
Date Accepted _____	
By _____	

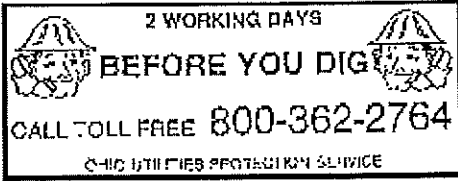

STATE OF OHIO
DEPARTMENT OF TRANSPORTATION
PERMIT

FILE COPY

7-378-07

MR-509
Rev. 5-82

County: Montgomery SR: 4
Section: 11.04 to 11.22

Subject to all of the terms, conditions and restrictions printed or written below, and on the reverse side hereof, permission is hereby granted to

Greater Moraine-Beavercre 1550 Soldiers Home- (937) 263-2676
W Carr
Dayton OH 45418

- All highway use permits are governed by the Ohio Revised Code 5515.01 and 5515.02.
- All proposed work shall be done as per attached plan, which becomes a part of this permit. Any changes must be approved by the Permit Department prior to work being performed.
- Permittee/Agent will have a copy of the permit and Ohio Department of Transportation approved, stamped plan on the job.
- If Permittee is excavating, he is responsible to call "OUPS" at 1-800-362-2764, as well as, all non-OUPS utilities at least 2 days prior to start of work, for location of buried facilities.
- Installation, maintenance and/or repair of this installation shall in no way be the responsibility of the State or Federal government.
- Any damage done by this installation is to be restored to its original condition or better.
- Permit holder shall furnish all labor, equipment and materials necessary for this installation.
- The Permittee will abide by current State and/or Local laws pertaining to storm water pollution and/or erosion control.
- Permit holder shall furnish sufficient flagmen and/or signs to protect the traveling public at all times, as per the Ohio Manual of Traffic Control Devices. Through traffic will be maintained at all times.
- This permit is not a substitute for satisfying the rights of any other party that may have an interest in the underlying fee.
- All disturbed earth shall be replaced, compacted, and reshaped to its original cross-section and then re-seed it to the satisfaction of the Director of Transportation or his agent.
- No open bore pits or trenches permitted during dark hours without barricades and flashing lights.
- The State of Ohio or Federal Highway Administration will not participate in the cost of this installation.
- Install 640' of 8" sanitary sewer and 2 manholes, as per plan and attached traffic control template.
- NOTE: MANHOLES MUST BE FLUSH WITH SURROUNDING GRADE - NO MOUNDING IS PERMITTED.
- NOTE: PERMITTEE MUST CALL SANDY LONGENECKER, 937-497-6716, 2 WORKING DAYS PRIOR TO WORK.

This permit is to be in the possession of employees in charge of work at all times. To be shown upon request to any employee of the Department of Transportation.

No work shall be done under this permit until the party or parties to whom it is granted shall have communicated with and received instructions from Sandy Longenecker 937-497-6716

Ohio Department of Transportation, P.O. Box 969, Sidney, Ohio 45365

This permit shall be void unless the work herein contemplated shall have been completed before 6/1/2008

Dated this 2nd day of November, 2007

Ray Dickey DDD/8
DISTRICT DEPUTY DIRECTOR



"John Burkhardt "
<john@burkengr.com>

09/24/2007 04:41 PM

Please respond to
"John Burkhardt"
<john@burkengr.com>

To <Sandy.Longenecker@dot.state.oh.us>

cc

bcc

Subject Re: State Route 4 (Germantown Pike) / Montgomery
County, OH

Sandy,

There is no existing easement outside of the R/W. We are creating a new one along the R/W per the Montgomery County Sanitary Engineering Department regs because of where we are installing the sewer. There is also a problem with existing power poles , light poles, and a large sign for the shopping center if we move out of the R/W.

Thanks, John

John T. Burkhardt P.E. , P.S.
Burkhardt Engineering Company
195 Byers Road Suite 202
Miamisburg, Ohio 45342
Phone: (937)388-0060
Fax: (937) 388-0062

----- Original Message -----

From: Sandy.Longenecker@dot.state.oh.us

To: [John Burkhardt](mailto:John.Burkhardt@burkengr.com)

Sent: Monday, September 24, 2007 3:49 PM

Subject: Re: State Route 4 (Germantown Pike) / Montgomery County, OH

Thanks for the reply & I apologize for forwarding incorrect information. I will check to see what other "activity on SR 4" there would be. I knew of no other.

I had just received the following comment on the plans

* If there is an existing sewer easement, that is to be utilized in lieu of the state right-of-way.

Sandra L. Longenecker
ODOT-District 7
P.O. Box 969
Sidney, OH 45365
VOICE: 937.497.6716
fax: 937.497.9734
email: sandy.longenecker@dot.state.oh.us

7-378-07

SEP 05 2007

See Reverse side for additional requirements

Office Use Only	
County/ Jurisdiction	MbT
Rte	4
Log Pt	11.04
Acc Cat	11.22

[1] This form must be completed by the property owner or agents working for a utility company (if applicable). Application by contractor is unacceptable.

Name GREATER MORAINES - BEAVERCREEK SEWER DISTRICT
 Address 1550 SOLDIERS HOME - W. CARR. ROAD City DAYTON State OH
 Zip 45418 Phone (937) 263-2676 Other (Fax, E-mail) FAX 937-268-3845

[2] Type of Permit requested: Commercial (See other side) Residential Field Utility Drainage
 Beautification (See other side) Spraying, trimming, tree removal Other

[3] Briefly describe work to be performed. (Attach plans and see Instructions.)

APPLICATION IS FOR A PERMIT FOR INSTALLATION OF
640 LF OF 8" SANITARY SEWER AND TWO MANHOLES
ALONG THE WEST RIGHT-OF-WAY OF STATE ROUTE 4.
 Traffic Plan SEE ATTACHED TRANSMITTAL

[4] Location where work is to be performed. Give sufficient detail to locate the site accurately, such as the distance in miles or feet from a mile post or from some geographical feature such as an intersecting highway.

In MONTGOMERY County (along, across) State Route 4, 900 miles or 900 feet
 North East West South of LISCOM DRIVE on the North East West South side of the road.
 Work to commence on SEPT. 2007 and will require 30 days to complete.

[5] Does the property owner own or have any interests in any adjacent property? Yes No

If yes, please describe. RANCH OWNS ALL THE ADJACENT TRACTS
ON THE WEST SIDE OF S.R. 4

[6] Prior to any excavation in the highway right-of-way, the Ohio Utilities Protection Service (OUPS) must be contacted in accordance with ORC Section 3781.25 to 3781.32. OUPS can be reached at 1-800-362-2764. A call must be made to OGPUPS at 1-800-925-0988.

[7] Open cutting of pavement shall not be permitted unless no reasonable alternate method is available. Written approval of the Ohio Department of Transportation District Office must be obtained.

[8] All work requiring men or vehicles within ODOT right of way shall comply with all applicable requirements of the Ohio Manual of Traffic Control Devices and Item 614 (Maintaining Traffic) of the Construction and Material Specifications, latest editions. Failure to comply with these requirements will be cause for immediate revocation or suspension of the permit until the proper traffic control devices have been provided.

[9] I have received a copy of the policies and regulations pertaining to the permit for which I have applied. If a permit is subsequently issued to me by the Ohio Department of Transportation, I understand that the permit will state the terms and conditions for its use, and I agree to comply with all conditions and regulations stipulated on or attached to the permit. I also understand and agree that failure to comply fully with all conditions and regulations of the permit or any change in the use of the permit inconsistent with its terms and conditions will be considered a violation and cause for suspension, revocation, or annulment of the permit thereby rendering the permit illegal and subject to appropriate Department action, up to an including removal of the installation at the permittee's expense.

SIGN and
PRINT here

JOHN T. BURKHARDT
 = [Signature]
 Signature of Property Owner or Agent for Owner
 Date 8-29-07
 Day time Phone 937-388-0060

Office use only	
Date Received	_____
By	_____
Date Accepted	_____
By	_____

APPROVALS: *[Signature]* 4/26/07
MONTGOMERY COUNTY SANITARY ENGINEER DATE

MONTGOMERY COUNTY ENGINEER DATE

CITY OF DAYTON CITY ENGINEER DATE

STATE OF OHIO E.P.A. (SEWER) Submitted Approved

MAINTENANCE OF TRAFFIC NOTE:
ALL EQUIPMENT AND MATERIALS REQUIRED TO INSTALL PROPOSED SEWER ARE TO BE STAGED ON THE RAUCH PROPERTY, OUTSIDE THE RIGHT-OF-WAY. DURING CONSTRUCTION, CONTRACTOR WILL BE RESPONSIBLE TO MAINTAIN DRIVEWAY ACCESS AND ENSURE TRAFFIC ALONG GERMANTOWN PIKE IS NOT DISTURBED.

DRIVEWAY NOTE:
SAW-CUT THROUGH EXISTING PAVEMENT PRIOR TO EXCAVATION. REPLACE EXISTING PAVEMENT IN KIND. SEE DETAIL PG. 2 OF 2 FOR TRENCH AND PIPE BEDDING DETAILS. DRIVEWAY ACCESS TO BE MAINTAINED THROUGH OUT CONSTRUCTION.

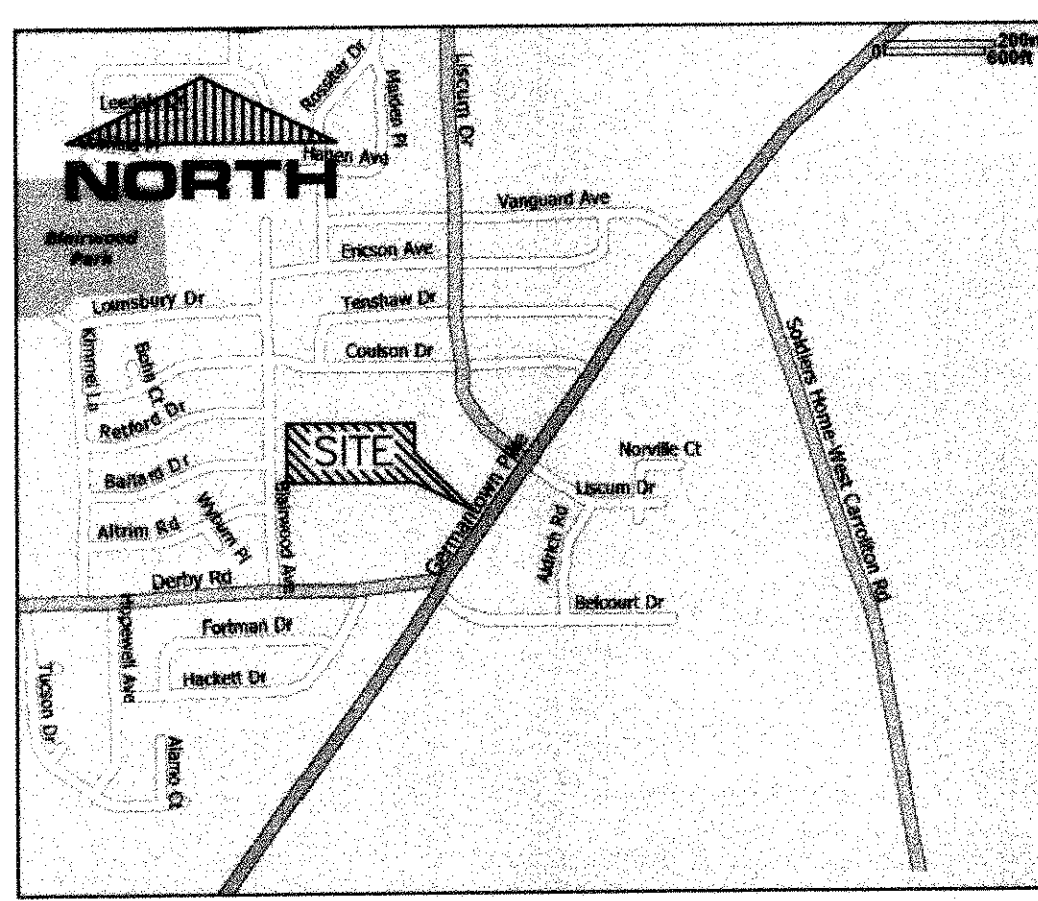
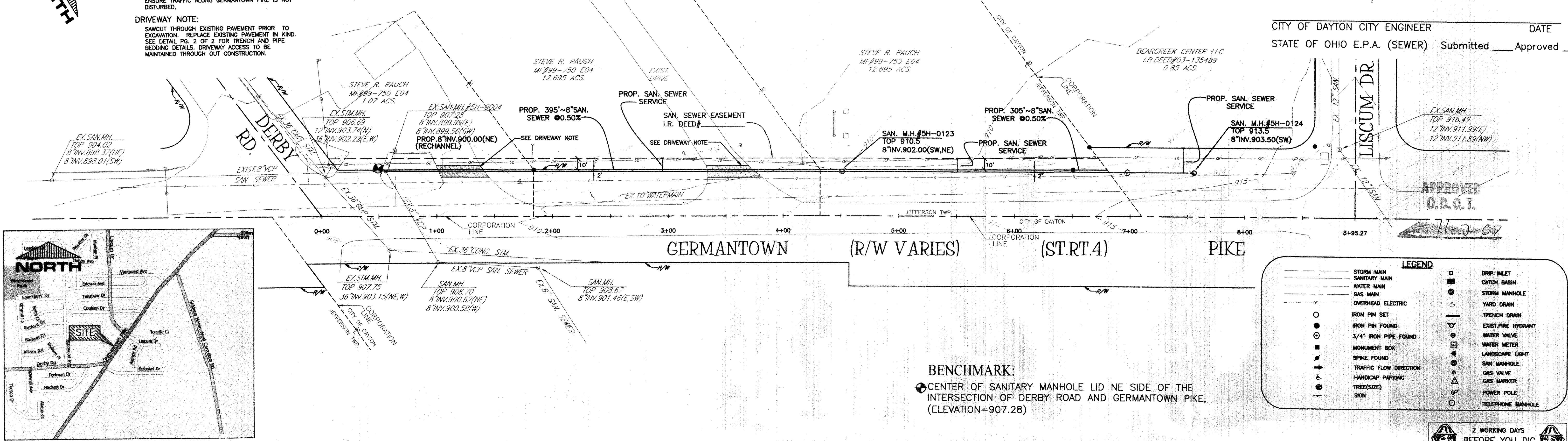

APPROVED
O.D.O.I.
11-2-07

LEGEND

	STORM MAIN		DRIP INLET
	SANITARY MAIN		CATCH BASIN
	WATER MAIN		STORM MANHOLE
	GAS MAIN		YARD DRAIN
	OVERHEAD ELECTRIC		TRENCH DRAIN
	IRON PIN SET		EXIST. FIRE HYDRANT
	IRON PIN FOUND		WATER VALVE
	3/4" IRON PIPE FOUND		WATER METER
	MONUMENT BOX		LANDSCAPE LIGHT
	SPIKE FOUND		SAN MANHOLE
	TRAFFIC FLOW DIRECTION		GAS VALVE
	HANDICAP PARKING		GAS MARKER
	TREE(SIZE)		POWER POLE
	SIGN		TELEPHONE MANHOLE

BENCHMARK:
CENTER OF SANITARY MANHOLE LID NE SIDE OF THE INTERSECTION OF DERBY ROAD AND GERMANTOWN PIKE. (ELEVATION=907.28)

2 WORKING DAYS BEFORE YOU DIG
CALL TOLL FREE 800-362-2764
OHIO UTILITIES PROTECTION SERVICE

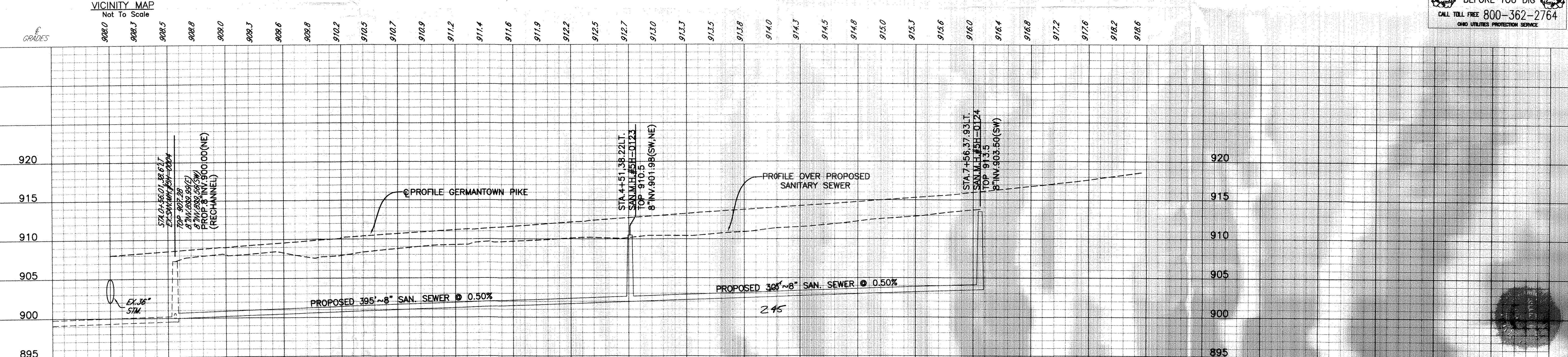

SEWER IMPROVEMENT AREA #1

GREATER MORAINÉ-BEAVERCREEK SEWER DISTRICT
BEARCREEK SUB-DISTRICT
SECTION 12, TOWN 3, RANGE 5 EAST

Plan and Profile of Improvements for:
GERMANTOWN PIKE
SANITARY SEWER EXTENSION

Scale : 1"=40' 1"=6' Date : 4/17/07

BURKHARDT ENGINEERING COMPANY

195 BYERS ROAD SUITE 202
MARIETTA, OHIO 45342
PHONE: (937) 388-0900 FAX: (937) 388-0862

Approved *[Signature]* Engineer

Sheet No. 1 of 2

SANITARY SEWER AND WATERMAIN NOTES:

All sanitary sewers and/or water lines and appurtenances shall be constructed according to Montgomery County Sanitary Engineering Specifications, dated February 6, 2001, (effective March 31, 2001), or latest revision thereof.

No additions, deletions or revisions to the sanitary sewer and/or water facilities are to be made without prior written approval by the Montgomery County Sanitary Engineer.

No construction shall commence until Montgomery County Sanitary Department permits have been issued, and two (2) working days notice has been given to the Inspection Division (781-2500).

All utility trenches within the existing or proposed right-of-way or under paved areas shall be backfilled with compacted granular material conforming to ODOT 310 in accordance with the Montgomery County Sanitary Engineering Department Specifications.

No sanitary sewer and/or water main line permits shall be issued until permits to work in the public road right of way (street cut permits) or the State of Ohio Highway permit has been obtained (as applicable).

All existing underground utilities are shown in their approximate locations according to the best available information. The contractor shall notify the Montgomery County Sanitary Engineering Department at 1-800-362-2764 and all other Utility Companies 48 hours prior to construction to obtain field locations of said existing underground utilities.

No service connections shall be made to the water main until the main line has been inspected, tested, disinfected and released for taps and on-premise.

Roof drains, foundation drains or other clean water connections to the sanitary sewer system are prohibited.

Sanitary manholes shall be precast conforming to ASTM C-478, or monolithic constructed of Class "A" 4200 psi concrete. Manholes shall be vacuum tested. Joints between precast sanitary manhole sections shall conform to ASTM C-443. Chimney seals shall be provided between the casting and cone section. Eccentric cones shall be used.

Sanitary manhole bottoms to be channeled.

Sanitary sewer pipe and fittings shall be PVC or extra strength vitrified clay. PVC pipe and fittings shall meet and/or exceed all the requirements of ASTM-D 3034, SDR35 and have a minimum pipe stiffness of 46 psi. Extra strength vitrified clay pipe and fittings shall meet and/or exceed all the requirements of ASTM C-700. The contractor may have his choice of these materials (prior to issuance of mainline permits) unless otherwise specified in the plans and specifications.

Sanitary sewer pipe joints shall conform as follows: PVC pipe joints shall conform to ASTM-D 3212 (elastomerically gasketed). Clay pipe joints shall conform to ASTM C-425, O-Ring Gasket

The contractor shall not make any physical connection to the existing sanitary sewer until the remaining sewer, excluding the first span has been inspected, tested and released.

The infiltration/exfiltration test for the sanitary sewer shall not exceed 50 gal/in.-dia./mi./day.

The water main installation will be inspected by the Montgomery County Sanitary Engineering Department and may be inspected by the City of Dayton, if required.

Water mains, bends and fitting shall be ductile cast iron pipe and conform to ANSI-A21.51 (AWWA C-151), Class 51. All water mains shall be polywrapped with a 12 gauge tracer wire placed above the pipe.

Water mains shall have 4"-6" minimum cover.

Only Montgomery County Sanitary Engineering Department personnel shall operate main line water valves.

Fire hydrants (closest point) shall be located 2' from and within 5' of the curb or edge of pavement and 4" opening to face the street.

Water lines crossing any and all sewers shall have a minimum vertical separation of 18" between the outsides of the water main pipe and the sewer pipe. One full length of water main pipe shall be centered at the point of crossing such that both joints will be equidistant and as far from the sewer as possible. If water crosses below sanitary sewers, the sewer must be water main material for that span.

All gate valves are to be located at tees or crosses with a one foot, (1") maximum nipple between tee or cross and valve. All plugs are to be connected to valves except where shown on plans.

Any construction of pre-stressed or connection to prestressed water mains will require a meeting with Montgomery County Sanitary Engineering Department before ordering the pipe for the project.

All fire hydrants and/or valves noted to be relocated shall be inspected prior to being placed back into service. Only fire hydrants meeting the current specifications will be placed back into service. All valves that are not restrained or anchored shall be replaced.

All water services and sanitary services noted to be abandoned shall be abandoned at the main.

* Last update -2-14-03

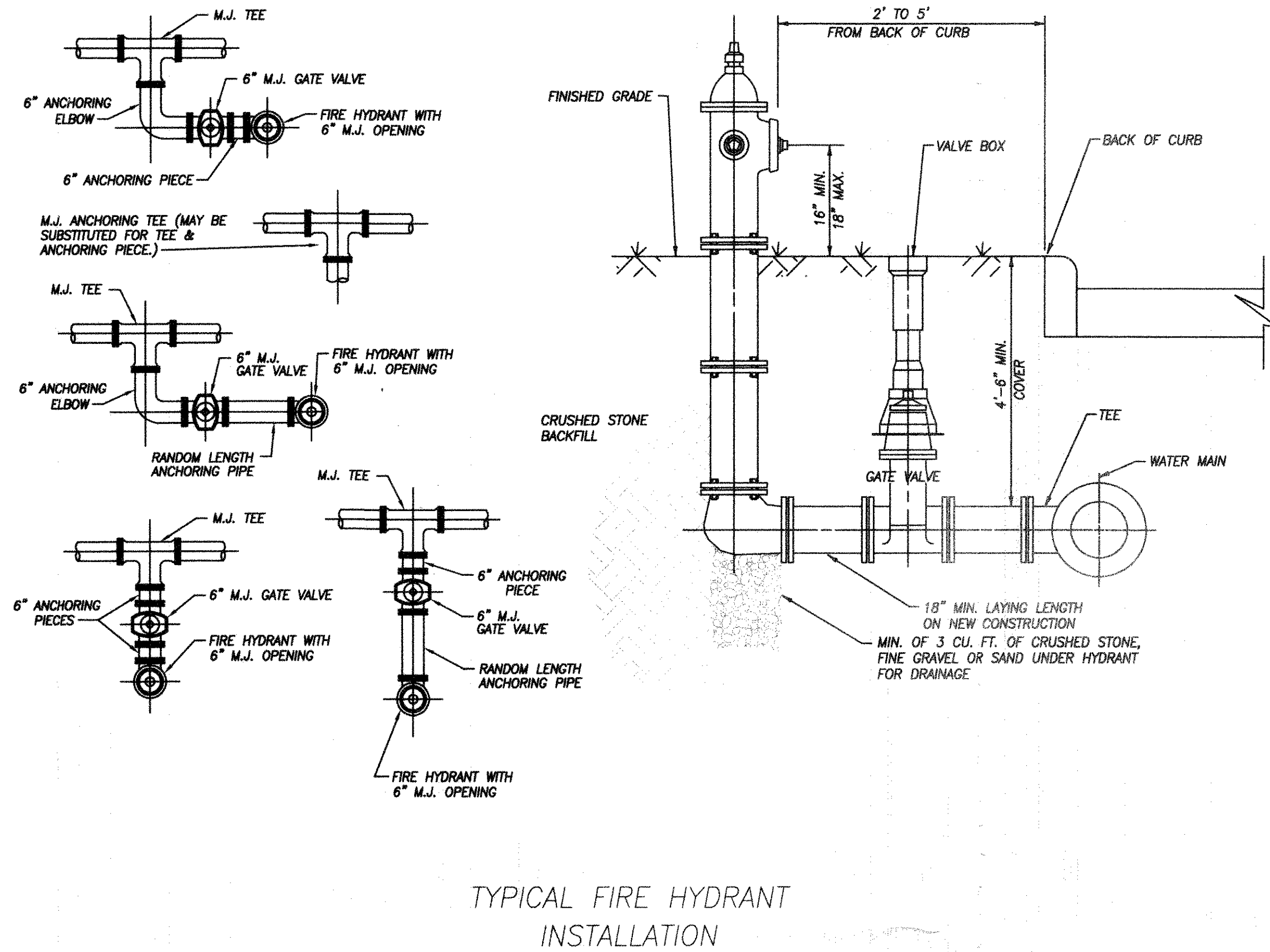

TYPICAL FIRE HYDRANT INSTALLATION

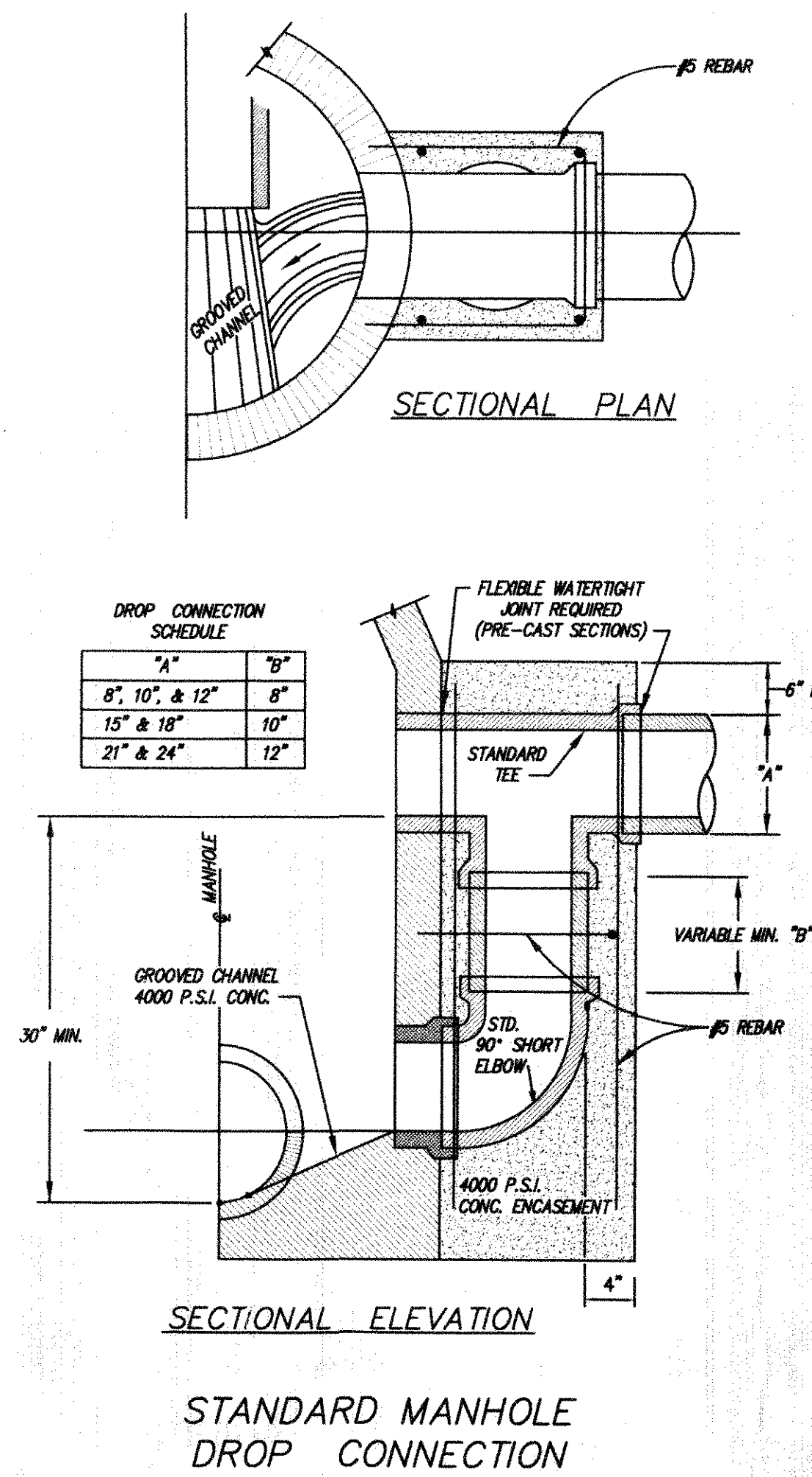

STANDARD MANHOLE DROP CONNECTION

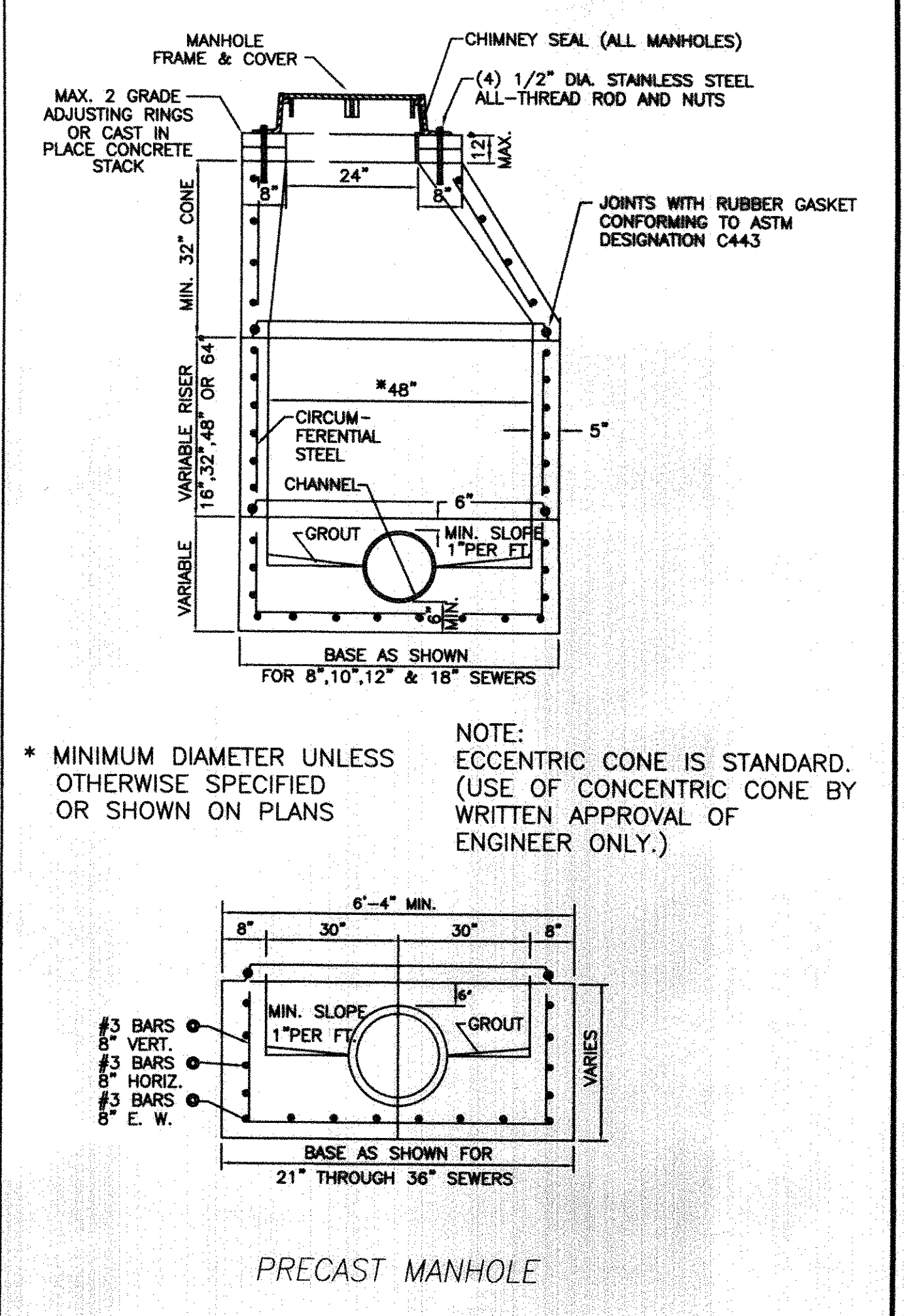

PRECAST MANHOLE

NOTE: ALL RESTORATION MUST COMPLY WITH THE REQUIREMENTS OF THE LOCAL JURISDICTION

TURF (SEED OR SOD AS SPECIFIED OR SHOWN ON THE DRAWINGS)

EXCAVATED MATERIAL BACKFILL AND COMPACT AS REQUIRED BY SANITARY ENGINEERING SPECIFICATIONS (12" LIFTS)

FOR DUCTILE IRON PIPE PROVIDE GRAVEL BACKFILL FROM SPRING LINE TO 6" ABOVE TOP OF PIPE ODOT (1995) ITEM 310.02

PIPE BEDDING (ODOT TABLE 703-1 SIZE No. 57)

COMPACTED GRAVEL BACKFILL (12" LIFTS) ODOT (1995) ITEM 310.02

SAWCUT AND SEAL EXISTING PAVED AREA

INITIAL TRENCH OPENING

TOPSOIL

OUTSIDE R/W

INSIDE R/W

PAVED AREA

6"

18"

12"

O.D. + 8" MIN.

O.D. + 16" MAX.

O.D. + 12" MIN. (IN ROCK)

O.D. + 16" MAX. (IN ROCK)

* 6" OR PIPE O.D. (INCHES) WHICHEVER IS LARGER

RIGID PIPE = DUCTILE IRON, CONCRETE PRESSURE PIPE, ** PVC COMPOSITE (TRUSS), VITRIFIED CLAY PIPE, OR REINFORCED CONCRETE PIPE

FOR RIGID PIPE **

BEDDING DETAILS

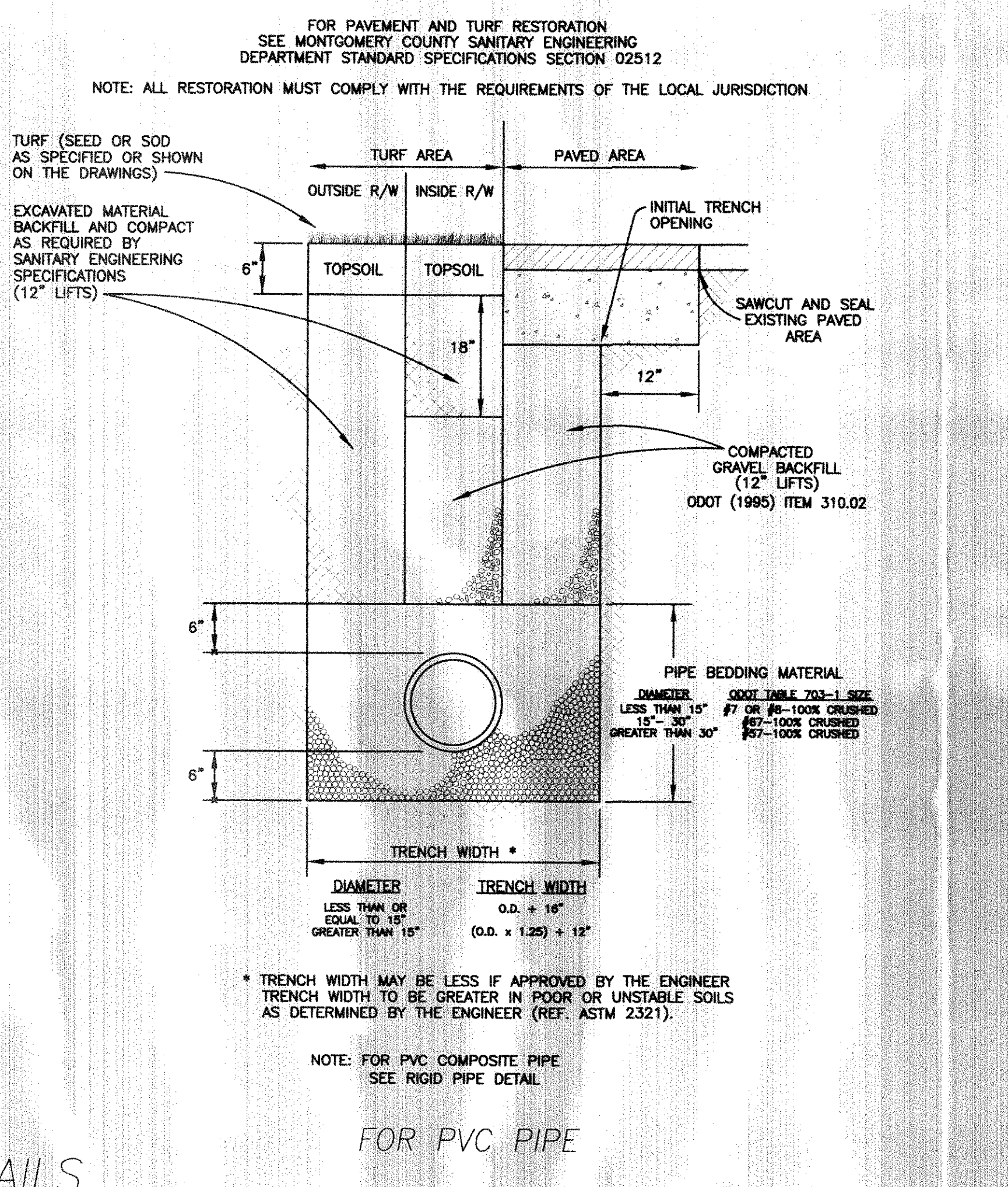

FOR PVC PIPE

NOTE: ALL RESTORATION MUST COMPLY WITH THE REQUIREMENTS OF THE LOCAL JURISDICTION

TURF (SEED OR SOD AS SPECIFIED OR SHOWN ON THE DRAWINGS)

EXCAVATED MATERIAL BACKFILL AND COMPACT AS REQUIRED BY SANITARY ENGINEERING SPECIFICATIONS (12" LIFTS)

INITIAL TRENCH OPENING

SAWCUT AND SEAL EXISTING PAVED AREA

COMPACTED GRAVEL BACKFILL (12" LIFTS) ODOT (1995) ITEM 310.02

PIPE BEDDING MATERIAL ODOT TABLE 703-1 SIZE LESS THAN 15" #7 OR #8-100% CRUSHED 15" - 30" #67-100% CRUSHED GREATER THAN 30" #57-100% CRUSHED

TRENCH WIDTH *

DIAMETER TRENCH WIDTH O.D. + 16" LESS THAN OR EQUAL TO 15" (O.D. x 1.25) + 12"

* TRENCH WIDTH MAY BE LESS IF APPROVED BY THE ENGINEER TRENCH WIDTH TO BE GREATER IN POOR OR UNSTABLE SOILS AS DETERMINED BY THE ENGINEER (REF. ASTM 2321).

NOTE: FOR PVC COMPOSITE PIPE SEE RIGID PIPE DETAIL

°	4"	6"	8"	10"	12"	16"	20"	24"	48"
11 1/4°	3'	5'	6'	8'	9'	12'	15'	18'	36'
22 1/2°	7'	10'	13'	16'	19'	25'	31'	37'	72'
45°	14'	20'	27'	33'	39'	51'	64'	76'	150'
90°	34'	49'	64'	79'	94'	124'	154'	184'	362'

TABLE FOR "L" (IN FEET) REQUIRED LENGTH OF RESTRAINED JOINTS

"D" - DIAMETER OF PIPE

"E" - DEGREE OF DEFLECTION

PRESSURE = 150 PSI

SAFETY FACTOR = 1.33

SOIL DESIGNATION = CLAY 1

DEPTH OF COVER = 4.5 FEET

LAYING CONDITIONS = TYPE 4 BEDDING

* THE LENGTHS WERE TAKEN FROM DIPRA CALCULATIONS FOR PIPE WITH POLYWRAP

** FOR MOST CRITICAL REQ. - VERTICAL BEND DOWN

JOINT RESTRAINT FOR FITTINGS WITH POLYWRAP ENCASEMENT

SEWER IMPROVEMENT AREA #1
GREATER MORAINÉ-BEAVERCREEK SEWER DISTRICT
BEARCREEK SUB-DISTRICT
SECTION 12, TOWN 3, RANGE 5 EAST
GERMANTOWN PIKE
SANITARY SEWER EXTENSION

Scale : 1"=40' 1"=6'

Date : 4/17/07

BURKHARDT ENGINEERING COMPANY

196 BYERS ROAD SUITE 202 MEAMISBURG, OHIO 45342 PHONE:(937)388-0860 FAX:(937)388-0862

Approved: [Signature] Engineer

Sheet No. 2 of 2

BASE DWG: 572base PROJ. NO. 572 ACAD FILE: pp2