

SAP ORDER # : _____

AES Ohio Staking Sheet

LC WR # : _____



STAKEOUT WO # : **10167575**

DESIGN TECH : **WARD, WILLIAM B.** PHONE : **937-554-9063**

DESIGN DATE : _____ Page : **1 of 7**

DESCRIPTION : **Convert 3PH OH/ UG, Relocate OH / bridge**

CUSTOMER NAME : ***P-ODOT-7 (115388)**

ADDRESS : **1587 US-68**

TWP / CITY : **Xenia** ZIP : **45385**

LOCATION : **0241 - Xenia Twp, Greene - OH29202410**

SUBDIVISION : **GRE-68-12.65**

TRENCHING PARTY : _____

JOINT TRENCH : **No**

GRID : **G34-14-C4**

CIRCUIT : **GB1202** TAPS : **.12 KV (100%)**

PHASE : **T**

UPLINE FUSE : **C9785** SIZE : **140K**

STATION	POLE NO.	POLE H/C	PRI. SPAN	PRIMARY		TRANSFORMERS	GROUND	GUY		ANCHOR	SECONDARY AND SERVICE UNITS	SEC/SERV SPAN	SECONDARY/SERVICE WIRE	MISCELLANEOUS UNITS	REMARKS
				UNITS	WIRE			UNIT	LEAD						
Sta 1	120642	45-4												(2)100K (R/M) (2)25K (I/S)	Re-fuse A3832, A and B from 100K to 25K after load is transferred.
Sta 2 (I/S)	537317 (I/S)	45-2 (I/S)		03-410 Aptg DDE (I/S) Slack PDE (I/S)				02-080 3/8" PDG (I/S) 35 (I/S)	35 (I/S)	Twin 8" ANC (I/S) Shared Twin 8" ANC (I/S)	(3)04-010 IB (I/S) (3)04-010 S-DE (I/S)			(3)12-032 Jumper 4/0 (I/S) (2)12-032 Jumper 1/0 (I/S) (3)08-120 C/O TF (I/S) (3)40K (I/S)	Backfill pole w/ gravel 116' N of Sta. 1, Install Relocated Cap Bank, Guy. 09-055 Cap Bank

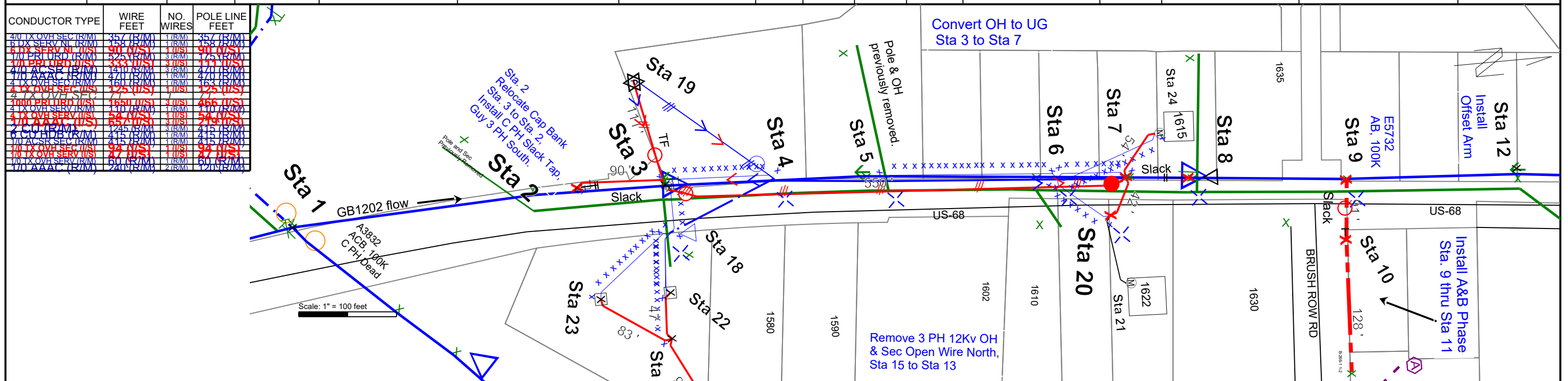

SAP ORDER # : _____

AES Ohio Staking Sheet

LC WR # : _____

	STAKEOUT WO # : 10167575	CUSTOMER NAME : *P-ODOT-7 (115388)	SUBDIVISION : GRE-68-12.65	GRID : G34-14-C4
	DESIGN TECH : WARD, WILLIAM B. PHONE : 937-554-9063	ADDRESS : 1587 US-68	TRENCHING PARTY : _____	CIRCUIT : GB1202 TAPS : 12 KV (100%)
	DESIGN DATE : _____ Page : 2 of 7	TWP / CITY : Xenia ZIP : 45385	JOINT TRENCH : No	PHASE : T
	DESCRIPTION : Convert 3PH OH/ UG, Relocate OH / bridge	LOCATION : 0241 - Xenia Twp, Greene - OH29202410	UPLINE FUSE : C9785 SIZE : 140K	

STATION	POLE NO.	POLE H/C	PRI. SPAN	PRIMARY		TRANSFORMERS	GROUND	GUY		ANCHOR	SECONDARY AND SERVICE UNITS	SEC/SERV SPAN	SECONDARY/SERVICE WIRE	MISCELLANEOUS UNITS	REMARKS
				UNITS	WIRE			UNIT	LEAD						
Sta 3	344730	45-2		03-470 3ph D 9' X-A (R/M)							Tie In (R/M)	111 (R/M)	4/0 TX OVH SEC (R/M)	09-055 Cap Bank	Relocate Cap Bank
				03-520 D9'X-ADE 1200 (I/S)							04-010 S-DE (I/S)	51 (R/M)	6 DX SERV NL (R/M)	(3)08-120 C/O BL (I/S)	One pole south to
											04-010 S-DE (R/M)	90 (I/S)	6 DX SERV NL (I/S)	(3)15K (I/S)	Sta. 2, Install (2)
														(3)08-120 C/O BL (I/S)	3PH Risers.
														(3)80K (I/S)	
														(3)08-120 C/O TF (R/M)	
														(3)40K (R/M)	
														STA.RISER1000-3PH 37 (I/S)	
														RISER1/0-3PH 37-240 (I/S)	
														(3)U-guard 2" (R/M)	
														BackPlate 2" (R/M)	
														(3)U-guard 5" (I/S)	
														BackPlate 5" (I/S)	
														BackPlate 3" (I/S)	
														(3)U-guard 3" (I/S)	
Sta 19	150Kva Xfmr		175 (R/M)	Hand Dig (I/S)	(3)1/0 PRI URD (R/M)	*150 Pdmt 120/208 3p 0 ABCØ								(3)ELBOW1/0 33-150 (R/M)	Existing 3PH PdMt
			111 (I/S)		(3)1/0 PRI URD (I/S)									(3)ELBOW1/0 33-150 (I/S)	

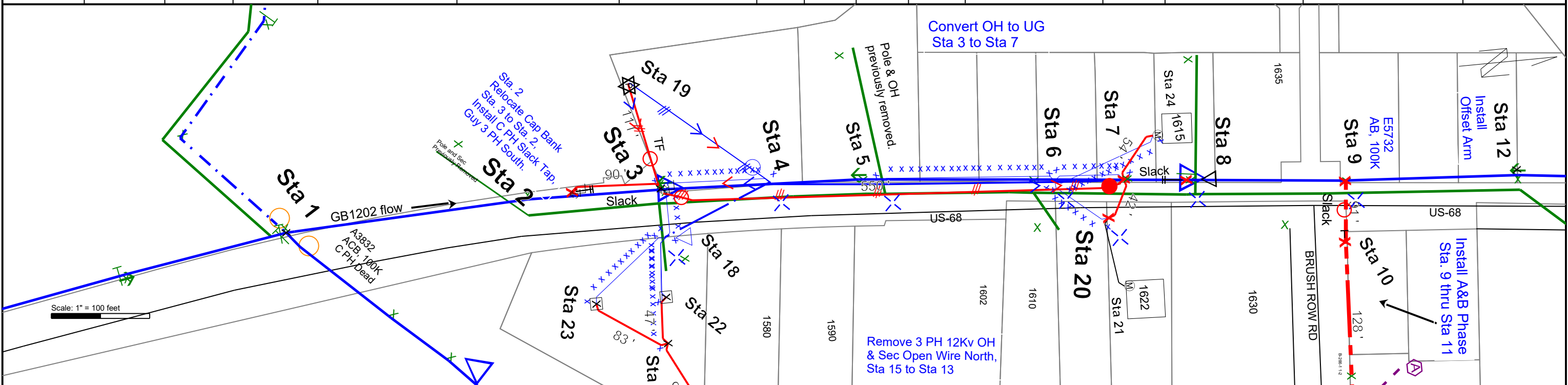

SAP ORDER # : _____

AES Ohio Staking Sheet

LC WR # : _____

	STAKEOUT WO # : 10167575 DESIGN TECH : WARD, WILLIAM B. PHONE : 937-554-9063 DESIGN DATE : _____ Page : 3 of 7 DESCRIPTION : Convert 3PH OH/ UG, Relocate OH / bridge	CUSTOMER NAME : *P-ODOT-7 (115388) ADDRESS : 1587 US-68 TWP / CITY : Xenia ZIP : 45385 LOCATION : 0241 - Xenia Twp, Greene - OH29202410	SUBDIVISION : GRE-68-12.65 TRENCHING PARTY : _____ JOINT TRENCH : No	GRID : G34-14-C4 CIRCUIT : GB1202 TAPS : 12 KV (100%) PHASE : T UPLINE FUSE : C9785 SIZE : 140K	
--	---	---	--	--	--

STATION	POLE NO.	POLE H/C	PRI. SPAN	PRIMARY		TRANSFORMERS	GROUND	GUY		ANCHOR	SECONDARY AND SERVICE UNITS	SEC/SERV SPAN	SECONDARY/SERVICE WIRE	MISCELLANEOUS UNITS	REMARKS
				UNITS	WIRE			UNIT	LEAD						
Sta 4 (R/M)	125092 (R/M)	50-2 (R/M)	111 (R/M)	03-440 3ph 9' X-A (R/M)	(3)4/0 ACSR-Pri 1/0 AAAC-Neu (R/M)						04-010 IB (R/M)			(3)08-120 C/O BL (R/M)	Remove Pole
				Slack PDE (R/M)							Tie In (R/M)			(3)15K (R/M)	#125092.
											04-010 S-DE (R/M)			RISER1/0-3PH 37-240 (R/M)	
														(3)U-guard 3" (R/M)	
														BackPlate 3" (R/M)	
														U-guard Vent Boot 4" (R/M)	
Sta 5 (R/M)	125093 (R/M)	55-2 (R/M)	113 (R/M)	03-440 3ph 9' X-A (R/M)	(3)4/0 ACSR-Pri 1/0 AAAC-Neu (R/M)						04-010 2-IB (R/M)	176 (R/M)	4/0 TX OVH SEC (R/M)		Remove Pole
											Tie In (R/M)				#125093.
											04-010 S-DE (R/M)				
Sta 6 (R/M)	161820 (R/M)	55-2 (R/M)	176 (R/M)	03-470 3ph D 9' X-A (R/M)	(3)4/0 ACSR-Pri 1/0 AAAC-Neu (R/M)						04-010 2-IB (R/M)	70 (R/M)	4/0 TX OVH SEC (R/M)		Remove Pole
											Tie In (R/M)				#161820.
											(2)04-010 S-DE (R/M)				
											(2)04-010 S-DE (R/M)				
Sta 20	344731	35-5 (R/M)									(2)04-010 IB (R/M)	66 (R/M)	4 TX OVH SEC (R/M)		Backfill pole w/ gravel 12' NE.
		35-2 (I/S)									(2)04-010 IB (I/S)	42 (I/S)	4 TX OVH SEC (I/S)		
											(2)04-010 S-DE (R/M)				
											(2)04-010 S-DE (I/S)				
											T/F Service (I/S)				
Sta 21												71	4 TX OVH SEC		

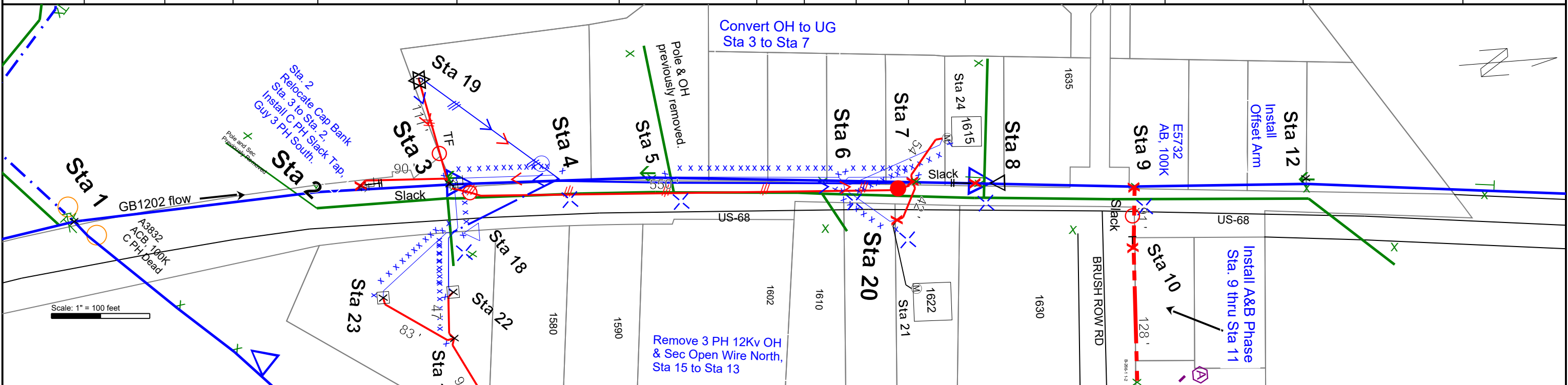

SAP ORDER # : _____

AES Ohio Staking Sheet

LC WR # : _____

	STAKEOUT WO # : 10167575	CUSTOMER NAME : *P-ODOT-7 (115388)	SUBDIVISION : GRE-68-12.65	GRID : G34-14-C4
	DESIGN TECH : WARD, WILLIAM B. PHONE : 937-554-9063	ADDRESS : 1587 US-68	TRENCHING PARTY : _____	CIRCUIT : GB1202 TAPS : 12 KV (100%)
	DESIGN DATE : _____ Page : 4 of 7	TWP / CITY : Xenia ZIP : 45385	JOINT TRENCH : No	PHASE : T
	DESCRIPTION : Convert 3PH OH/ UG, Relocate OH / bridge	LOCATION : 0241 - Xenia Twp, Greene - OH29202410	UPLINE FUSE : C9785 SIZE : 140K	

STATION	POLE NO.	POLE H/C	PRI. SPAN	PRIMARY		TRANSFORMERS	GROUND	GUY		ANCHOR	SECONDARY AND SERVICE UNITS	SEC/SERV SPAN	SECONDARY/SERVICE WIRE	MISCELLANEOUS UNITS	REMARKS
				UNITS	WIRE			UNIT	LEAD						
Sta 7 (I/S)	537318 (I/S)	50-2 (I/S)	70 (R/M)	03-410 Aptg DE (I/S)	(3)4/0 ACSR-Pri 1/0 AAAC-Neu (R/M)						04-010 IB (I/S)			(3)08-120 C/O BL (I/S)	Backfill pole w/ gravel 46' S inline, 6' W for 3PH Riser.
			471 (I/S)	Hand Dig (I/S)	(3)1000 PRI URD (I/S)						04-010 S-DE (I/S)			STA.RISER1000-3PH 37 (I/S)	
				Hand Dig (I/S)										(3)U-guard 5" (I/S)	
														BackPlate 5" (I/S)	
Sta 24	1615 OH Svc										04-010 S-DE (R/M)	110 (R/M)	4 TX OVH SERV (R/M)		
											04-010 S-DE (I/S)	54 (I/S)	4 TX OVH SERV (I/S)		
Sta 8	125094	50-2 (R/M)		03-440 3ph 9' X-A (R/M)		1-50KVA 120/240 NT 0 CØ		02-060 5/16" PDG (I/S)	40 (I/S)	10" ANC (I/S)				08-120 C/O TF (R/M)	Backfill pole w/ gravel 6' W, Guy
		50-2 (I/S)		03-410 Aptg DDE (I/S)		T/F Ex. Xfmr Ø (I/S)		02-060 5/16" PDG (I/S)	40 (I/S)	Shared 10" ANC (I/S)				08-120 C/O TF (I/S)	against Sta. 9, remove
								02-050 5/16" NDG (I/S)	35 (I/S)	10" ANC (I/S)				15K (R/M)	guying against Sta. 7.
								02-050 5/16" NDG (R/M)	12 (R/M)	10" ANC (R/M)				15K (I/S)	
Sta 9	120665	60-1 (R/M)		03-410 Aptg DE (I/S)							04-010 IB (R/M)			(2)08-120 C/O BL (I/S)	Backfill pole w/ gravel 6' W, Lower
		60-1 (I/S)		03-440 3ph 9' X-A (R/M)							04-010 IB (I/S)			(2)100K (I/S)	Clevis to install
				03-440 3ph 9' X-A (I/S)							Tie In (R/M)			12-032 Jumper 1/0 (I/S)	X-Arm, Install BL E5732, AB, 100K.
											Tie In (I/S)				
											04-010 S-DE (I/S)				
Sta 12	161822	50-2		03-440 3ph 9' X-A (R/M)											Install Offset Arm
				03-500 3ph 9' X-A (I/S)											

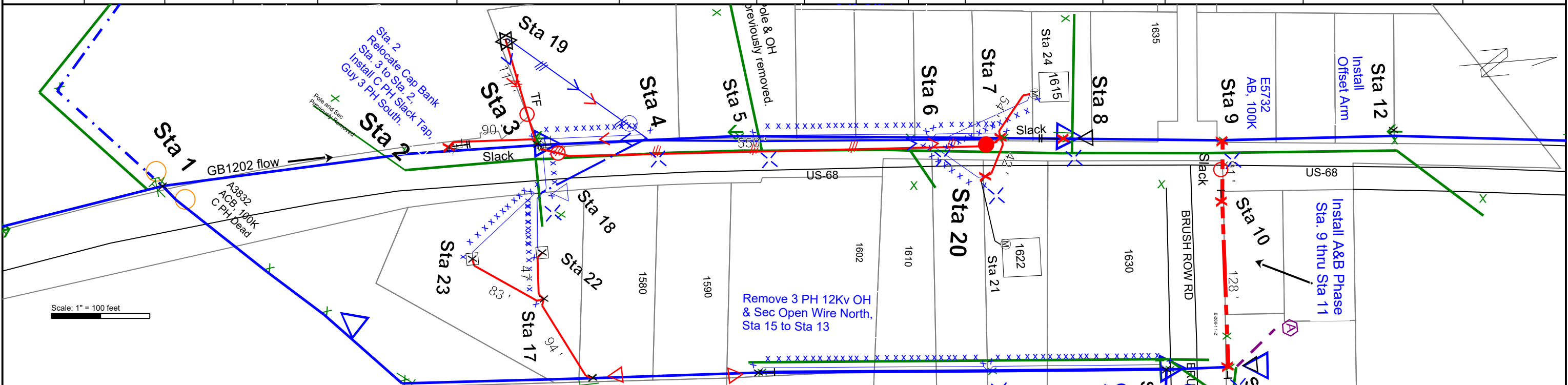

SAP ORDER # : _____

AES Ohio Staking Sheet

LC WR # : _____

	STAKEOUT WO # : 10167575	CUSTOMER NAME : *P-ODOT-7 (115388)	SUBDIVISION : GRE-68-12.65	GRID : G34-14-C4
	DESIGN TECH : WARD, WILLIAM B. PHONE : 937-554-9063	ADDRESS : 1587 US-68	TRENCHING PARTY : _____	CIRCUIT : GB1202 TAPS : .12 KV (100%)
	DESIGN DATE : _____ Page : 5 of 7	TWP / CITY : Xenia ZIP : 45385	JOINT TRENCH : No	PHASE : T
	DESCRIPTION : Convert 3PH OH/ UG, Relocate OH / bridge	LOCATION : 0241 - Xenia Twp, Greene - OH29202410	UPLINE FUSE : C9785 SIZE : 140K	

STATION	POLE NO.	POLE H/C	PRI. SPAN	PRIMARY		TRANSFORMERS	GROUND	GUY		ANCHOR	SECONDARY AND SERVICE UNITS	SEC/SERV SPAN	SECONDARY/SERVICE WIRE	MISCELLANEOUS UNITS	REMARKS
				UNITS	WIRE			UNIT	LEAD						
Sta 10 (I/S)	537319 (I/S)	45-2 (I/S)	91 (I/S)	03-410 Aptg DDE (I/S)	(3)1/0 AAAC (I/S)			02-060 5/16" PDG (I/S)	15 (I/S)	10" ANC (I/S)	(2)04-010 IB (I/S)			(2)12-032 Jumper 1/0 (I/S)	Set and Own 45'-2
								02-050-5/16" NDG (I/S)	15 (I/S)	Shared 10" ANC (I/S)	(2)04-010 S-DE (I/S)			12-032 Jumper 1/0 (I/S)	
Sta 11	491490	45-2 (I/S)	128 (I/S)	03-260 9' X-A 2ph (I/S)	(3)1/0 AAAC (I/S)	T/F Ex. Xfmr Ø (I/S)		02-060 5/16" PDG (I/S)	15 (I/S)	10" ANC (I/S)	04-010 IB (I/S)			08-120 C/O TF (R/M)	Replace 40' pole
		40-2 (R/M)		(3)T/F Tie In (I/S)		1-50KVA 120/240 NT 0 AØ		02-050-5/16" NDG (I/S)	15 (I/S)	Shared 10" ANC (I/S)	Tie In (I/S)			15K (R/M)	w/ 45'-2.
				03-520 D9'X-ADE 2100 (R/M)				02-060 5/16" PDG (R/M)	15 (R/M)	10" ANC (R/M)	04-010 IB (R/M)			08-120 C/O TF (I/S)	
								02-050-5/16" NDG (R/M)	15 (R/M)	Shared 10" ANC (R/M)	04-010 IB (I/S)			15K (I/S)	
											04-010 S-DE (R/M)			(3)U-guard 2" (R/M)	
											04-010 S-DE (I/S)			BackPlate 2" (R/M)	
											04-010 S-DE (R/M)			BackPlate 2" (I/S)	
											04-010 S-DE (I/S)			(3)U-guard 2" (I/S)	
											04-010 S-DE (R/M)				
Sta 13	121640	40-5		03-440 3ph 9' X-A (R/M)							(2)04-010 S-DE (R/M)				Convert to Slack
				03-520 D9'X-ADE 1200 (I/S)							Tie In (R/M)				over Brush Row Rd.
											04-010 S-DE (I/S)				
Sta 14 (R/M)	70137 (R/M)	40-5 (R/M)	181 (R/M)	03-440 3ph 9' X-A (R/M)	(3)2 CU-Pri 6 CU HDB-Neu (R/M)						(3)04-010 IB (R/M)	181 (R/M)	1/0 ACSR SEC (R/M)		Remove Pole, Pri/ Open wire North.
											(3)Tie In (R/M)				
Sta 16	120658	45-2				1-25KVA 120/240 NT 0 CØ (I/S)									

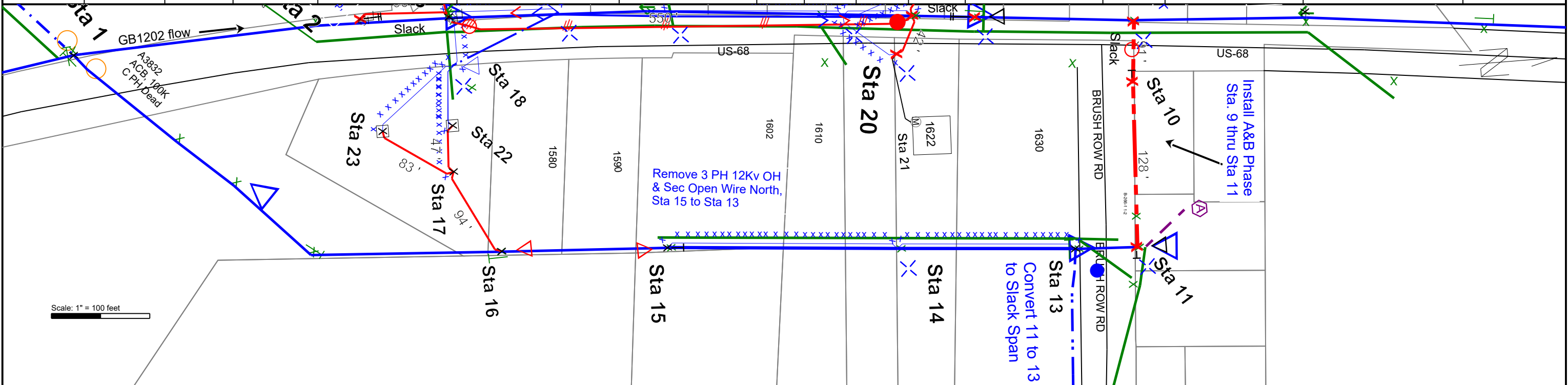

SAP ORDER # : _____

AES Ohio Staking Sheet

LC WR # : _____

 <p>STAKEOUT WO # : 10167575 DESIGN TECH : WARD, WILLIAM B. PHONE : 937-554-9063 DESIGN DATE : _____ Page : 6 of 7 DESCRIPTION : Convert 3PH OH/ UG, Relocate OH / bridge</p>	<p>CUSTOMER NAME : *P-ODOT-7 (115388) ADDRESS : 1587 US-68 TWP / CITY : Xenia ZIP : 45385 LOCATION : 0241 - Xenia Twp, Greene - OH29202410</p>	<p>SUBDIVISION : GRE-68-12.65 TRENCHING PARTY : _____ JOINT TRENCH : No</p>	<p>GRID : G34-14-C4 CIRCUIT : GB1202 TAPS : .12 KV (100%) PHASE : T UPLINE FUSE : C9785 SIZE : 140K</p>
---	--	---	--

STATION	POLE NO.	POLE H/C	PRI. SPAN	PRIMARY			TRANSFORMERS	GROUND	GUY		ANCHOR	SECONDARY AND SERVICE UNITS	SEC/SERV SPAN	SECONDARY/SERVICE WIRE	MISCELLANEOUS UNITS	REMARKS
				UNITS	WIRE	UNIT			LEAD							
Sta 15	120659	35-5	234 (R/M)	03-440 3ph 9' X-A (R/M)	(3)2 CU-Pri 6 CU HDB-Neu (R/M)	1-25KVA 120/240 NT 0 BØ (I/S)		02-060 5/16" PDG (I/S)	25 (I/S)	10" ANC (I/S)	04-020 DIB (R/M)	234 (R/M)	1/0 ACSR SEC (R/M)	08-120 C/O TF (I/S)	Guy South, Remove	
				03-520 D9'X-ADE 2100 (I/S)				02-050 5/16" NDG (I/S)	25 (I/S)	Shared 10" ANC (I/S)	(3)04-010 S-DE (R/M)				Pri/ Open wire North.	
Sta 17	320045	35-5									04-010 2-IB	94 (I/S)	1/0 TX OVH SEC (I/S)			
												107 (R/M)	6 DX SERV NL (R/M)			
Sta 22	Cust. Pole	30-6									04-010 IB	47 (I/S)	1/0 TX OVH SERV (I/S)			
											04-010 S-DE (I/S)	60 (R/M)	1/0 TX OVH SERV (R/M)			
											04-010 S-DE (R/M)					
Sta 23	Customer pole	35-5									04-010 S-DE (R/M)	83 (I/S)	4 TX OVH SEC (I/S)			
											04-010 S-DE (I/S)	97 (R/M)	4 TX OVH SEC (R/M)			
											04-010 IB					
Sta 18 (R/M)	320045 (R/M)	40-2 (R/M)	120 (R/M)	Slack PDE (R/M)	(2)1/0 AAAC (R/M)	1-25KVA 120/240 NT 0 CØ (R/M)					04-010 IB (R/M)			08-120 C/O TF (R/M)	Remove pole and Xfmr.	
											04-010 S-DE (R/M)			10K (R/M)	Feed customers from	
														12-032 Jumper 1/0 (R/M)	back lot.	

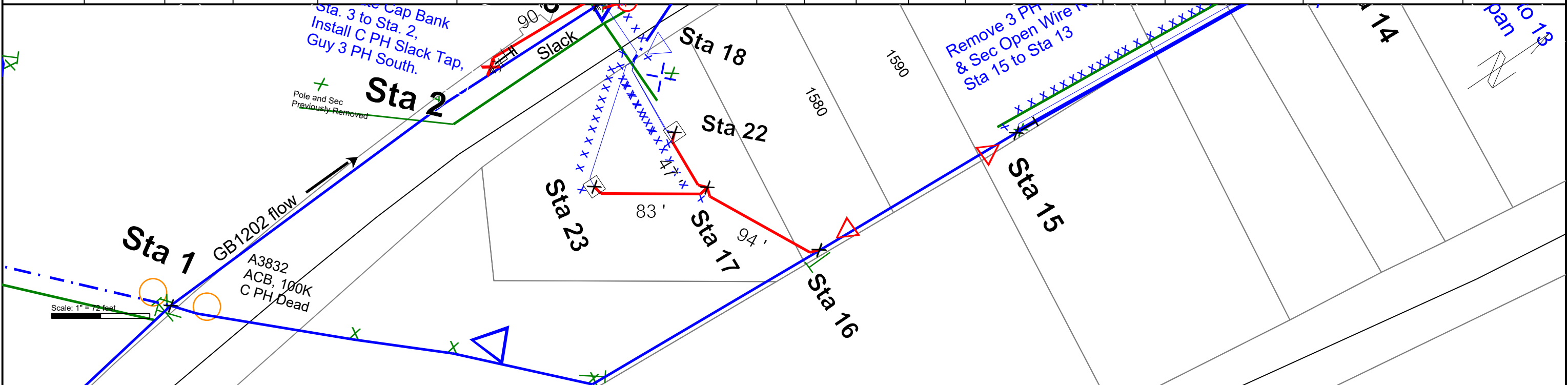

SAP ORDER # : _____

AES Ohio Staking Sheet

LC WR # : _____



STAKEOUT WO # : **10167575**

DESIGN TECH : **WARD, WILLIAM B.**

DESIGN DATE : _____

DESCRIPTION : **Convert 3PH OH/ UG, Relocate OH / bridge**

PHONE : **937-554-9063**

Page : **7 of 7**

CUSTOMER NAME : ***P-ODOT-7 (115388)**

ADDRESS : **1587 US-68**

TWP / CITY : **Xenia**

LOCATION : **0241 - Xenia Twp, Greene - OH29202410**

SUBDIVISION : **GRE-68-12.65**

TRENCHING PARTY : _____

JOINT TRENCH : **No**

GRID : **G34-14-C4**

CIRCUIT : **GB1202** TAPS : **12 KV (100%)**

PHASE : **T**

UPLINE FUSE : **C9785** SIZE : **140K**

