

DETAIL 2

CROSS SECTION
(LOOKING DOWNSTATION, SOUTH BOUND BRIDGE SHOWN
NORTH BOUND BRIDGE OPPOSITE HAND)

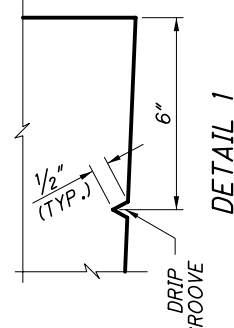

DETAIL 1

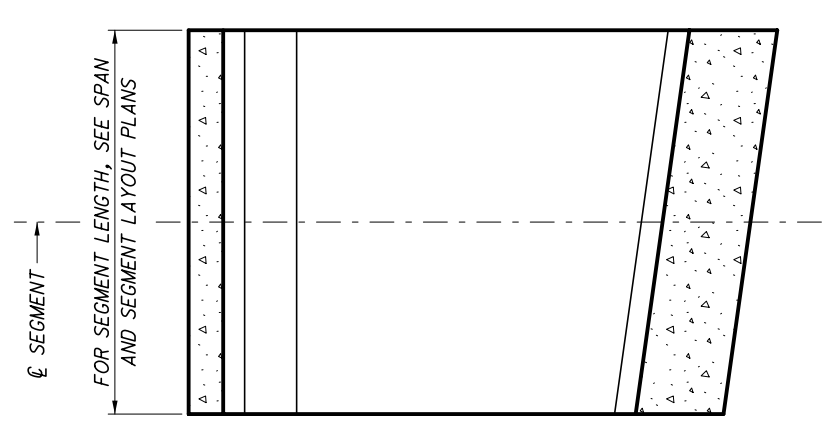

SECTION A-A

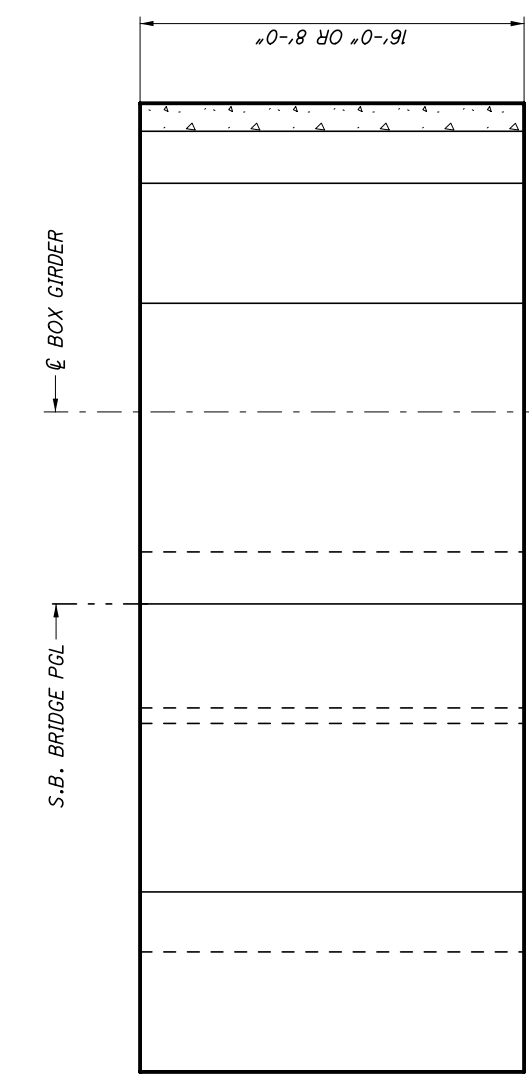

FIGURE 1-2: CROSS SECTION
HALF PLAN TOP SLAB
(SOUTH BOUND BRIDGE SHOWN
NORTH BOUND BRIDGE OPPOSITE HAND)
HALF PLAN BOTTOM SLAB
(SOUTH BOUND BRIDGE SHOWN
NORTH BOUND BRIDGE OPPOSITE HAND)

JOINT NO.	A	H	T
0B **	20'-0"	25'-0"	3'-8"
1B	20'-3"	24'-5"	3'-6"
2B	21'-0 1/2"	22'-7 3/4"	2'-11"
3B	21'-9 1/4"	20'-11 3/4"	2'-5"
4B	22'-5 1/2"	19'-5 1/8"	2'-0"
5B	23'-1"	18'-0 1/8"	1'-7 1/2"
6B	23'-7 7/8"	16'-8 1/2"	1'-4"
7B	24'-2"	15'-6 1/2"	1'-1"
8B	24'-7 3/8"	14'-6 1/4"	11"
9B	25'-0"	13'-7 3/4"	9 7/8"
10B	25'-3 3/8"	12'-11 1/8"	9 1/2"
11B	25'-6 3/8"	12'-4 3/8"	9 1/2"
12B	25'-8 3/8"	12'-0 3/4"	9 1/2"
13B	25'-8 3/4"	12'-0"	9 1/2"
14B	25'-8 3/4"	12'-0"	9 1/2"

JOINT NO.	A	H	T
0A **	20'-0"	25'-0"	3'-8"
1A	20'-7 3/4"	23'-6 1/4"	3'-2 3/8"
2A	21'-4 1/8"	21'-9 1/2"	2'-8"
3A	22'-1 3/8"	20'-2 1/4"	2'-2 1/2"
4A	22'-9 1/4"	18'-8 3/8"	1'-9 1/2"
5A	23'-4 1/2"	17'-4 1/8"	1'-5 1/2"
6A	23'-11"	16'-1 7/8"	1'-2 1/2"
7A	24'-4 3/4"	15'-0 1/8"	1'-0"
8A	24'-9 3/4"	14'-0 3/4"	10 1/2"
9A	25'-2"	13'-3 3/8"	9 1/2"
10A	25'-5 3/8"	12'-7 5/8"	9 1/2"
11A	25'-7 5/8"	12'-2 3/8"	9 1/2"
12A	25'-8 3/4"	12'-0"	9 1/2"
13A	25'-8 3/4"	12'-0"	9 1/2"
12C	25'-8 3/4"	12'-0 3/4"	9 1/2"

** FOR DIMENSION ONLY, NOT A SEGMENT JOINT

NOTES:

- SEE SHEETS 96 AND 97 OF 204 FOR JOINT DEFINITION.
- ALL CONCRETE CHAMFERS ARE 3/4".
- S.B. DENOTES SOUTH BOUND.
- 1/2" INITIAL WEARING SURFACE IN CROSS SECTION NOT SHOWN FOR CLARITY. ALL DIMENSIONS SHOWN ARE MEASURED FROM WORKPOINT "P" IN DETAIL 2 AND DO NOT INCLUDE THE INITIAL WEARING SURFACE.