

MARK	NUMBER		LENGTH	WEIGHT	TYPE	DIMENSIONS					
	TOTAL					A	B	C	D	E	R
SUPERSTRUCTURE REINFORCING STEEL LIST											
S601	3		4'-3"	19	2	1'-0"	0'-11"	2'-8"	.	.	.
S602	12		21'-11"	396	STR
S603	12		21'-7"	390	STR
S604	3		4'-8"	21	2	1'-0"	0'-11"	3'-1"	.	.	.
S605	3		3'-10"	17	2	1'-0"	0'-11"	2'-3"	.	.	.
S606	3		4'-0"	18	2	1'-0"	0'-11"	2'-5"	.	.	.
S701	12		21'-11"	538	STR
S702	12		21'-7"	530	STR
SUB-TOTAL				1,929							

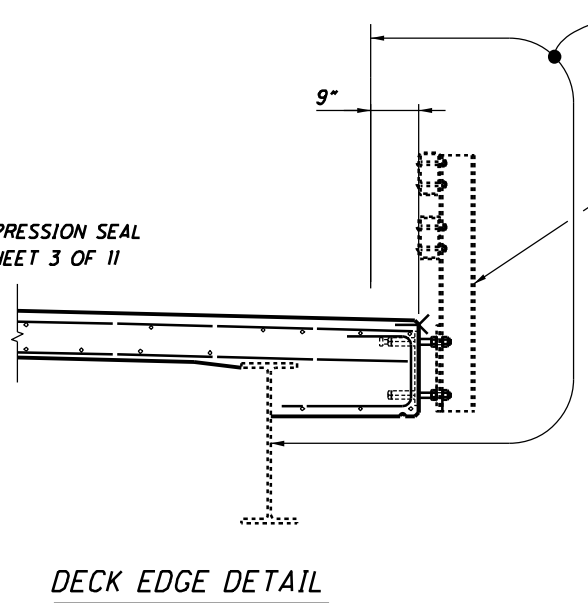
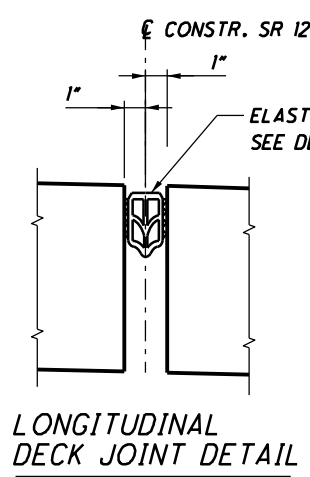

SEE NOTE #3
REMOVE AND REPLACE A PORTION OF THE BRIDGE RAILING TO ACCOMMODATE PARTIAL DECK SLAB REPLACEMENT. REPLACE RAILING ANCHOR BOLTS AS NEEDED. ANCHOR BOLTS REMOVED WITH THE DECK SHALL NOT BE RE-USED. BOLTS SHALL MEET THE REQUIREMENTS OF STD. DWG. DBR-2-73. THIS WORK SHALL BE INCLUDED WITH ITEM 517 - RAILING MISC.: PORTION OF BRIDGE RAILING REMOVED AND REBUILT FOR PAYMENT.

- NOTES:**
- REFER TO MAINTENANCE OF TRAFFIC PLANS FOR ADDITIONAL INFORMATION.
 - CROSSFRAMES NOT SHOWN FOR CLARITY.
 - REMOVE EXISTING CONCRETE SEALER AS NEEDED AND RE-SEAL ENDS OF DECK AS SHOWN.
 - SAWCUT AND REMOVE EXISTING DECK CONCRETE PER PHASE CONSTRUCTION. SALVAGE EXISTING LONGITUDINAL DECK REBAR. SAWCUTTING OF DECK REBAR SHALL NOT BE ALLOWED.