



STATE OF OHIO
DEPARTMENT OF HIGHWAYS

INTER-OFFICE COMMUNICATION

County of Brown Div. 9

S. H. 125 Sec. Decatur

Date 2-25-69

To Fred C. Tarbox, Engineer, Bureau of Traffic

Attention: John W. Clark, Traffic
Operations Engineer

From W. R. Wright DTE

Subject Signal Up-grading.

This will advise you that the signal heads for Signal No. 1904, located at SR 125 E DECATUR, BROWN CO., were up-graded on the following date 2-25-69.

We removed the following heads (number, size and type): ONE 8" 4WAY
DOUBLE UNIT.

We installed the following heads (number, size and type): TWO 8" 4WAY
SINGLE UNIT.

The sketch below shows how the signal heads were displayed when the job was finished:

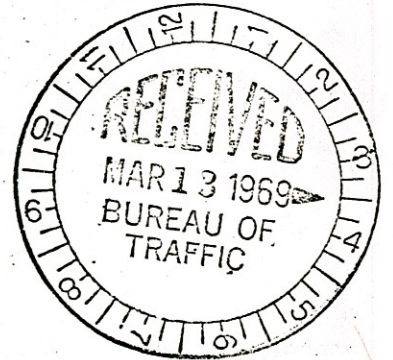
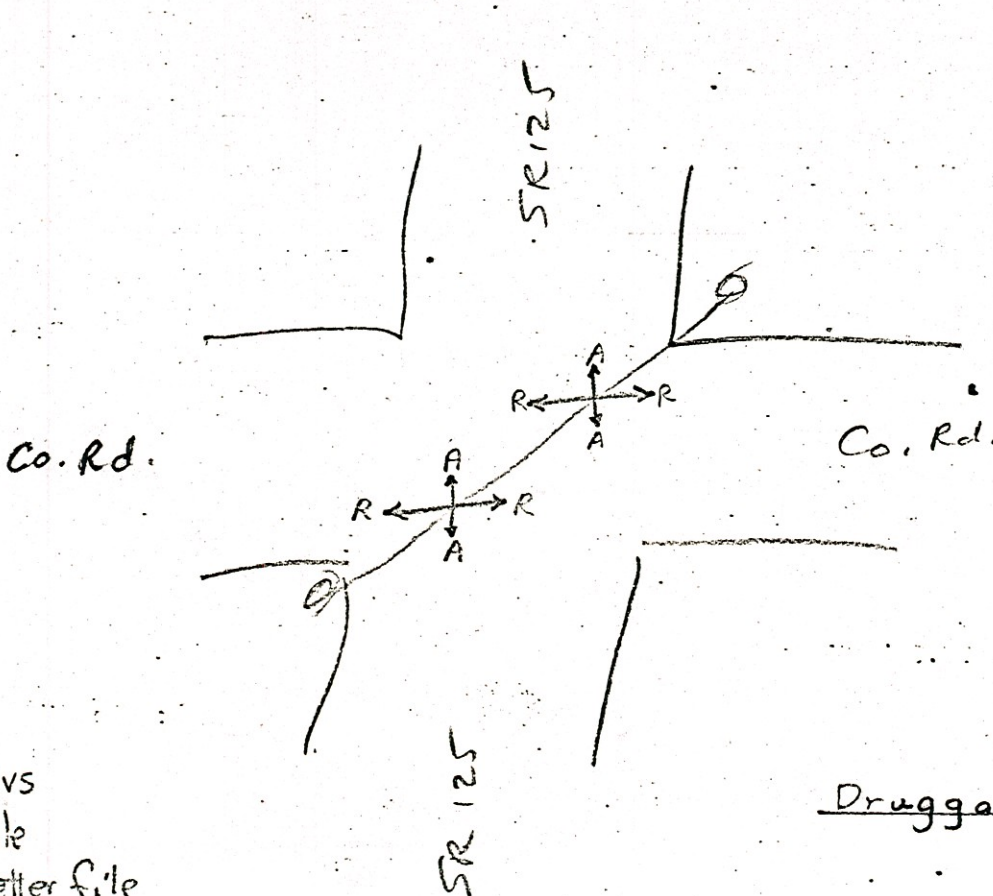

Druggan - Stout.

RVS
file
letter file

Gwen Roberts

OHIO DEPARTMENT OF HIGHWAYS
BUREAU OF TRAFFIC
SIGNAL SECTION

TRAFFIC SIGNAL INSPECTION REPORT

SIGNAL NO 1904 LOCATION SR 125 - Co. Rds 14 & 22
DATE OF INSTALLATION 1-20-62 DATE OF INSPECTION 9-12-69
COUNTY BROWN DIVISION 9

TYPE	_____ FLASHER OVERHEAD	_____ FLASHING STOP SIGN
	_____ FLASHING SIGNAL AHEAD	_____ OTHER FLASHING DEVICES
	_____ SCHOOL SIGNAL	_____ SCHOOL FLASHING UNIT
	_____ FIXED TIME	_____ SEMI ACTUATED
	_____ FULL ACTUATED	_____ 2 ϕ VOLUME DENSITY
	_____ 3 ϕ VOLUME DENSITY	_____ MULTI PHASE

WAS JOB INSTALLED AS PER PLAN? YES NO

ELECTRIC UTILITY

COMPANY Cols - Southern SERVICE OH, _____ UG
 2 WIRE _____ 3 WIRE, METERED,
_____ NOT METERED NO SAFETY SWITCH
_____ POLE # _____ POLE # _____ POLE #
_____ LOCATION _____ LOCATION _____ LOCATION

GENERAL TELEPHONE COMPANY

POLE # T 104 POLE # _____ POLE # _____
LOCATION S.O.E. GR. LOCATION _____ LOCATION _____

TRAFFIC CONTROL EQUIPMENT

ITEM	SATISFACTORY	UNSATISFACTORY	COMMENTS
HEADS	✓		2-4way 1 unit 8"
POLES	✓		1 class 5-35 1 GENERAL TELE.
DETECTORS			
FLASHER		✓	TRAFFIC SIG. INC.
SIGNAL HOUSING	✓		METER SOCKET GLASS ENCLOSURE
CONTROLLER			
SIGNAL RELAYS			
INTERNAL WIRING	✓		
EXTERNAL WIRING	✓		
SERVICE	✓		2 wire metered no safety switch
PHOTO RELAYS			
TIMING	SEE ATTACHED CHART		36 F.P.M
MANHOLES			
CONCRETE WORK			
CLEAN UP	✓		
SIGNS	✓		
PAVEMENT MARKING	✓	✓	SR 125 no SB c/ on P.O.S
LIGHTING			

NOTE: If no print is available make sketch and attach to inspection report.

INSPECTED BY Ray Andrews

DATE: 9-12-69



SIG. # 1904
RECOMMEND

- ① Trim Trees as per photos 1-3
- ② Have TWP. or County put down
S/Bs E/L and E/L on TYP RDS 14-22
- ③ Paint Conduits and Fittings.
- ④ Div. 9 paint E/L on SR 125.
- ⑤ Replace Jack Mounted Flasher,
F.P.M. only 36.

9-29-69

Ray Andrews

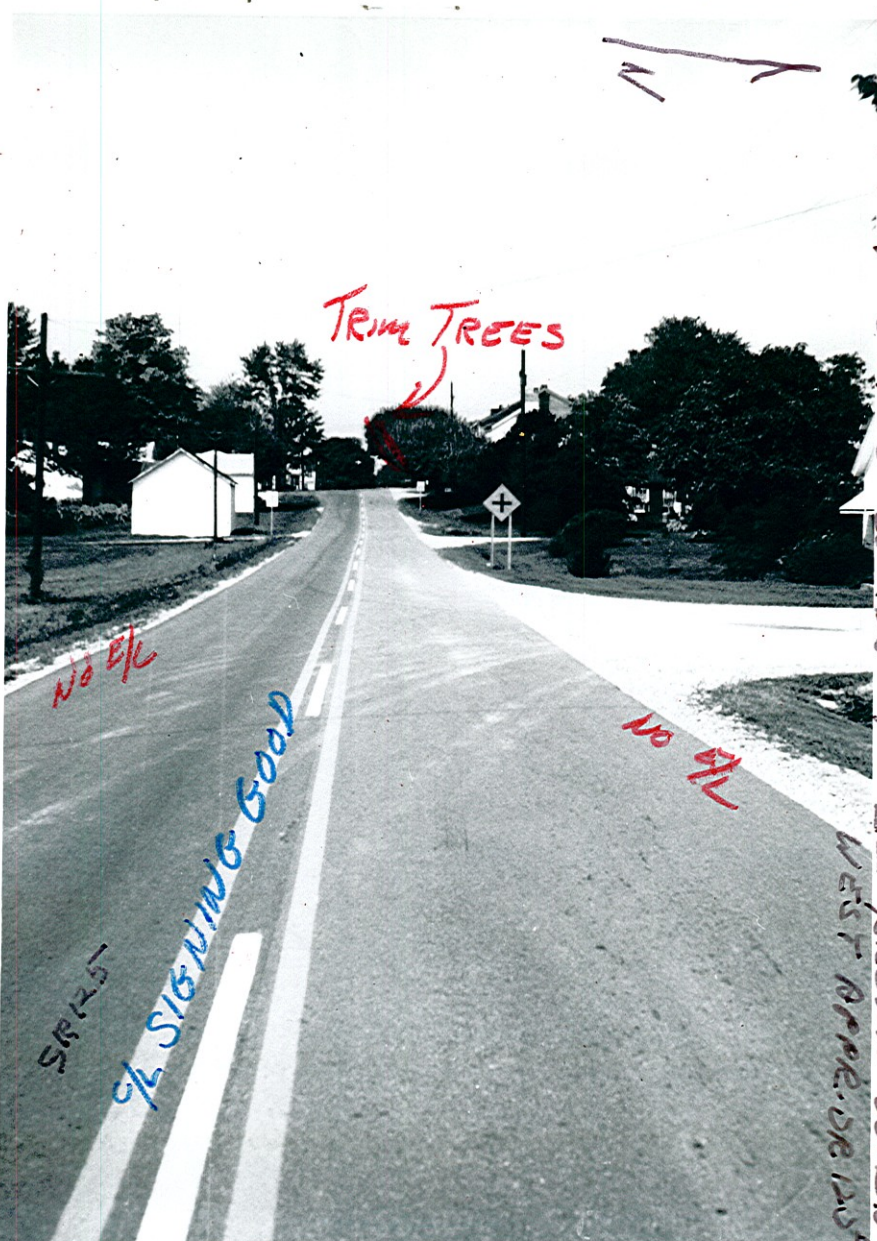

TRIM TREES

No 4/2

No 4/2

S.R. 12.5

1/2 SIGNING GOOD

S6# 1904 S.E. 12.5 - Co RDS 14 - 22. TREAWN CO. DIV
WEST APPR. DR 12.5





Sig. # 1984 SR 125 - C.R.D.S. 14-22 Brown Co. Div 19

WEST APPROX. 1/2 MILE

NO 9/27

GOOD TURNING GOOD

NO 9/27

12

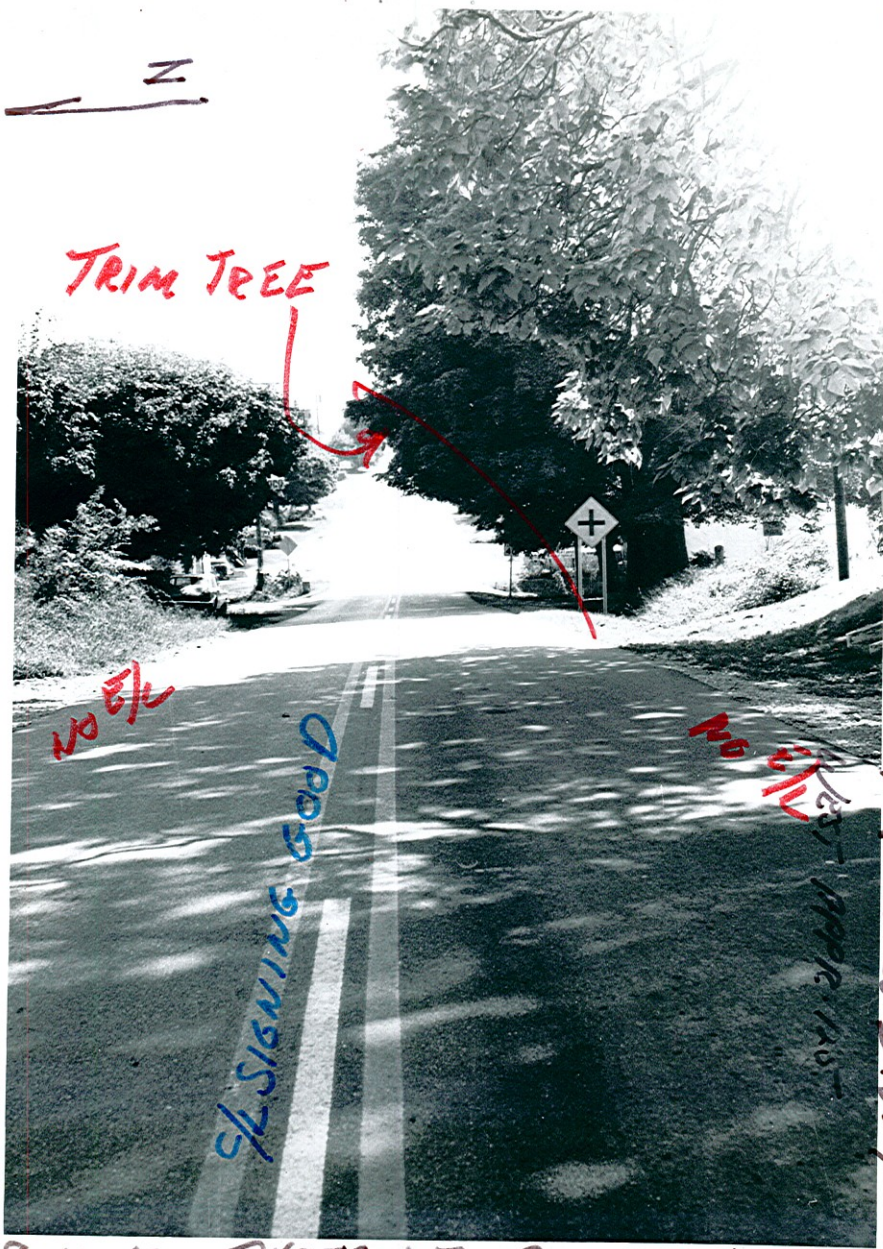

Sta. # 1904 SR 125 - Co. ROS 14-22 BROWN CO. DIV. 9

N

TRIM TREE

W 5/2

DROPPING GOOD

W 5/2

EST 1992 125



2-4WAY UNIT HEADS 8"

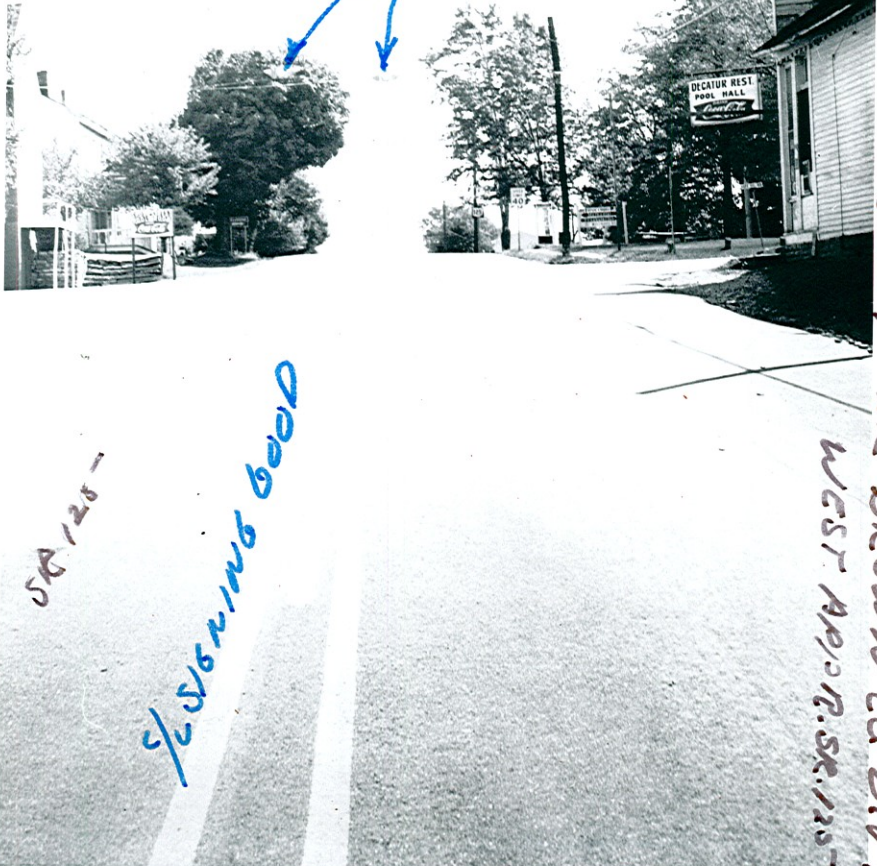

SR 125-

DECATUR REST

SR. # 1904 SE 125 - CO. RD 14-22 BROWN CA DIV 9
WEST APPR. SR. 125-

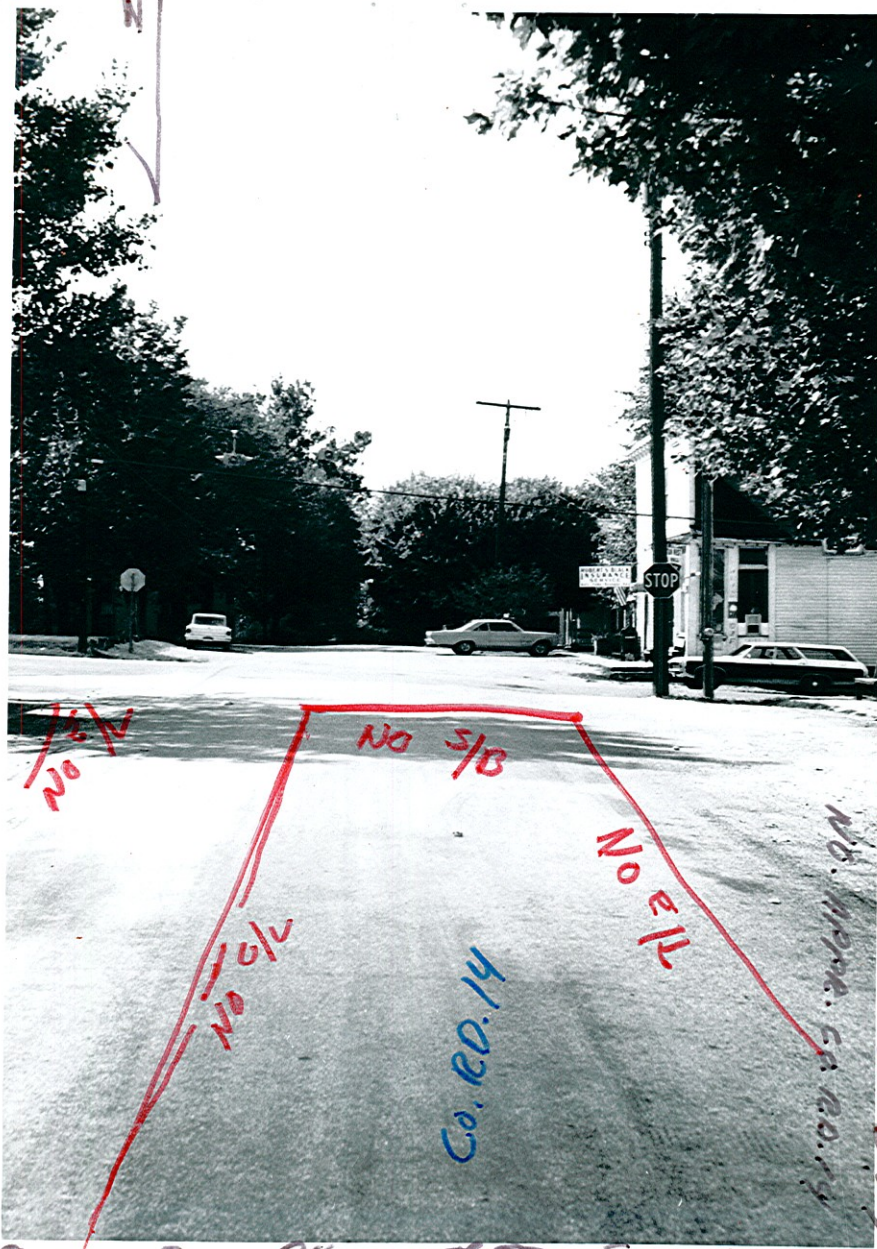

N

S16. # 1704 SRE 146 - Co. Rds 14 - 22. BROWN Co. Div 9

NE. MPPR. Co. RD. 14

No 1/2 V

No 5/8

No 1/2 V

No 1/2 R

Co. RD. 14

STOP



S/G. # 1904 SK 125-08 PPS 14-22 BROWN CO. DIV 9
No. W 557 COLVATE

STOP

RESTAURANT

CL. 6.35

SK 125

NO S/B

NO APPR

JACK MOUNTED
FLASHER

NO S/B

CO. RT

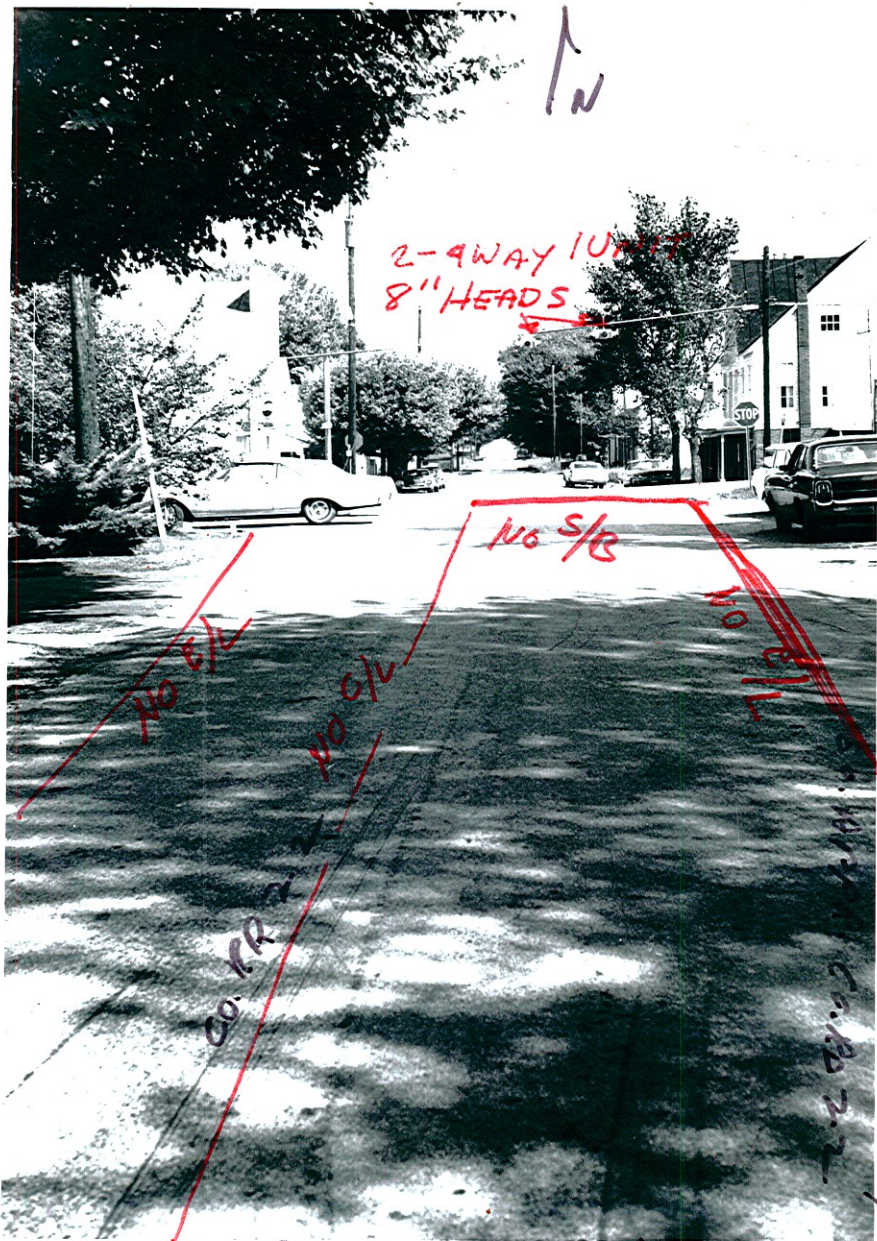

SIC # 1904 SE 125 - Co. Pos. 04-22 BERN CO. DIV. 9

N

2-WAY UNIT
8" HEADS

NO S/R

NO S/R

NO S/R

NO S/R

CO. POS.

CO. POS. 04-22

9-14-69 D. H. # 2 P. H. # 1

S/G. # 1909 SR. 125-CO Res 14-22 Brown CA Div 9



9-12-10 DUNTOFC (P...)