

GENERAL PLAN

GENERAL NOTES:

All Concrete except duct encasement to be Class 2  
 (6 Bags of Cement per Cu. Yd.)  
 Duct encasement concrete to be Class 3  
 (4 1/2 Bags of Cement per Cu. Yd.)  
 No Construction Joints to be made, except as shown, without specific authority from the Engineer of Structures, C.U.T. Co.  
 For explanation of method of marking bent bars, see "Standard Bar Marks" Sheet No 1 of 1, Issue No 2 dated June 20, 1927.  
 Specifications used for design - C.U.T. Co's. "Specifications for Highway Bridges and Viaducts" Issue No 1 dated July 10, 1924.  
 All exposed edges of Concrete to be chamfered 3/4" unless otherwise noted.  
 In making splices for reinforcement bars the bond distance shall be as follows:  
 3/8" φ 1'-6"; 1/2" φ 2'-0"; 5/8" φ 2'-6"; 3/4" φ 3'-0"; 7/8" φ 3'-6";  
 1" φ 4'-0"; 1 1/8" φ 4'-6" and 1 1/4" φ 5'-0".

Note: Subsequent to the completion of the Central Avenue Bridge, in accordance with this Plan, the County of Cuyahoga made alterations in the western side of this Bridge and extended it to the west.  
 For information concerning the alterations and extensions see the County's Plans for "Lorain-Centra Bridge, Cleveland, Ohio; Central Ave. Bridge Extension" Drawings Nos. 18 to 22 inclusive.

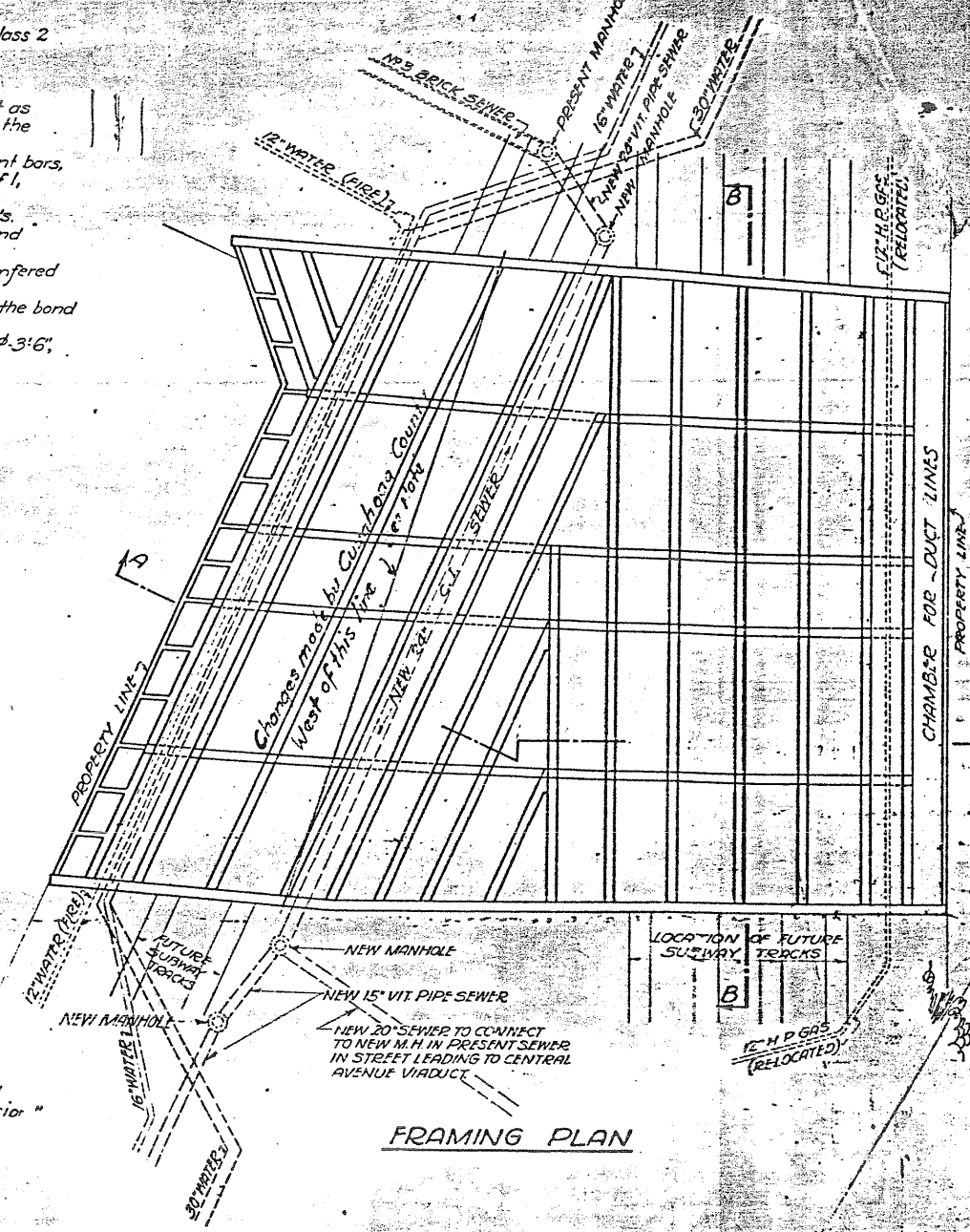

FRAMING PLAN

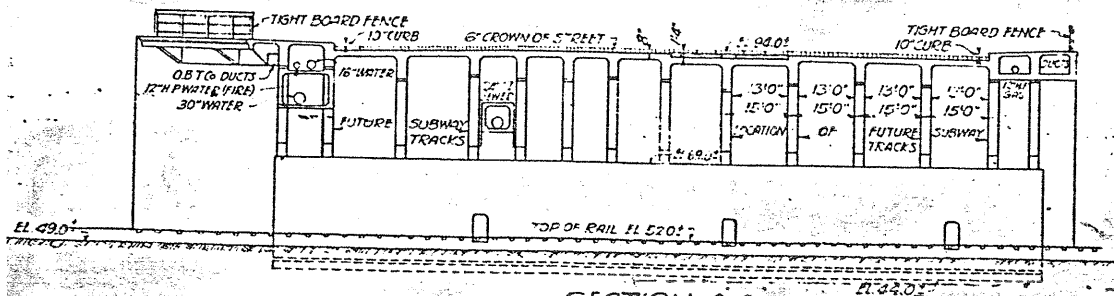

SECTION A-A

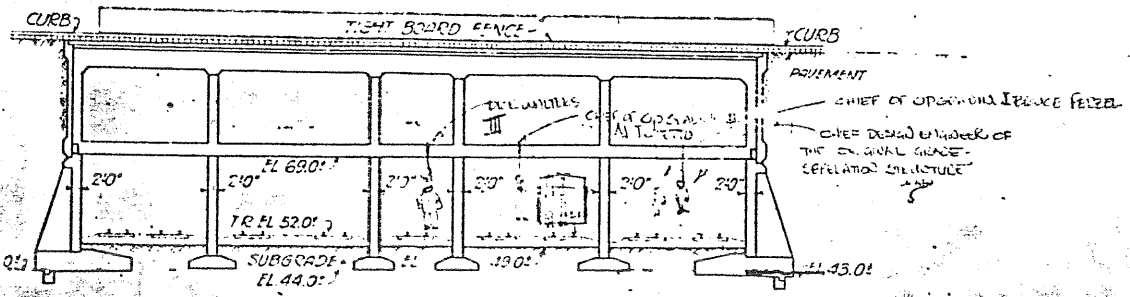

SECTION B-B

W. J. ...  
 Engineer of Structures  
 W. J. ...  
 Principal Assistant Engineer

Plan Approved  
 CITY OF CLEVELAND

THE CLEVELAND UNION TERMINALS CO.  
 CENTRAL AVE. BRIDGE  
 GENERAL PLAN  
 AND SECTIONS  
 CLEVELAND, OHIO

CUYAHOGA COUNTY  
CUY-10-16.23

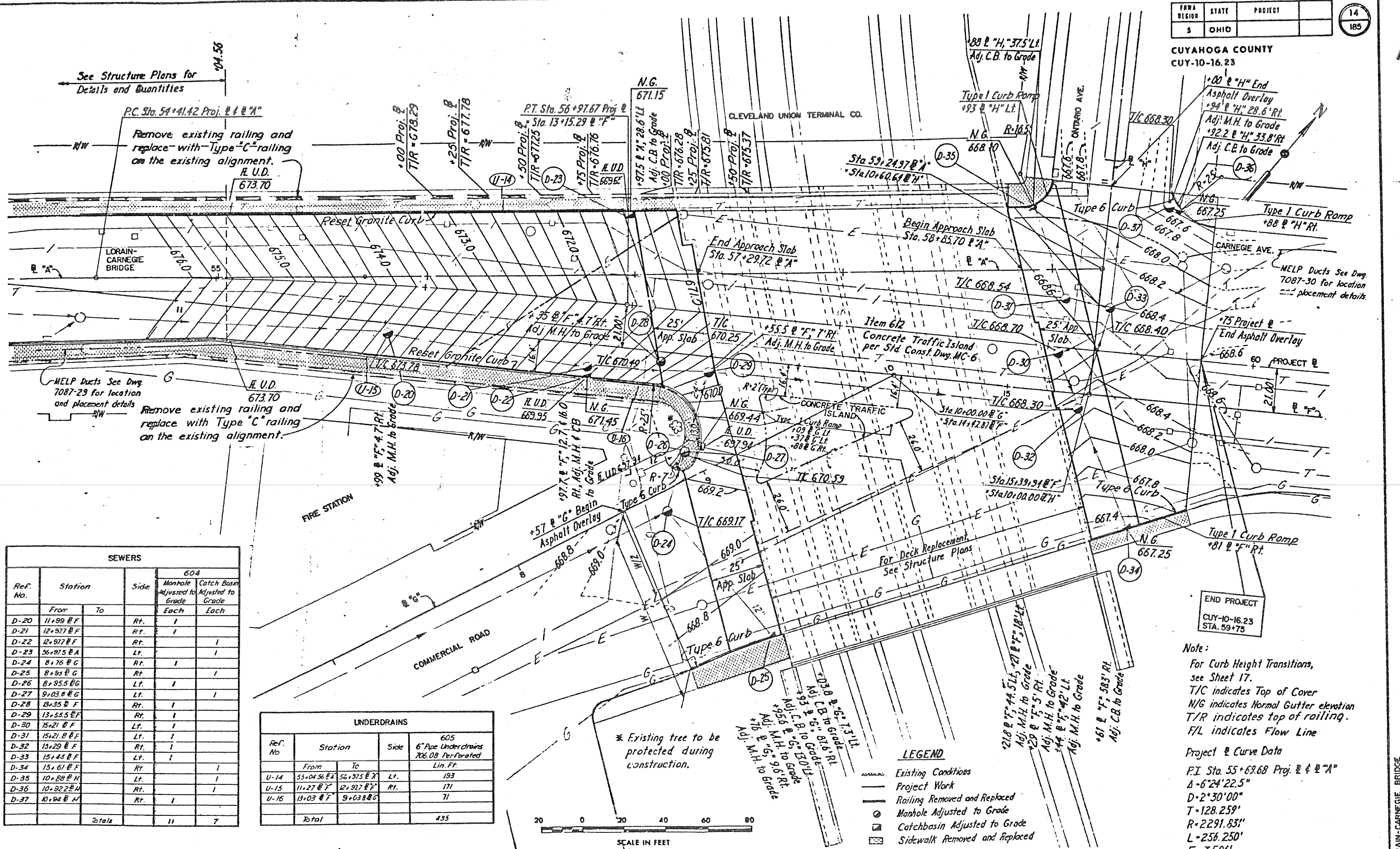

| SEWERS   |         |       |      |                                |                                    |
|----------|---------|-------|------|--------------------------------|------------------------------------|
| Ref. No. | Station |       | Side | 604                            |                                    |
|          | From    | To    |      | Manhole Adjusted to Grade Each | Catch Basin Adjusted to Grade Each |
| D-20     | 11+99   | 12+00 | Rt.  | 1                              |                                    |
| D-21     | 12+00   | 12+05 | Rt.  | 1                              |                                    |
| D-22     | 12+05   | 12+10 | Rt.  | 1                              |                                    |
| D-23     | 12+10   | 12+15 | Lt.  | 1                              |                                    |
| D-24     | 12+15   | 12+20 | Rt.  | 1                              |                                    |
| D-25     | 12+20   | 12+25 | Rt.  | 1                              |                                    |
| D-26     | 12+25   | 12+30 | Lt.  | 1                              |                                    |
| D-27     | 12+30   | 12+35 | Lt.  | 1                              |                                    |
| D-28     | 12+35   | 12+40 | Rt.  | 1                              |                                    |
| D-29     | 12+40   | 12+45 | Rt.  | 1                              |                                    |
| D-30     | 12+45   | 12+50 | Lt.  | 1                              |                                    |
| D-31     | 12+50   | 12+55 | Lt.  | 1                              |                                    |
| D-32     | 12+55   | 13+00 | Rt.  | 1                              |                                    |
| D-33     | 13+00   | 13+05 | Lt.  | 1                              |                                    |
| D-34     | 13+05   | 13+10 | Rt.  | 1                              |                                    |
| D-35     | 13+10   | 13+15 | Lt.  | 1                              |                                    |
| D-36     | 13+15   | 13+20 | Rt.  | 1                              |                                    |
| D-37     | 13+20   | 13+25 | Rt.  | 1                              |                                    |
| Total    |         |       | 11   | 7                              |                                    |

| UNDERDRAINS |          |         |      |                     |                            |
|-------------|----------|---------|------|---------------------|----------------------------|
| Ref. No.    | Station  |         | Side | 605                 |                            |
|             | From     | To      |      | 6" Pipe Underdrains | 706.08 Perforated Lin. Ft. |
| U-14        | 55+04.56 | 56+97.5 | Lt.  | 193                 |                            |
| U-15        | 11+27    | 12+92.7 | Rt.  | 171                 |                            |
| U-16        | 13+03    | 9+03.8  | G    | 71                  |                            |
| Total       |          |         |      | 435                 |                            |

- LEGEND**
- Existing Conditions
  - Project Work
  - Railing Removed and Replaced
  - Manhole Adjusted to Grade
  - Catchbasin Adjusted to Grade
  - Sidewalk Removed and Replaced

Note:  
For Curb Height Transitions, see Sheet 17.  
T/C indicates Top of Cover  
N/G indicates Normal Gutter elevation  
T/R indicates top of railing.  
F/L indicates Flow Line

Project & Curve Data  
P.I. Sta. 55+69.68 Proj. & Curve "A"  
Δ=6°24'22.5"  
D=2°30'00"  
T=128.259'  
R=2291.83'  
L=256.250'  
E=3.586'