

STRUCTURE DATA ON TRUSSES

TYPE: STEEL BECK TRUSSES WITH REINFORCED CONCRETE DECK AND SUBSTRUCTURE
 SPANS: VARRIES SEE GENERAL PLAN AND ELEVATION
 ROADWAY: 40'-0" FREE TO FRONT OF CURBS WITH TWO 8'-0" SIDEWAYS
 LOADS: HS20-44 (SEE 31.1) AND THE RELEVANT MILITARY LOADING
 SKIN: 0" x 0" x 0" (NONE)
 ALIGNMENT: TANGENT
 SUPERELEVATION: NONE (NORMAL CROWN)
 STRUCTURE FILE NUMBER: 10103
 CONDITION OF STRUCTURE: FAIR
 WEARING SURFACE: 2.0" x 2.0" ASPHALTIC CONCRETE (SUBBERIZED)
 PROPOSED: 2.0" x 2.0" ASPHALTIC CONCRETE OVER EXISTING

NOTES:

DIMENSIONS SHOWN HEREIN ARE TAKEN FROM ORIGINAL CONSTRUCTION DRAWINGS AND ARE NOT BEING RECHECKED. THEREFORE, THEY WILL BE CONSIDERED TO BE PART OF THIS PROJECT.
 THE EXISTING VERTICAL, HORIZONTAL, AND VERTICAL CLEARANCES ARE NOT NEARLY AFFECTED BY THIS PROJECT.
 SPANS AND PILES ARE NUMBERED AS SHOWN IN THE GENERAL PLAN AND ELEVATION DRAWINGS.
 ALL PROPOSED AND EXISTING PILES ARE SHOWN IN THE GENERAL PLAN AND ELEVATION DRAWINGS. ALL PILES TO BE REPLACED OR NEW PILES TO BE INSTALLED ARE SHOWN IN THE GENERAL PLAN AND ELEVATION DRAWINGS.
 C.P.P. - CLEVELAND PUBLIC POWER

odotche-clain-lynn associates
 CONSULTING ENGINEERS
 1156
GENERAL PLAN AND ELEVATION
 HOPE MEMORIAL BRIDGE
 (STATE ROUTE 10 OVER THE CUYAHOGA RIVER)
 BRIDGE NUMBER 101-16-13
 CUYAHOGA COUNTY
 318 24th ST. TO STA. 514+84.56
 DIVISION OF HIGHWAYS
 P.L.M. T.M.J. D.P. Z.A.P.
 3/76

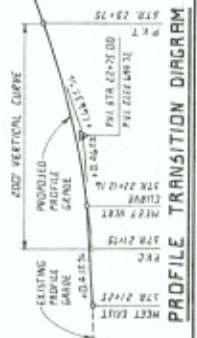
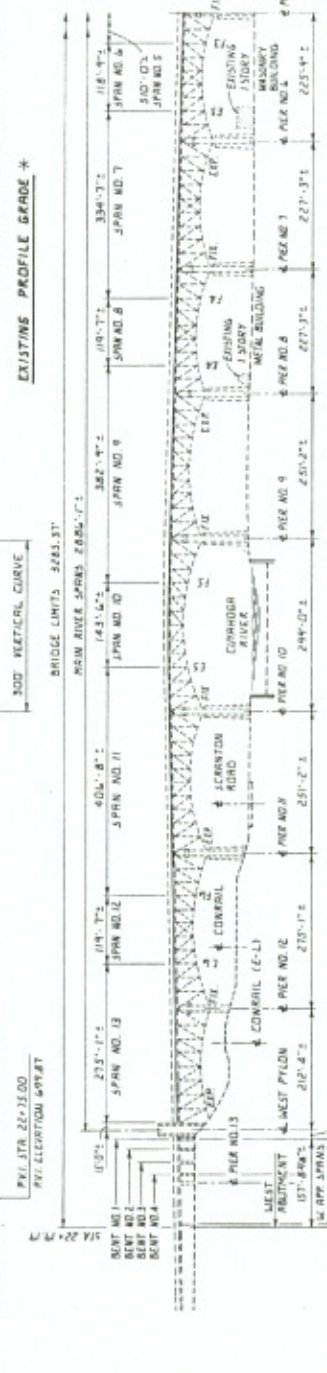
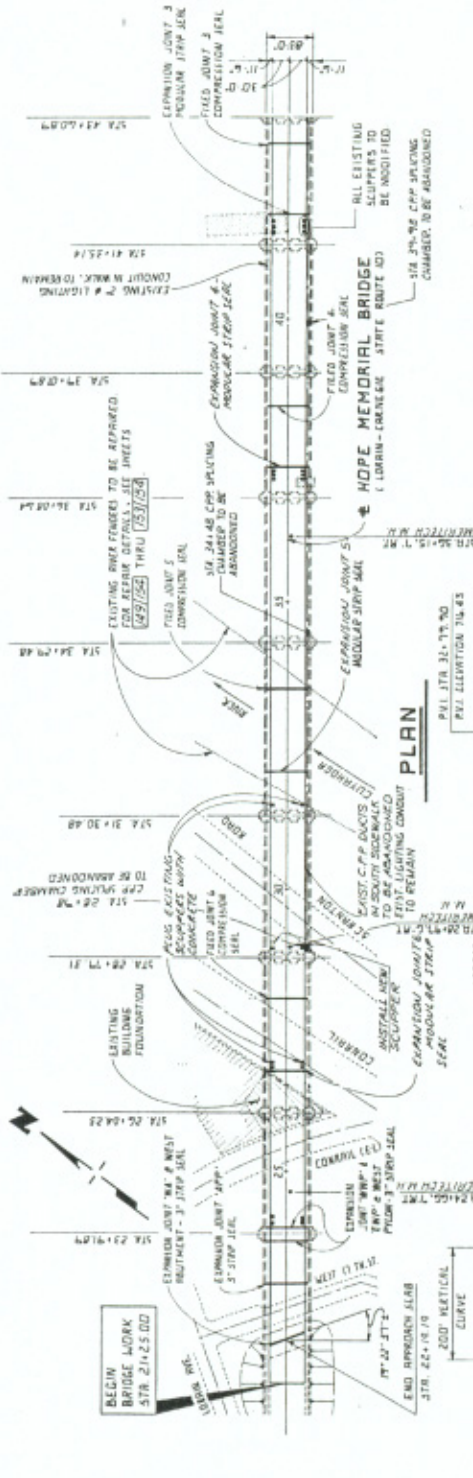

REVIEWED BY: BURGESS & NIPL, LIMITED
 J.C.S./M.P.R.
 5/15/56