

BENCHMARK: T&M 71 CHISELED SQ.
N.W. CORNER INLET I-480 STA.
846+20 80' ± PT.
ELEV. 750.30

SLM 10.47, 15"
SEE SHEET 176

SLM 10.50, 15"
SEE SHEET 70

CURVE DATA

①
 THETA-S = 9°49'18.8" P.I. STA. 47+07.26
 Ls = 250' Δ = 53°32'42.2"
 Xc = 249.27' Dc = 7°51'27"
 Yc = 14.26' R = 729.18'
 L.T. = 166.92' T = 367.90'
 S.T. = 83.57' L = 681.44'
 L.C. = 249.67' Ch = 656.92'
 P = 3.57' E = 87.55'
 K = 124.88'

②
 THETA-S = 9°49'18.8"
 Ls = 250'
 Xc = 249.27'
 Yc = 14.26'
 L.T. = 166.92'
 S.T. = 83.57'
 L.C. = 249.67'
 P = 3.57'
 K = 124.88'

③
 THETA-S = 9°49'18.8"
 Ls = 250'
 Xc = 249.27'
 Yc = 14.26'
 L.T. = 166.92'
 S.T. = 83.57'
 L.C. = 249.67'
 P = 3.57'
 K = 124.88'

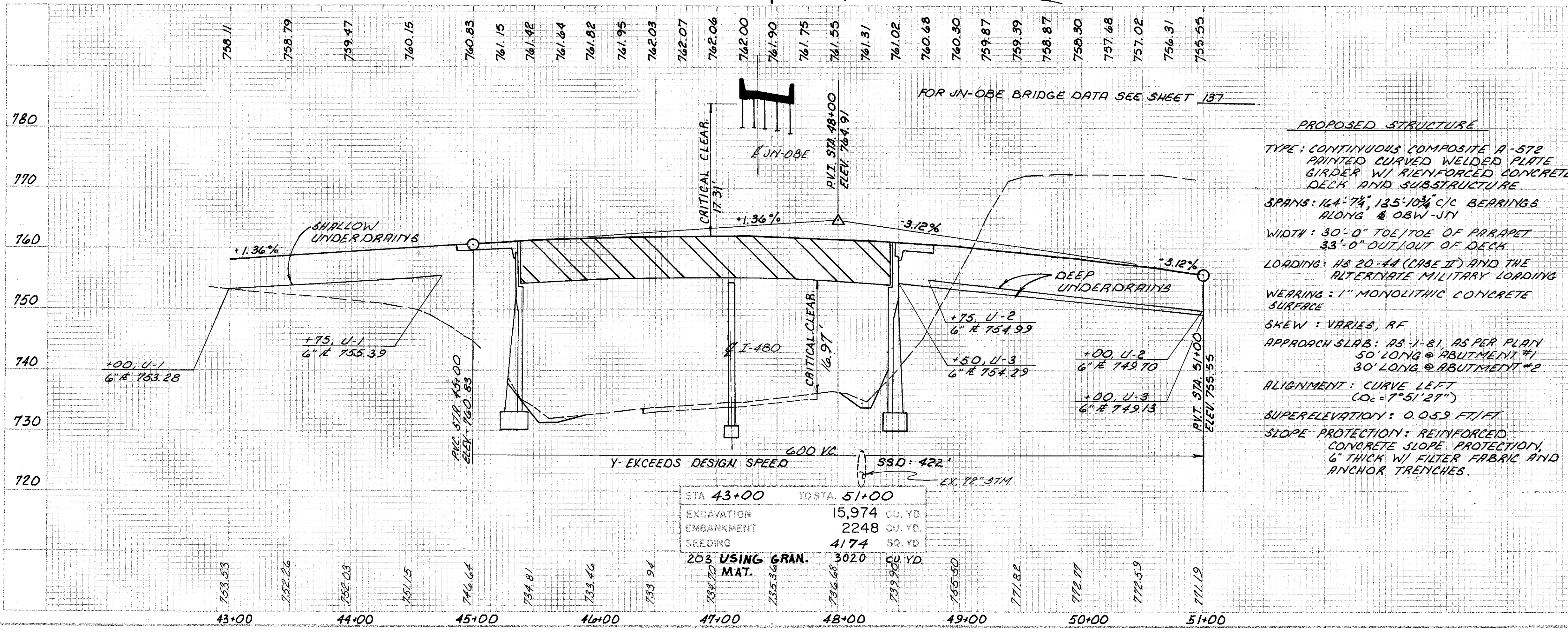
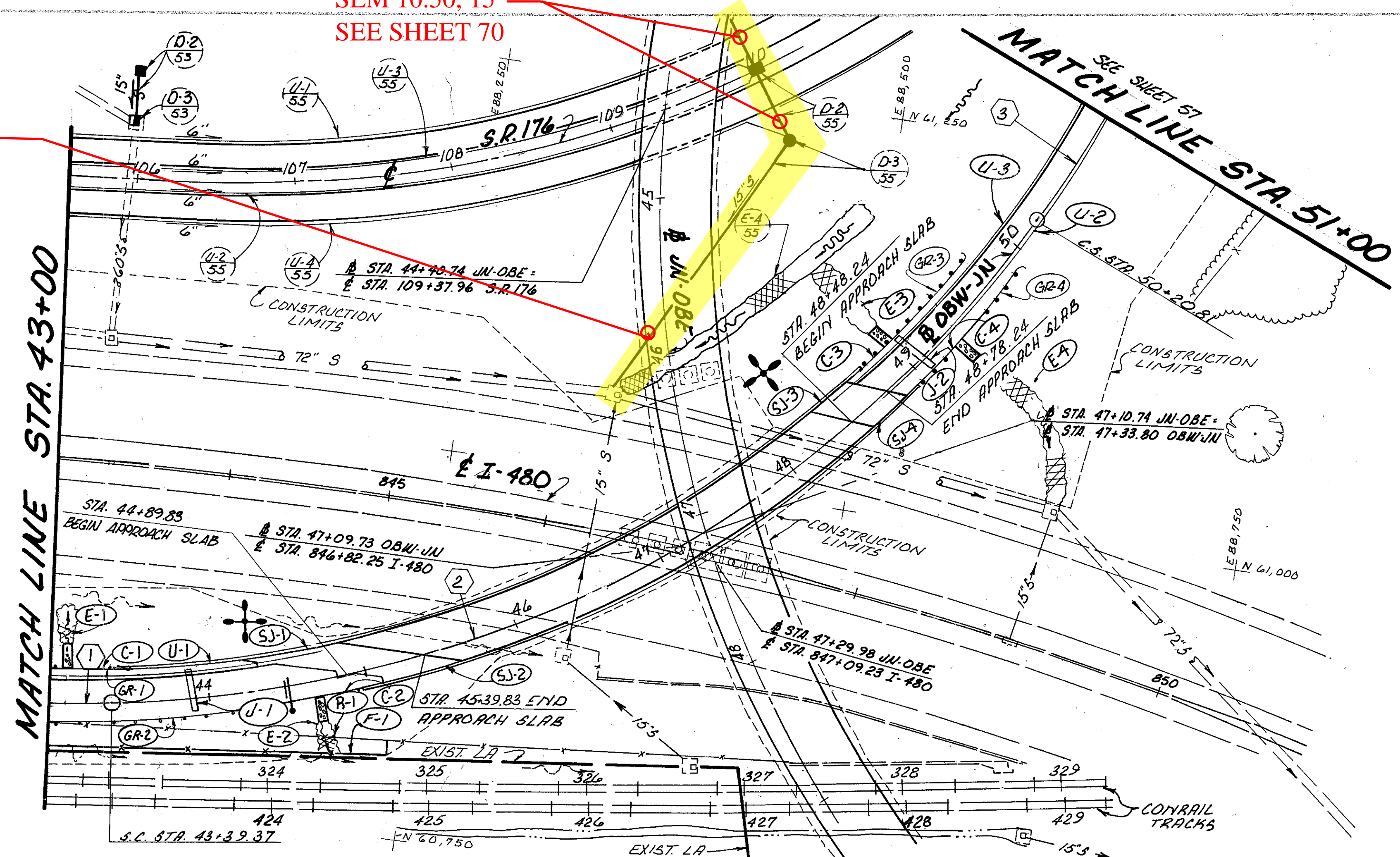
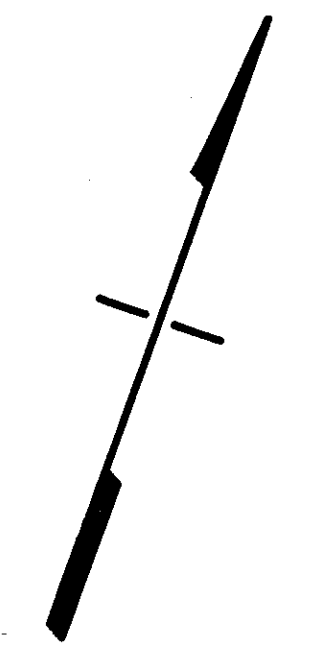

REFERENCES

QUANTITIES FOR REFERENCED ITEMS	87
BRIDGE PLANS	314-336
ADDITIONAL LEGEND ITEMS	2
PIPE PROFILES	69 & 70

PROPOSED STRUCTURE

TYPE: CONTINUOUS COMPOSITE A-572
 PAINTED CURVED WELDED PLATE
 GIRDER W/ REINFORCED CONCRETE
 DECK AND SUBSTRUCTURE

SPANS: 14'-7", 13'-10" C/C BEARINGS
 ALONG & OBW-S1Y

WIDTH: 30'-0" TO/TOE OF PARAPET
 33'-0" OUT/OUT OF DECK

LOADING: HS 20-44 (CRAB II) AND THE
 ALTERNATE MILITARY LOADING

WEARING: 1" MONOLITHIC CONCRETE
 SURFACE

SKIEW: VARIES, RF

APPROACH SLAB: AS 1-81, AS PER PLAN
 50' LONG @ ABUTMENT #1
 30' LONG @ ABUTMENT #2

ALIGNMENT: CURVE LEFT
 (Dc = 7°51'27")

SUPERELEVATION: 0.059 FT/FT

SLOPE PROTECTION: REINFORCED
 CONCRETE SLOPE PROTECTION,
 6" THICK W/ FILTER FABRIC AND
 ANCHOR TRENCHES.

RELOC. S.R. 176