

BENCHMARK: TBM 83 CURVELED "Y" ON NORTH  
EDGE CONCRETE MEDIAN AT N. BOUND RAMP  
STA. 28+75.1, 40.11 N. OF E. MON. BOX  
ELEV. 730.81

BENCHMARK: TBM 84 CURVELED "Y" N. EDGE  
CONCRETE MEDIAN AT N. BOUND RAMP STA. 24+98.2  
OPP. BROOKLYN APTS. GREENHOUSE  
ELEV. 742.84

**CURVE DATA**

PI. STA. 93+33.70  
Δ = 1°36'00"  
Dc = 0°30'00"  
R = 11459.16'  
T = 160.01'  
L = 320.00'  
CH = 319.99'  
E = 1.12'  
M = 1.12'

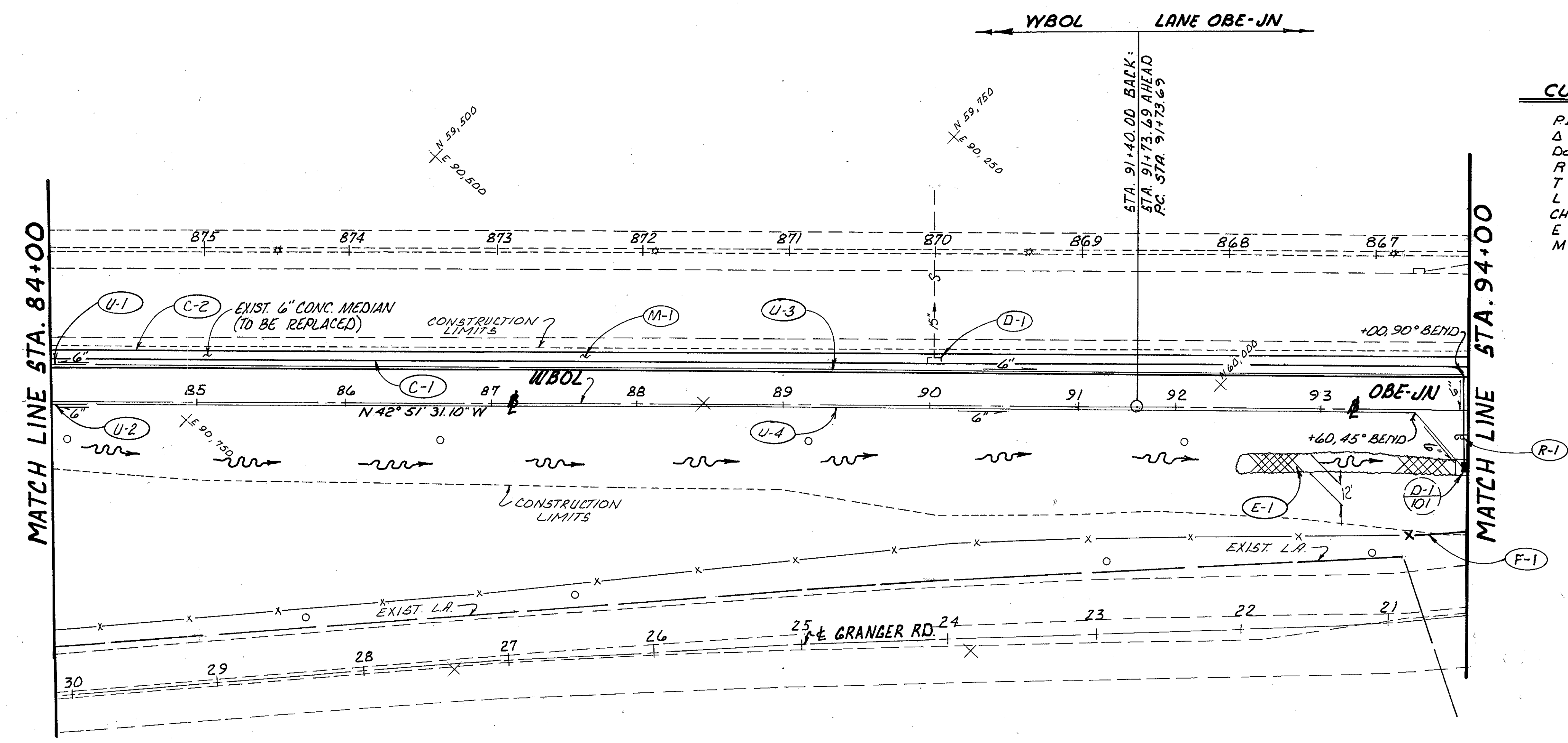

(D-1) STA. 90+03, 29' LT. WBOL  
INLET ADJUSTED TO GRADE  
EXIST. T/C = 729.98 T/C = 730.14

REFERENCE SHEET NUMBERS  
QUANTITIES FOR REFERENCED ITEMS... 100

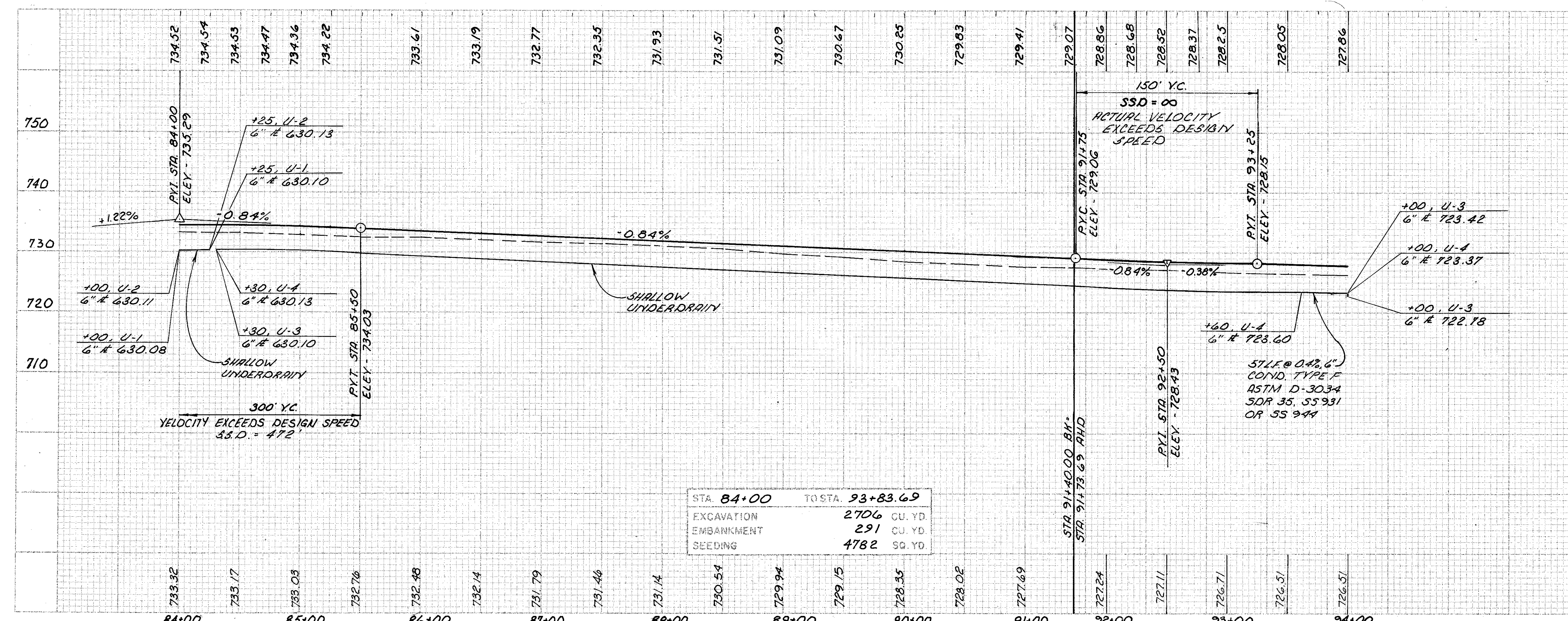

WBOL & LANE OBE - JN PLAN & PROFILE STA. 84+00 TO STA. 94+00

RELOC. S.R. - 176