

BENCHMARK: TBM 49 CHISELED 'X'
TOP CURB S.E. CORNER SIDEWALK AT S.E.
CORNER INTERSECTION OF TUXEDO AND S.R.17
ELEV. 749.12

CURVE DATA

①	②	③	④
PI. STA. 93+33.70	PI. STA. 99+76.19	PI. STA. 93+33.70	PI. STA. 99+76.19
Δ = 1° 36' 0"	Δ = 11° 30' 0"	Δ = 1° 36' 0"	Δ = 11° 30' 0"
Dc = 0° 30' 0"	Dc = 3° 0' 0"	Dc = 0° 30' 0"	Dc = 3° 0' 0"
R = 1459.16'	R = 1909.86'	R = 1459.16'	R = 1909.86'
T = 160.01'	T = 192.31'	T = 160.01'	T = 192.31'
L = 320.00'	L = 383.33'	L = 320.00'	L = 383.33'
CH = 319.99'	CH = 382.69'	CH = 319.99'	CH = 382.69'
E = 1.12'	E = 9.66'	E = 1.12'	E = 9.66'
M = 1.12'	M = 9.61'	M = 1.12'	M = 9.61'
THETA = 3° 45' 0"	THETA = 16° 0' 0"	THETA = 3° 45' 0"	THETA = 16° 0' 0"
LS = 250'	LS = 400'	LS = 250'	LS = 400'
Xc = 249.89'	Xc = 249.89'	Xc = 249.89'	Xc = 249.89'
Yc = 5.45'	Yc = 5.45'	Yc = 5.45'	Yc = 5.45'
LT = 166.70'	LT = 166.70'	LT = 166.70'	LT = 166.70'
ST = 83.37'	ST = 83.37'	ST = 83.37'	ST = 83.37'
LC = 249.95'	LC = 249.95'	LC = 249.95'	LC = 249.95'
P = 136'	P = 136'	P = 136'	P = 136'
H = 124.98'	H = 124.98'	H = 124.98'	H = 124.98'

DRAINAGE STRUCTURE DATA

- (D-1) STA. 94+00, 40' RT. OBE-JN
C.B. 17" x 5 A.P.P. T/G = 724.00
- (D-2) STA. 94+88, 20' RT. OBE-JN
C.B. RECONSTRUCTED TO GRADE
AS PER PLAN. EX. T/G = 726.60 T/G = 726.03
- (D-3) STA. 100+53, 30.5' LT. OBE-JN
INLET NO. 2-A-8 (SEE PROPOSAL NOTE)
T/G = 724.62
- (D-4) STA. 102+38, 21' RT. OBE-JN
C.B. ADJ. TO GRADE T/G = 722.33 EX. 722.45
- (D-5) STA. 102+39, 36' LT. OBE-JN
C.B. 17" x 5 A.P.P. T/G = 722.51
- (D-6) STA. 100+70, 6.4' RT. OBE-JN
CATCH BASIN REMOVED
- (D-7) STA. 100+99, 8.4' RT. OBE-JN
PULL BOX REMOVED AND REPLACED
T/G = 725.00 EX. T/G = 723.74
- (D-8) STA. 94+84, 40' LT. OBE-JN
INLET ADJUSTED TO GRADE
EXIST. T/G = 726.99 T/G = 726.79
- (D-9) STA. 96+05, 29' LT. OBE-JN
INLET ADJUSTED TO GRADE
EXIST. T/G = 726.49 T/G = 726.14
- (D-10) STA. 96+64, 29' LT. OBE-JN
INLET ADJUSTED TO GRADE
EXIST. T/G = 726.02 T/G = 725.77
- (D-11) STA. 96+23, 38' LT. OBE-JN
PULL BOX REMOVED & REPLACED
EXIST. T/G = 726.95 T/G = 726.66
- (D-12) STA. 96+30, 15' RT. OBE-JN
PULL BOX REMOVED & REPLACED
EXIST. T/G = 727.54 T/G = 727.08

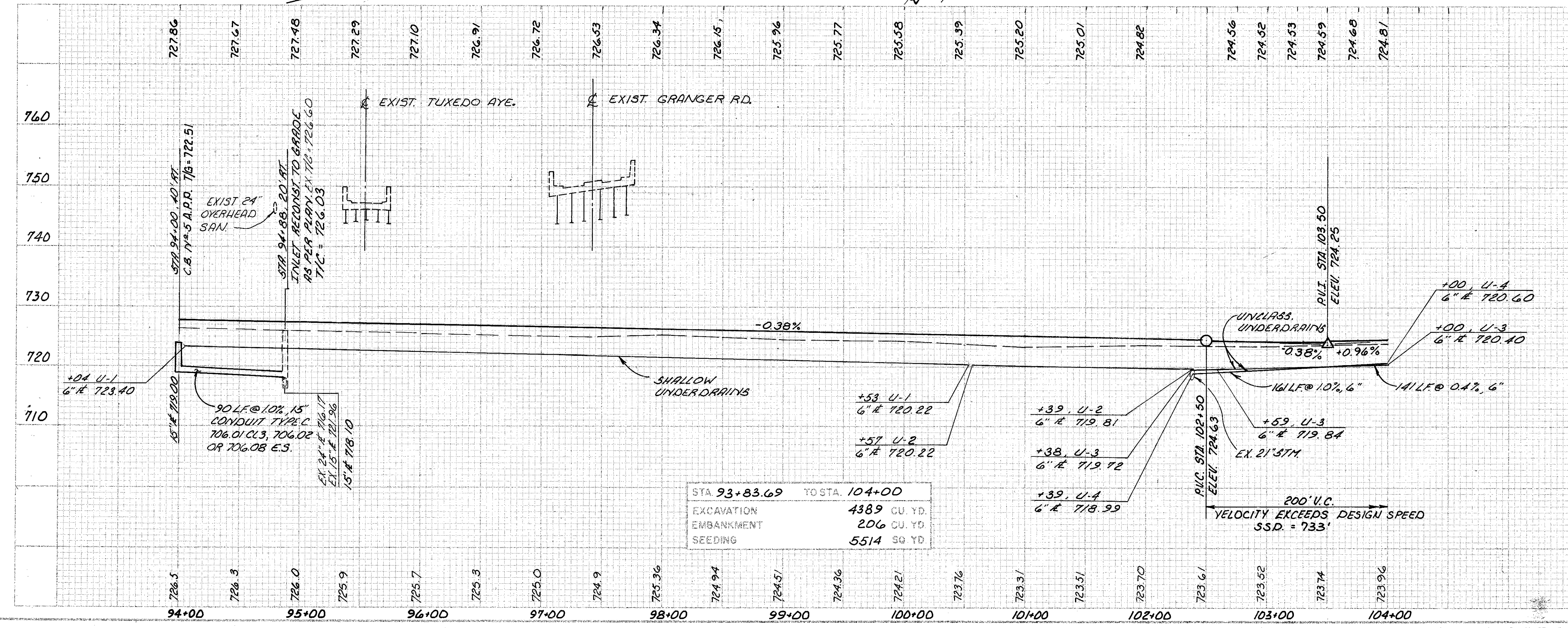
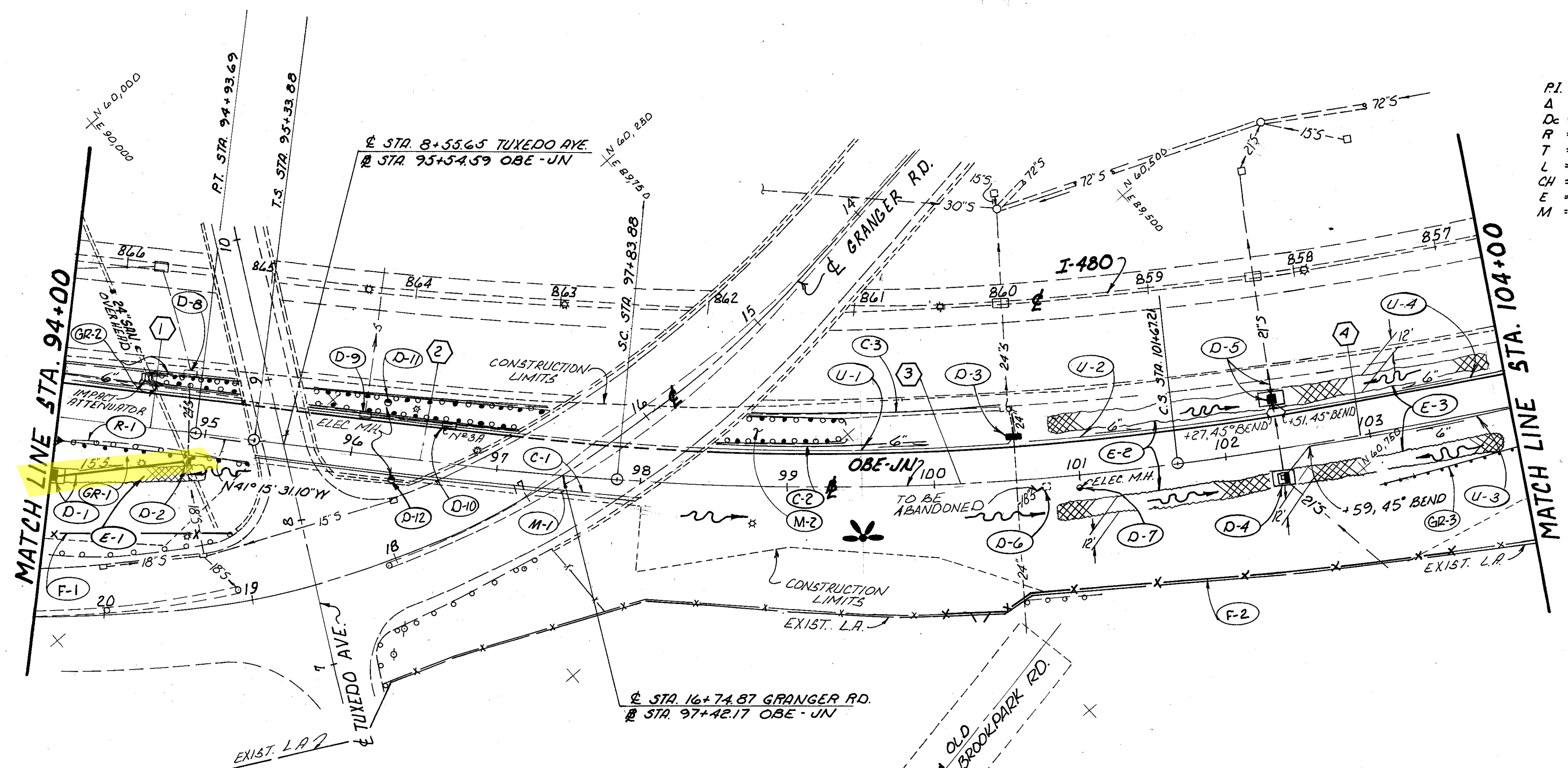

STA 93+83.69	TO STA. 104+00
EXCAVATION	4389 CU. YD.
EMBANKMENT	206 CU. YD.
SEEDING	5514 SQ. YD.

REFERENCES	SHEET NUMBERS
QUANTITIES FOR REFERENCED ITEMS ...	102
PIPE PROFILES	113

RELOC. S.R. - 176