

**GPD GROUP**  
 Glaus, Pyle, Schomer, Burns & DeLaven, Inc.  
 320 South Main Street, Suite 2531  
 Akron, OH 44311  
 330.572.2100 Fax: 330.572.2102  
 Copyright: Glaus, Pyle, Schomer, Burns & DeLaven, Inc. 2015

42" Min slope for 3 fps = 0.12%

42" Full Flow @ 0.4% = 5.7 fps

REV#	DATE	REMARKS
1	1/13/16	DD SUBMITTAL
2	2/04/16	DD REVISIONS
3	4/22/16	DD REVISIONS

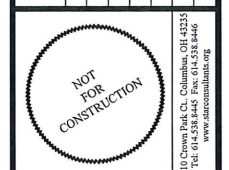

**STAR CONSULTANTS, INC.**  
 ARCHITECTS & ENGINEERS  
 design | strategy | vision

OHIO DEPARTMENT OF TRANSPORTATION DOT-14006.1

**ODOT MAINTENANCE FACILITY**  
 3263 EAST 44TH STREET  
 CLEVELAND, OHIO 44127

UTILITY PLAN

PJT #: 2015204.01  
 DATE: REVIEW 1.13.16  
 DRN BY: BK  
 DGN BY: TS  
 REV BY: BP

SHEET  
**C5.4**

- PROPOSED STRUCTURES**
- ST 21 PROPOSED STORM MANHOLE (SEE DETAIL 16, SHEET C6.1)  
RIM=658.95  
INV. 42" (NW)=646.47  
INV. 42" (SE)=646.47
  - ST 22 PROPOSED STORM MANHOLE (SEE DETAIL 16, SHEET C6.1)  
RIM=657.04  
INV. 42" (NW)=646.22  
INV. 42" (E)=646.22

- EXISTING STRUCTURES**
- EX 1 EXISTING STORM CATCH BASIN  
RIM=657.95  
INV. (SW)=654.11  
PER ODOT DEVELOPMENT PLANS
  - EX 2 EXISTING STORM CATCH BASIN  
RIM=657.95  
INV. (NE,SE)=653.71  
PER ODOT DEVELOPMENT PLANS
  - EX 3 EXISTING STORM CATCH BASIN  
RIM=NOT PROVIDED  
INV. (SW)=NOT PROVIDED  
PER ODOT DEVELOPMENT PLANS
  - EST 4 EXISTING STORM MANHOLE  
RIM=664.42  
INV. 42" RCP (S)=646.15  
INV. 42" RCP (N)=646.55  
INV. 12" SMP (NE)=659.61
  - EX 5 EXISTING SANITARY MANHOLE  
RIM=678.00  
INV. 12" VCP (N)=668.71  
INV. 12" VCP (S)=668.71
  - EX 6 EXISTING SANITARY MANHOLE  
RIM=674.21  
INV. 12" VCP (N)=669.31  
INV. 12" VCP (E)=669.41
  - EX 7 EXISTING SANITARY MANHOLE  
RIM=674.75  
INV. 12" VCP (W)=669.52  
PROPOSED CL 6" HDPE (E)=671.00

**Underground Utilities**

2 Working Days Before You Dig  
 Call 800-362-2764 (Toll Free)  
 Ohio Utilities Protection Service

Non-members Must Be Called Directly

Call 800-925-0988 (Toll Free)  
 Oil & Gas Producers Utility Protection Service

**BENCHMARKS:**

UPDATE ELEVATION TIE-IN OR BASIS OF BEARING.

BENCHMARK #1 N 657534.8687 E 2198816.8364 ELEVATION=677.30	BENCHMARK #2 N 656896.57 E 2199053.3086 ELEVATION=677.30
---	---

**LEGEND**  
 (SEE SHEET C1.0 FOR GENERAL LEGEND)

ST	PROPOSED STORM SEWER
SAN	PROPOSED SANITARY SEWER
W	PROPOSED WATER SERVICE
GAS	PROPOSED GAS SERVICE
E	PROPOSED ELECTRIC SERVICE
T	PROPOSED TELEPHONE SERVICE
C	PROPOSED CABLE SERVICE
D.S.	PROPOSED DOWNSPOUT
A #	APPURTENANCES
#	UTILITY CONSTRUCTION KEYNOTE
- - -	PROPOSED DETENTION BASIN

**CONSTRUCTION KEYNOTES**

DRL 5/31/16

CUYAHOGA COUNTY  
C.U.Y. 21-13.20

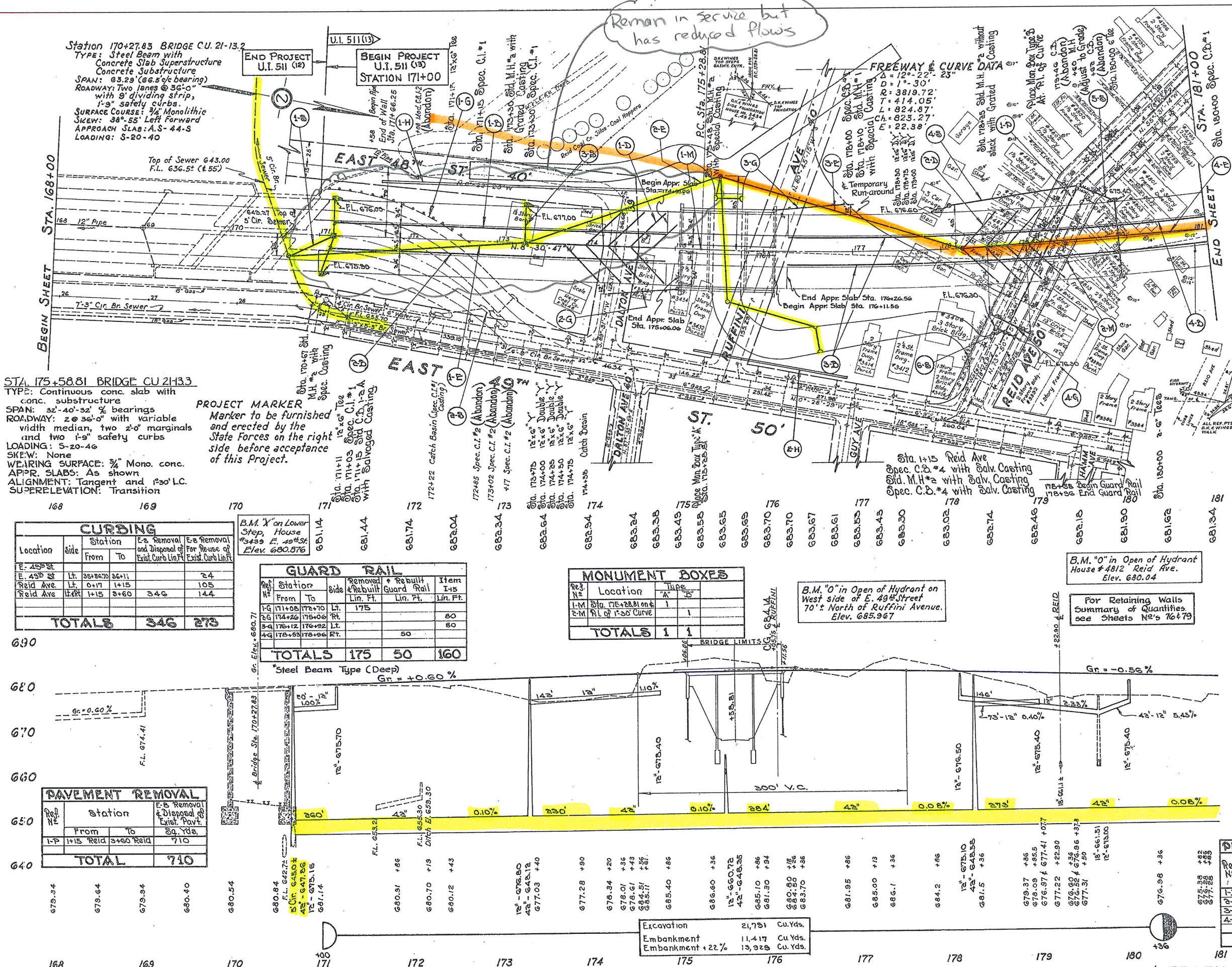

Station 170+27.83 BRIDGE C.U. 21-13.2  
TYPE: Steel Beam with Concrete Slab Superstructure  
Concrete Substructure  
SPAN: 63.29' (66.5' bearing)  
ROADWAY: Two lanes @ 36'-0" with 9' dividing strip, 1-9' safety curbs.  
SURFACE COURSE: 3/4" Monolithic  
SKEW: 38°-55' Left Forward  
APPROACH SLAB: A.S.-44-S  
LOADING: S-20-40

STA. 175+58.81 BRIDGE C.U. 21-13.3  
TYPE: Continuous conc. slab with conc. substructure  
SPAN: 32'-40'-32' % bearings  
ROADWAY: 2 @ 36'-0" with variable width median, two 2'-0" marginals and two 1-9" safety curbs  
LOADING: S-20-40  
SKEW: None  
WEARING SURFACE: 3/4" Mono. conc.  
APPR. SLABS: As shown  
ALIGNMENT: Tangent and 130' L.C.  
SUPERELEVATION: Transition

PROJECT MARKER  
Marker to be furnished and erected by the State Forces on the right side before acceptance of this Project.

CURBING					
Location	Side	Station		E.S. Removal and Disposal of Exst. Curb Lin. Ft.	E.S. Removal and Disposal of Exst. Curb Lin. Ft.
		From	To		
E. 49th St.	Lt.	35+60	36+11		24
Reid Ave.	Lt.	0+17	1+15		105
Reid Ave.	Rt.	1+15	3+60	346	144
<b>TOTALS</b>				<b>346</b>	<b>273</b>

GUARD RAIL				
Station	Side	Removed + Rebuilt		Item I-15 Lin. Ft.
		Lin. Ft.	Lin. Ft.	
171+00	Lt.	175		80
172+20	Rt.			80
173+00	Lt.		50	
174+00	Rt.			50
<b>TOTALS</b>		<b>175</b>	<b>50</b>	<b>160</b>

MONUMENT BOXES			
Res. No.	Location	Type	Qty
I-M	Sta. 175+28.81 on E. 49th St. of 130' Curve	1	1
<b>TOTALS</b>		<b>1</b>	<b>1</b>

PAVEMENT REMOVAL				
Station	Side	E.S. Removal and Disposal of Exst. Pavt. Sq. Yds.		
		From	To	
1+15	Reid	3+60	Reid	710
<b>TOTAL</b>				<b>710</b>

PIPE UNDERDRAIN (HERRINGBONE)					
Station	Side	Pipe Size	Pipe		Pipe Specials
			Lin. Ft.	6" Tee	
173+30	Lt.	18"	444	2	
174+75	Rt.	18"	464	67	
178+25	Rt.	18"	464	67	
<b>TOTALS</b>			<b>908</b>	<b>200</b>	<b>2</b>

STORM SEWER					
Station	Side	Pipe Size	Pipe		Location of Structure
			Lin. Ft.	Each	
170+67	Rt.	48"	214	1	170+67
173+30	Lt.	116"	114	1	173+30
173+48	Lt.	137"	147	1	173+48
178+25	Rt.	48"	275	1	178+25
<b>TOTALS</b>			<b>572</b>	<b>4</b>	<b>4</b>

STORM SEWER					
Station	Side	Pipe Size	Pipe		Location of Structure
			Lin. Ft.	Each	
170+67	Rt.	48"	214	1	170+67
173+30	Lt.	116"	114	1	173+30
173+48	Lt.	137"	147	1	173+48
178+25	Rt.	48"	275	1	178+25
<b>TOTALS</b>			<b>572</b>	<b>4</b>	<b>4</b>

PIPE UNDERDRAIN (BLANKET COURSE)					
Station	Side	Pipe Size	Pipe		Pipe Specials
			Lin. Ft.	6" Tee	
171+15	Lt.	18"	374		
171+17	Rt.	18"	370		
176+25	Lt.	18"	744	75	
180+00	Rt.	18"	196		
<b>TOTALS</b>			<b>1692</b>	<b>75</b>	<b>3</b>

PLAN & PROFILE STA. 168+00 TO STA. 181+00

DEL 5/3/16