

# SCHEMATIC GEOMETRIC PLAN

FED. RD. DIVISION	STATE	PROJECT
2	OHIO	

2  
646

CUYAHOGA COUNTY  
 CUY-71-17.83  
 CUY-176-12.76

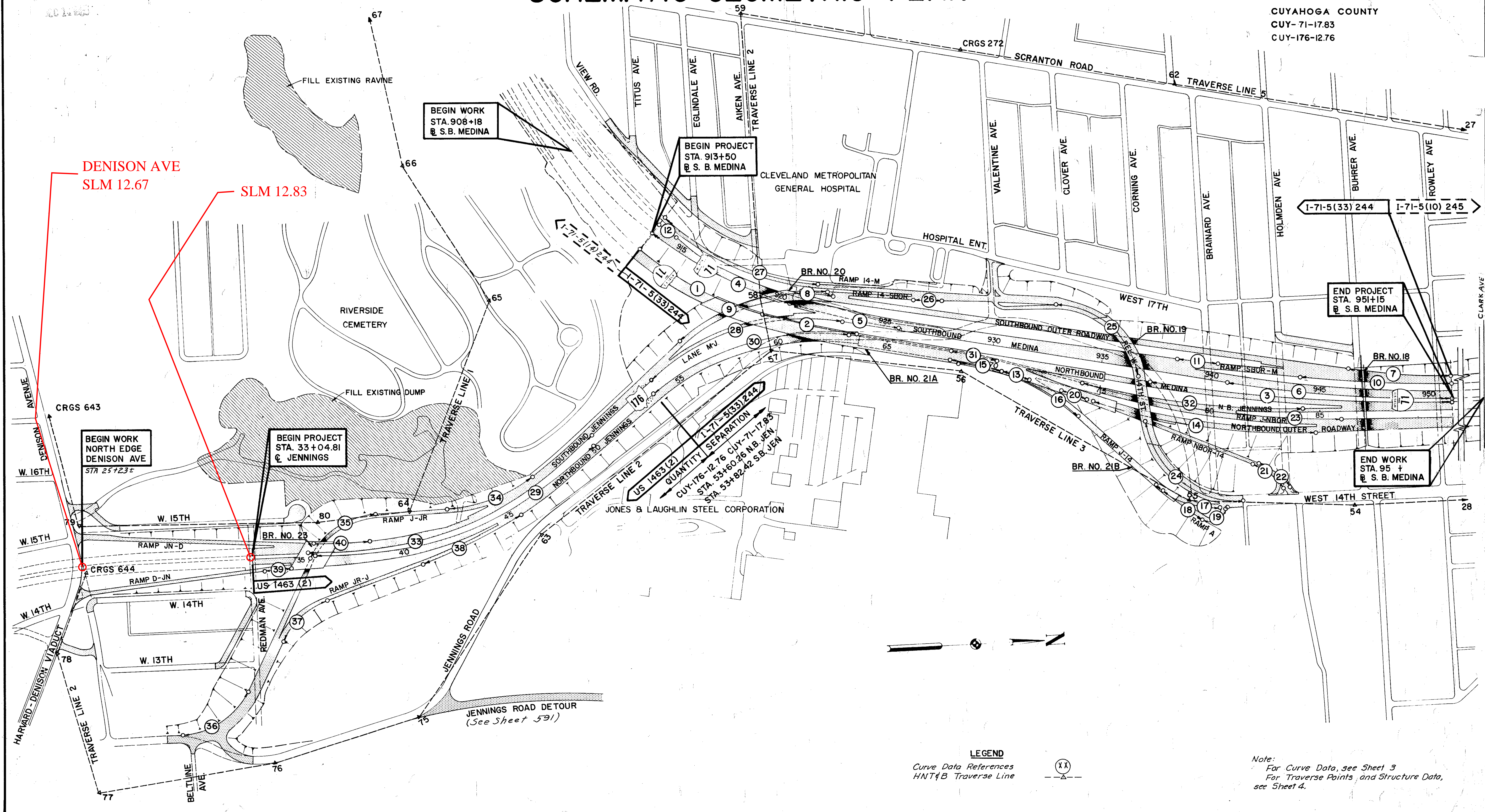

DENISON AVE  
 SLM 12.67

SLM 12.83

BEGIN WORK  
 STA. 908+18  
 @ S.B. MEDINA

BEGIN PROJECT  
 STA. 913+50  
 @ S. B. MEDINA

BEGIN WORK  
 NORTH EDGE  
 DENISON AVE  
 STA. 25+23±

BEGIN PROJECT  
 STA. 33+04.81  
 @ JENNINGS

END PROJECT  
 STA. 951+15  
 @ S. B. MEDINA

END WORK  
 STA. 95 +  
 @ S. B. MEDINA

US 1463 (2)  
 QUANTITY SEPARATION  
 CUY-176-12.76 CUY-71-17.85  
 STA. 53+60.26 NB JEN.  
 STA. 53+82.42 SB. JEN.



**LEGEND**  
 Curve Data References  
 HNT&B Traverse Line

Note:  
 For Curve Data, see Sheet 3  
 For Traverse Points, and Structure Data,  
 see Sheet 4.

SCALE 1" = 200'  
 HOWARD, NEEDLES, TAMMEN & BERGENDOFF  
 MADE BY DATE 12-1-64 CONSULTING ENGINEERS  
 TRCD. R.L.K. DATE 4-12-64  
 CKD. R.P.R. DATE 12-2-64 KANSAS CITY CLEVELAND NEW YORK