

CUYAHOGA COUNTY
MED-42-26.17
CUY-42-0.00

ESTIMATED QUANTITIES

E-3 Channel Excavation	78 C.Y.
I-1 42" Class A-1 Pipe Sec. M 6.6(d)	268 L.F.
I-2 Masonry	1494 C.Y.
I-10 Dumped Rock	11 C.Y.
L-10 Sodding	16 S.Y.

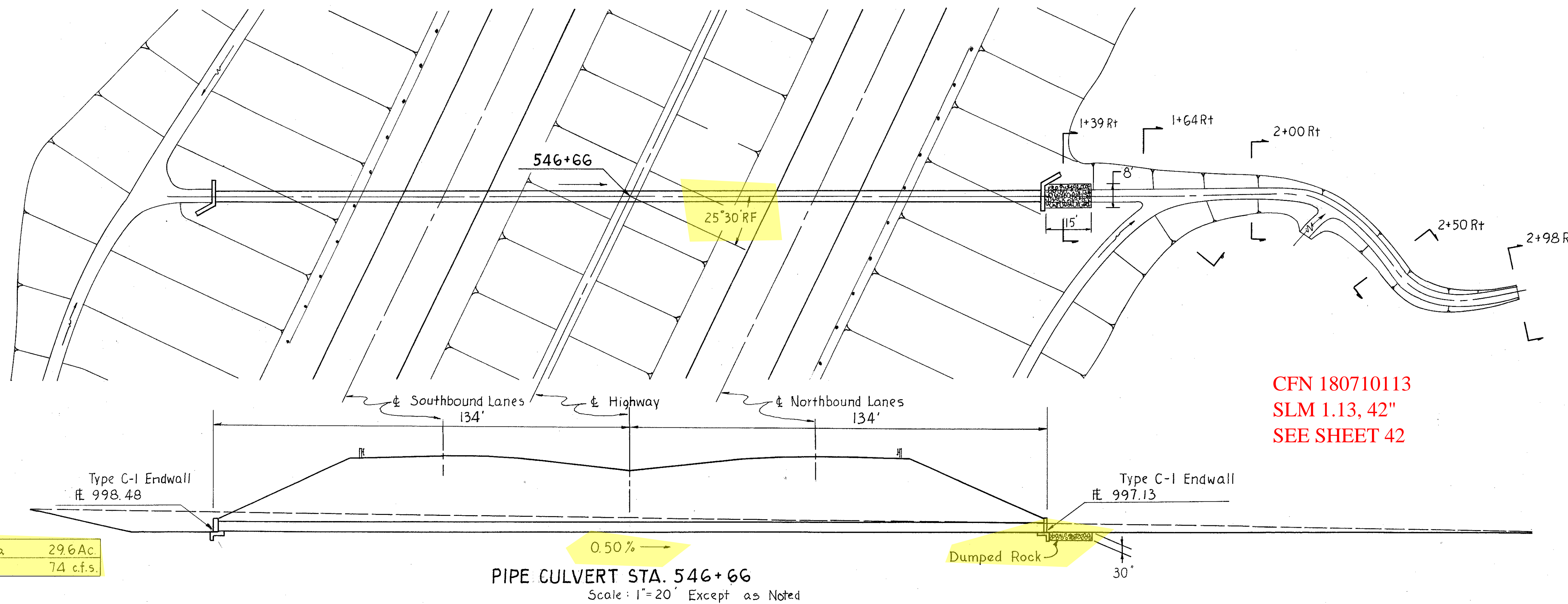

Area	29.6 Ac.
Q50	74 c.f.s.

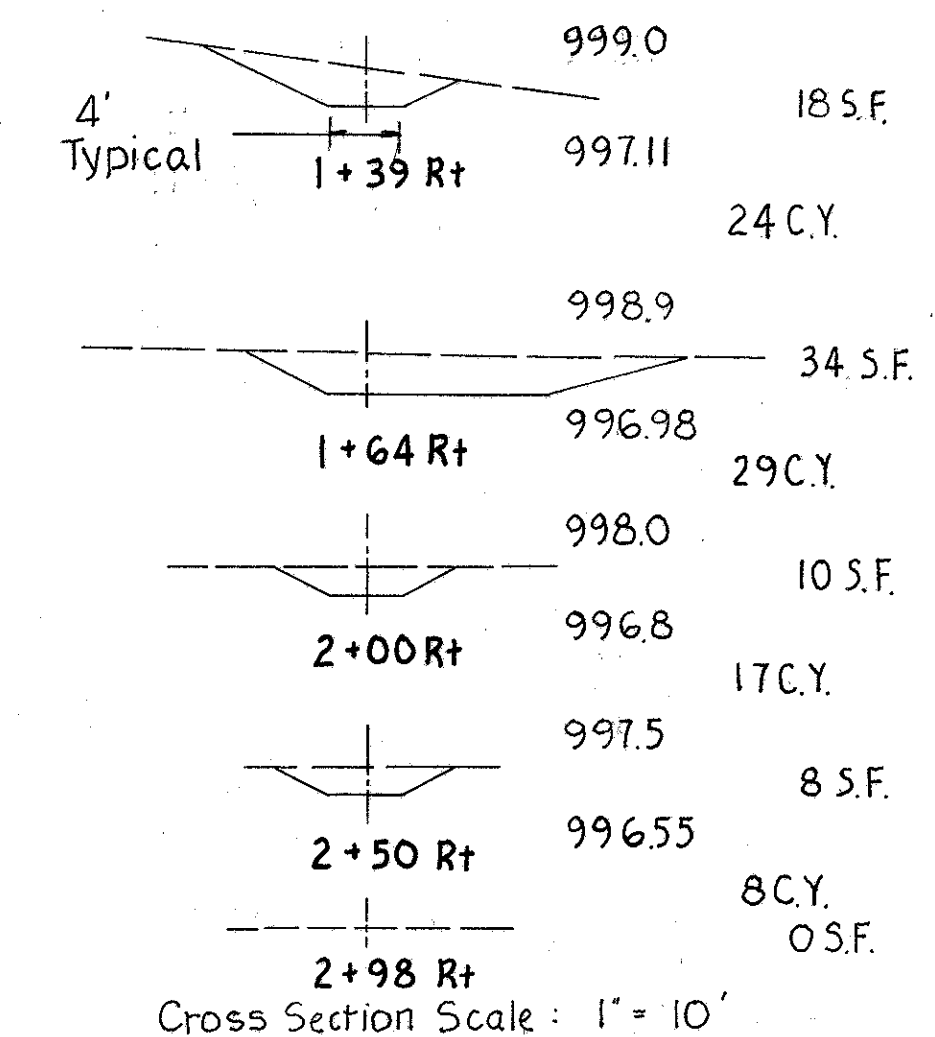

ESTIMATED QUANTITIES

E-3 Channel Excavation	222 C.Y.
I-1 30" Class A-1 pipe Sec. M 6.6(c)	214 L.F.
I-2 Masonry	6,020 C.Y.
L-10 Sodding	16 S.Y.

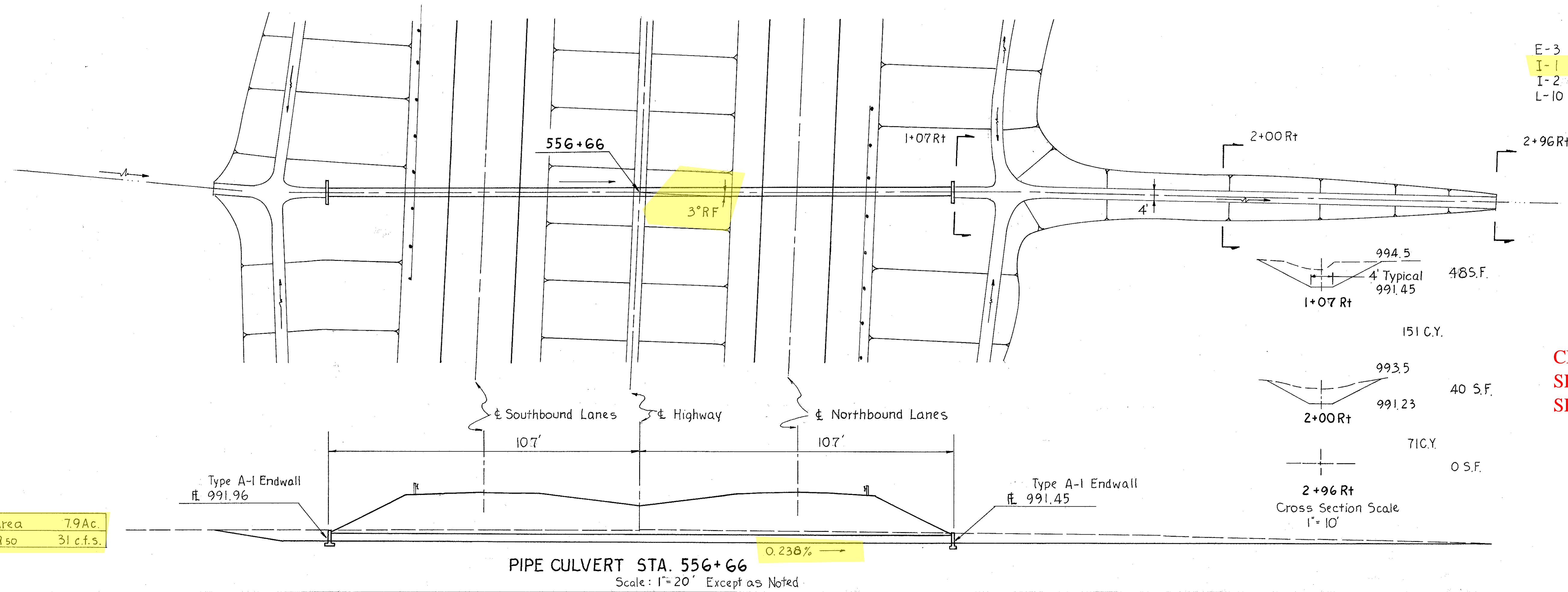

Area	7.9 Ac.
Q50	31 c.f.s.

