

CUYAHOGA COUNTY
MED-42-26.17
CUY-42-0.00

ESTIMATED QUANTITIES

I-1	30" Class A-1 Pipe Sec. M6.6(c)	284 L.F.
I-2	Masonry	6.20 C.Y.
I-10	Dumped Rock	16 C.Y.
L-10	Sodding	16 S.Y.

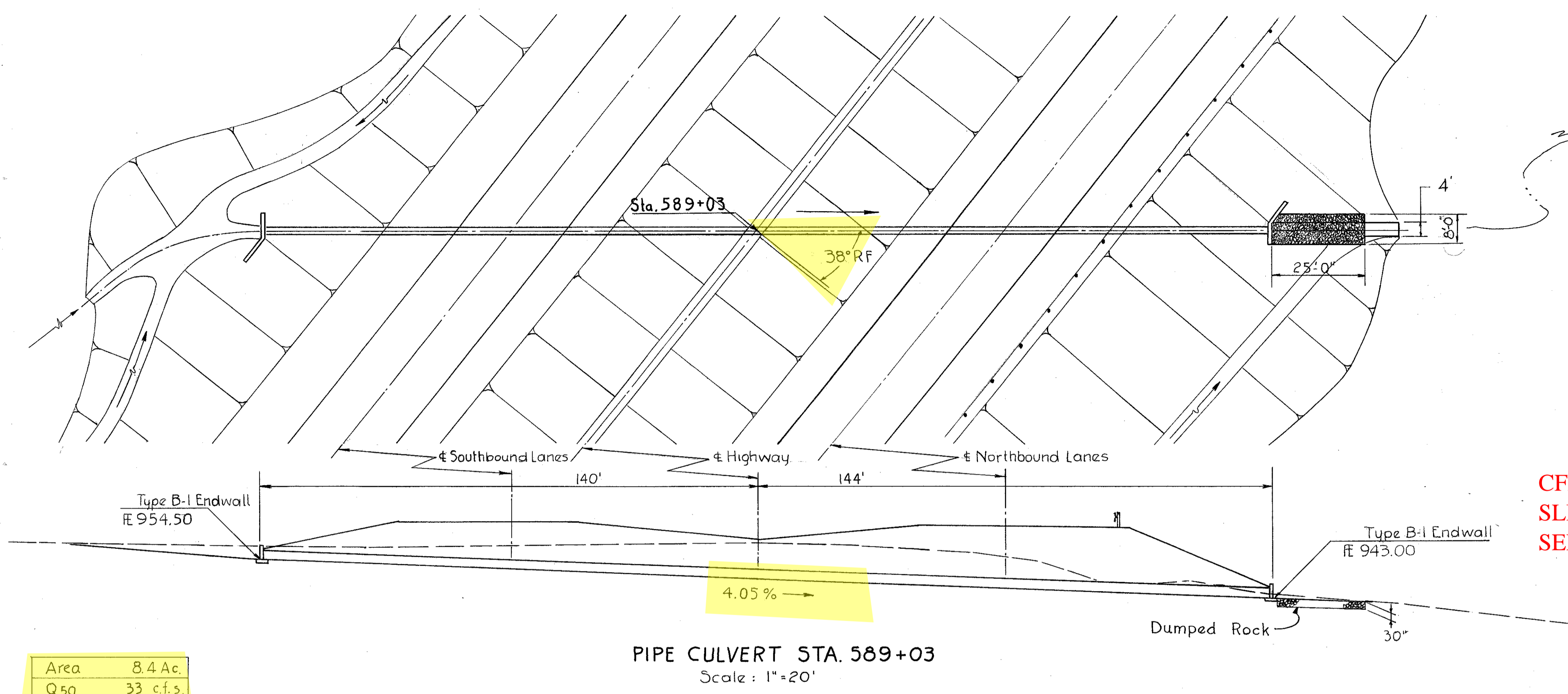

Area	8.4 Ac.
Q50	33 c.f.s.

PIPE CULVERT STA. 589+03
Scale: 1"=20'

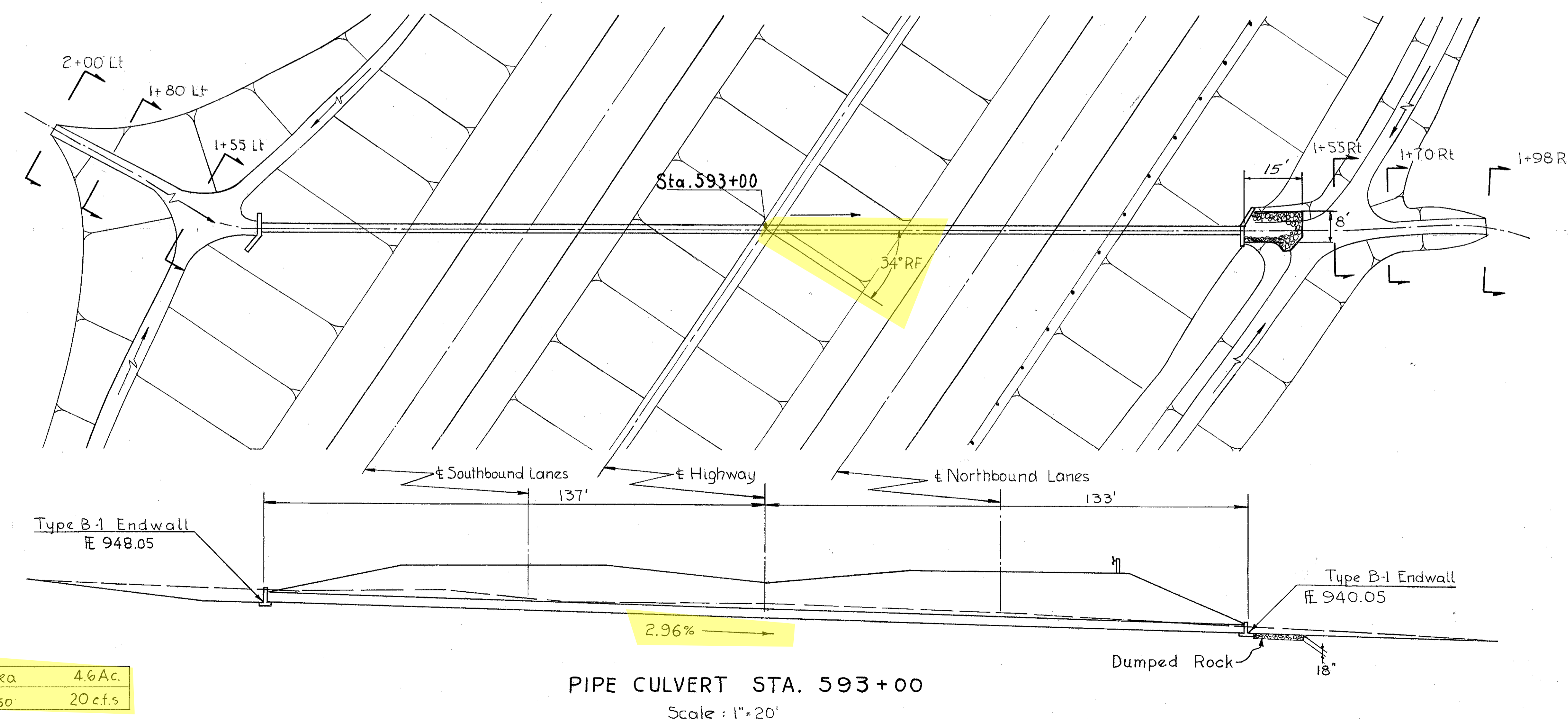

Area	4.6 Ac.
Q50	20 c.f.s.

PIPE CULVERT STA. 593+00
Scale: 1"=20'

ESTIMATED QUANTITIES

E-3	Channel Excavation	22 C.Y.
I-1	24" Class A-1 Pipe Sec. M6.6(b) or M6.8(b)	270 L.F.
I-2	Masonry	3.43 C.Y.
L-10	Sodding	12 S.Y.
I-10	Dumped Rock	7 C.Y.

2+00 Lt.	0 S.F.	1+98 Rt.	0 S.F.
1+80 Lt.	6 C.Y.	1+70 Rt.	6 C.Y.
1+55 Lt.	7 C.Y.	1+55 Rt.	3 C.Y.
	0 S.F.		0 S.F.

4' Typical

Scale: 1"=10'

CFN 180710202
SLM 2.02, 24"
SEE SHEET 46