

SLM 0.93, 15"  
SEE SHEET 74

CURVE # 6  
P.I. 537+92.14  
 $\Delta = 4^{\circ} 51' 06''$   
 $D_c = 0^{\circ} 20'$   
 $R = 17,188.73'$   
 $L = 1,455.50'$   
 $T = 728.19'$   
 $E = 15.42'$

CFN 180710094  
SLM 0.94, 54"  
SEE SHEET 214

SLM 0.99, 15"  
SEE SHEET 216

SLM 1.04, 15"  
SEE SHEET 216  
ABANDONED UNDER  
2001 CUY-71-0.00

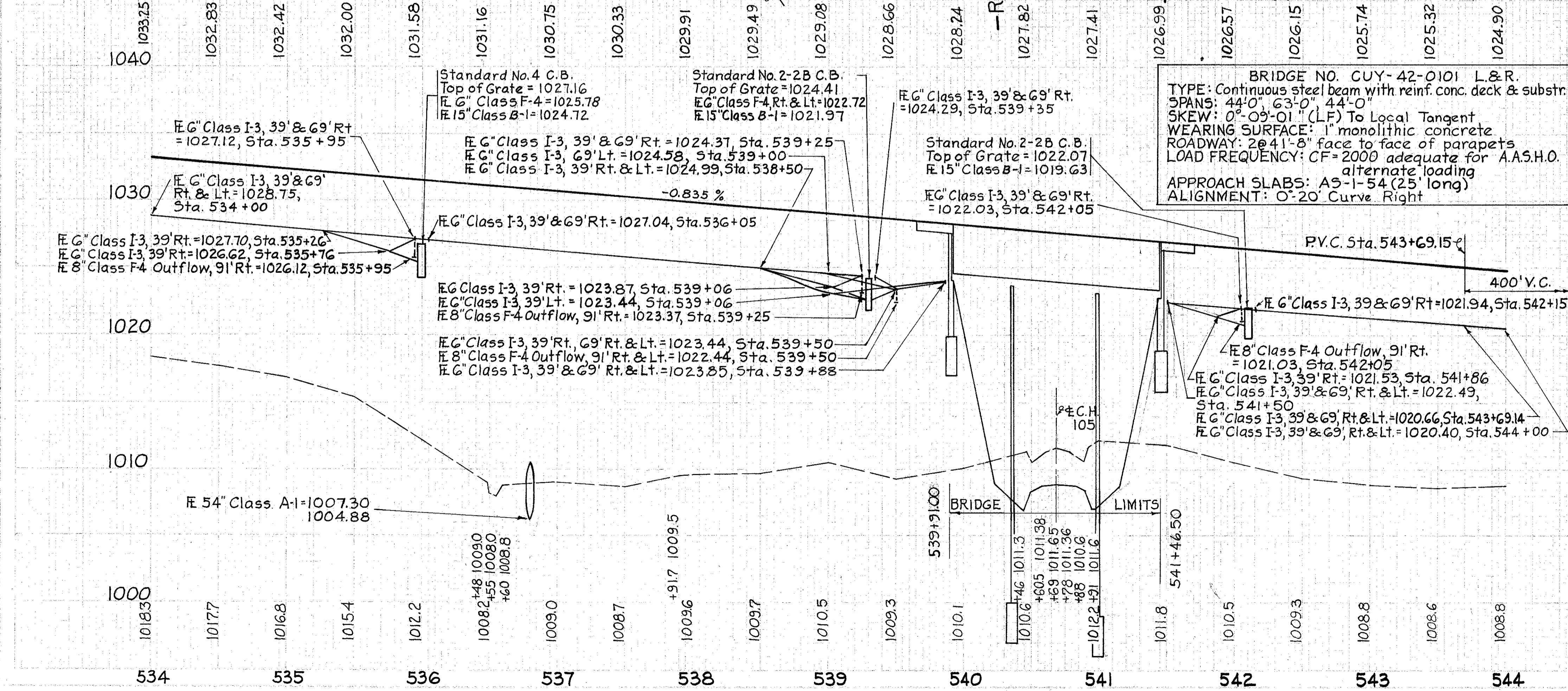
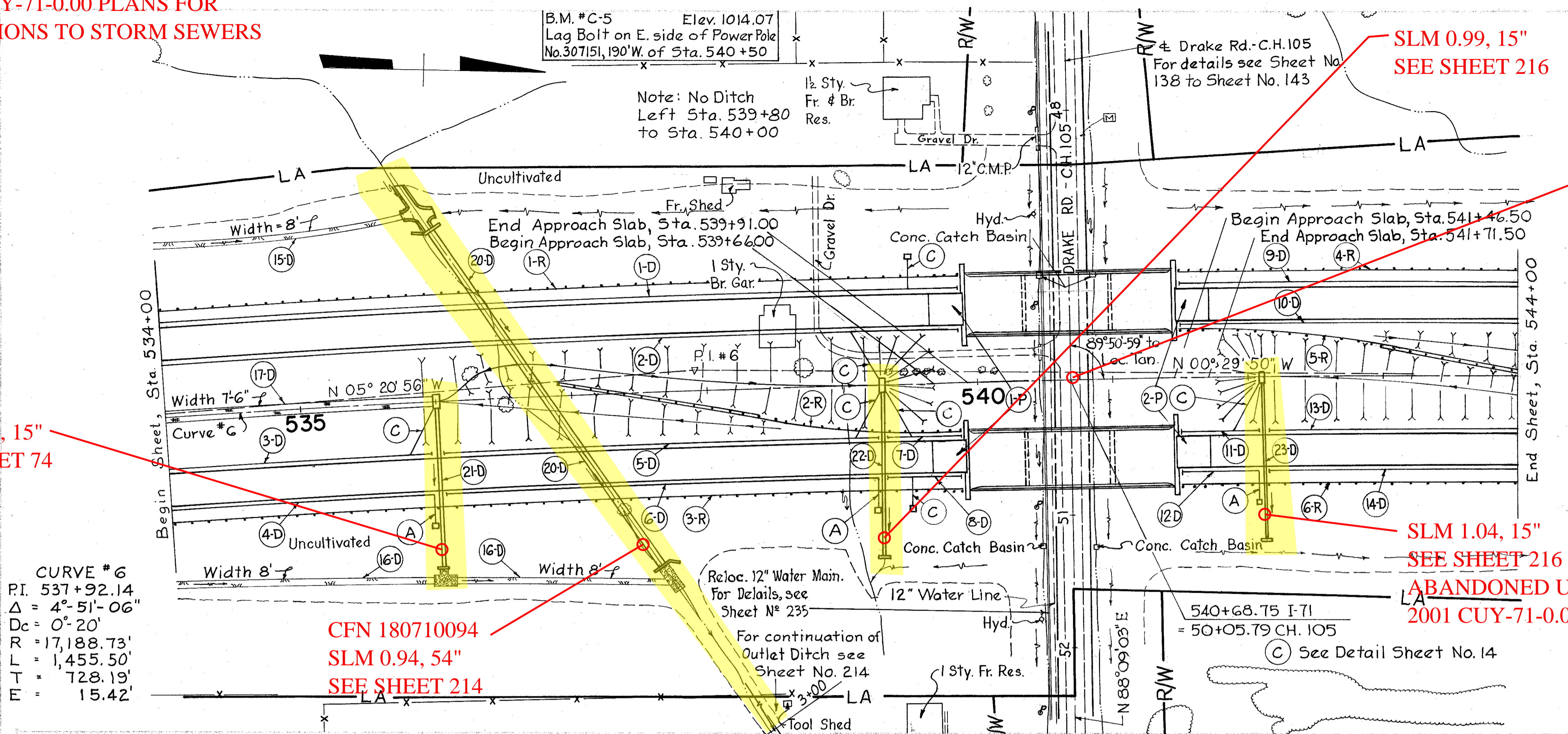

REF NO.	STATION TO STATION	SIDE	Class A-1 Pipe Class	Class A-1 Pipe Class	Class F-4 Pipe	Masonry Headwall	Pipe Specials	I-7	I-8	I-10	I-15	E-3	L-10	L-120	SEE SHEET NO.
1-D	534+00 to 539+88	Lt.	600	10	10	20.92									214
2-D	534+00 to 539+88	Rt.	627	10	10	0.26									74
3-D	534+00 to 535+95	Rt.	229	10	10	0.26									216
4-D	534+00 to 535+95	Rt.	207	10	10	0.26									216
5-D	536+05 to 539+25	Rt.	354	10	10										
6-D	536+05 to 539+25	Rt.	332	10	10										
7-D	539+35 to 539+88	Rt.	87	10	10										
8-D	539+35 to 539+88	Rt.	65	10	10										
9-D	541+50 to 544+00	Lt.	250	10	10										
10-D	541+50 to 544+00	Lt.	250	10	10										
11-D	541+50 to 542+05	Rt.	97	10	10										
12-D	541+50 to 542+05	Rt.	77	10	10										
13-D	542+15 to 544+00	Rt.	185	10	10										
14-D	542+15 to 544+00	Rt.	185	10	10										
15-D	534+00 to 536+00	Lt.													
16-D	534+00 to 536+00	Lt.													
17-D	534+00 to 536+00	Med.													
20-D	536+81	Lt.	296												
21-D	536+00	Rt.													
22-D	535+30	Rt.													
23-D	542+10	Rt.													
1-R	534+00 to 539+91	Lt.													
2-R	536+91 to 539+91	Med.													
3-R	534+00 to 539+91	Rt.													
4-R	541+46.5 to 544+00	Lt.													
5-R	541+46.5 to 544+00	Med.													
6-R	541+46.5 to 544+00	Rt.													
1-P	539+66 to 539+91	Rt.													
2-P	541+46.5 to 541+71.50	Rt.													
TOTALS															