

B.M.*C-10 Elev. 952.56
R.R. Spike in W. side of 8" tree
100' E. of Sta. 592+00

CURVE #7
PI 593+34.87
 $\Delta = 14^{\circ}32'11''$
 $D_c = 0^{\circ}28'$
 $R = 12,277.67'$
 $T = 1,565.88'$
 $L = 3,114.94'$
 $E = 99.45'$

CFN 180710202
SLM 2.02, 24"
SEE SHEET 219

CUYAHOGA COUNTY
MED - 42 - 26.17
CUY - 42 - 0.00

DATE	REV.	BY	CHKD.
2		OHIO	I-71-5(15)233

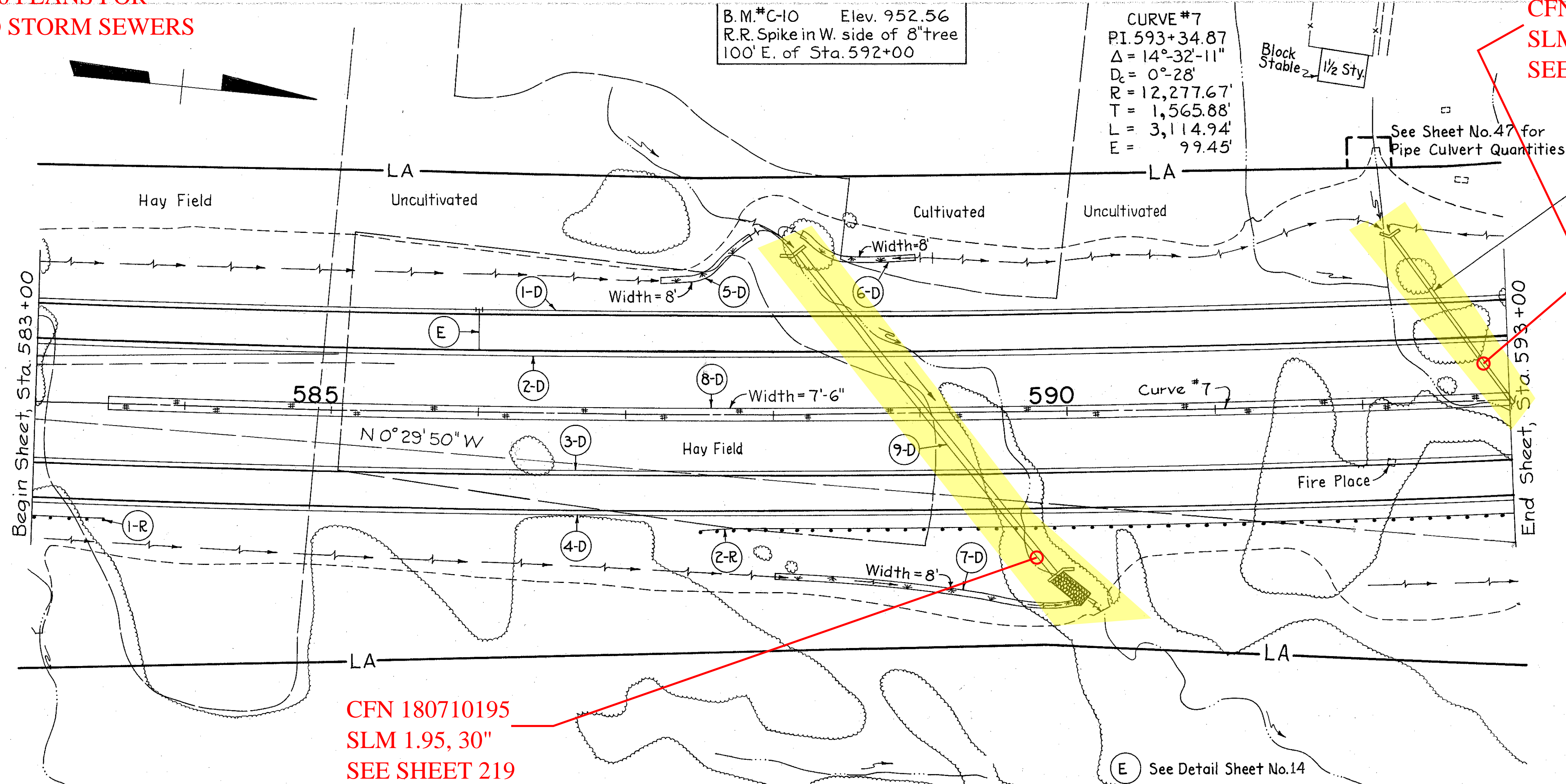

CFN 180710195
SLM 1.95, 30"
SEE SHEET 219

E See Detail Sheet No.14

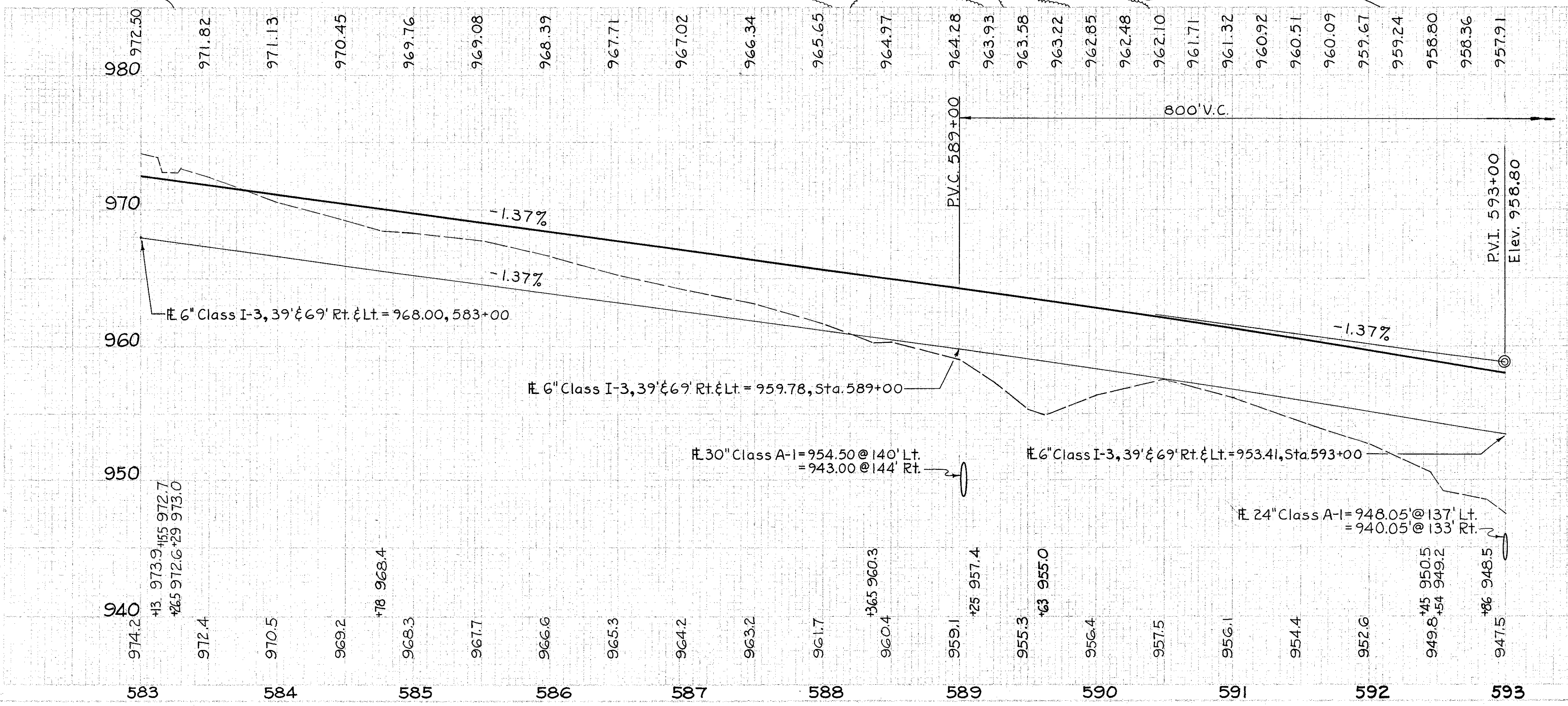

ESTIMATED QUANTITIES

REF. NO.	STATION TO STATION	SIDE	Class A-1 Pipe		Class 1-3 Pipe		Class 1-2 Pipe		I-5		I-10		I-15		I-10		I-10	
			30" Lin. Ft.	Sec. M-66/d	Shallow 6" Lin. Ft.	Each	Each	Each	Each	Each	Each	Each	Each	Each	Each	Each	Each	Each
1-D	583+00 to 593+00	Lt.			1,028													
2-D	583+00 to 593+00	Lt.			1,000													
3-D	583+00 to 593+00	Rt.			1,000													
4-D	587+25 to 587+90	Lt.																
5-D	587+25 to 587+90	Lt.																
6-D	588+20 to 589+00	Lt.																
7-D	588+00 to 590+00	Rt.																
8-D	583+50 to 593+00	Med.																
9-D	589+03																	
1-R	583+00 to 583+50	Rt.																
2-R	587+50 to 593+00	Rt.																
TOTALS					4,028	6.20	1	16	600	323	792							