

0
1
2
3
4
5
6
7
8
9
10
11
12
13
14
15
16
17
18
19
20
21
22
23
24
25
26
27
28
29
30
31
32
33
34
35
36
37
38
39
40
41
42
43
44
45
46
47
48
49
50
51
52
53
54
55
56
57
60
61
62
63

PLOTTED FROM: Reforsber@p1d08459@dan@307xs33.dgn
 PLOT SUBMITTED: 24-JUL-1998 15:11
 307XS33.DGN

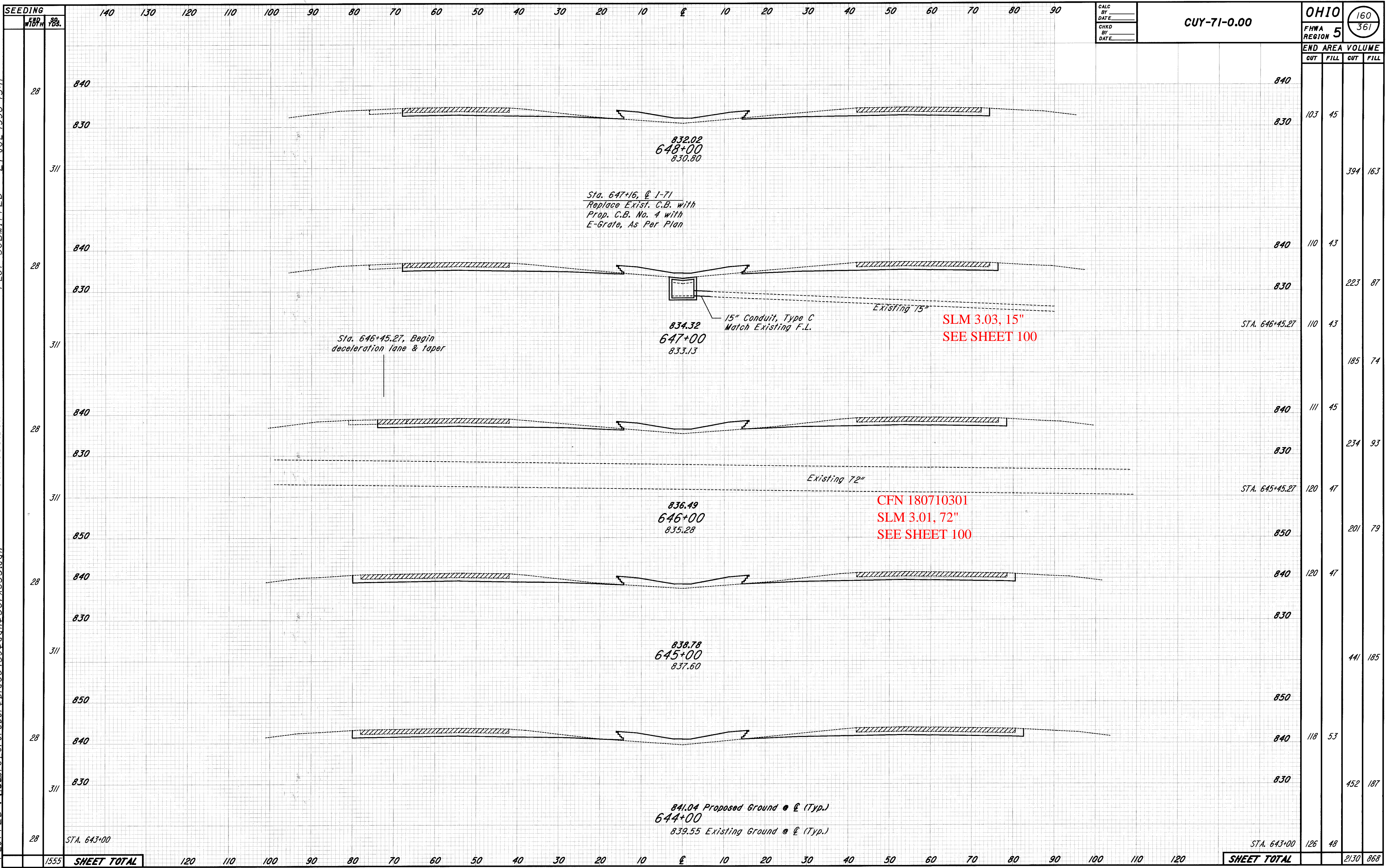

CROSS SECTIONS STA. 644+00 TO STA. 648+00