

STATE OF OHIO  
DEPARTMENT OF TRANSPORTATION

**CUY SR 043-10.61**

**CITY OF CLEVELAND  
CUYAHOGA COUNTY**

**STAGE 2 - APRIL 3, 2019**

*PROJECT DESCRIPTION*

RESURFACING OF APPROXIMATELY 3.40 MILES OF SR 43 ROAD FROM EAST 175TH STREET TO BROADWAY AVENUE IN THE CITY OF CLEVELAND. WORK WILL INCLUDE MILLING OF EXISTING ASPHALT AND REPLACEMENT, ALONG WITH FULL AND PARTIAL DEPTH PAVEMENT REPAIRS, UTILITY CASTING ADJUSTMENTS, ADA COMPLIANT CURB RAMPS, PAVEMENT MARKINGS AND SIGNAGE THROUGHOUT THE PROJECT LENGTH.

PROJECT EARTH DISTURBED AREA: N/A\* ACRES  
ESTIMATED CONTRACTOR EARTH DISTURBED AREA: N/A\* ACRES  
NOTICE OF INTENT EARTH DISTURBED AREA: N/A\* ACRES  
\*MAINTENANCE PROJECT

*2019 SPECIFICATIONS*

THE STANDARD SPECIFICATIONS OF THE STATE OF OHIO, DEPARTMENT OF TRANSPORTATION, INCLUDING CHANGES AND SUPPLEMENTAL SPECIFICATIONS LISTED IN THE PROPOSAL SHALL GOVERN THIS IMPROVEMENT.

*OUPS TICKET NUMBERS*

A905001446	2/19/2019
A905001453	2/19/2019
A905001461	2/19/2019
A905001463	2/19/2019
A905001467	2/19/2019
A905001471	2/19/2019
A905001475	2/19/2019
A905001484	2/19/2019
A905001453	2/19/2019

APPROVED \_\_\_\_\_  
DATE \_\_\_\_\_ DISTRICT DEPUTY DIRECTOR

APPROVED \_\_\_\_\_  
DATE \_\_\_\_\_ DIRECTOR, DEPARTMENT OF TRANSPORTATION

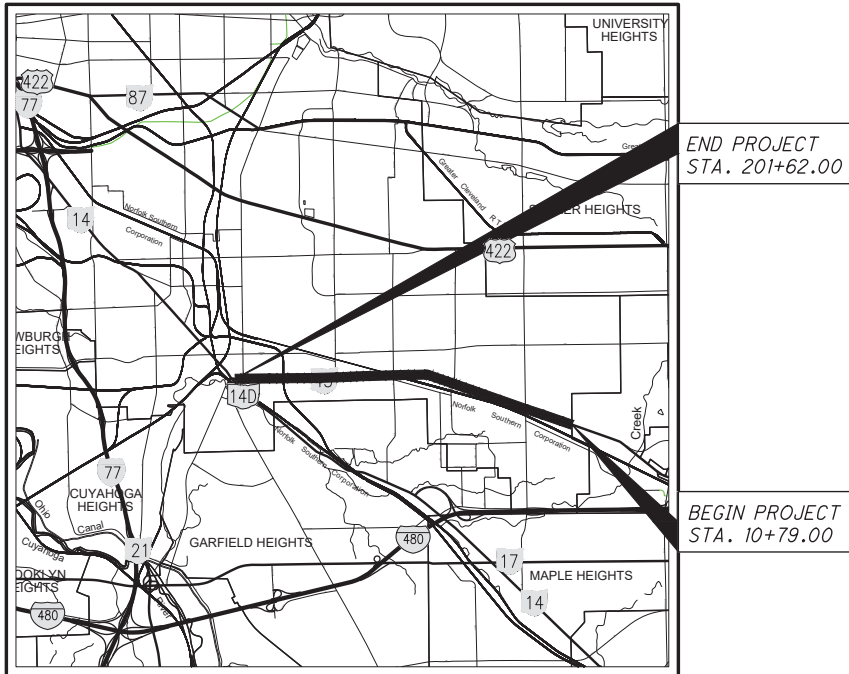

**LOCATION MAP**

LATITUDE: 41°26'44" LONGITUDE: 81°35'19"



*PORTION TO BE IMPROVED* -----

*INTERSTATE HIGHWAY* -----

*FEDERAL ROUTES* -----

*STATE ROUTES* -----

*COUNTY & TOWNSHIP ROADS* -----

*OTHER ROADS* -----

**DESIGN DESIGNATION**

*CURRENT ADT (20...)* -----

*DESIGN YEAR ADT (20...)* -----

*DESIGN HOURLY VOLUME (20...)* -----

*DIRECTIONAL DISTRIBUTION* -----

*TRUCKS (24 HOUR B&C)* -----

*DESIGN SPEED* -----

*LEGAL SPEED* -----

*DESIGN FUNCTIONAL CLASSIFICATION:* -----

*NHS PROJECT* -----

**DESIGN EXCEPTIONS**

*INDEX OF SHEETS:*

TITLE SHEET	1
SCHEMATIC PLANS	2-5
TYPICAL SECTIONS	6
PAVEMENT REPAIR DETAILS	7
GENERAL NOTES	8-14
MAINTENANCE OF TRAFFIC	15-33
PLAN AND ESTIMATED QUANTITIES	34-72
MISCELLANEOUS DETAILS	73-112
TRAFFIC CONTROL	113-155

**UNDERGROUND UTILITIES**

CONTACT BOTH SERVICES TWO WORKING DAYS BEFORE YOU DIG.

**Call Before You Dig**  
1-800-362-2764

(Non-members must be called directly)

**OIL & GAS PRODUCERS  
UNDERGROUD PROTECTION SERVICE**  
1-800-925-0988

PLAN PREPARED BY:

ENGINEERS SEAL:

SIGNED: \_\_\_\_\_



DATE: \_\_\_\_\_

	STANDARD CONSTRUCTION DRAWINGS				SUPPLEMENTAL SPECIFICATIONS	SPECIAL PROVISIONS

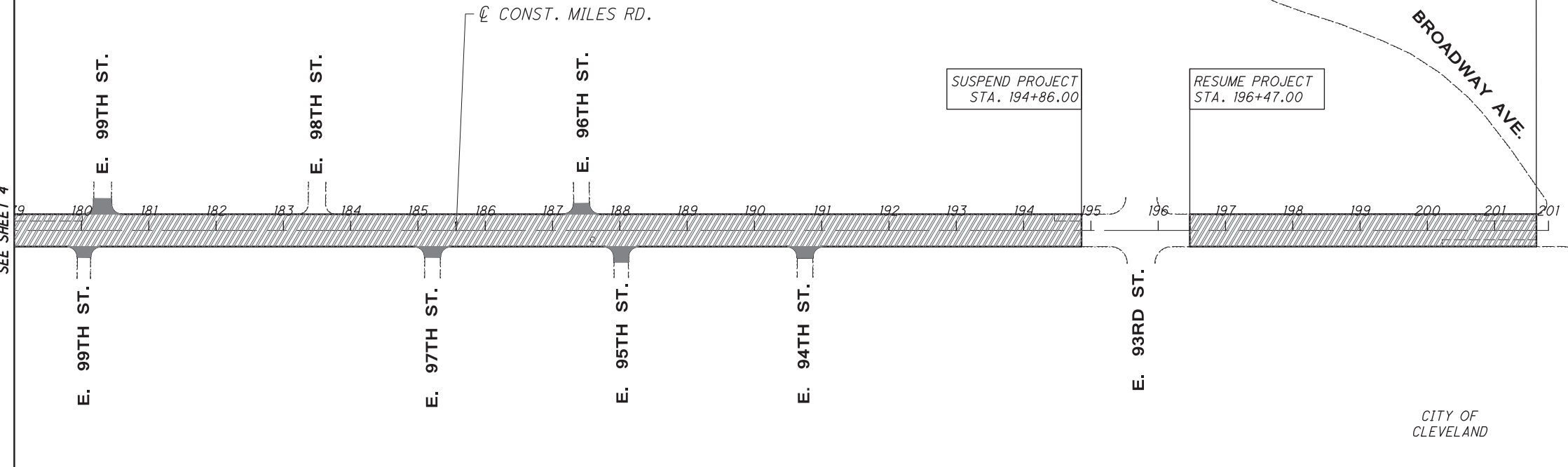
MATCHLINE STA. 179+00  
SEE SHEET 4

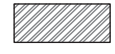

**LEGEND**

-  ITEM 441 - SURFACE COURSE, TYPE 1, (448), AS PER PLAN, PG70-22M  
ITEM 441 - INTERMEDIATE COURSE, TYPE 2, (448), AS PER PLAN, PG64-22
-  ITEM 441 - SURFACE COURSE, TYPE 1, (448), AS PER PLAN, PG64-22  
ITEM 441 - INTERMEDIATE COURSE, TYPE 1, (448), AS PER PLAN, PG64-22

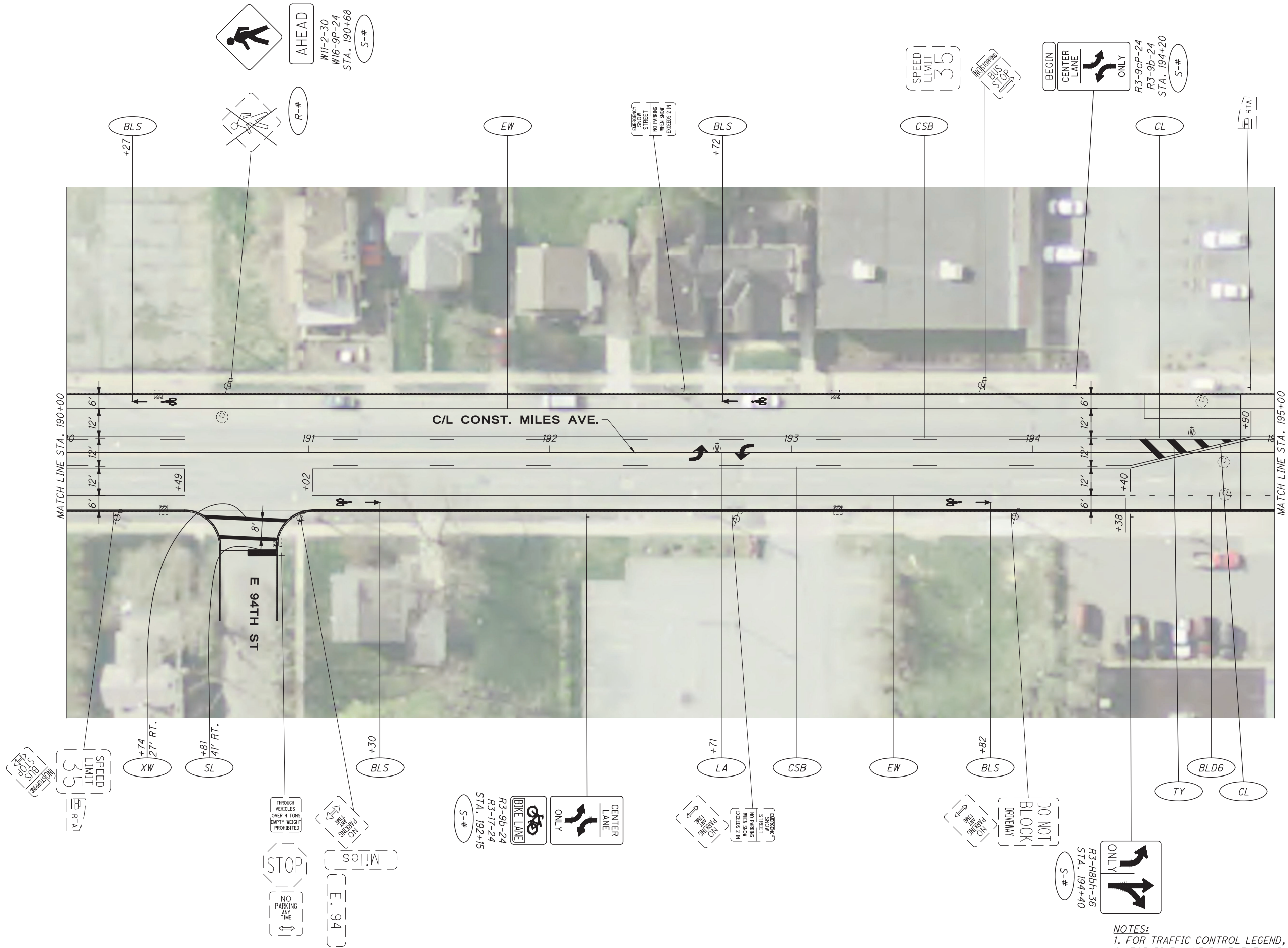

NOTES:  
 1. FOR TRAFFIC CONTROL LEGEND, SEE SHEET 113.  
 2. FOR BIKE LANE PAVEMENT MARKING DETAIL SEE SHEET 155.

CALCULATED	DLS	TJR

0 20 40  
 HORIZONTAL SCALE IN FEET

0 20 40  
 HORIZONTAL SCALE IN FEET

**TRAFFIC CONTROL PLAN - MILES AVE.**  
**STA. 190+00 TO STA. 195+00**

**CUY SR 043-10.61**

150  
155







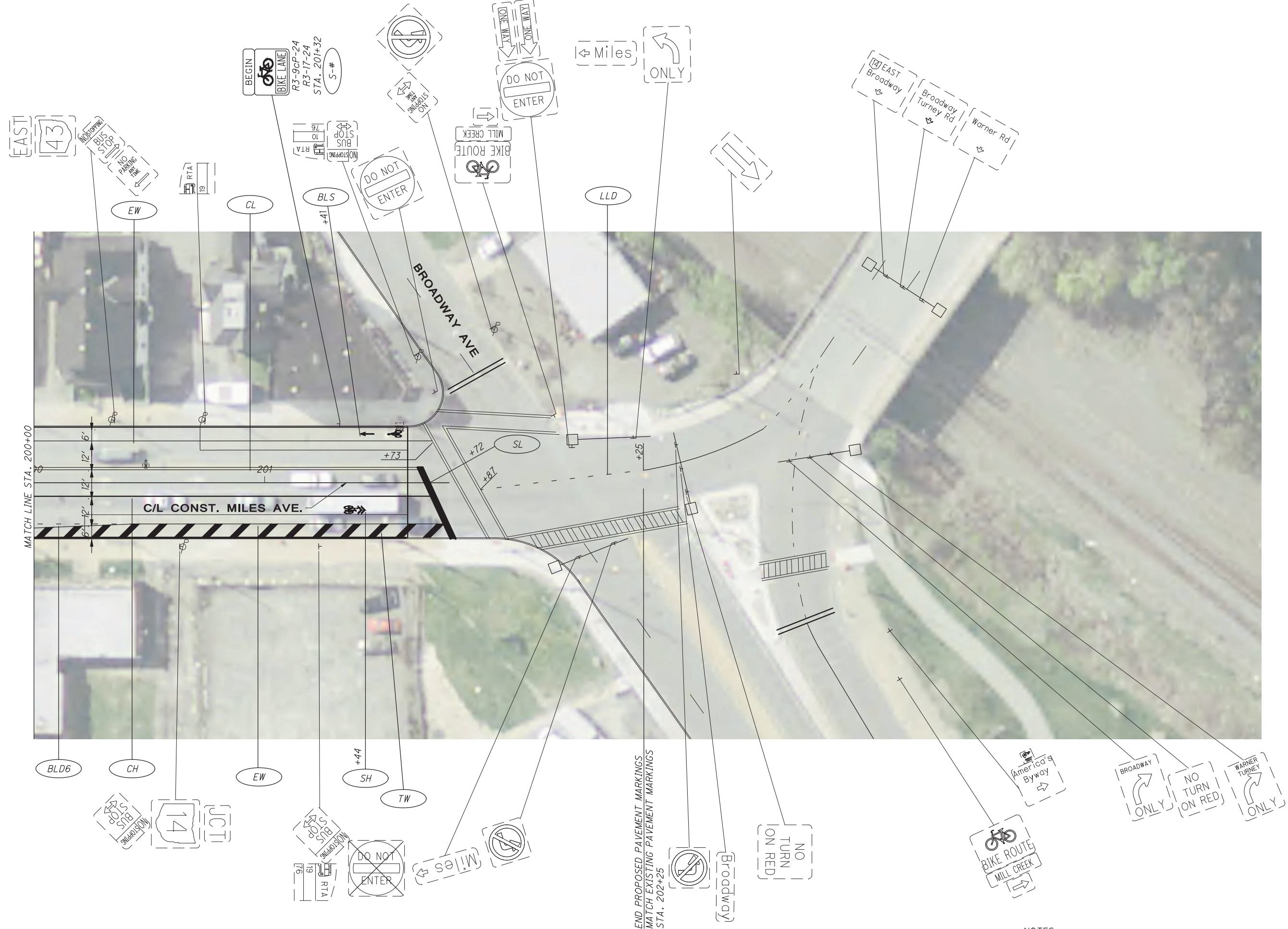

END PROPOSED PAVEMENT MARKINGS  
MATCH EXISTING PAVEMENT MARKINGS  
STA. 202+25

NOTES:  
1. FOR TRAFFIC CONTROL LEGEND, SEE SHEET 113.  
2. FOR BIKE LANE PAVEMENT MARKING DETAIL SEE SHEET 155.

CALCULATED DLS CHECKED TJR  
 0 20 40  
 HORIZONTAL SCALE IN FEET

TRAFFIC CONTROL PLAN - MILES AVE.  
STA. 200+00 TO END

CUY SR 043-10.61