

# CUYAHOGA COUNTY CUY-TURNEY ROAD (C.R.-72) IMPROVEMENT PLANS

## CITIES OF CLEVELAND & GARFIELD HEIGHTS STATE OF OHIO

**PROJECT DESCRIPTION**

RESURFACING AND REHABILITATION OF 3.40 MILES OF TURNEY ROAD (C.R.-72), FROM WARNER ROAD TO HATHAWAY ROAD, (EXCLUDING THE BRIDGE OVER I-480). MAJOR WORK ITEMS INCLUDE: PARTIAL AND FULL DEPTH PAVEMENT REPAIR, CURB REPAIR, CURB RAMPS, TRAFFIC LOOP DETECTORS, SIGNS, AND MANHOLE, CATCH BASIN AND WATER VALVE ADJUSTMENTS TO GRADE.

**EARTH DISTURBED AREAS**

PROJECT EARTH DISTURBED AREA..... N/A ACRE (MAINTENANCE PROJECT)  
ESTIMATED CONTRACTOR  
EARTH DISTURBED AREA ..... N/A ACRE (MAINTENANCE PROJECT)  
NOTICE OF INTENT  
EARTH DISTURBED AREA ..... N/A ACRE (MAINTENANCE PROJECT)

**2013 SPECIFICATIONS**

THE STANDARD CONSTRUCTION AND MATERIAL SPECIFICATIONS OF THE STATE OF OHIO, DEPARTMENT OF TRANSPORTATION, SHALL GOVERN THIS IMPROVEMENT EXCEPT WHEN MODIFIED BY THE PLANS, SPECIAL PROVISIONS, SUPPLEMENTAL SPECIFICATIONS OR PROPOSAL NOTES.

I HEREBY APPROVE THESE PLANS AND DECLARE THAT THE MAKING OF THIS IMPROVEMENT WILL NOT REQUIRE THE CLOSING OF THE HIGHWAY TO TRAFFIC, EXCEPT AS NOTED ON SHEETS 67-66, AND THAT PROVISIONS FOR THE MAINTENANCE AND SAFETY OF TRAFFIC WILL BE AS SET FORTH ON THE PLANS AND ESTIMATES.

**DAVID E. MARQUARD, P.E., P.S.**

DESIGN AND CONSTRUCTION ADMINISTRATOR DATE

**MICHAEL W. DEVER**

DIRECTOR OF PUBLIC WORKS DATE

**ARMOND BUDISH**

CUYAHOGA COUNTY EXECUTIVE DATE

UNDERGROUND UTILITIES  
TWO (2) WORKING DAYS  
**BEFORE YOU DIG**  
CALL 1-800-362-2764 (TOLL FREE)  
OHIO UTILITIES PROTECTION SERVICE  
NON MEMBERS  
MUST BE CALLED DIRECTLY  
- AND -  
CALL 1-800-925-0988 (TOLL FREE)  
OHIO OIL & GAS PRODUCERS  
UNDERGROUND PROTECTION SERVICE

**INDEX OF SHEETS**

TITLE SHEET..... 1  
SCHEMATIC PLAN..... 2-6  
REFERENCE 3-POINT TIES..... 7-10  
TYPICAL SECTIONS ..... 11-12  
GENERAL NOTES ..... 13-20A  
MAINTENANCE OF TRAFFIC PLANS..... 21-66  
GENERAL SUMMARY..... 68-70  
SUBSUMMARIES..... 71-80  
PLAN SHEETS..... 81-99  
TRAFFIC CONTROL PLANS..... 100-136

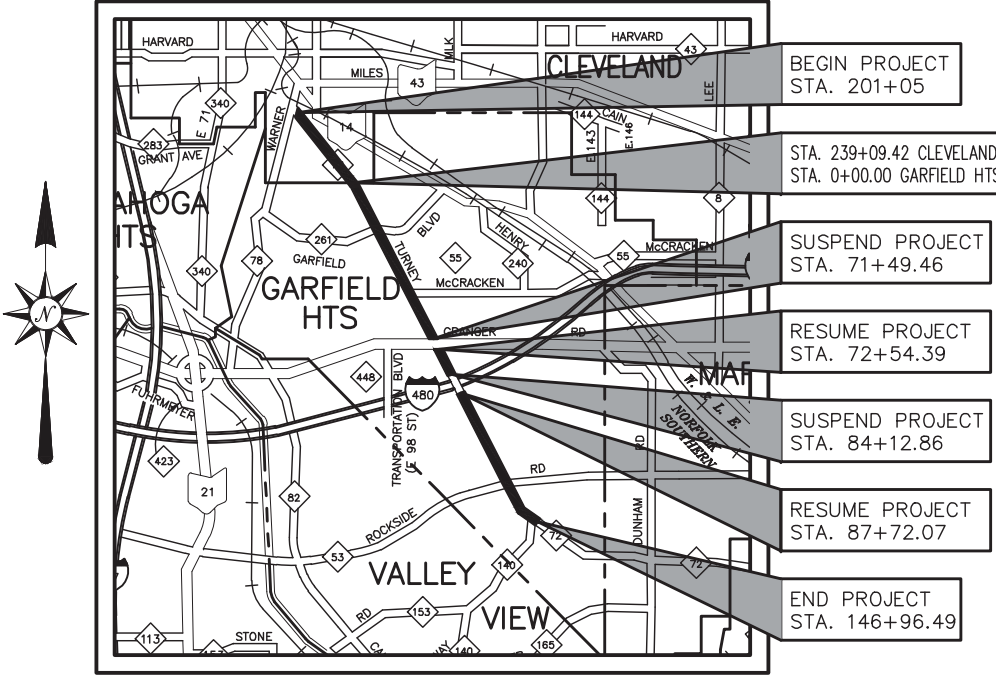

**LOCATION MAP**

LATITUDE: 41° 25' 00" LONGITUDE: 81° 36' 21"

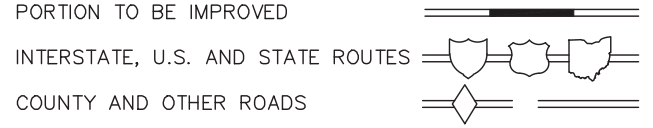
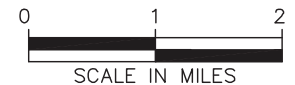

**DESIGN DESIGNATION**

CURRENT ADT (2013).....19,612 (NOACA)  
DESIGN YEAR ADT (2033).....19,612 (NOACA)  
DESIGN HOURLY VOLUME (DHV) .....N/A  
DIRECTIONAL DISTRIBUTION (D) .....N/A  
TRUCKS (T) (24 HOUR B&C).....N/A  
DESIGN SPEED.....40 M.P.H.  
POSTED SPEED.....VARIES 25/35 M.P.H.  
DESIGN FUNCTIONAL CLASSIFICATION:.....MINOR URBAN ARTERIAL

**DESIGN EXCEPTIONS**

NONE REQUIRED

APPROVED IN THE CITY OF CLEVELAND APPROVED IN THE CITY OF GARFIELD HEIGHTS  
ORDINANCE OF CONSENT NO. 1349-14 ORDINANCE OF CONSENT NO. 38-2012  
PASSED 12-1-14 PASSED 7-9-12

ENGINEER'S SEAL  
FOR SHEETS: 1, 11-97  
RYAN M. SMALLER  
NO. 73559  
REGISTERED PROFESSIONAL ENGINEER  
SIGNED: [Signature]  
DATE: 9/1/2015

ENGINEER'S SEAL  
FOR SHEETS: 2-10, 98-134  
DONALD P. BIERUT  
E-52239  
REGISTERED PROFESSIONAL ENGINEER  
SIGNED: [Signature]  
DATE: 8/15

PLANS PREPARED FOR:  
CUYAHOGA COUNTY  
DEPARTMENT OF PUBLIC WORKS  
2079 EAST 9TH STREET  
CLEVELAND, OHIO 44115  
(216) 348-3800

PLANS PREPARED BY:  
**Hatch Mott MacDonald**  
18013 CLEVELAND PARKWAY DRIVE, SUITE 200, CLEVELAND, OHIO 44135  
PHONE: (216)-535-3640 FAX: (216)-265-2816

OHIO DEPARTMENT OF TRANSPORTATION STANDARD CONSTRUCTION DRAWINGS				CUYAHOGA COUNTY DEPARTMENT OF PUBLIC WORKS CONSTRUCTION DRAWINGS					
NUMBER	DATE	NUMBER	DATE	NUMBER	DATE	NUMBER	DATE	NUMBER	DATE
BP-1.1	7/28/00	MT-95.60	7/19/13	BP-2.5C	10/31/13	MD-1C	5/31/10		
BP-2.1	7/17/15	MT-97.10	7/18/14	BP-2.6C	10/31/13	MH-10C	10/31/13		
BP-2.2	7/18/08	MT-97.11	7/18/14	BP-2.7C	10/10/08	MKG-1C	1/26/04		
BP-2.5	7/19/13	MT-99.20	7/19/13	BP-2.8C	10/10/08	MKG-2C	11/8/13		
BP-3.1	7/18/14	MT-101.60	7/19/13	BP-4.1C	10/31/13				
BP-5.1	7/19/13	MT-105.10	7/19/13	CB-3C	10/31/13				
BP-7.1	7/18/14	MT-110.10	7/19/13	MB-1C	10/31/13				
DM-1.4	1/18/13	TC-22.20	1/17/14						
DM-4.4	7/20/12	TC-41.10	7/19/13						
MH-1.1	1/18/13	TC-41.20	10/18/13						
MH-1.2	1/18/13	TC-42.20	10/18/13						
MT-95.31	7/18/14	TC-71.10	1/17/14	800	7/17/15				
MT-95.32	7/18/14	TC-82.10	7/17/15	832	1/17/14				
				875	1/17/14				
CITY OF CLEVELAND CONSTRUCTION DRAWINGS				O.D.O.T. SUPPLEMENTAL SPECIFICATIONS					
NUMBER	DATE	NUMBER	DATE	NUMBER	DATE	NUMBER	DATE	NUMBER	DATE
CB-1	7/8/08	MH-1	7/8/08						
CR-1	12/8/09	PR-1	7/8/08						
A-503	7/8/08	A-605	7/8/08						
A-695	7/8/08								
SPECIAL PROVISIONS				SEE SECTION 200 OF THE CUYAHOGA COUNTY ENGINEER SPECIFICATION BOOKLET IN THE BID PACKAGE					

DWG: Z:\Borrett\_2010-03-23\Plan\_Sheets\01-TTitle.dwg  
PLOT SCALE: 1 = 1  
PLOT DATE: 2-13-12

FEDERAL PROJECT NO. E130209  
PID NO. 94637  
CONSTRUCTION PROJECT NO.  
RAILROAD INVOLVEMENT NONE  
TURNNEY ROAD (CR-72)  
1/136

EXISTING LEGEND

- (A) ASPHALT CONCRETE (4.5" AVG. GRAND DIVISION TO HATHAWAY)  
(4.0" AVG. WARNER TO GRAND DIVISION)
- (B) CONCRETE BASE (10" AVG.)
- (C) SUBBASE
- (D) NON-INTEGRAL CONCRETE CURB, TYPE 6
- (E) 6" SHALLOW PIPE UNDERDRAIN (VITRIFIED CLAY)
- (F) CONCRETE SIDEWALK
- (G) BRICK BASE (4" AVG.)
- (H) REINFORCED CONCRETE APPROACH SLAB
- (I) INTEGRAL CONCRETE CURB

- + STA. 0+00 TO STA. 1+37 = VARIES 17'-6" TO 23'
- STA. 1+37.17 TO STA. 5+97 = 23'
- STA. 6+82 TO STA. 10+07 = 23'
- STA. 11+58 TO STA. 12+18 = 23'
- STA. 12+18 TO STA. 13+18 = VARIES 23' TO 24'
- STA. 13+18 TO STA. 18+49 = 24'
- STA. 23+03 TO STA. 24+37 = 24'
- STA. 25+80 TO STA. 27+56 = 24'
- STA. 27+56 TO STA. 28+59 = VARIES 24' TO 21'
- STA. 28+59 TO STA. 65+83 = 21'
- STA. 65+83 TO STA. 68+83 = VARIES 21' TO 31'
- STA. 68+83 TO STA. 71+49 = 31'
- STA. 72+54 TO STA. 74+67 = 31'
- STA. 74+67 TO STA. 75+67 = VARIES 31' TO 29'
- STA. 75+67 TO STA. 82+24 = 29'
- STA. 82+24 TO STA. 83+19 = VARIES 29' TO 26'
- STA. 83+19 TO STA. 83+93 = 26'
- STA. 87+92 TO STA. 88+37 = 26'
- STA. 88+37 TO STA. 89+41 = VARIES 26' TO 33'
- STA. 89+41 TO STA. 92+13 = 33'
- STA. 92+13 TO STA. 94+54 = VARIES 33' TO 23'
- STA. 94+54 TO STA. 134+13 = 23'
- STA. 134+13 TO STA. 136+18 = VARIES 23' TO 31'
- STA. 136+18 TO STA. 141+59 = 31'
- STA. 141+59 TO STA. 144+37 = VARIES 31' TO 21'
- STA. 144+37 TO STA. 146+96.49 = 21'

✱ STA. 238+76 TO STA. 239+09 = VARIES 15'-3" TO 17'-6"

\*\* - ITEM 441, 1-1/2" ASPHALT CONCRETE SURFACE COURSE, TYPE 1, PG64-22, AS PER PLAN IS TO BE USED FOR ALL SIDE STREET TURNOUTS.

PROPOSED LEGEND

- (1) ITEM 202-WEARING COURSE REMOVED, AS PER PLAN
- (2) ITEM 254-PAVEMENT PLANING, PORTLAND CEMENT CONCRETE, AS PER PLAN (VARIES, 1" MAX.)
- (3) ITEM 304-AGGREGATE BASE, AS PER PLAN (MATCH DEPTH TO EXISTING ADJACENT SUBBASE)
- (4) ITEM 255-FULL DEPTH PAVEMENT REMOVAL AND RIGID REPLACEMENT, CLASS QC MS, AS PER PLAN (MIN 9" REPAIR)
- (5) ITEM SPECIAL-TACK COAT, TRACKLESS TACK (0.10 GAL/SY)
- (6) ITEM SPECIAL-TACK COAT, TRACKLESS TACK, FOR INTERMEDIATE COURSE (0.04 GAL/SY)
- (7) ITEM 609-CURB, TYPE 2-B, USING CLASS QC MS CONCRETE, AS PER PLAN
- (8) ITEM 441-1 1/2" ASPHALT CONCRETE SURFACE COURSE, TYPE 1, (448), PG64-22, AS PER PLAN
- (9) ITEM 441-1 3/4" ASPHALT CONCRETE INTERMEDIATE COURSE, TYPE 2, (448), AS PER PLAN
- (10) ITEM 441-1 1/2" ASPHALT CONCRETE SURFACE COURSE, TYPE 1, (448), PG70-22M, AS PER PLAN
- (11) ITEM 659-SEEDING AND MULCHING, AS PER PLAN
- (12) ITEM 441-3/4" (CLE), 1 1/4" (GAR) AVG. ASPHALT CONCRETE INTERMEDIATE COURSE, TYPE 1, (448), AS PER PLAN
- (13) ITEM 202-BRICK BASE REMOVED, AS PER PLAN
- (14) ITEM 609-CURB, TYPE 6, USING CLASS QC MS CONCRETE, AS PER PLAN
- (15) ITEM 305-9" CONCRETE BASE, CLASS QC MS, AS PER PLAN
- (16) ITEM 203-EXCAVATION

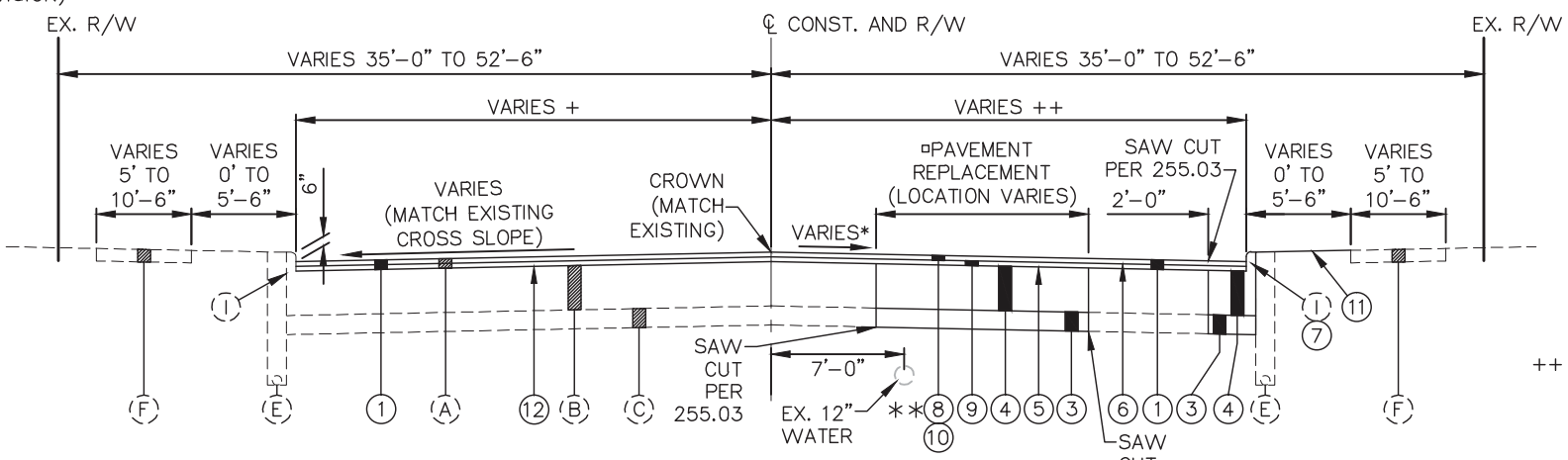

TURNEY ROAD - NORMAL SECTION (GRAND DIVISION TO HATHAWAY)

STA. 0+00 TO STA. 5+97 = 597 FT  
 STA. 6+82 TO STA. 10+07 = 325 FT  
 STA. 11+58 TO STA. 18+49 = 691 FT  
 STA. 23+03 TO STA. 24+37 = 134 FT  
 STA. 25+80 TO STA. 71+49 = 4,569 FT  
 STA. 72+54 TO STA. 83+93 SUSPEND = 1,139 FT  
 I.R. 480 BRIDGE  
 RESUME STA. 87+92 TO STA. 146+96.49 = 5,904.49 FT

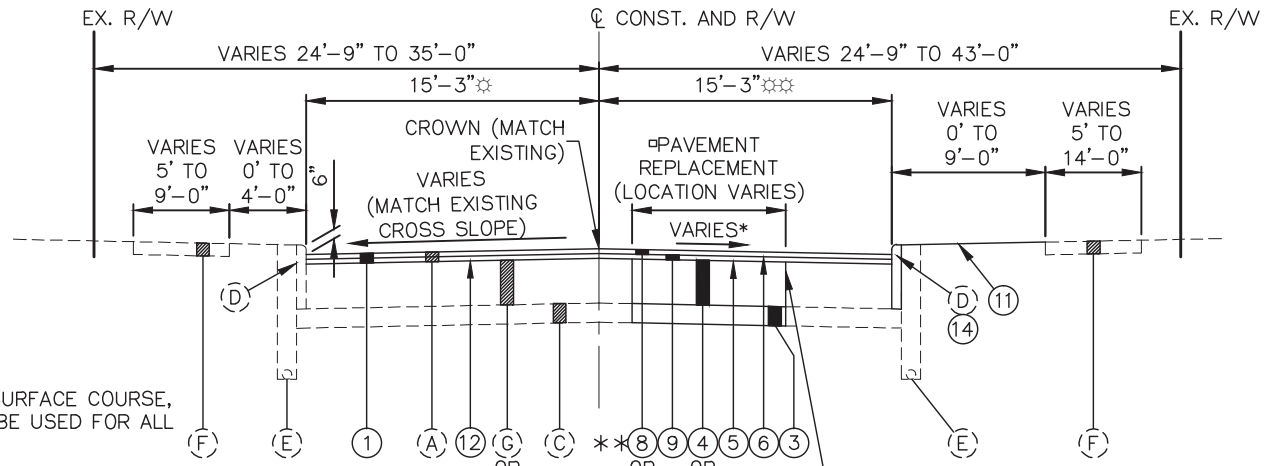

TURNEY ROAD - NORMAL SECTION (WARNER TO GRAND DIVISION)

STA. 201+05 TO STA. 239+09.42 = 3,804.42 FT

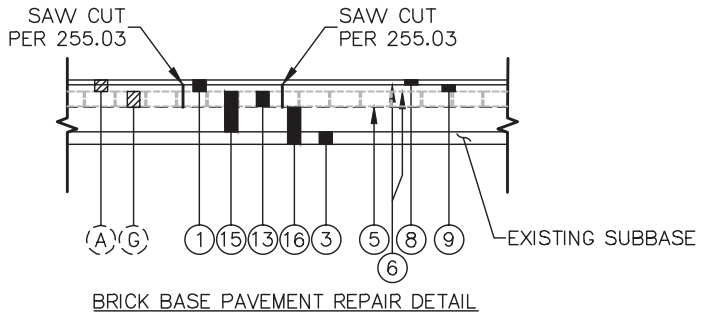

BRICK BASE PAVEMENT REPAIR DETAIL

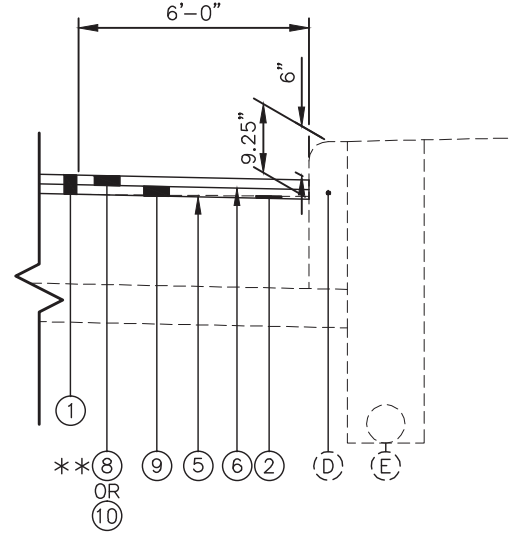

CONCRETE PLANING EDGE DETAIL

NOTE - USE AS DIRECTED BY ENGINEER.  
 (WHERE EXISTING ASPHALT COURSE IS LESS THAN 3-1/4 INCHES).

\* = MATCH EXISTING BASE CROSS SLOPE

- ++ STA. 0+00 TO STA. 0+19 = VARIES 20'-6" TO 23'
- STA. 0+19 TO STA. 5+97 = 23'
- STA. 6+82 TO STA. 10+07 = 23'
- STA. 11+58 TO STA. 12+18 = 23'
- STA. 12+18 TO STA. 15+18 = VARIES 23' TO 32'
- STA. 15+18 TO STA. 18+49 = 32'
- STA. 23+03 TO STA. 24+37 = 32'
- STA. 25+80 TO STA. 27+56 = 32'
- STA. 27+56 TO STA. 29+65 = VARIES 32' TO 25'
- STA. 29+65 TO STA. 67+85 = 25'
- STA. 67+85 TO STA. 69+97 = VARIES 25' TO 26.5'
- STA. 69+97 TO STA. 71+49 = 26.5'
- STA. 72+54 TO STA. 74+68 = 25'
- STA. 74+68 TO STA. 75+33 = VARIES 25' TO 23'
- STA. 75+33 TO STA. 82+95 = 23'
- STA. 82+95 TO STA. 83+93 = VARIES 23' TO 25.5'
- STA. 87+92 TO STA. 89+15 = VARIES 26' TO 31'
- STA. 89+15 TO STA. 89+93 = VARIES 31' TO 23'
- STA. 89+93 TO STA. 134+67 = 23'
- STA. 134+67 TO STA. 135+40 = VARIES 23' TO 25'
- STA. 135+40 TO STA. 146+96.49 = 25'

□ - ACTUAL LOCATION SHALL BE AS DIRECTED BY THE ENGINEER AFTER THE WEARING COURSE HAS BEEN REMOVED.

✱✱ STA. 238+76 TO STA. 239+09 = VARIES 15'-3" TO 20'-6"

P:\DE\COVAYHOGA COUNTY\PROJECTS\309586 - TURNERY ROAD\0700 CAD DRAWINGS\ROADWAY SHEETS\946376\001.DWG - 07001 - CCEO-HIGHWAY.CTB - PLOTTED 10/15/2015 9:54 AM BY TYNESKI, STEVEN J



P:\DE\CUYAHOGA COUNTY\PROJECTS\309566 - TURNERY ROAD\0700 CAD DRAWINGS\ROADWAY\SHEETS\946370\016.DWG - C-016 - CCEO\_HIGHWAY.CTB - PLOTTED 10/15/2015 10:13 AM BY TYNESKI, STEVEN J

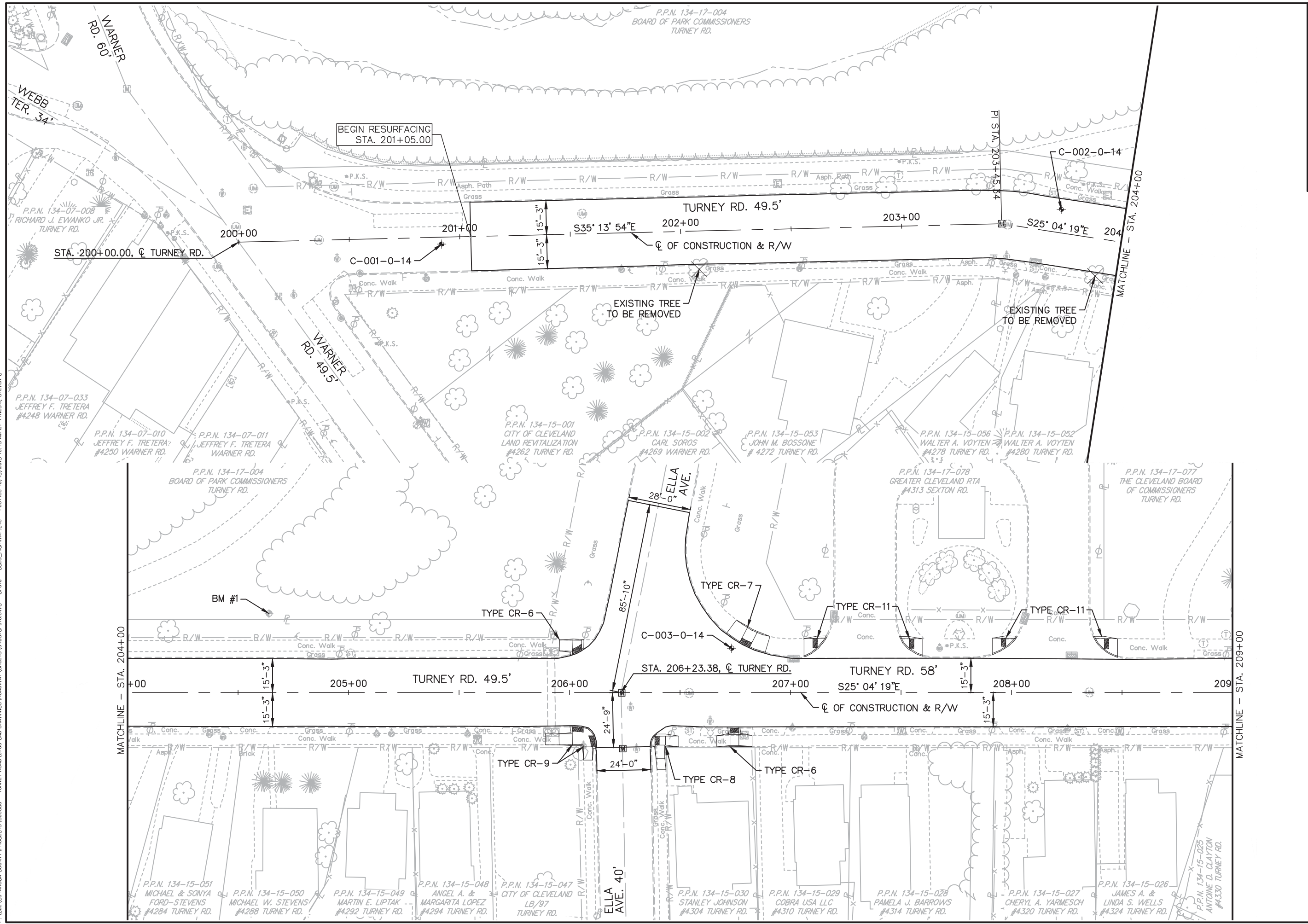

P.P.N. 134-17-004  
BOARD OF PARK COMMISSIONERS  
TURNERY RD.

CROSS REFERENCES	
SHEET No.	DESCRIPTION
71-80	SUBSUMMARIES
##-##	SIGNING PLANS
0	CALCULATED
TWJ	CHECKED
RMS	

BENCHMARK #1 ELEV. 811.254  
5/8" IRON PIN SET  
STA. 204+64.09, 35.73' LT

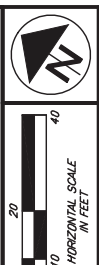

PLAN - TURNERY ROAD  
WARNER ROAD TO STA. 209+00

TURNERY ROAD  
(CR-72)

P:\DE\COVANOCA COUNTY\PROJECTS\309586 - TURNERY ROAD\0700 CAD DRAWINGS\TRAFFIC CONTROL\SHEETS\946377\CD01.DWG - P&P001 - CECO\_HIGHWAY.CTB - PLOTTED 10/15/2015 10:29 AM BY TYESKI, STEVEN J

**LEGEND**

- EXISTING SIGN TO REMAIN
- EXISTING SIGN REERECTED
- PROPOSED SIGN
- SINGLE POST GROUND MOUNTED
- DOUBLE POST GROUND MOUNTED
- POLE MOUNTED
- PROPOSED SIGN
- STOP LINE (RELOC.)
- CROSSWALK LINES (RELOCATED)

NOTE: CROSSWALK LINES AND STOP BARS SHOWN REFLECT NEW LOCATIONS DUE TO RELOCATED CURB RAMPS OR LOCATIONS THAT DID NOT PREVIOUSLY HAVE CROSSWALK LINES OR STOP BARS. CROSSWALK LINES, STOP BARS AND OTHER MARKINGS NOT DEPICTED ARE TO BE REPLACED IN THEIR PRESENT LOCATIONS PER THE "LAYOUT OF PAVEMENT MARKINGS" NOTE ON SHEET 19.

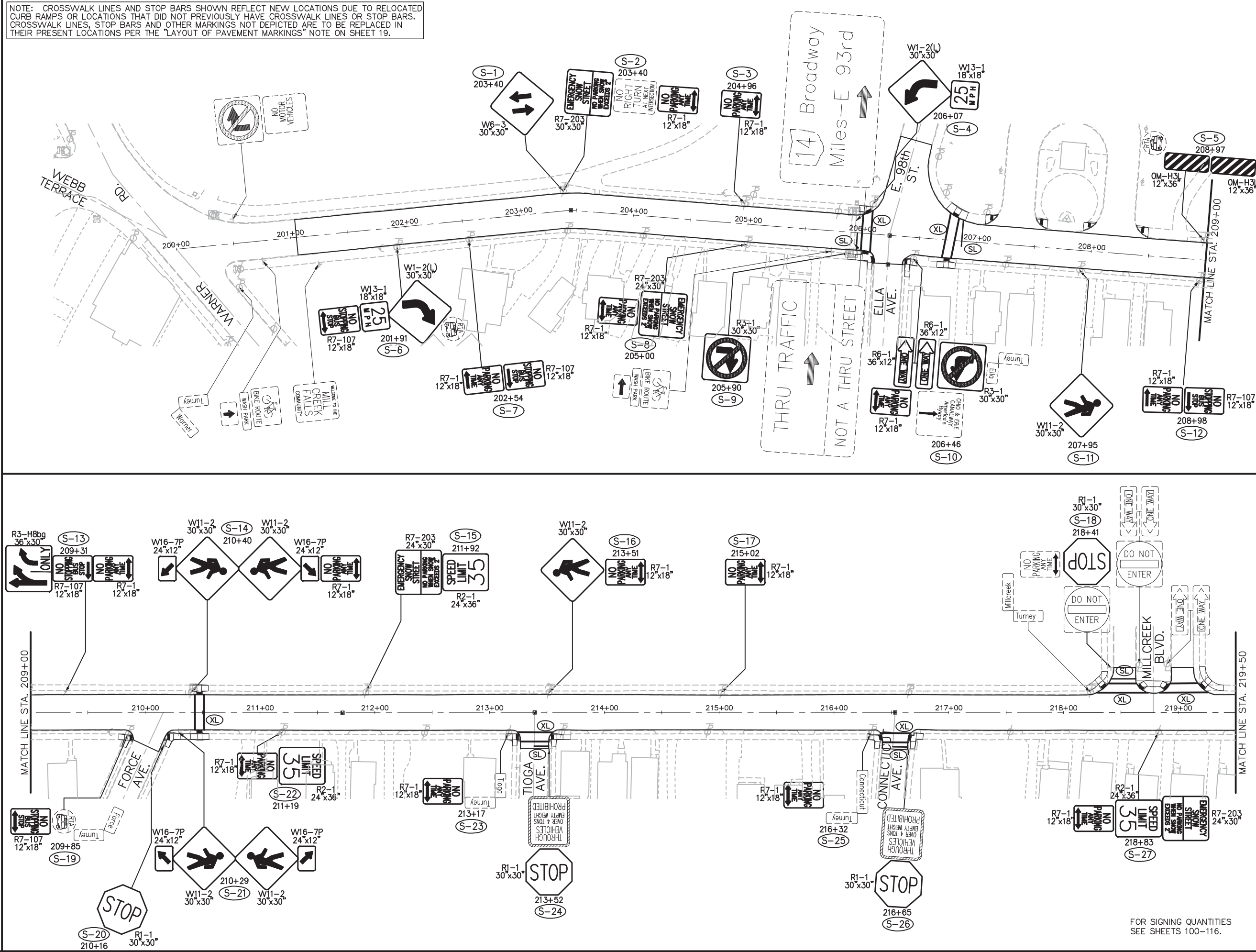

CALCULATED R.B.

CHECKED D.P.B.

PROPOSED SIGNING PLAN  
STA 200+00 TO STA 219+50

TURNERY ROAD  
(CR-72)

FOR SIGNING QUANTITIES SEE SHEETS 100-116.