

### TYPICAL SECTION TYPE "C"

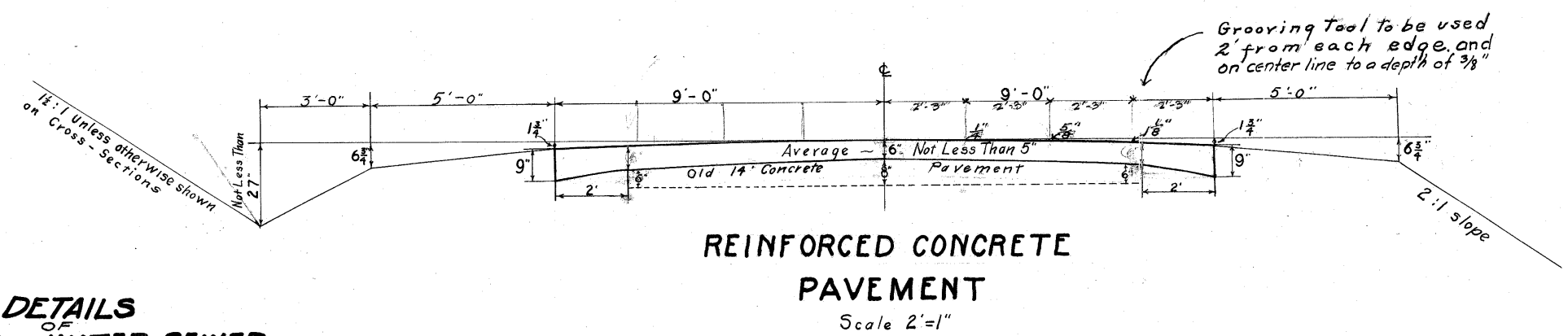

### REINFORCED CONCRETE PAVEMENT

Scale 2'=1"

### DETAILS OF STORM WATER SEWER

Scale 1"=2'

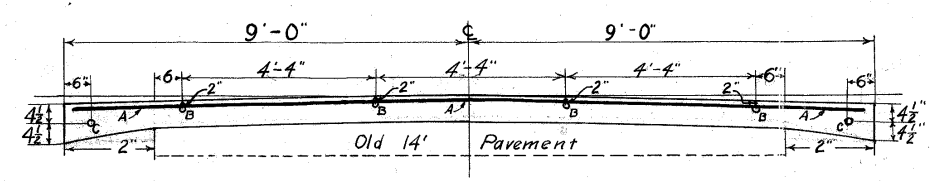
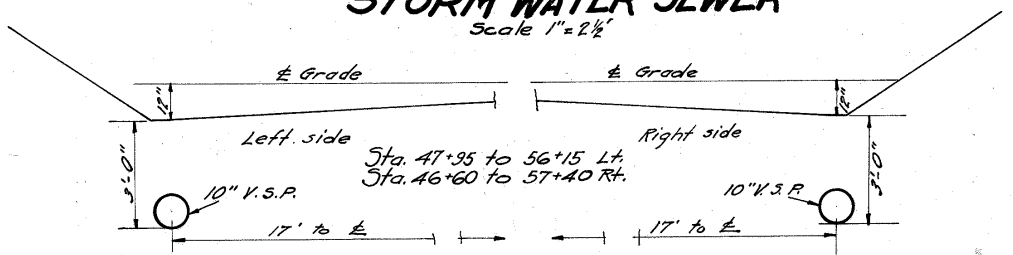

Note: Construction shall be in two units, divided at Moss Dairy Farm, Sta. 25 and first section permitted to cure 21 days before constructing other portion, so as to allow service to Moss Dairy Co. at all times.

### SECTION SHOWING REINFORCEMENTS

- A 3/8" round or deformed Transverse Bars spaced 12" ; Length 17'-8"
- B 3/8" round or deformed Longitudinal Bars spaced as shown; Length 20' (4 Lines)
- C 3/4" round Edge Bars as shown. (Smooth bars, painted and greased.)

**REINFORCING STEEL LIST**  
included in 59. Yds. estimate

3/8" Transverse bars 17'-8" =	5,726 pieces
3/8" Longitudinal bars 20'-0" =	1,206 "
3/4" Edge bars 20'-0" =	636 "
Total weight = 66,210 Lbs	

A & B bars lap = 1'-0"  
C bars lap = 2'-0"

Star. Type "B" Guard Rail to be built where indicated on plan, at ends of culverts.

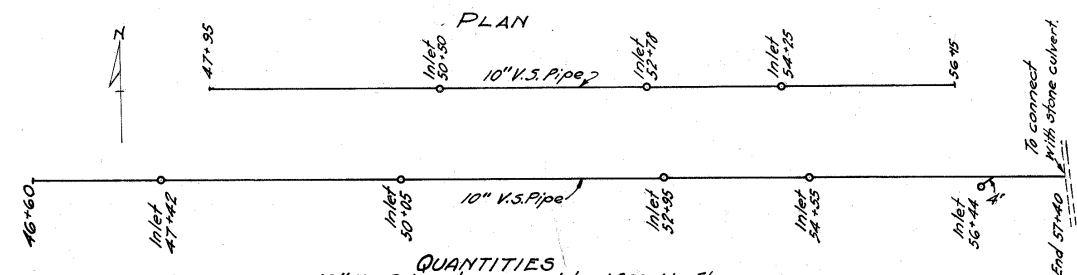

**QUANTITIES**  
10" V.S.P. in place complete 1,888 Lin. Ft.  
10" x 10" "Y" 3 8 only.  
10" x 10" "Y" 3 1 only.  
Star. No. 1 Side Ditch Inlets. 8 only.

Note:-  
Exposed ends of all Vit. pipe used on this project shall be protected by hand laid Rip Rep.

All inlets shall be Side Ditch Inlet Type  
Star. Drawing No. 305.