

FED. RD. DIST. NO.	STATE	FED. AID PROJECT	FISCAL YEAR
10	OHIO	388E	1927

I-C-H 324 SEC. F.
GEAUGA COUNTY

Left Edge of Pav.	Width	Station	Grade Elev.	Right Edge of Pav.
1145.25	9.00	192+43.98	1145.40	9.00
1144.94	9.00	+50	1145.09	9.00
1144.24	8.83	+68.88	1144.57	9.00
1143.81	11.33	+92.81	1144.86	9.00
1142.55	11.77	193+00	1143.70	9.00
1141.76	12.78	+18.95	1141.91	9.00
1140.81	13.40	+43.95	1140.96	9.00
1140.60	13.40	+50	1140.75	9.00
1139.76	13.40	+75	1139.91	9.00
1139.03	13.40	194+00	1139.12	9.00
1138.97	13.40	+02.23	1139.12	9.00
1138.30	12.78	+72.28	1138.45	9.00
1137.62	11.38	+52.28	1137.77	9.00
1136.95	9.38	-77.78	1137.10	9.00
1136.33	9.00	195+00	1136.42	9.00
1136.27	9.00	+02.23	1136.42	9.00

Extra Pavement = 77.7 Sq. Yds.

Left Edge of Pav.	Width	Station	Grade Elev.	Right Edge of Pav.
1128.68	9.00	209+46.14	1128.83	9.00
1129.03	10.50	+71.14	1129.18	9.00
1129.38	13.33	+86.14	1129.53	9.00
1129.43	13.80	210+00	1129.58	9.00
1129.72	15.85	+21.14	1129.84	9.00
1130.38	17.00	+46.14	1130.53	9.00
1130.48	17.00	+50	1130.63	9.00
1131.23	17.00	+75	1131.42	9.00
1131.61	17.00	211+00	1132.63	9.00
1131.61	17.00	+48.64	1134.76	9.00
1132.09	15.85	+33.64	1132.24	9.00
1132.74	13.33	+88.64	1132.89	9.00
1132.83	13.33	+90	1132.98	9.00
1132.89	10.50	+75.64	1132.64	9.00
1132.16	9.00	+48.64	1131.31	9.00

Extra Pavement = 176.8 Sq. Yds.

Left Edge of Pav.	Width	Station	Grade Elev.	Right Edge of Pav.
1147.71	9.00	215+41.68	1147.86	9.00
1147.15	9.38	+16.68	1147.30	9.00
1146.76	10.28	+41.68	1146.91	9.00
1146.23	10.33	216+00	1146.38	9.00
1145.76	10.73	+16.68	1145.91	9.00
1145.26	11.00	+41.68	1145.41	9.00
1144.83	11.00	+50	1144.98	9.00
1144.32	11.00	217+00	1144.47	9.00
1143.78	11.00	+50	1143.93	9.00
1143.13	11.00	218+00	1143.27	9.00
1142.50	11.00	+75.68	1142.65	9.00
1141.90	10.73	+41.68	1142.05	9.00
1141.32	10.28	+16.68	1141.47	9.00
1140.73	9.38	219+00	1140.88	9.00
1140.19	9.00	+17.81	1140.34	9.00
1139.61	9.00	+17.81	1139.76	9.00
1139.02	9.00	+46.14	1139.17	9.00

Extra Pavement = 303.4 Sq. Yds.

old CFN 280440669
new CFN 1812917
SLM 6.69, 3'x2'
CONCRETE BOX
SEE SHEET 41

old CFN 280440678
new CFN 1819281
SLM 6.78, 15"
SEE SHEET 41

old CFN 280440681
new CFN 1828507
SLM 6.81, 12"
SEE SHEET 41

MUSIC ST.
SLM 7.00

POND ROAD
SLM 6.82

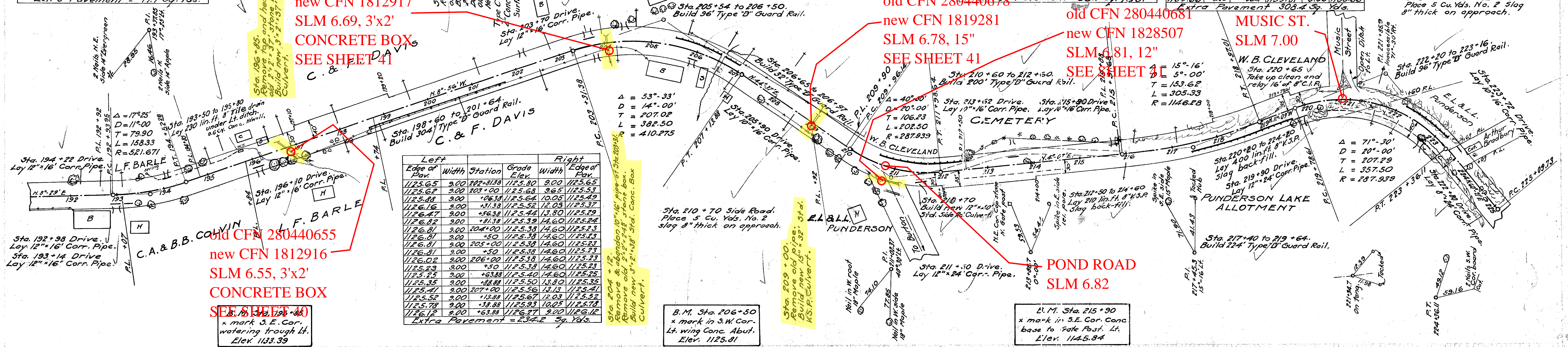

Left Edge of Pav.	Width	Station	Grade Elev.	Right Edge of Pav.
1125.65	9.00	202+81.38	1125.80	9.00
1125.62	9.00	203+00	1125.68	9.00
1125.88	9.00	+06.38	1125.64	10.05
1126.16	9.00	+31.38	1125.52	12.09
1126.47	9.00	+56.38	1125.44	13.80
1126.82	9.00	+81.38	1125.39	14.60
1126.81	9.00	204+00	1125.38	14.60
1126.81	9.00	+50	1125.38	14.60
1126.81	9.00	205+00	1125.38	14.60
1126.02	9.00	+50	1125.38	14.60
1125.25	9.00	+63.88	1125.40	14.60
1125.35	9.00	+88.88	1125.50	13.80
1125.41	9.00	207+00	1125.56	13.13
1125.52	9.00	+13.88	1125.67	12.03
1125.78	9.00	+38.88	1125.93	10.05
1126.12	9.00	+63.88	1126.27	9.00

Extra Pavement = 234.2 Sq. Yds.

Excav. 282 Cu. Yds. Emb. 235 Cu. Yds. +20% 47 Cu. Yds.	Excav. 292 Cu. Yds. Emb. 244 Cu. Yds. +20% 48 Cu. Yds.	Excav. 687 Cu. Yds. Emb. 573 Cu. Yds. +20% 114 Cu. Yds.	Excav. 1670 Cu. Yds. Emb. 1390 Cu. Yds. +20% 280 Cu. Yds.	232 Cu. Yds. 190 Cu. Yds. 40 Cu. Yds.	Excav. 1187 Cu. Yds. Emb. 989 Cu. Yds. +20% 198 Cu. Yds.
--	--	---	---	---	--

*AT SOME POINT THE UPSTREAM PROPERTY OWNER INSTALLED A PARKING LOT OVER THE CULVERT INLET AND A PORTION OF THE CULVERT. APPEARS THAT AN UPSTREAM POND MAY BE FEEDING THE CULVERT THROUGH CLOSED SYSTEM.

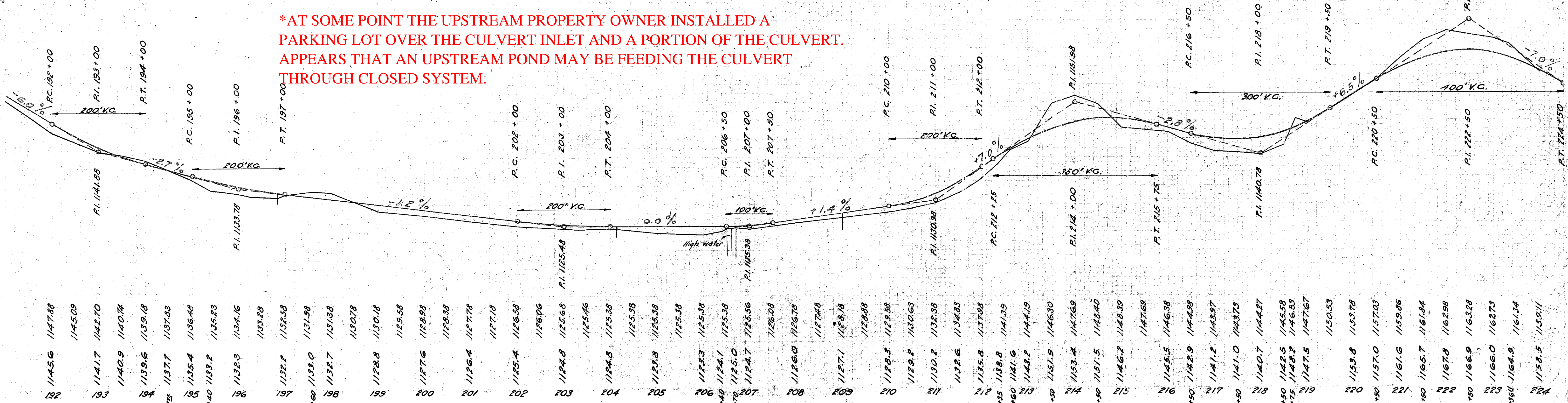

1145.6	1147.88	192	1141.7	1142.70	193	1140.9	1140.74	194	1139.6	1139.18	195	1137.7	1137.83	196	1135.4	1136.48	197	1133.2	1133.23	198	1132.3	1134.16	199	1132.2	1132.58	200	1131.98	1131.98	201	1131.38	1131.38	202	1130.78	1130.78	203	1129.58	1129.58	204	1128.98	1128.98	205	1128.38	1128.38	206	1127.78	1127.78	207	1127.18	1127.18	208	1126.58	1126.58	209	1126.06	1126.06	210	1125.46	1125.46	211	1124.86	1124.86	212	1124.26	1124.26	213	1123.66	1123.66	214	1123.06	1123.06	215	1122.46	1122.46	216	1121.86	1121.86	217	1121.26	1121.26	218	1120.66	1120.66	219	1120.06	1120.06	220	1119.46	1119.46	221	1118.86	1118.86	222	1118.26	1118.26	223	1117.66	1117.66	224	1117.06	1117.06	225	1116.46	1116.46	226	1115.86	1115.86	227	1115.26	1115.26	228	1114.66	1114.66	229	1114.06	1114.06	230	1113.46	1113.46	231	1112.86	1112.86	232	1112.26	1112.26	233	1111.66	1111.66	234	1111.06	1111.06	235	1110.46	1110.46	236	1109.86	1109.86	237	1109.26	1109.26	238	1108.66	1108.66	239	1108.06	1108.06	240	1107.46	1107.46	241	1106.86	1106.86	242	1106.26	1106.26	243	1105.66	1105.66	244	1105.06	1105.06	245	1104.46	1104.46	246	1103.86	1103.86	247	1103.26	1103.26	248	1102.66	1102.66	249	1102.06	1102.06	250
--------	---------	-----	--------	---------	-----	--------	---------	-----	--------	---------	-----	--------	---------	-----	--------	---------	-----	--------	---------	-----	--------	---------	-----	--------	---------	-----	---------	---------	-----	---------	---------	-----	---------	---------	-----	---------	---------	-----	---------	---------	-----	---------	---------	-----	---------	---------	-----	---------	---------	-----	---------	---------	-----	---------	---------	-----	---------	---------	-----	---------	---------	-----	---------	---------	-----	---------	---------	-----	---------	---------	-----	---------	---------	-----	---------	---------	-----	---------	---------	-----	---------	---------	-----	---------	---------	-----	---------	---------	-----	---------	---------	-----	---------	---------	-----	---------	---------	-----	---------	---------	-----	---------	---------	-----	---------	---------	-----	---------	---------	-----	---------	---------	-----	---------	---------	-----	---------	---------	-----	---------	---------	-----	---------	---------	-----	---------	---------	-----	---------	---------	-----	---------	---------	-----	---------	---------	-----	---------	---------	-----	---------	---------	-----	---------	---------	-----	---------	---------	-----	---------	---------	-----	---------	---------	-----	---------	---------	-----	---------	---------	-----	---------	---------	-----	---------	---------	-----	---------	---------	-----	---------	---------	-----	---------	---------	-----