

h-k

ORIGINAL CONSTRUCTION OF CFNS
 283220489, 283220490, 283220776, 283220777
 EXTENSION OF CFNS
 283220497, 283220509, 283220518, 283220545
 283220557, 283220565, 283220567, 283220595
 283220627, 283220643, 283220653, 283220668
 283220724, 283220752, 283220761, 283220806
 283220822, 283220851, 283220874, 283220895
 283220931, 283220959, 283220985, 283221046
 283221055, 283221068

INDEX
 STANDARD DRAWINGS ATTACHED

Pipe Culverts	300
Box Culverts	301
Slab Bridges	302-1
Inlets etc.	305
Type D Guard Rail	105

CONVENTIONAL SIGNS

Township Line	-----
Village Line	-----
Property Line	-----
Center Line	-----
Fence	-----
Electric or Telephone Line	
Steam Railroad	-----
Guard Rail	-----
Drain Pipe - new	-----
Trees	●●●●●

We, the Commissioners of Geauga County, hereby approve these plans and certify that the right-of-way 60 to 80 feet wide is available for the construction, maintenance and repair of the above highway.

B Ashcraft
W H Cromwell
A J Russell

Date Nov. 1927 County Commissioners.

STATE OF OHIO
 DEPARTMENT OF HIGHWAYS AND PUBLIC WORKS
 DIVISION OF HIGHWAYS
CLEVELAND — MEADVILLE ROAD
 I.C.H. NO. 15 SEC. H₁ PET. NO. M.&R.
GEAUGA COUNTY
 MUNSON — TOWNSHIP
 JUNE 1927

Gea. Use 322
 8.27-10.40
 FED. RD. DIST. NO. 10 STATE OHIO FED. AID PROJECT YEAR 469-B 1928
 SEC. H₁ GEAUGA COUNTY

The Standard Specifications of the State of Ohio, Division of Highways, in force on date of contract will govern this improvement.

I hereby approve these plans and declare that the making of this improvement will not require the closing to traffic of the highway

GEA-322-4.89
 1927 PLANS
 HEATH RD. (SLM 4.89) to SR 44 (SLM 10.45)

Approved: B. R. Kenney
 Date, 6-30-27 Resident Engineer.

Approved: L. C. Breen
 Date, 7-16-27 Resident Deputy
 State Highway Commissioner.

Approved: Robt. S. Reigher
 Date, 7-23-27 Chief Engineer
 Bureau of Construction.

Approved: _____
 Date, _____ Chief Engineer
 Bureau of Maintenance.

Approved: W. Burkey
 Date, 8-29-27 Chief Engineer
 Bureau of Bridges.

Approved: Harry J. Dink
 Date, 7-23-27 State Highway Engineer.

Approved: E. F. Schlesinger
 Date, 7-23-27 Director of Highways and
 Public Works.

Recommended for Approval: _____
 Date, _____ District Engineer
 Bureau of Public Roads.

Recommended for Approval: _____
 Date, _____ Chief Engineer.
 Bureau of Public Roads.

Approved: _____
 Date, _____ Chief of Bureau.

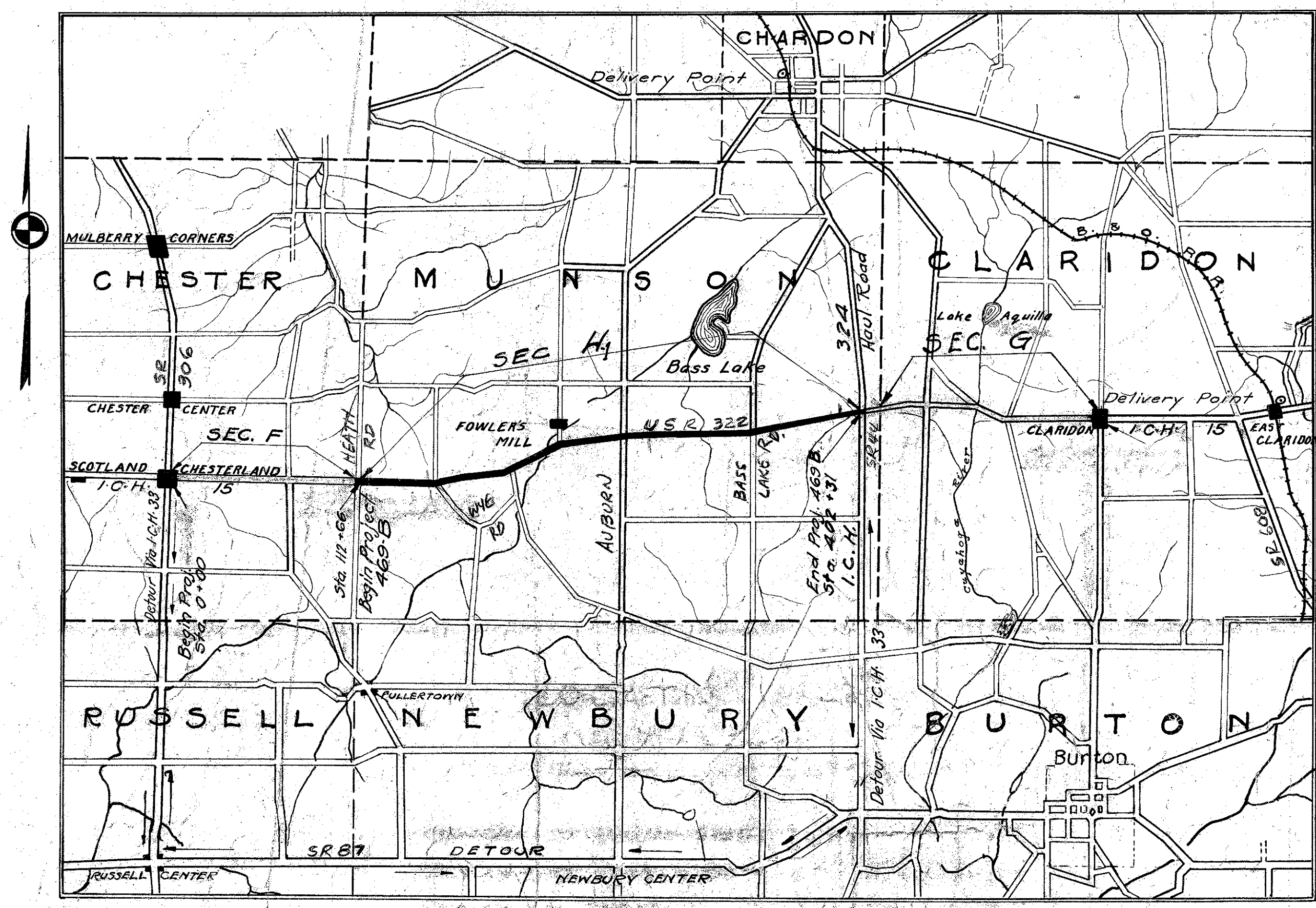

LOCATION MAP
 SCALE
 PORTION TO BE IMPROVED
 IMPROVED ROADS
 DETOURS (Alternate for thru traffic.)

SCALES	INDEX SEC. H ₁	Sheet
Plan 1"=100'	Title Page	1
Profile (Vertical) 1"=10'	Typical Cross Section	2
Profile (Horizontal) 1"=100'	Plans and Profile	3-13
Cross Sections 1"=5'	Cross Sections	14-27
	Structural Plans	28-33
	Summary Sheets	37-38
	Twin Slab Bridge	34-36

CONSTRUCTION BUREAU
 APR 4 1956
 GROUND PHOTOLAB

1086