

old CFN 283220985
new CFN 1852057
SLM 9.85, 12" VCP
SEE SHEET 32

DATE	
BY	
REVISION	
NO. 1	
NO. 2	
NO. 3	
NO. 4	
NO. 5	
NO. 6	
NO. 7	
NO. 8	
NO. 9	
NO. 10	

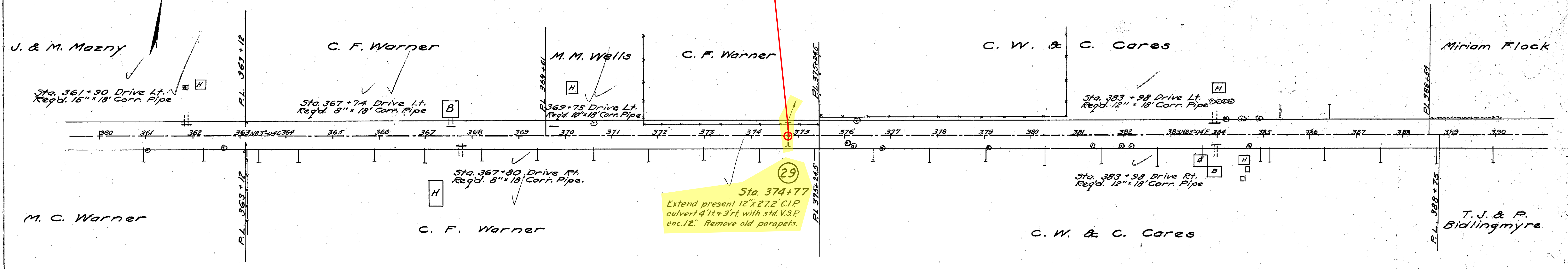

Note: Grade line shown is crown of existing pavement.

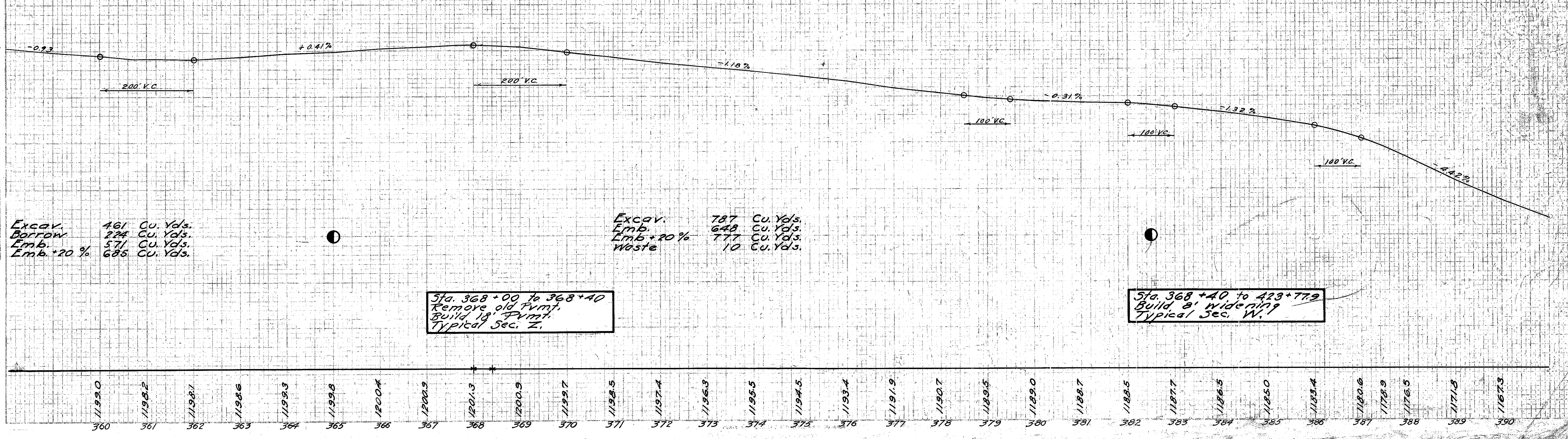

Excav. 461 Cu. Yds.
Borrow 224 Cu. Yds.
Emb. 571 Cu. Yds.
Emb. + 20% 685 Cu. Yds.

Excav. 787 Cu. Yds.
Emb. 648 Cu. Yds.
Emb. + 20% 777 Cu. Yds.
Waste 10 Cu. Yds.

Sta. 368+00 to 368+40
Remove old Pmnt.
Build 18' Pmnt.
Typical Sec. Z.

Sta. 368+40 to 423+77.9
Build 8' Widening
Typical Sec. W.