

1' CH 15 SEC. F
GEAUGA COUNTY

old CFN 283220347
new CFN 1807819
SLM 3.47, 2.5'x3'
CONCRETE BOX
SEE SHEET 13

old CFN 283220352
new CFN 1833184
SLM 3.52, 2.5'x3'
STONE AND CONCRETE
SEE SHEET 13

BARTFIELD ROAD
SLM 3.52 = MM 20.23

old CFN 283220384
new CFN 1807821
SLM 3.84, 12"
SEE SHEET 13

old CFN 283220355
new CFN 1807820
SLM 3.55, 15"
SEE SHEET 13

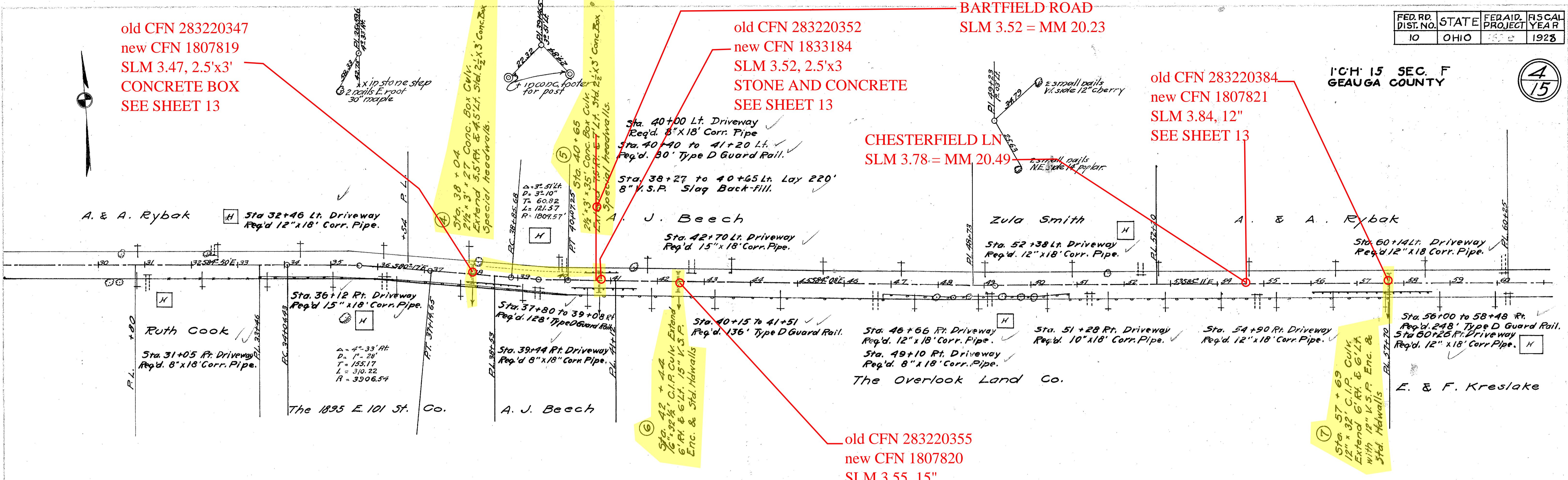

Note:- Profile shown is crown of existing pavement.

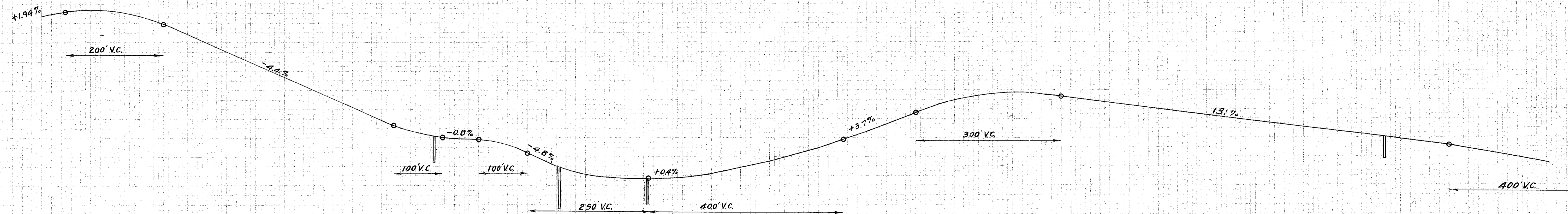

Excav. 1198
Emb. 667
Emb. +20% 800
Waste 395

Cu. Yds.
Cu. Yds.
Cu. Yds.
Cu. Yds.

Excav. 887
Emb. 570
Emb. +20% 684
Waste 203

Cu. Yds.
Cu. Yds.
Cu. Yds.
Cu. Yds.

Excav. 758
Emb. 699
Emb. +20% 739
Waste 19

Cu. Yds.
Cu. Yds.
Cu. Yds.
Cu. Yds.

